

LOCALE	CODICE	DESCRIZIONE COMPONENTE	FINITURA	GR.
CABINA ARMATORE	MD321_AA01	ARMADIO	LAMINATO SM'ART ES04 JUNGLE ANICE	PTP

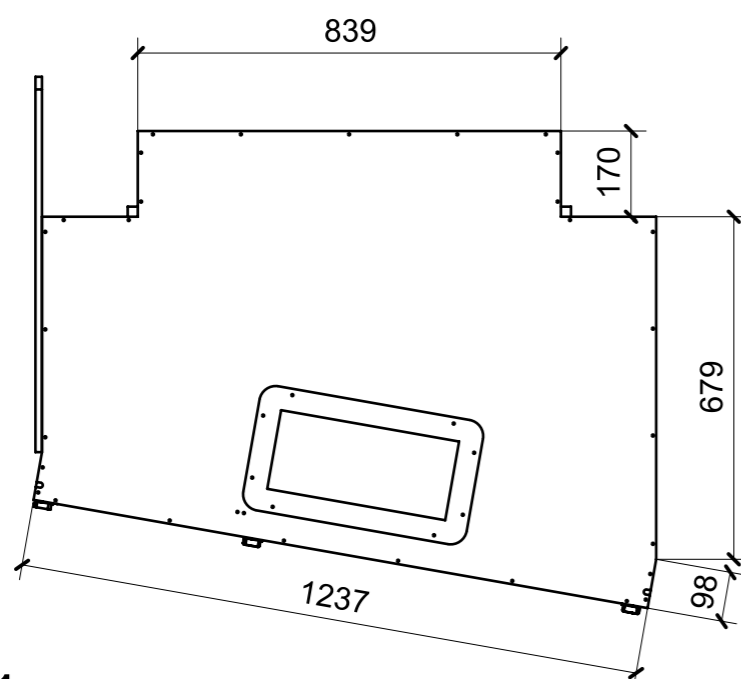
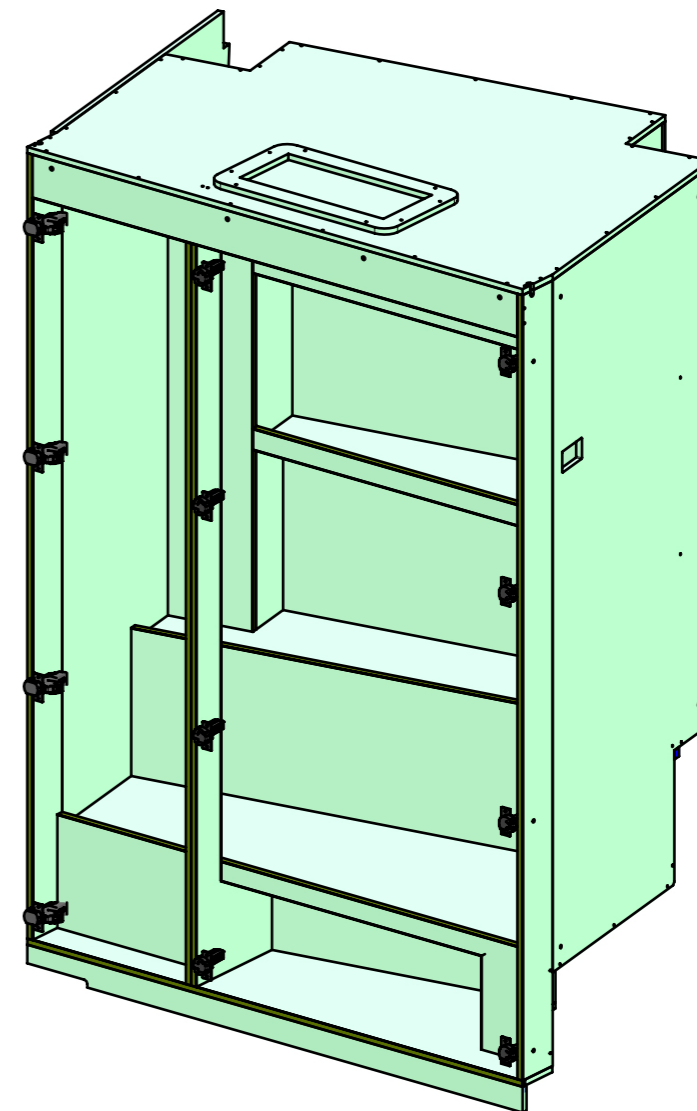
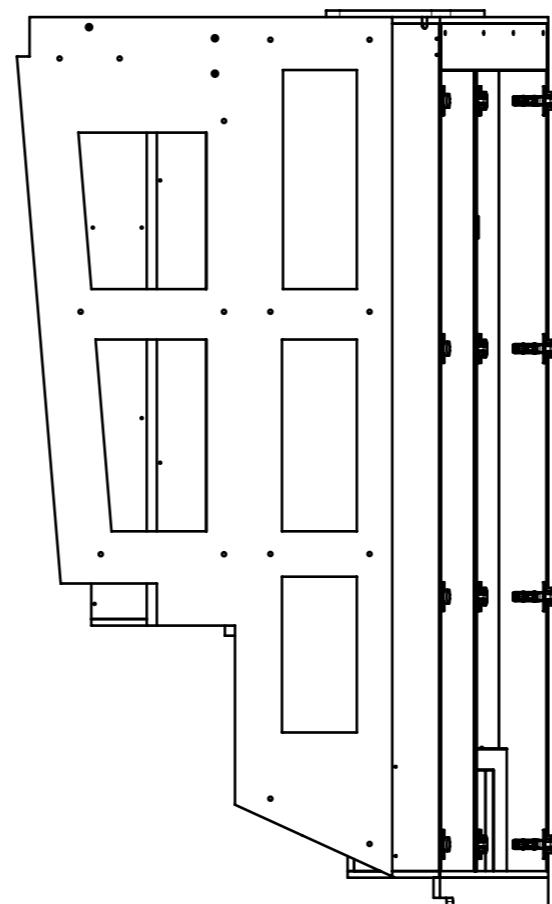
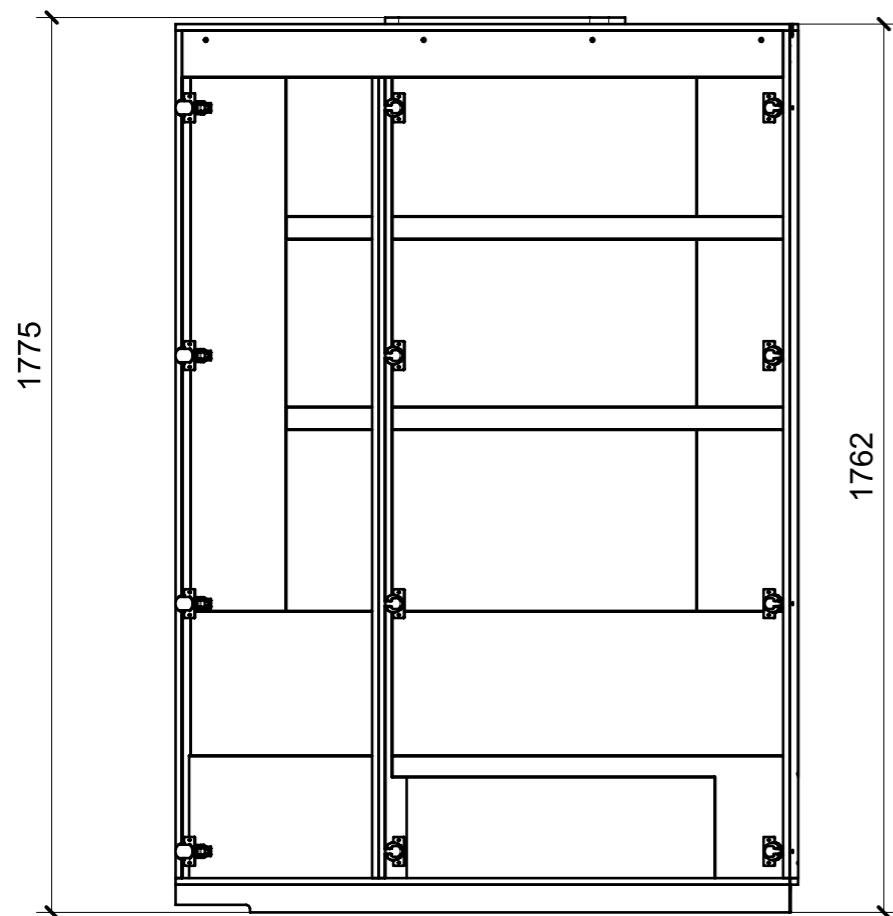

01

FERRAMENTA	QTY
BASE_0-NERA_HAFELE_342.22.065-BLUM_175H3100.STP	4
BASE_3-NERA_HAFELE_342.22.067-BLUM_175H3130.STP	8
BUSSOLA 5MA ANKOR BORGHI X BASE 0	8
BUSSOLA 5MA ANKOR BORGHI X CERNIERA COLLO PIENO	24
BUSSOLA 6MA X 10 FORO DIAM.8	3
CERNIERA 155° .PIANA NERA. BLUM SOFT CLOSING 342_44_406	4
CERNIERA 94°_MEZZO COLLO-NERA_HAFELE_342.46.605-BLUM_71B9650	8
KIT LED PER ARMADIO MD321 AA01 MM 800 _ E MM 381	1
RISCONTRO IN FERRO PER CALAMITA DA FAR PRODURRE X MD321	6
VITE 4MAX8 ANKOR BORGHI	16
VITE 4MAX8 ANKOR BORGHI X BASE 0	8

LOCALE	CODICE	DESCRIZIONE COMPONENTE	FINITURA	GR.
CABINA ARMATORE	MD321_AB01	STRUTTURA DX VANO TENDA	OKUME' GREZZO-VERNICIATO ANTI ROMBO	2

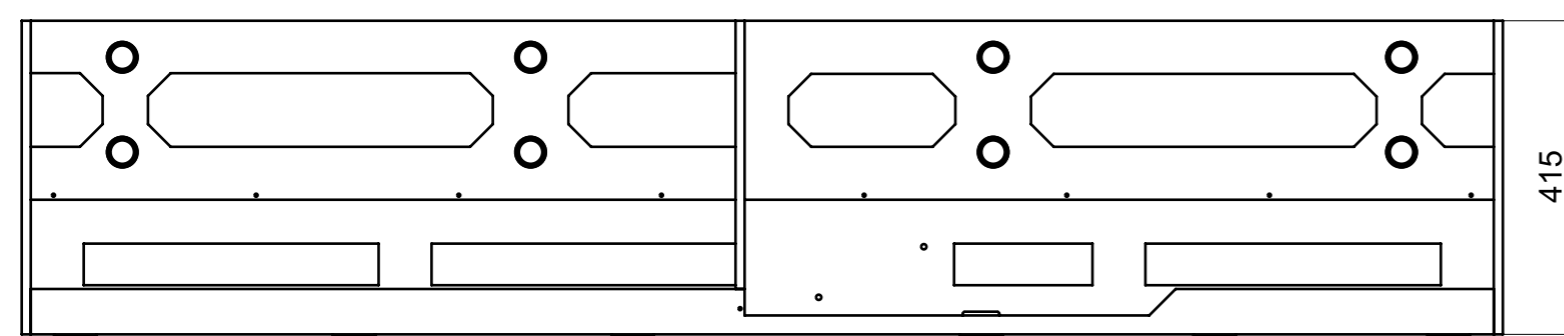
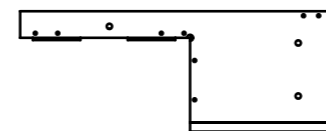
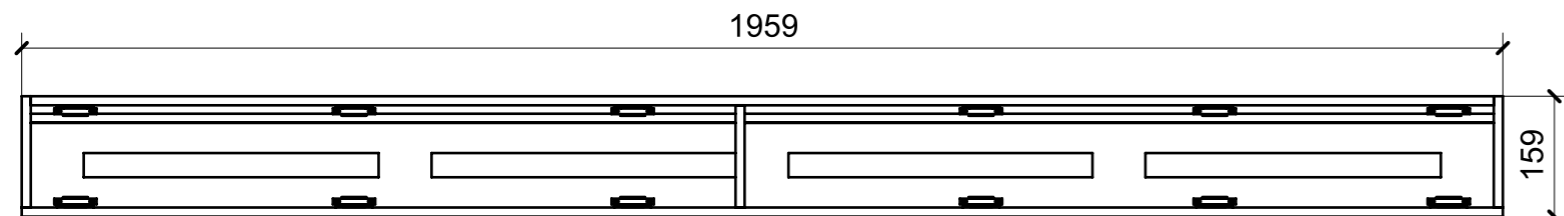

OKUME' GREZZO

VERNICIATO ANTI ROMBO

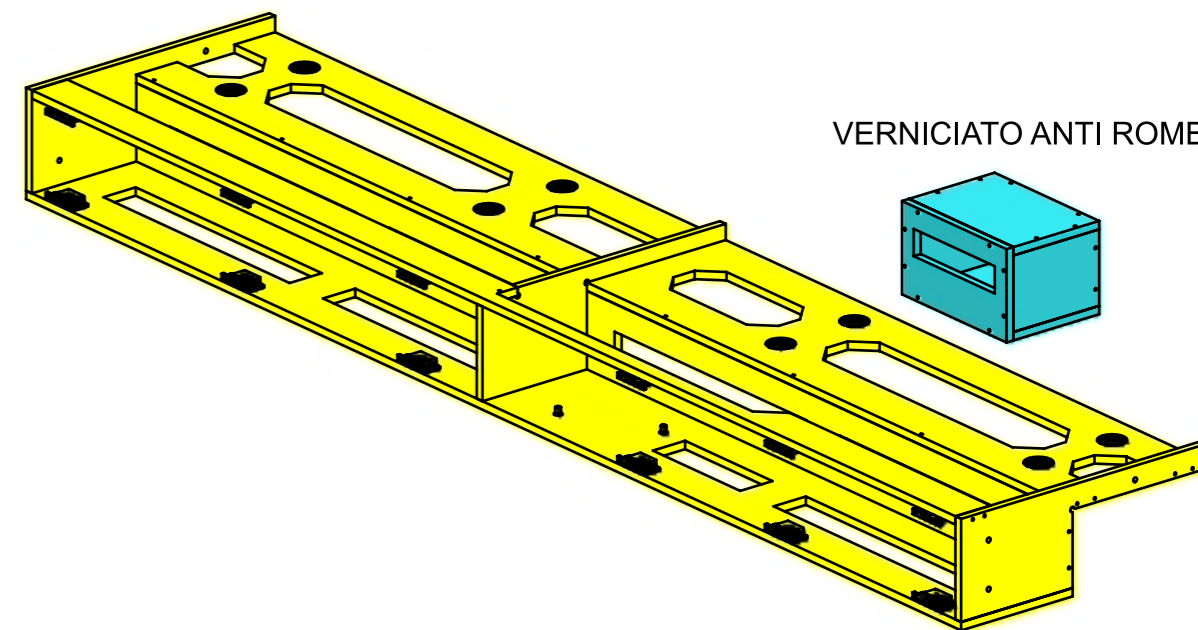

01

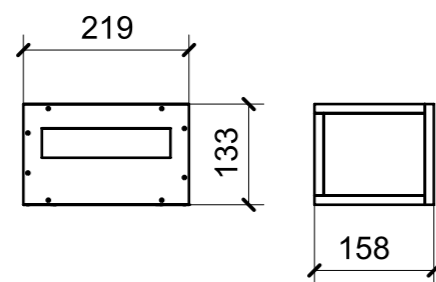

02

FERRAMENTA	QTY
BUSSOLA 6MA X 10 FORO DIAM.8	2
CHIUSURA A SPINTA_TECHNOPARTNER_SOU C3-203	12
FITLOCK F_MASCHERPA_6020101102	8
VITE 6MA X 20 TESTA SVASATA_FBC	2

LOCALE	CODICE	DESCRIZIONE COMPONENTE	FINITURA	GR.
CABINA ARMATORE	MD321_AC01	PANNELLO OBLO' MURATA DX	LAMINATO ABET 411	PTP

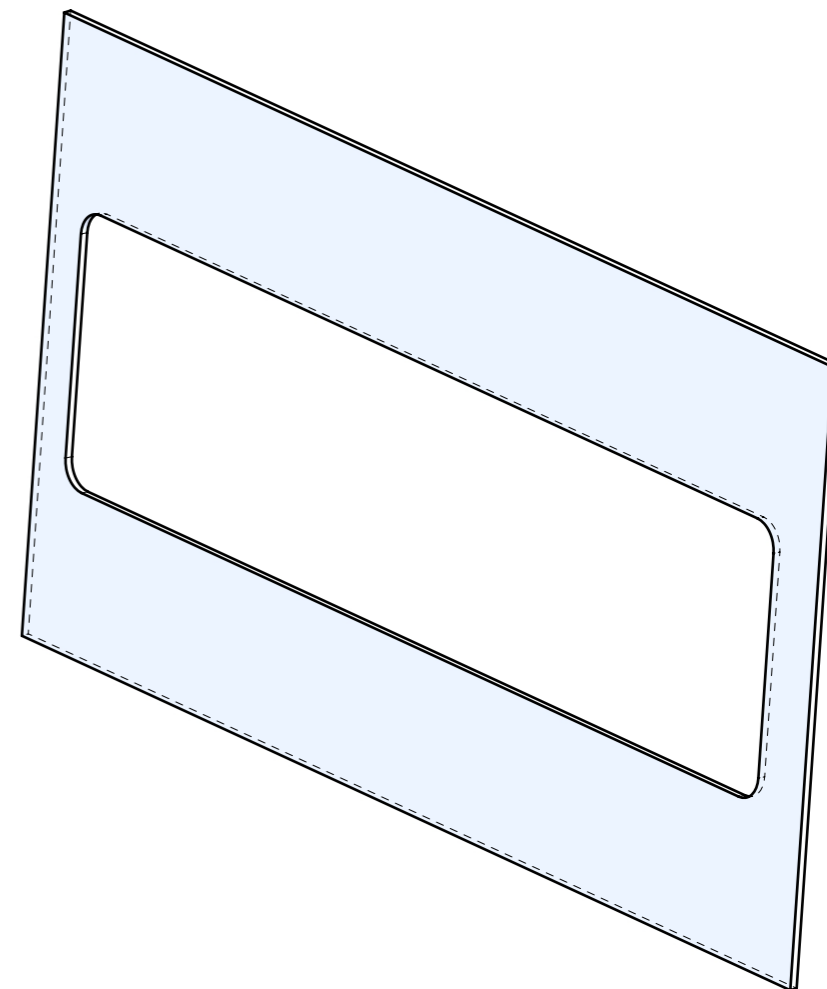
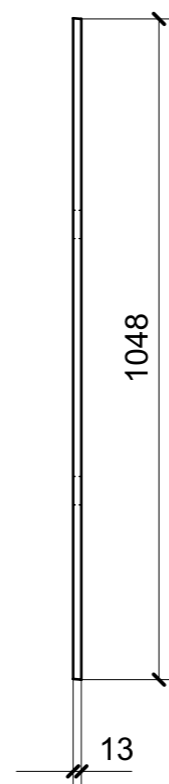
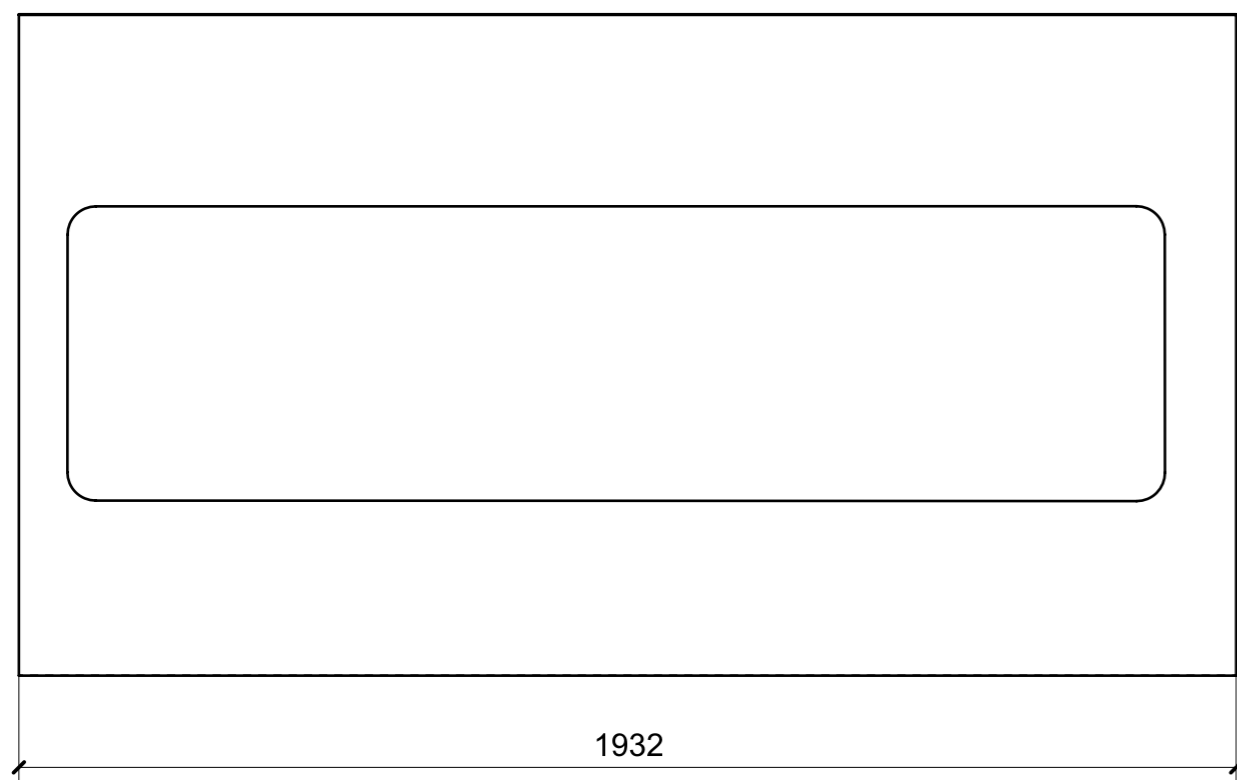

01

LOCALE	CODICE	DESCRIZIONE COMPONENTE	FINITURA	GR.
CABINA ARMATORE	MD321_AD01	STRUTTURA MURATA DX	OKUME' GREZZO	PTP

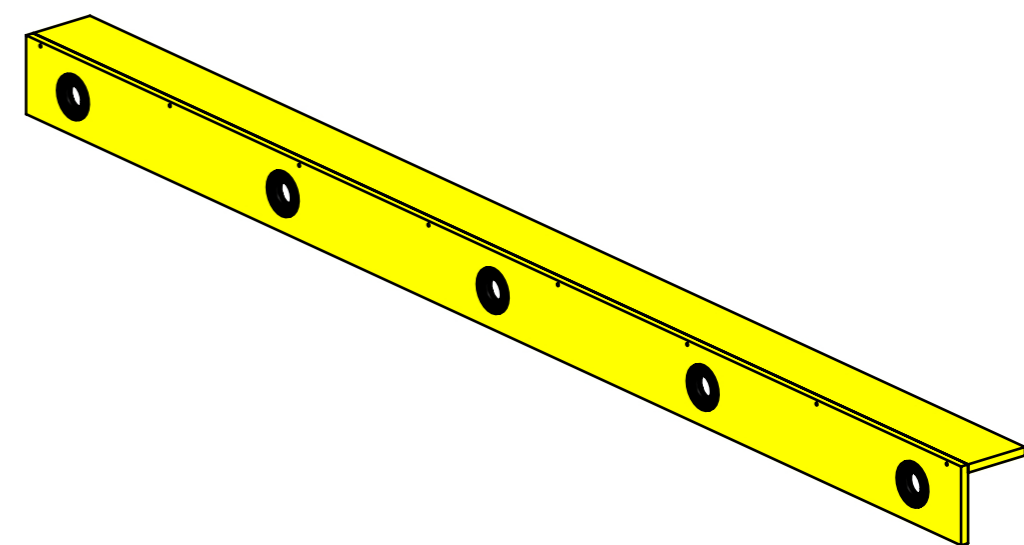
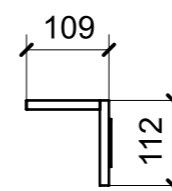
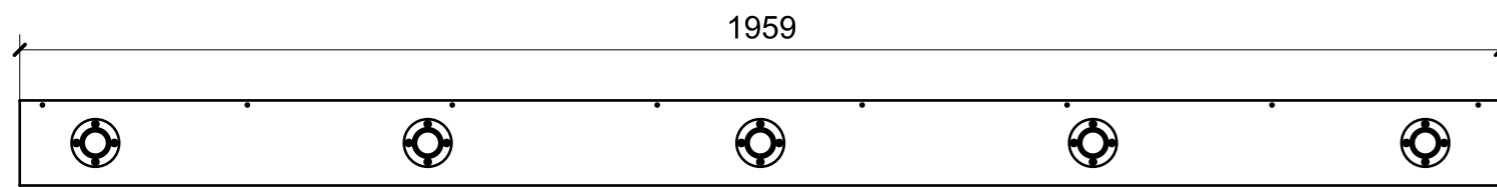

01

FERRAMENTA	QTY
FITLOCK F_MASCHERPA_6020101102	5

LOCALE	CODICE	DESCRIZIONE COMPONENTE	FINITURA	GR.
CABINA ARMATORE	MD321_AE01	STRUTT. ANGOLO POPPA MURATA DX	OKUME' GREZZO	2

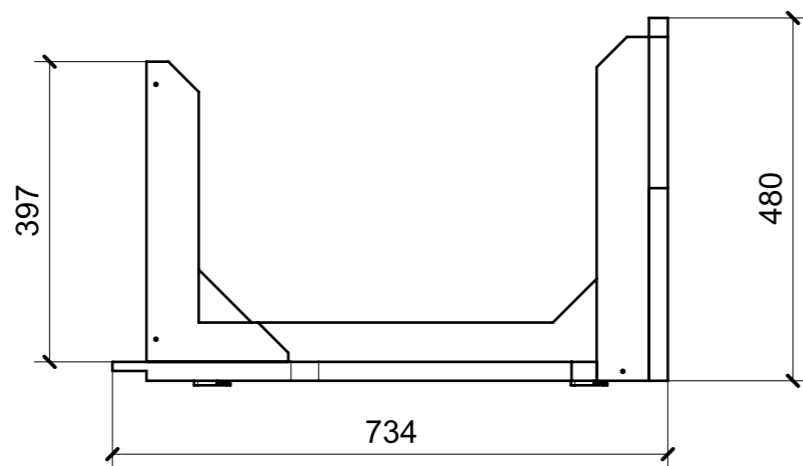
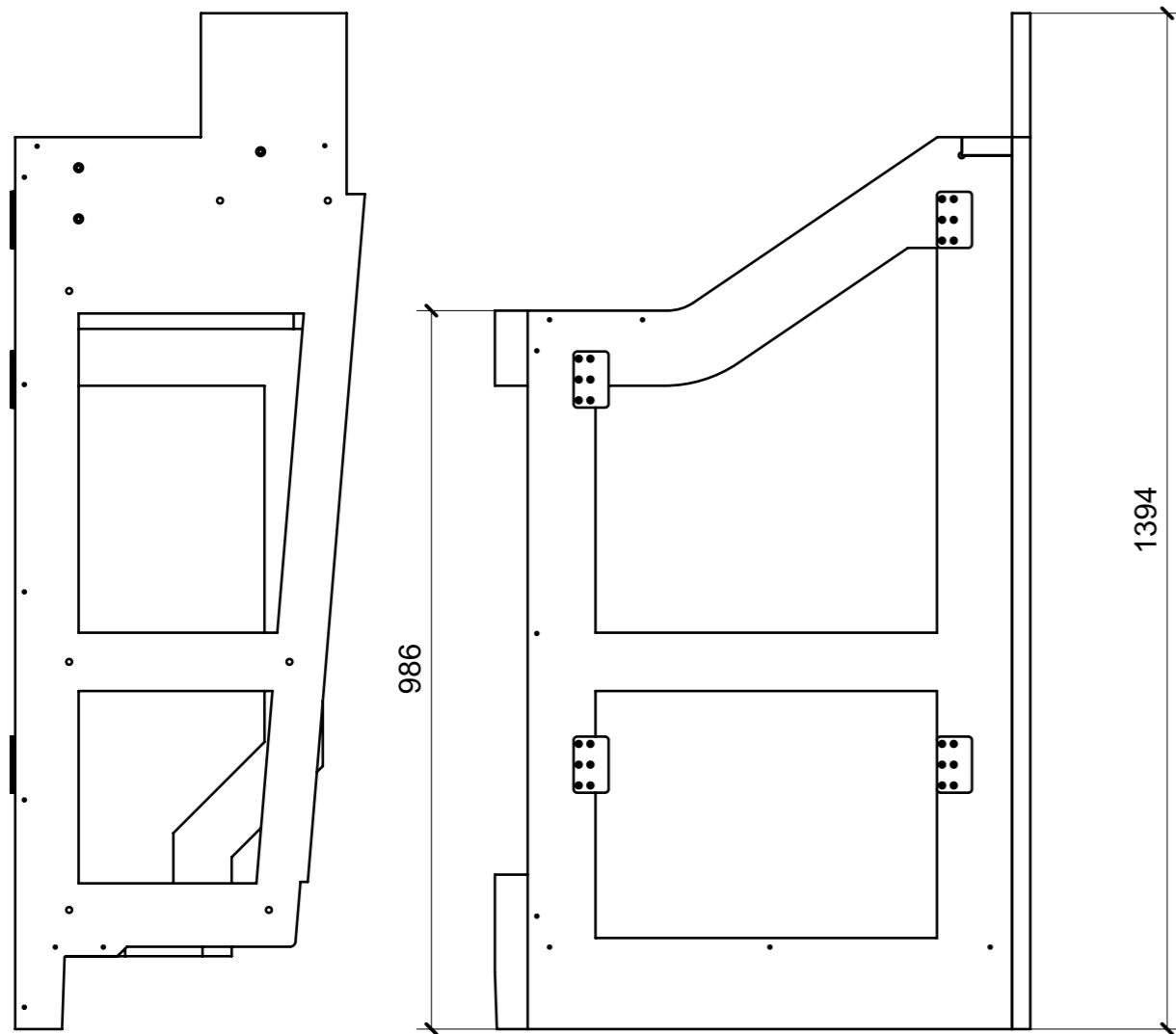

01

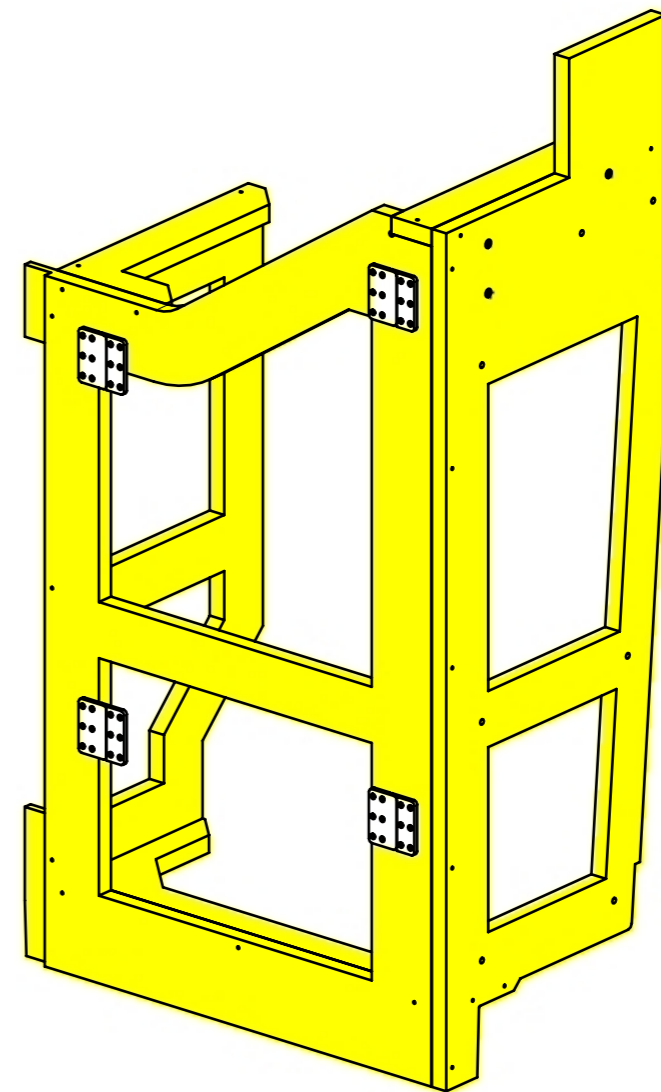

FERRAMENTA	QTY
BUSSOLA 6MA X 10 FORO DIAM.8	3
BAIONETTA CAI FITLOCK_	4

LOCALE	CODICE	DESCRIZIONE COMPONENTE	FINITURA	GR.
CABINA ARMATORE	MD321_AG01	MOBILE A RIBALTA POPPA DX	LAMINATO SM'ART ES04 JUNGLE ANICE	2

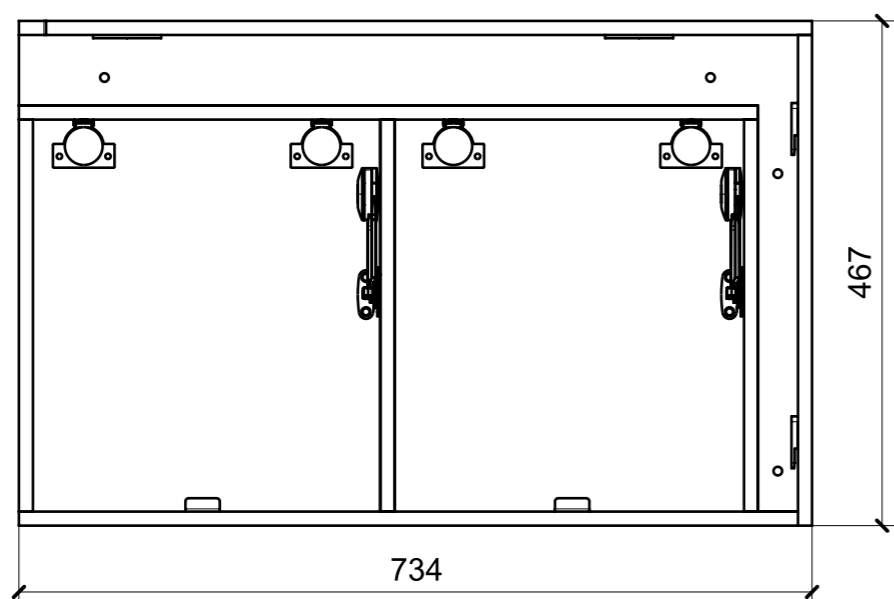
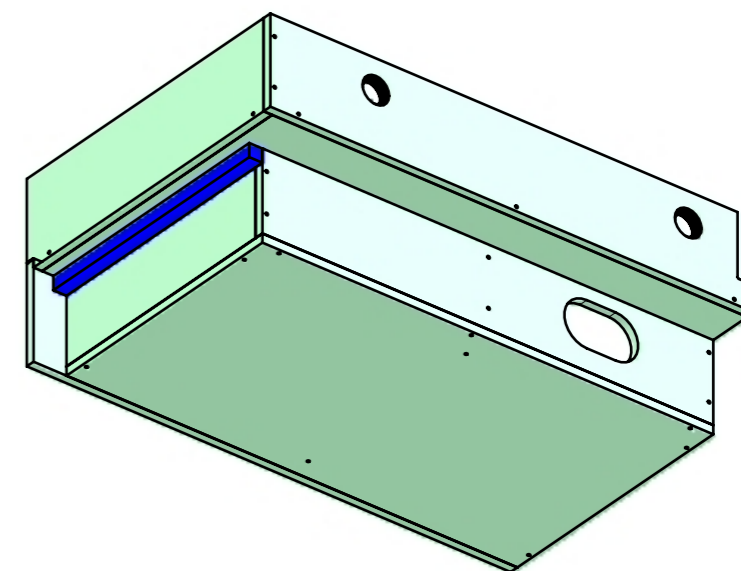
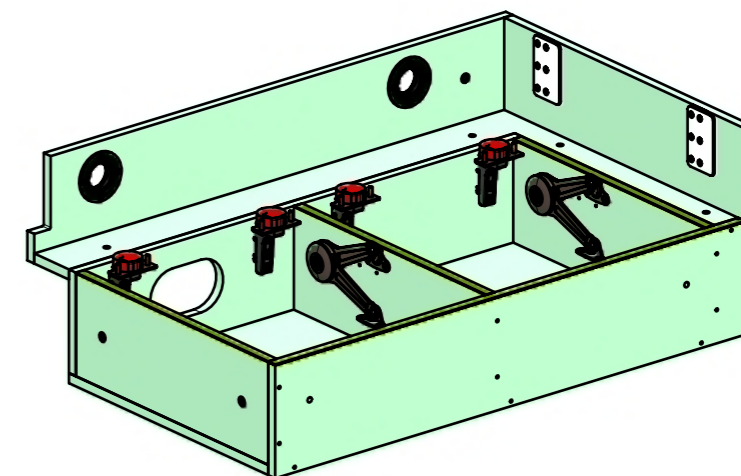
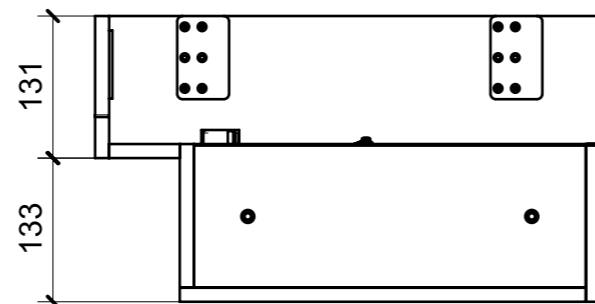
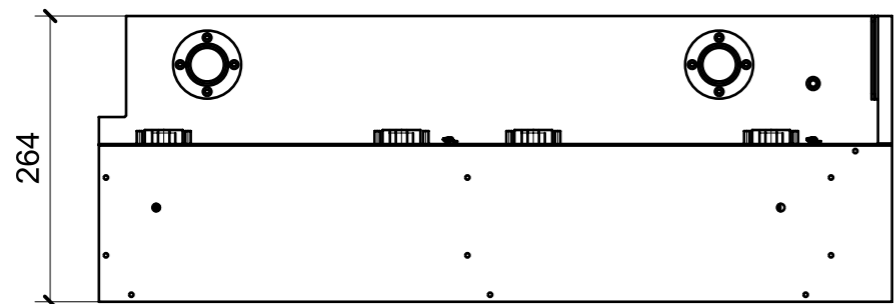

01

FERRAMENTA	QTY
BAIONETTA CAI FITLOCK_	2
BASE_0-NERA_HAFELE_342.22.065-BLUM_175H3100.STP	4
BRACCETTO A CIPOLLA PER ANTE A RIBALTA NERO_HAFELE_373_66_213	2
BUSSOLA 5MA ANKOR BORGHI X BASE 0	8
BUSSOLA 6MA X 10 FORO DIAM.8	3
CERNIERA 95°_COLLO PIENO-NERA_HAFELE_342.46.606-BLUM_71B9750.STP	4
FITLOCK F_MASCHERPA_6020101102	2
KEEPER PUSH TO CLOSE_SOUTCHO-J-M1-519-4_TECHNOPARTNER	2
VITE 4MAX8 ANKOR BORGHI X BASE 0	8

LOCALE	CODICE	DESCRIZIONE COMPONENTE	FINITURA	GR.
CABINA ARMATORE	MD321_AH01	COMODINO DX	LAMINATO SM'ART ES04 JUNGLE ANICE	2

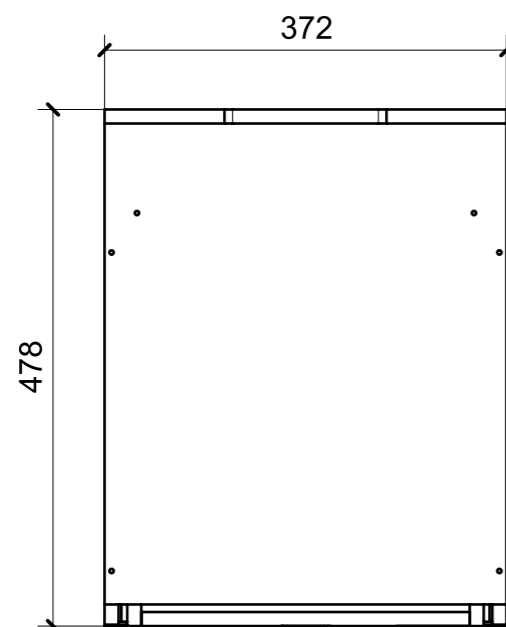
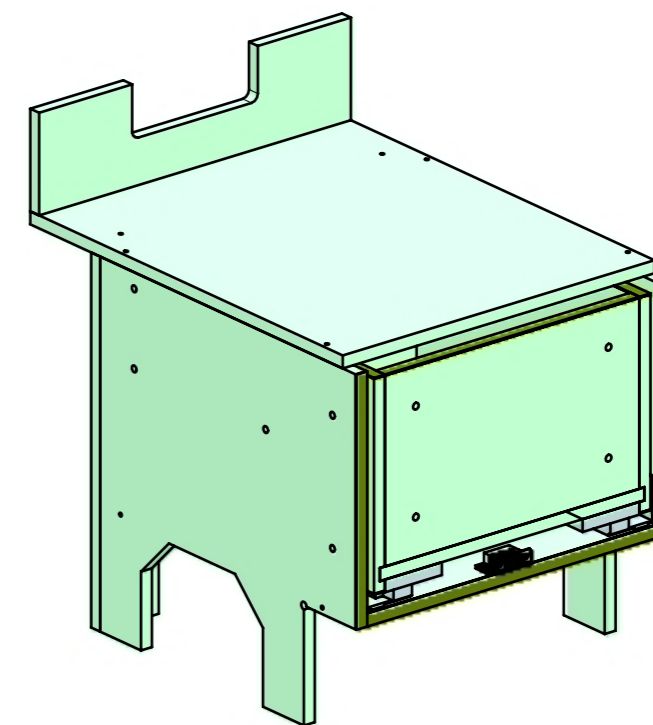
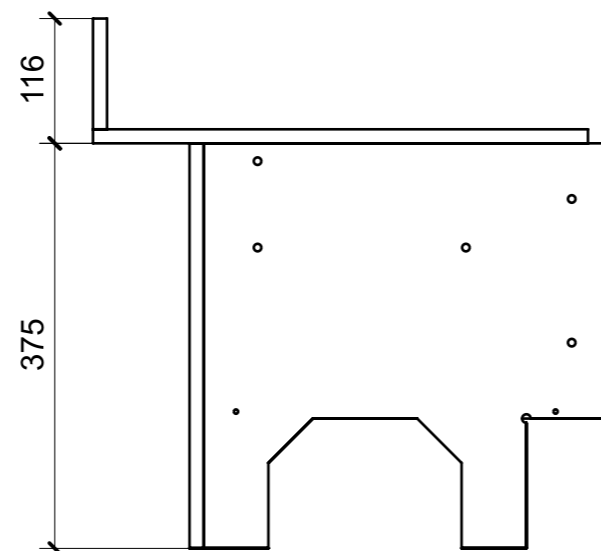
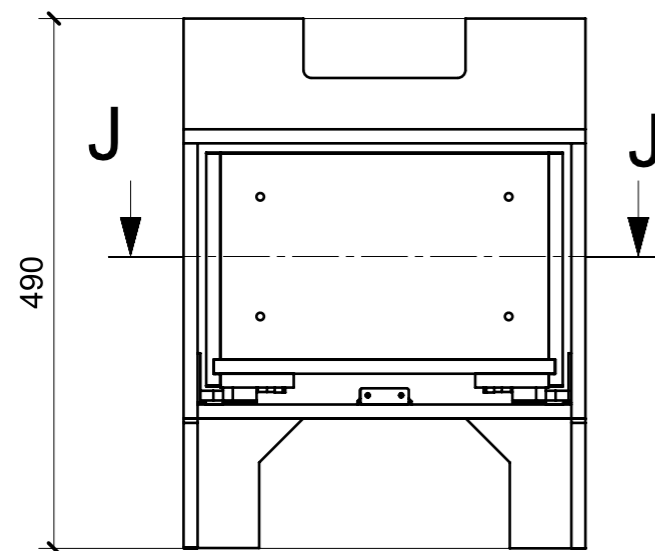

01

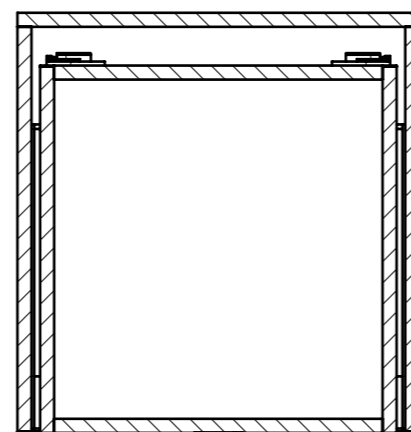

SECTION J-J

FERRAMENTA	QTY
CALAMITA SEALED MAGNETIC_TECNOPARTNER_MC-JM50-BL	1
PLACCHETTA COUNTER STEEL_TECNOPARTNER_MC-JM49	1
GUIDA DYNAPRO ADJUSTAMENT ADAPTER R_FBC_F134141746 4D	1
GUIDA DYNAPRO FRONT LOCKING DEVICE R_FBC_F134108955 4D	1
GUIDA DYNAPRO SOFTCLOSE L350 R_FBC_F130107802 4D	1
GUIDA DYNAPRO ADJUSTAMENT ADAPTER L_FBC_F134141746 4D	1
GUIDA DYNAPRO FRONT LOCKING DEVICE L_FBC_F134108955 4D	1
GUIDA DYNAPRO SOFTCLOSE L350 L_FBC_F130107802 4D	1

LOCALE	CODICE	DESCRIZIONE COMPONENTE	FINITURA	GR.
CABINA ARMATORE	MD321_AI01	LETTO	LAMINATO SM'ART ES04 JUNGLE ANICE	2

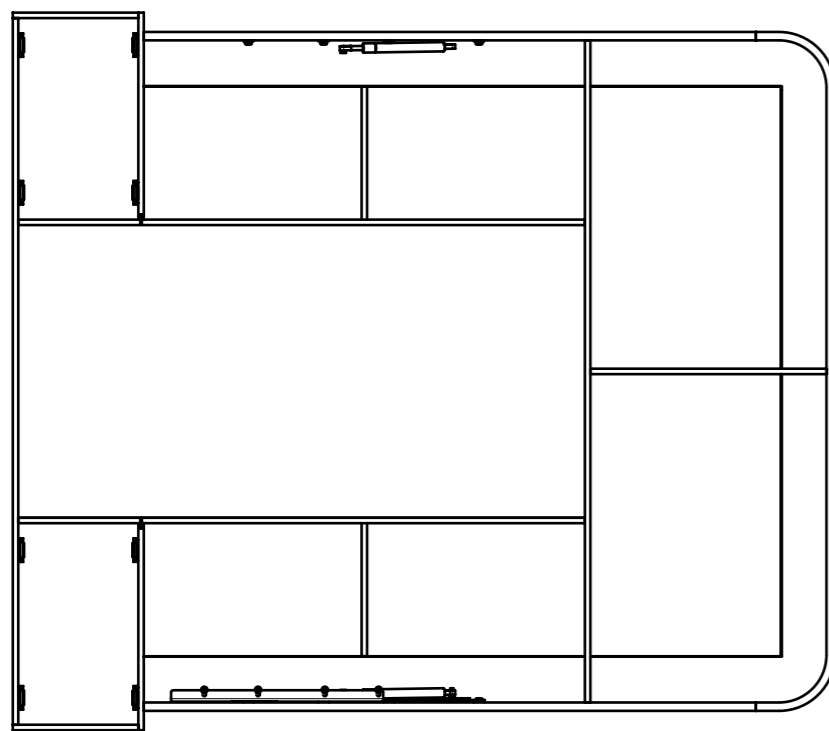

01

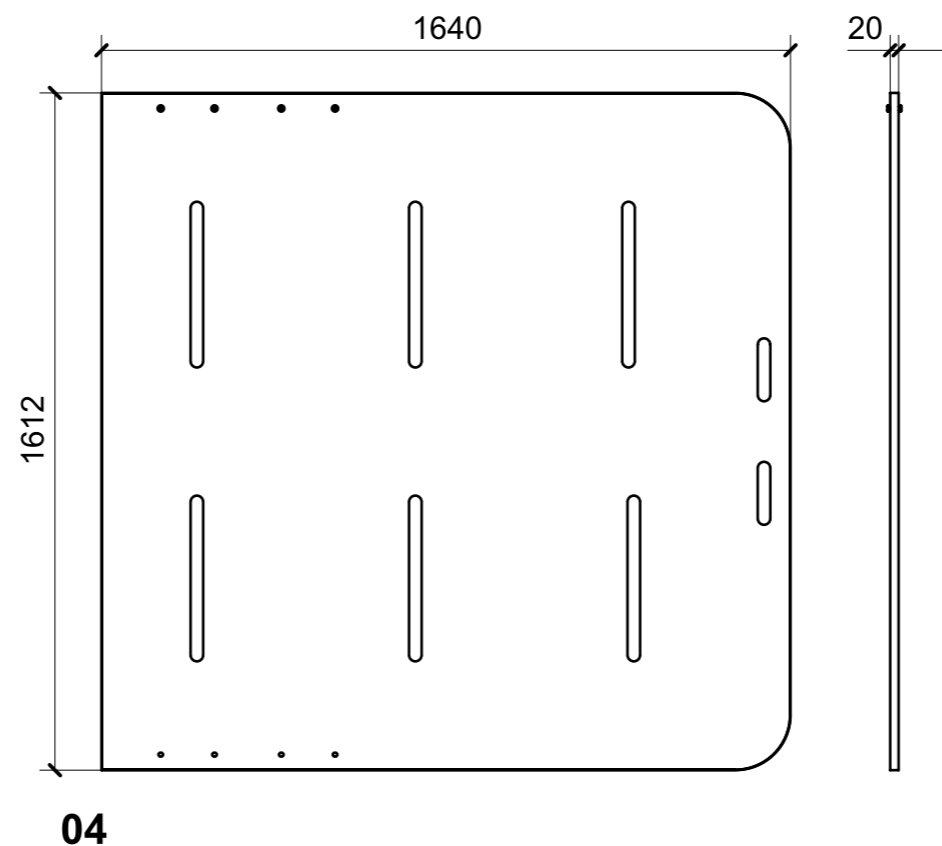

ELEMENTI DA MONTARE
in MG_AI01
e spedire con unico imballo

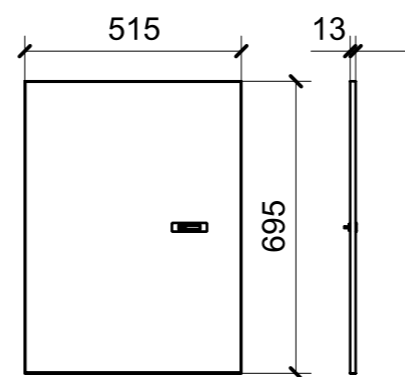
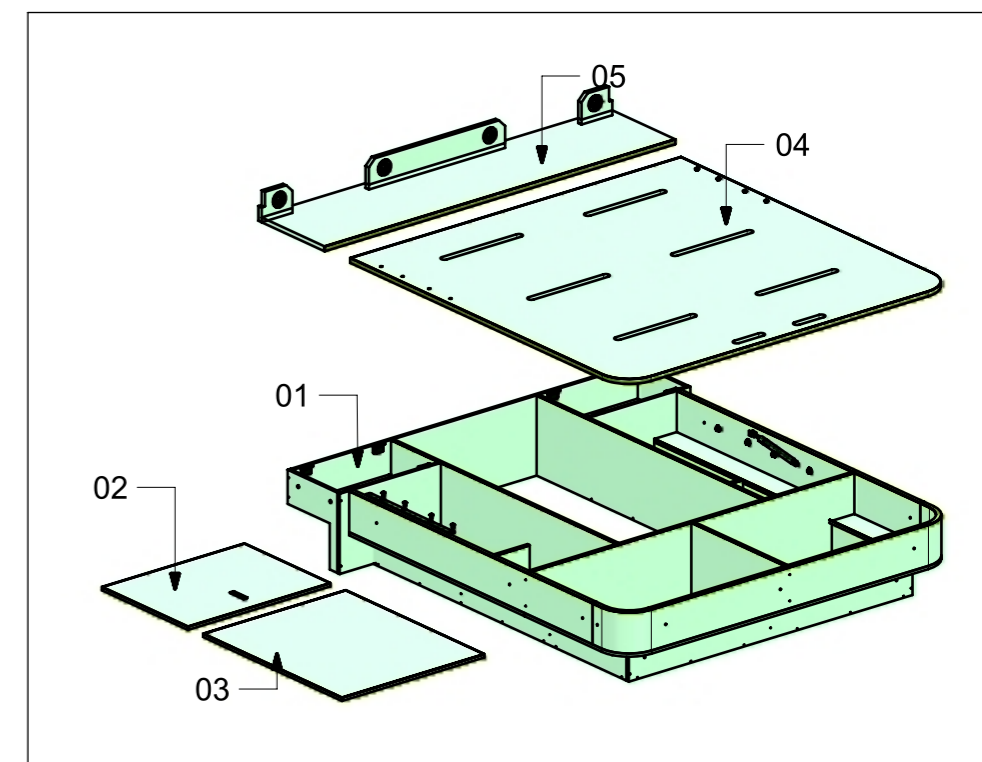

02

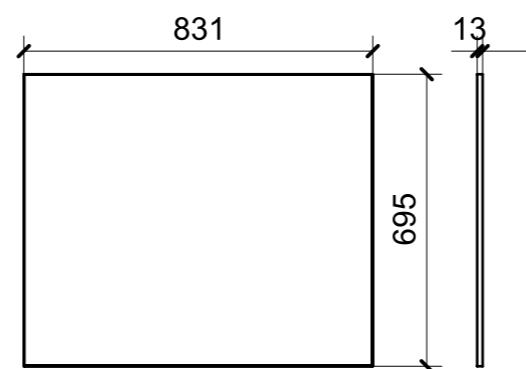

03

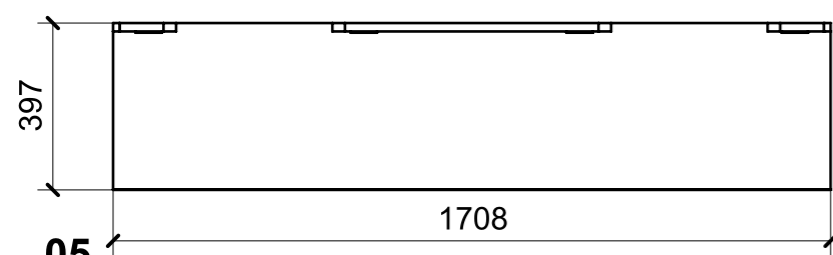
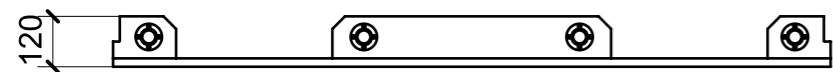

05

FERRAMENTA	QTY
ALZAPAGLIOLI_FORESTI_164.B BRUNITON	1
BORCHIA PASSO 6MA_FBC	8
BUSSOLA 6MA X 10 FORO DIAM.8	4
BUSSOLA 8MA X 14_FBC	8
CHIUSURA A SPINTA_TECHNOPARTNER_SOU C3-203	8
CP TRAPEZI NERI STABILUS TZ 530 BTZ T2.A0_FBC_99999049	1
FITLOCK F_MASCHERPA_6020101102	4
PISTONE A GAS STABILUS_456306_600NW-L385_FBC	1
PISTONE A GAS STABILUS_456306_600NW-L385_FBC_99999049	1
RANELLA SP.2 MM DIAM.24 FORO 8_FBC	8
SEEGER PER MECC. LETTO_00407908	2
TBL 6MAX15_FBC	8
TBL 8MA X 20_FBC	8
VITE 4MA X 12 TESTA SVASATA ESAGONALE NERA_FBC	2

LOCALE	CODICE	DESCRIZIONE COMPONENTE	FINITURA	GR.
CABINA ARMATORE	MD321AJ01	COMODINO SX	LAMINATO SM'ART ES04 JUNGLE ANICE	2

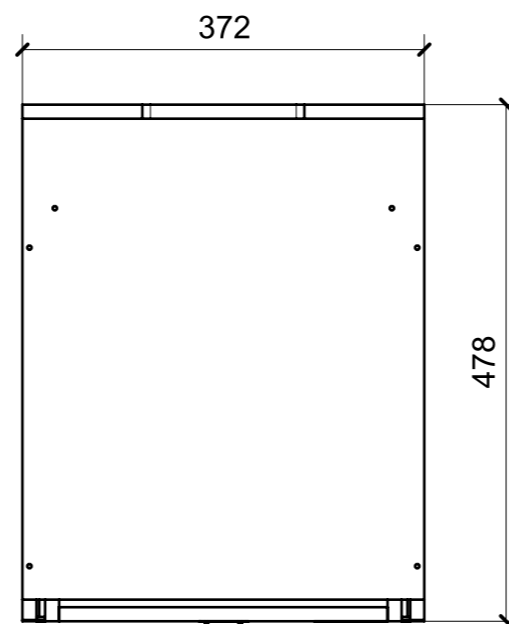
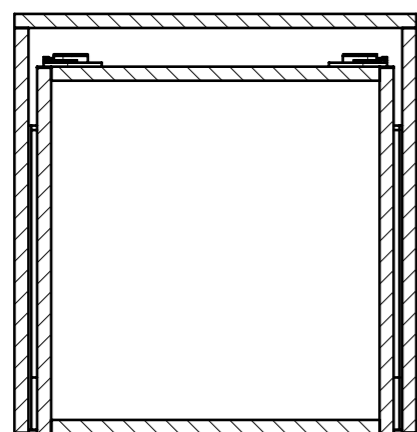
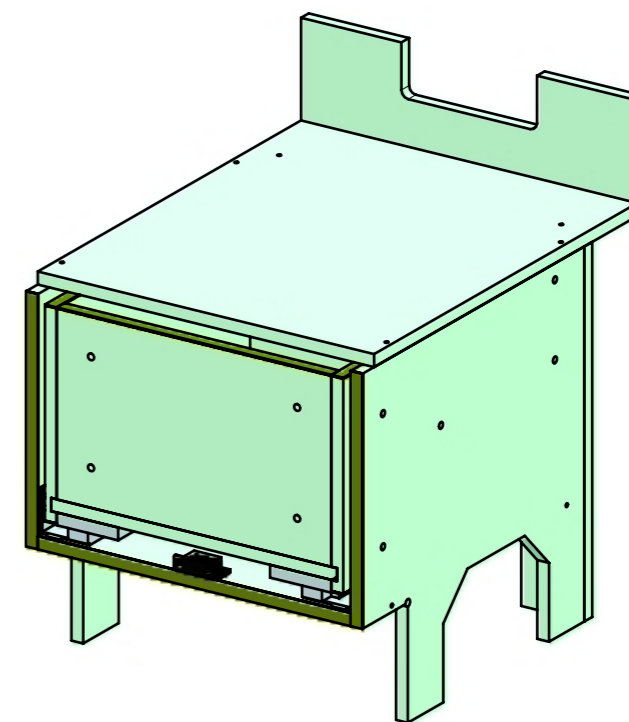
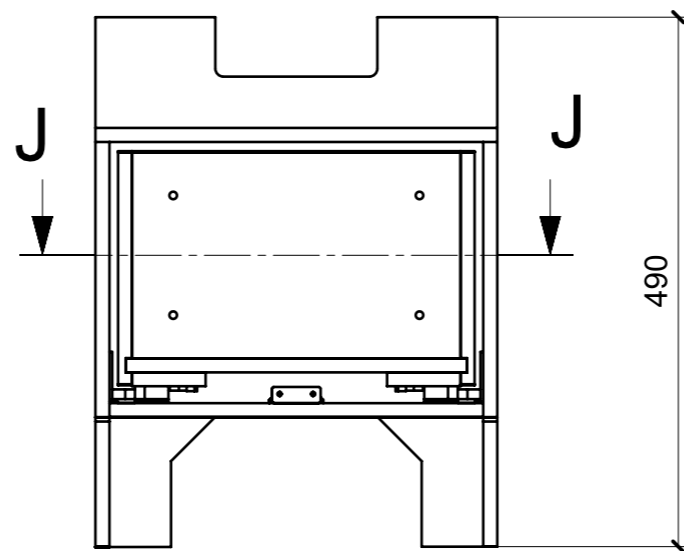
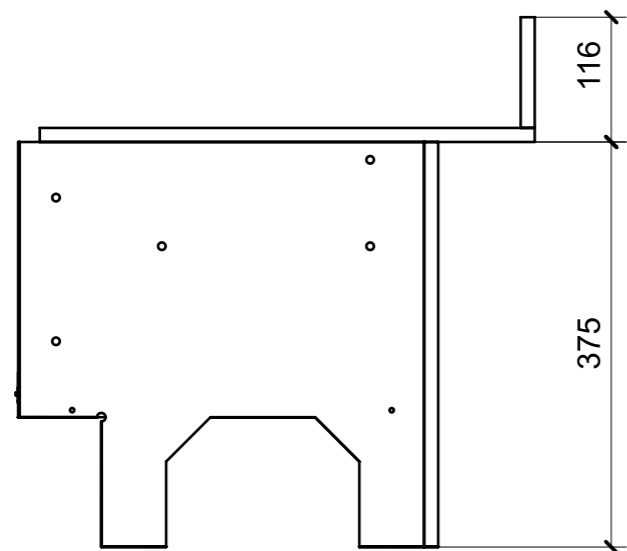

01

SECTION J-J

FERRAMENTA	QTY
PLACCHETTA COUNTER STEEL_TECHNOPARTNER_MC-JM49	1
GUIDA DYNAPRO SOFTCLOSE L350 R_FBC_F130107802 4D	1
GUIDA DYNAPRO SOFTCLOSE L350 L_FBC_F130107802 4D	1
GUIDA DYNAPRO FRONT LOCKING DEVICE R_FBC_F134108955 4D	1
GUIDA DYNAPRO FRONT LOCKING DEVICE L_FBC_F134108955 4D	1
GUIDA DYNAPRO ADJUSTMENT ADAPTER R_FBC_F134141746 4D	1
GUIDA DYNAPRO ADJUSTMENT ADAPTER L_FBC_F134141746 4D	1
CALAMITA SEALED MAGNETIC_TECNOPARTNER_MC-JM50-BL	1

LOCALE	CODICE	DESCRIZIONE COMPONENTE	FINITURA	GR.
CABINA ARMATORE	MD321_AK01	MOBILE A RIBALTA POPPA SX	LAMINATO SM'ART ES04 JUNGLE ANICE	2

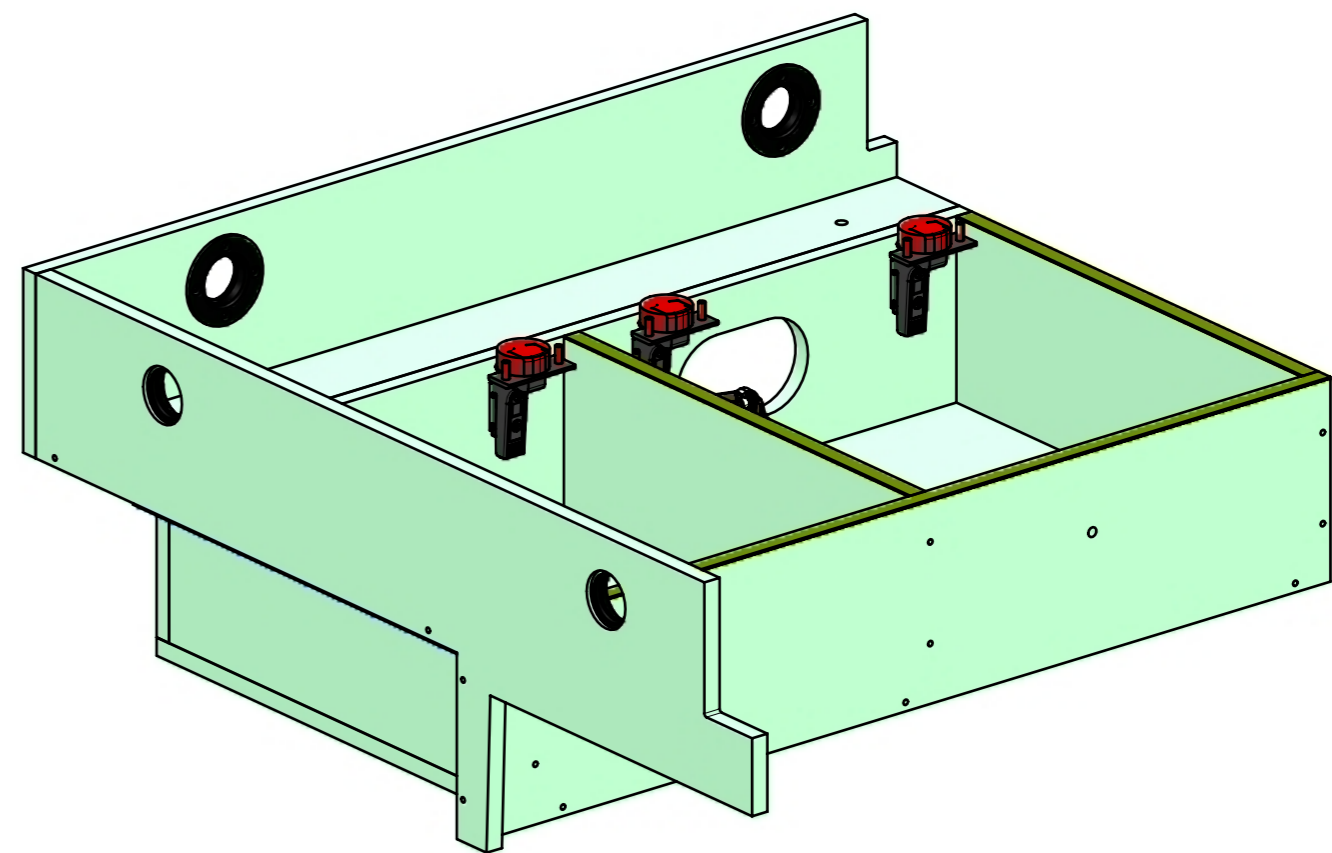
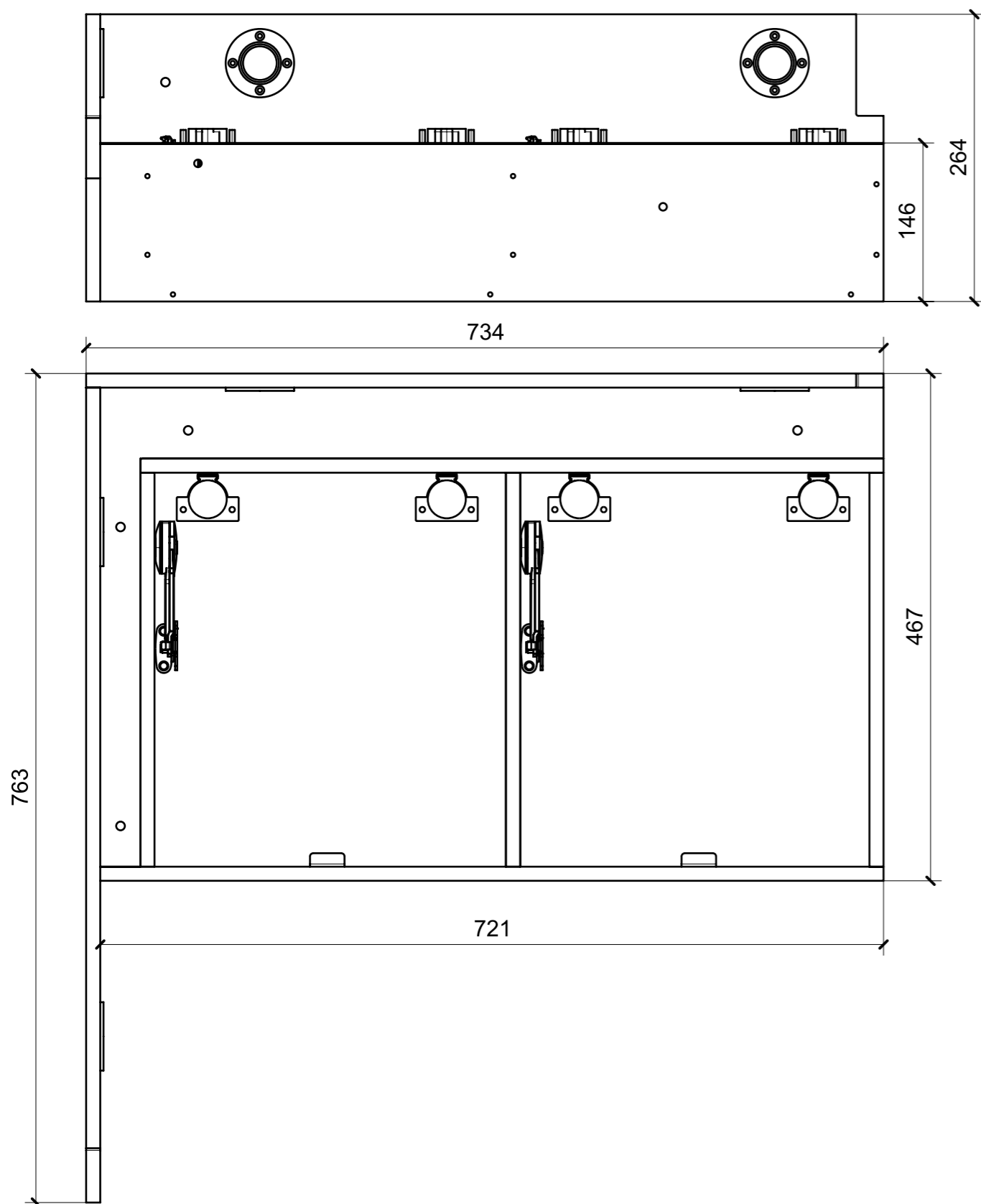

FERRAMENTA	QTY
BASE_0-NERA_HAFELE_342.22.065-BLUM_175H3100.STP	4
BRACCETTO A CIPOLLA PER ANTE A RIBALTA NERO_HAFELE_373_66_213	2
BUSSOLA 5MA ANKOR BORGHI X BASE 0	8
CERNIERA 95°_COLLO PIENO-NERA_HAFELE_342.46.606-BLUM_71B9750.STP	4
FITLOCK F_MASCHERPA_6020101102	4
KEEPER PUSH TO CLOSE_SOUTCHO-J-M1-519-4_TECHNOPARTNER	2

LOCALE	CODICE	DESCRIZIONE COMPONENTE	FINITURA	GR.
CABINA ARMATORE	MD321_AL01	STRUTT. ANGOLO POPPA MURATA SX	OKUME' GREZZO	2

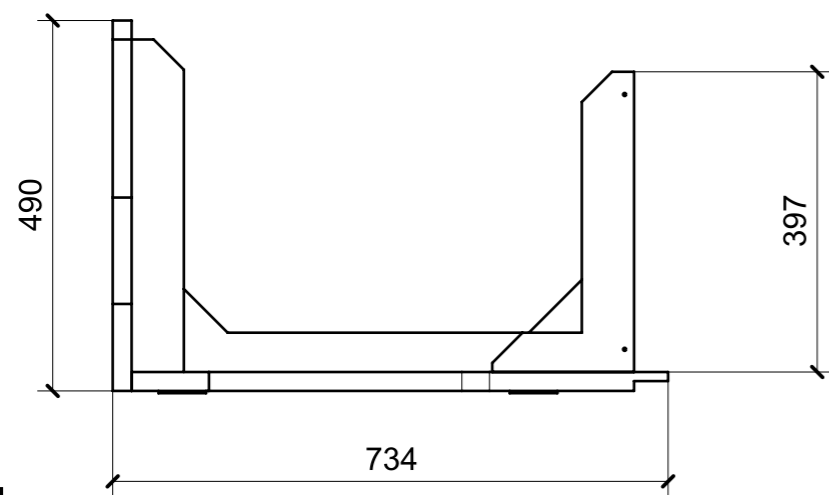
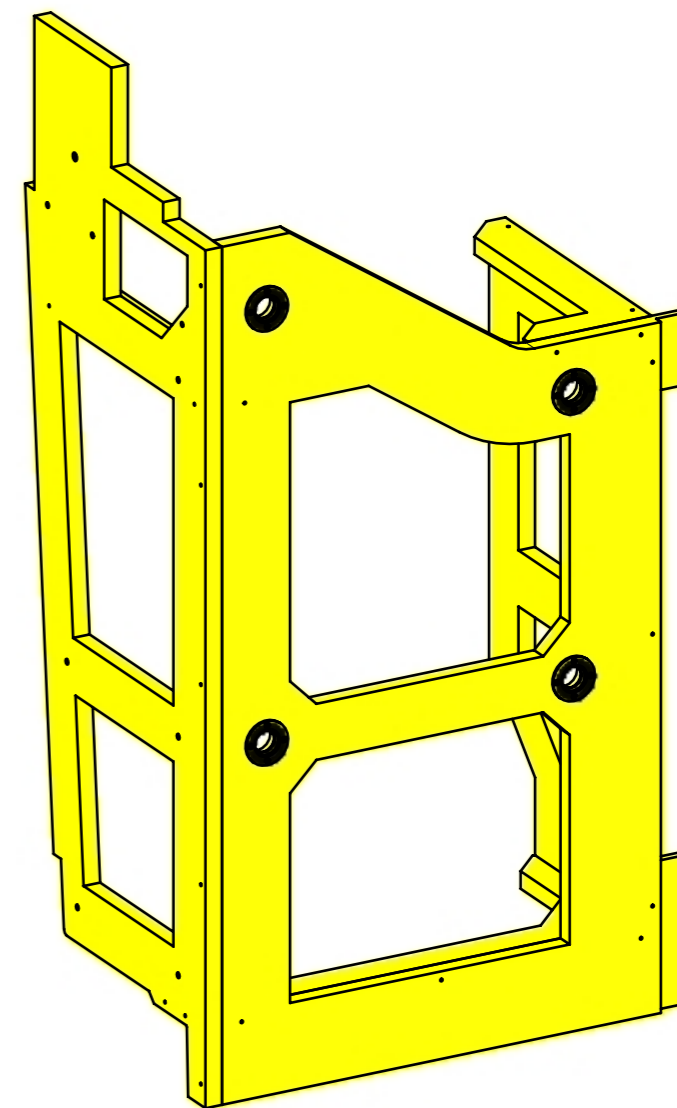
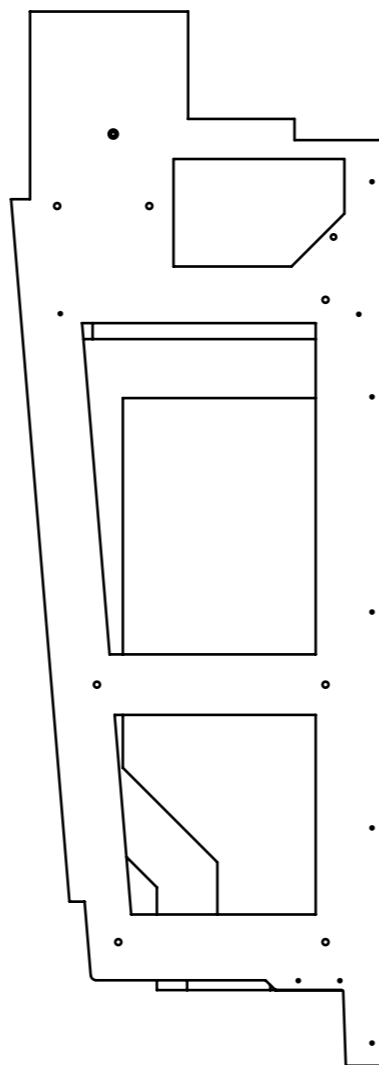
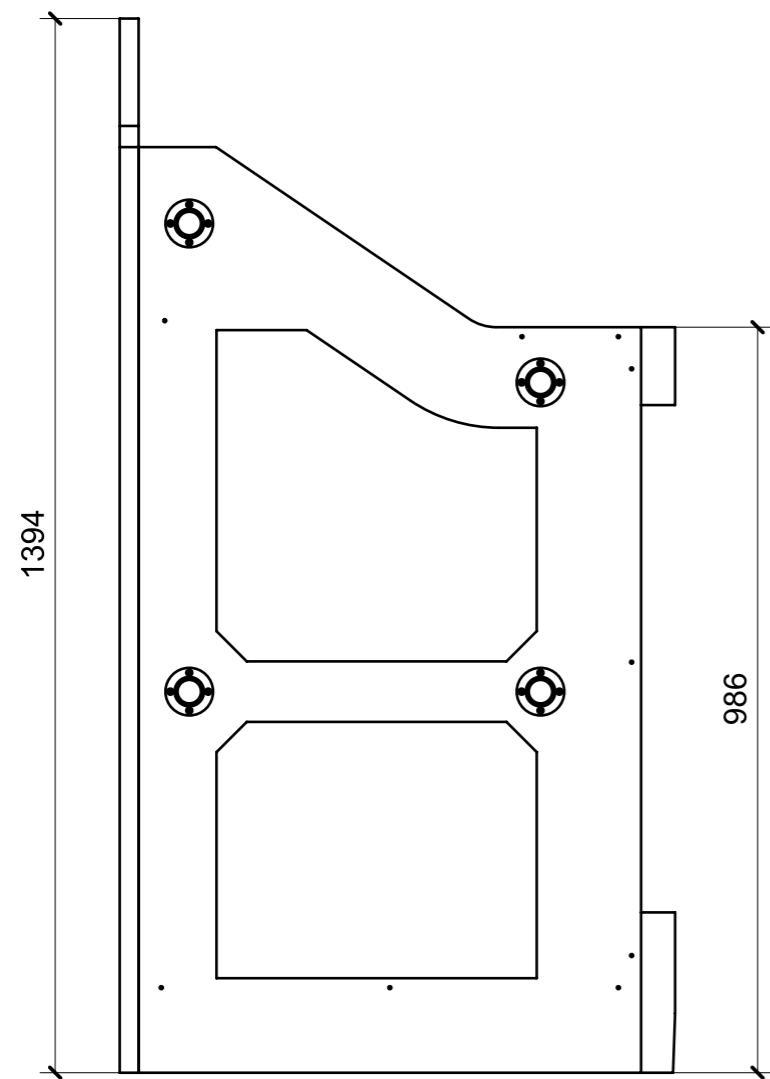

01

FERRAMENTA	QTY
BUSSOLA 6MA X 10 FORO DIAM.8	1
FITLOCK F_MASCHERPA_6020101102	4

LOCALE	CODICE	DESCRIZIONE COMPONENTE	FINITURA	GR.
CABINA ARMATORE	MD321_AM01	STRUTTURA TESTALETTO	OKUME' GREZZO	2

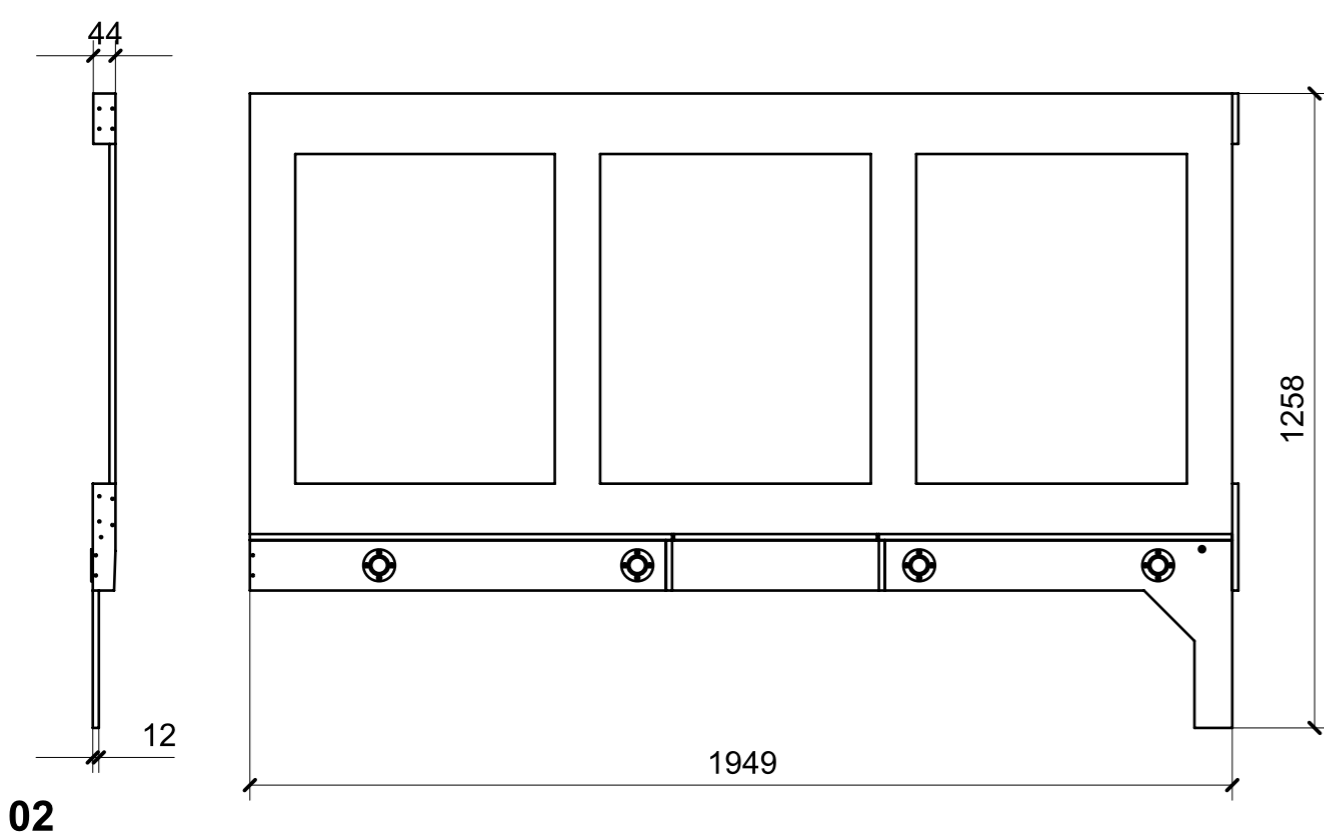
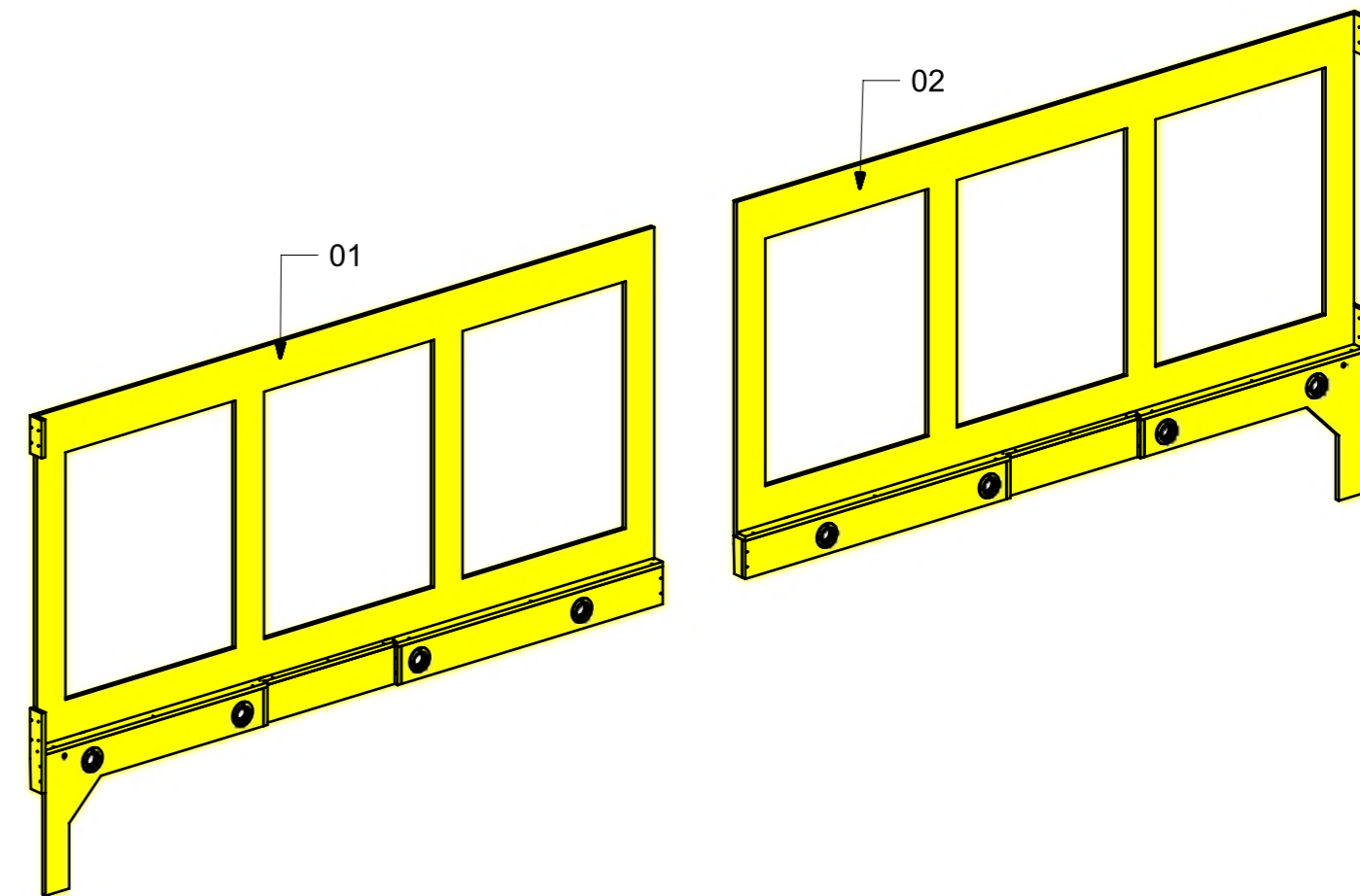
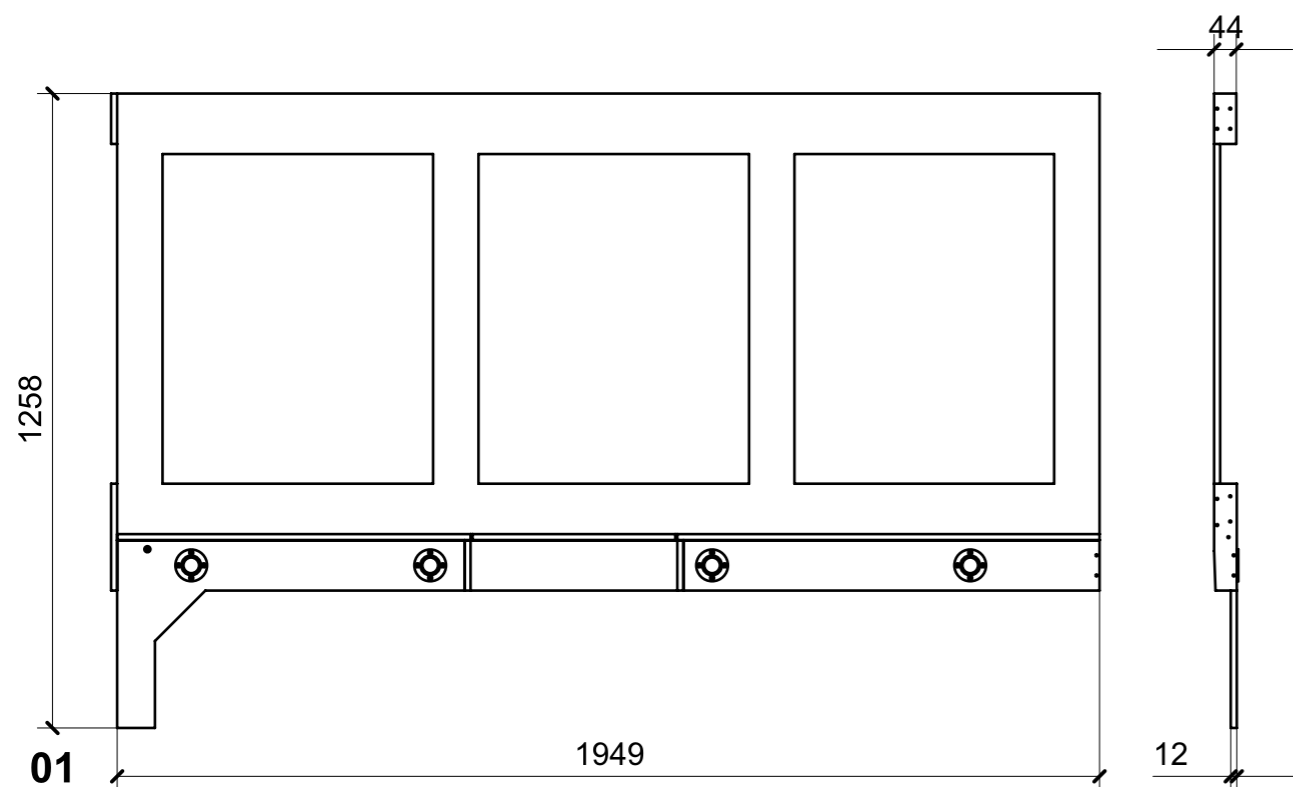

FERRAMENTA	QTY
BUSSOLA 6MA X 10 FORO DIAM.8	2
FITLOCK F_MASCHERPA_6020101102	8

LOCALE	CODICE	DESCRIZIONE COMPONENTE	FINITURA	GR.
CABINA ARMATORE	MD321_AN01	STRUTTURA MURATA SX	OKUME' GREZZO	PTP

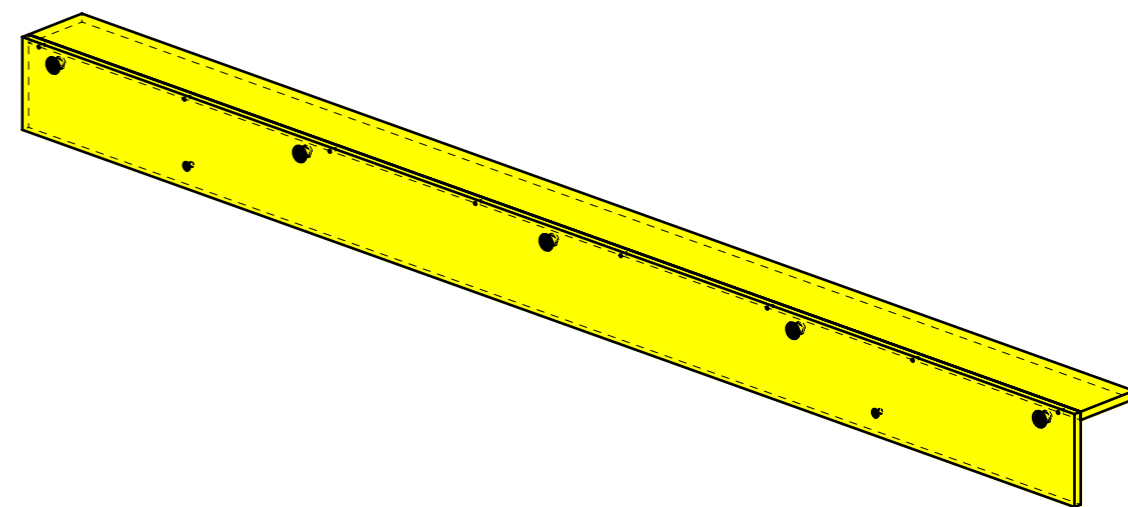
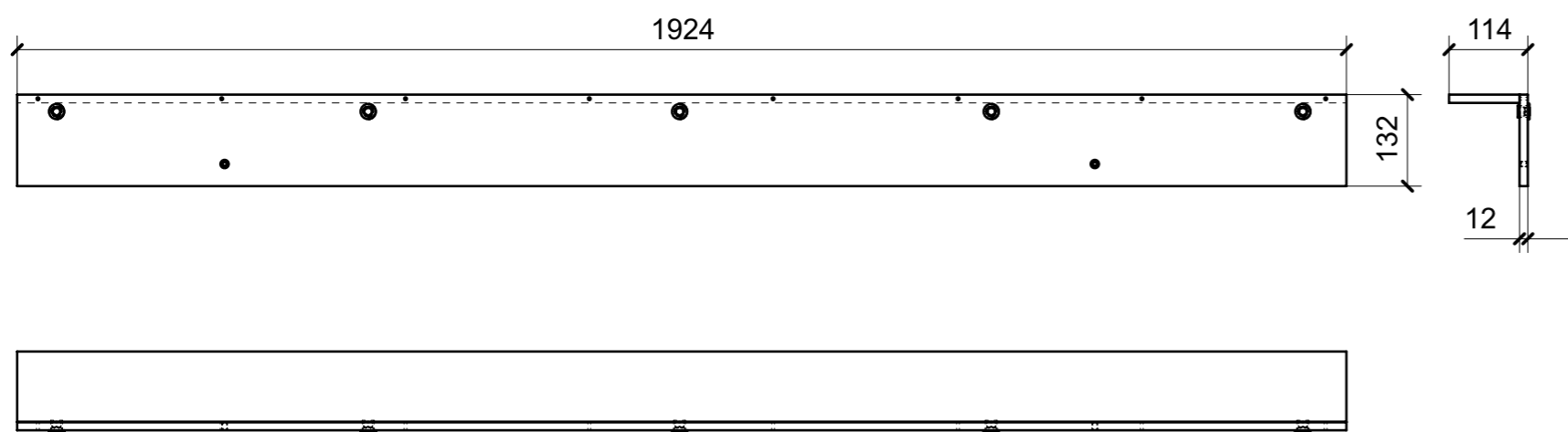

01

FERRAMENTA	QTY
FM INCASSO_ITALVIPLA_973_FMPC_F1A	5
BUSSOLA 6MA X 10 FORO DIAM.8	2

LOCALE	CODICE	DESCRIZIONE COMPONENTE	FINITURA	GR.
CABINA ARMATORE	MD321_AO01	PLENUM	GREZZO VERNICIATO ANTI ROMBO	2

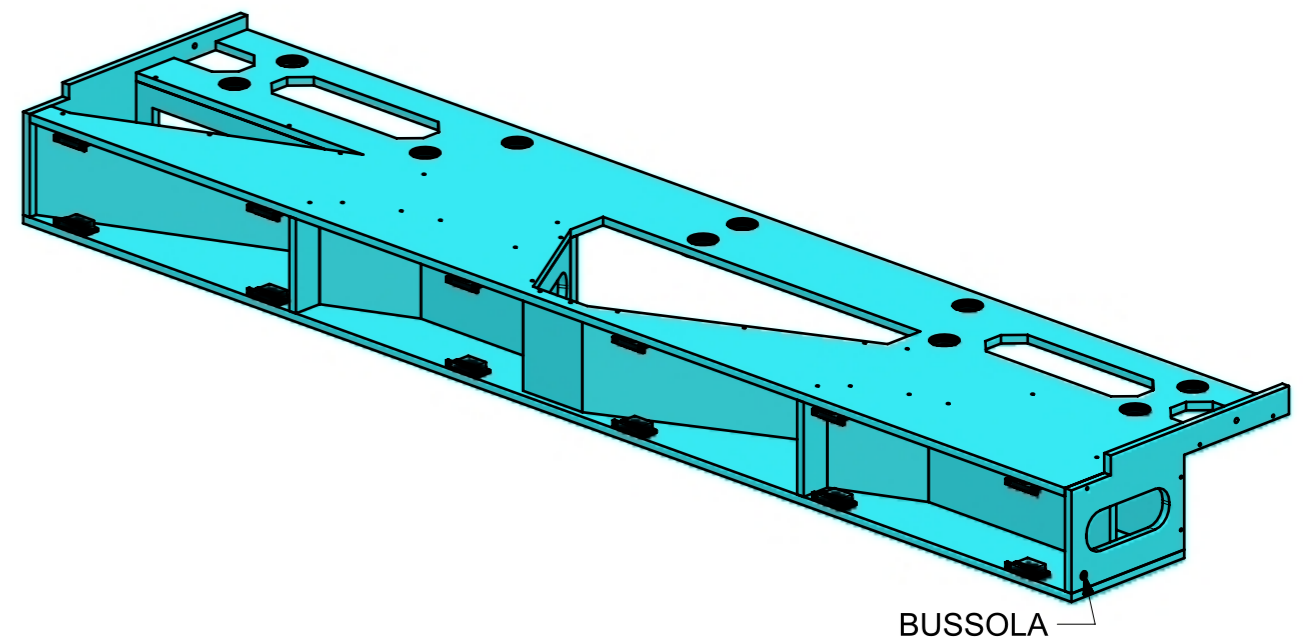
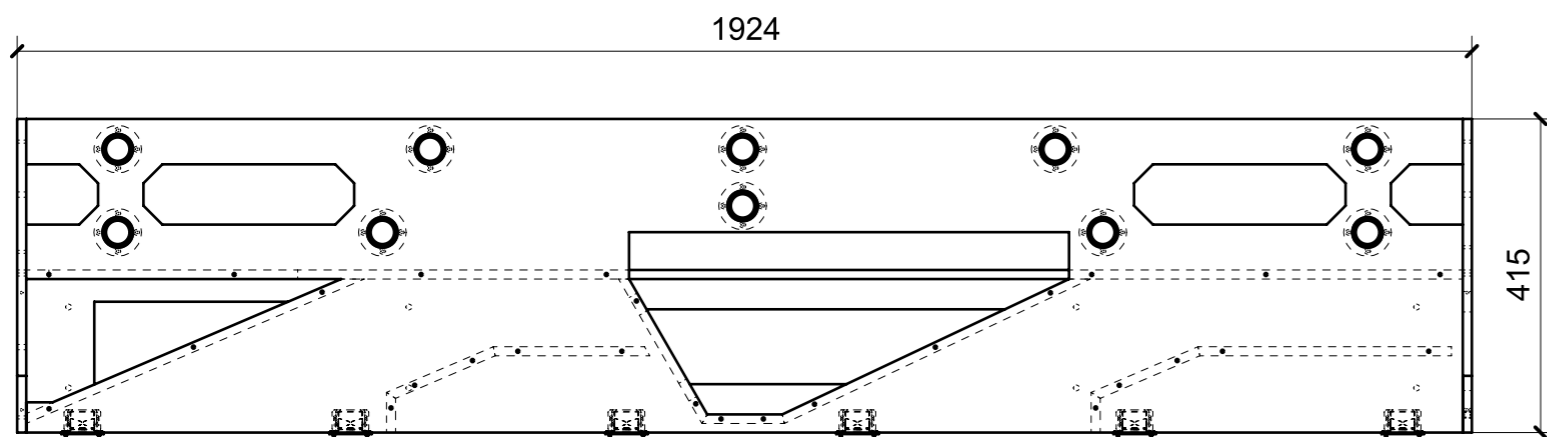
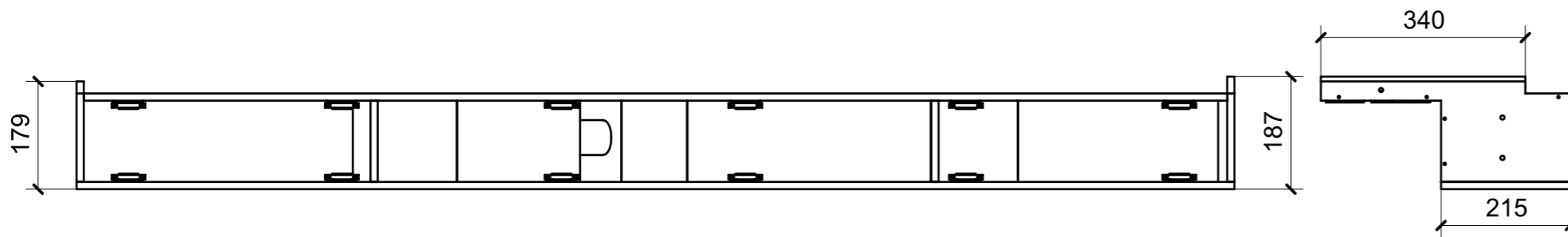

01

FERRAMENTA	QTY
CHIUSURA A SPINTA_TECHNOPARTNER_SOU C3-203	12
BUSSOLA 6MA X 10 FORO DIAM.8	1
FITLOCK F_MASCHERPA_6020101102	10

LOCALE	CODICE	DESCRIZIONE COMPONENTE	FINITURA	GR.
CABINA ARMATORE	MD321_AP01	PANNELLO OBLO' MURATA SX	LAMINATO ABET 411	PTP

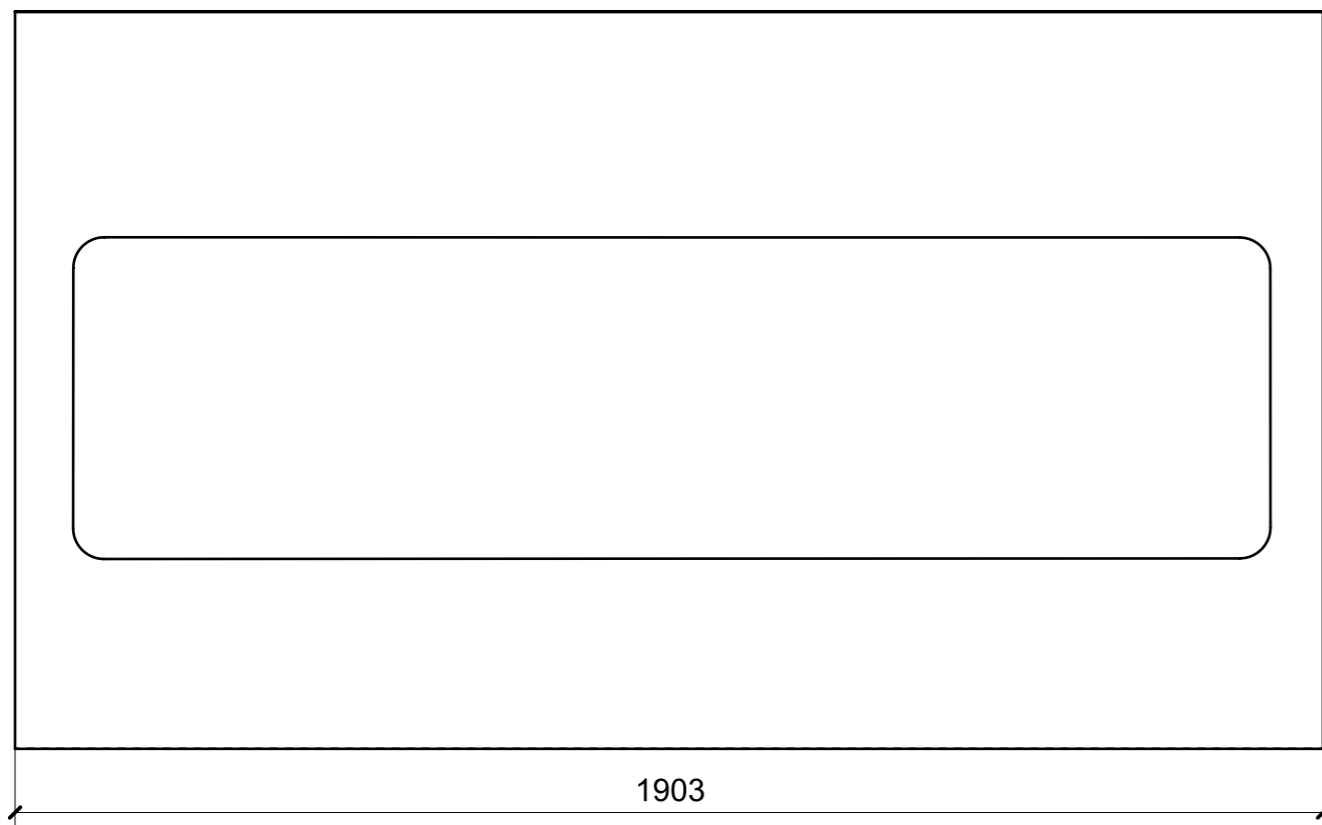

01

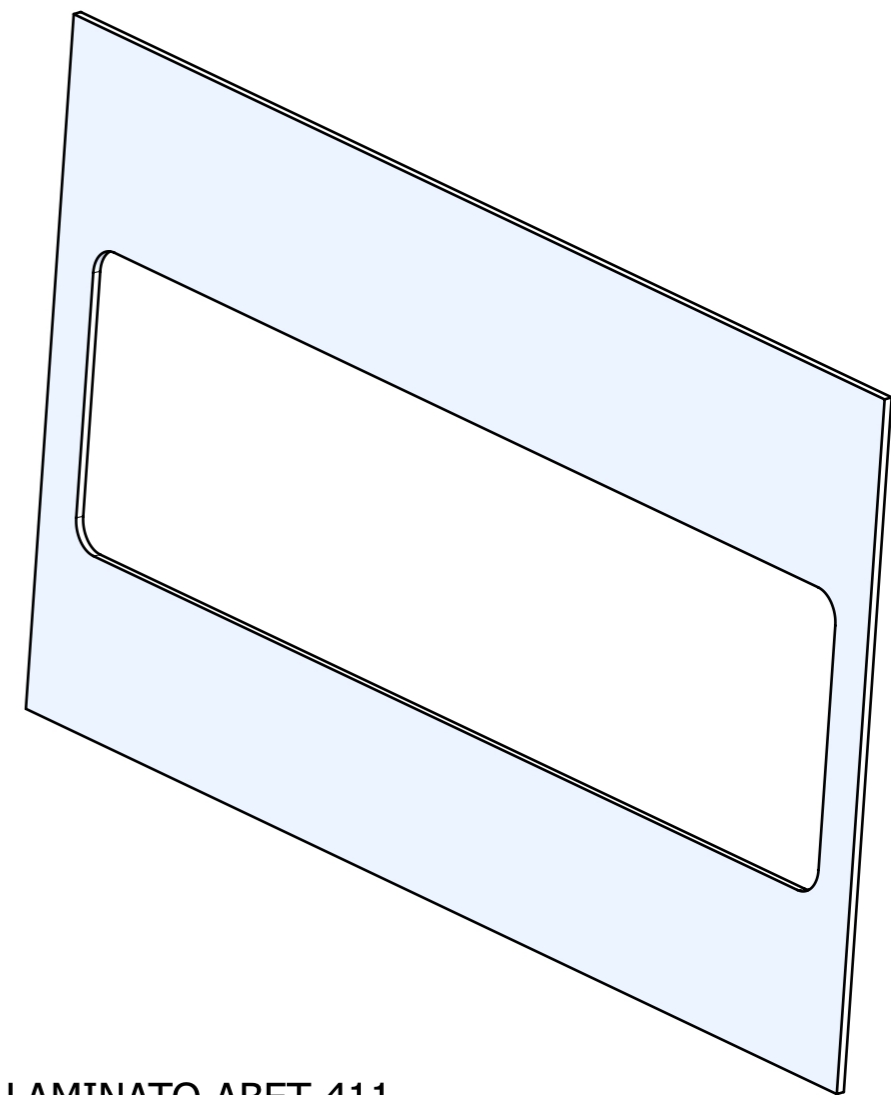
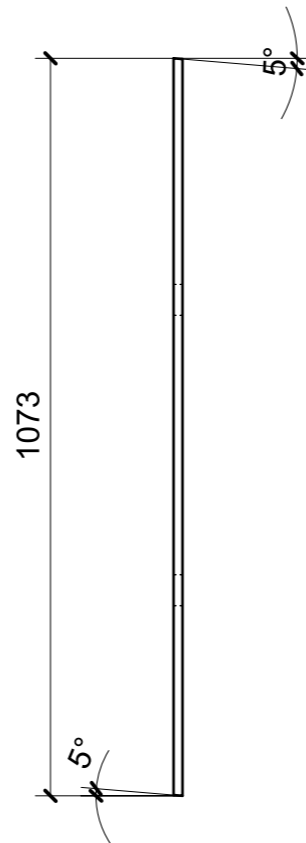

LAMINATO ABET 411

LOCALE	CODICE	DESCRIZIONE COMPONENTE	FINITURA	GR.
CABINA ARMATORE	MD321_AQ01	CASSETTIERA MURATA SX	LAMINATO SM'ART ES04 JUNGLE ANICE	2

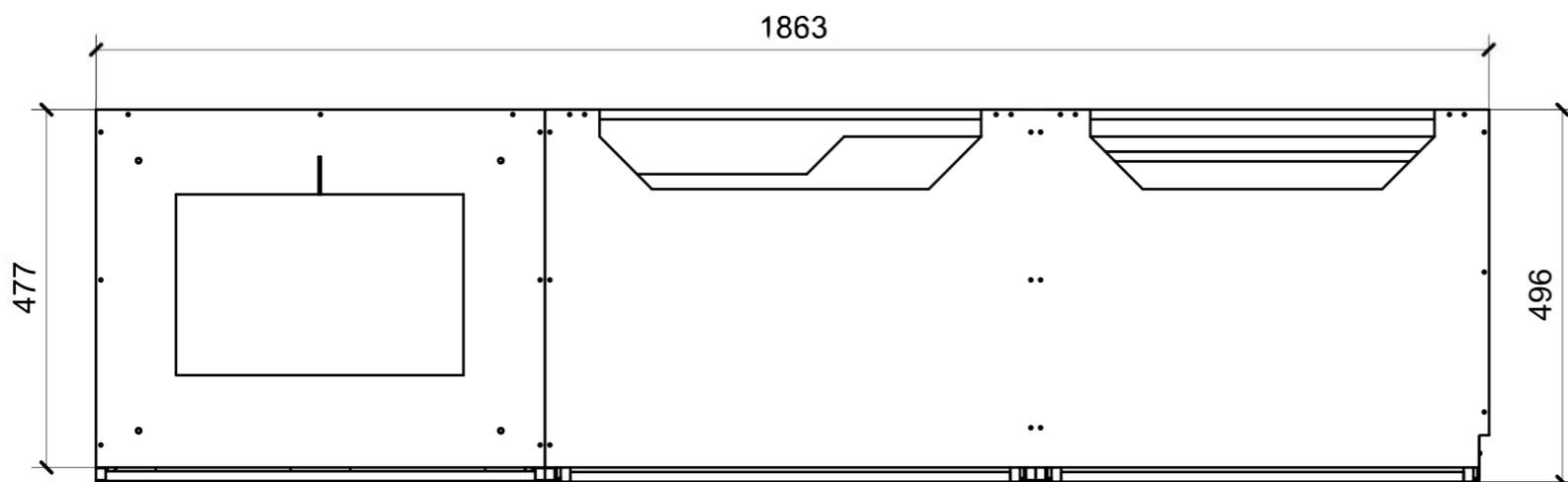
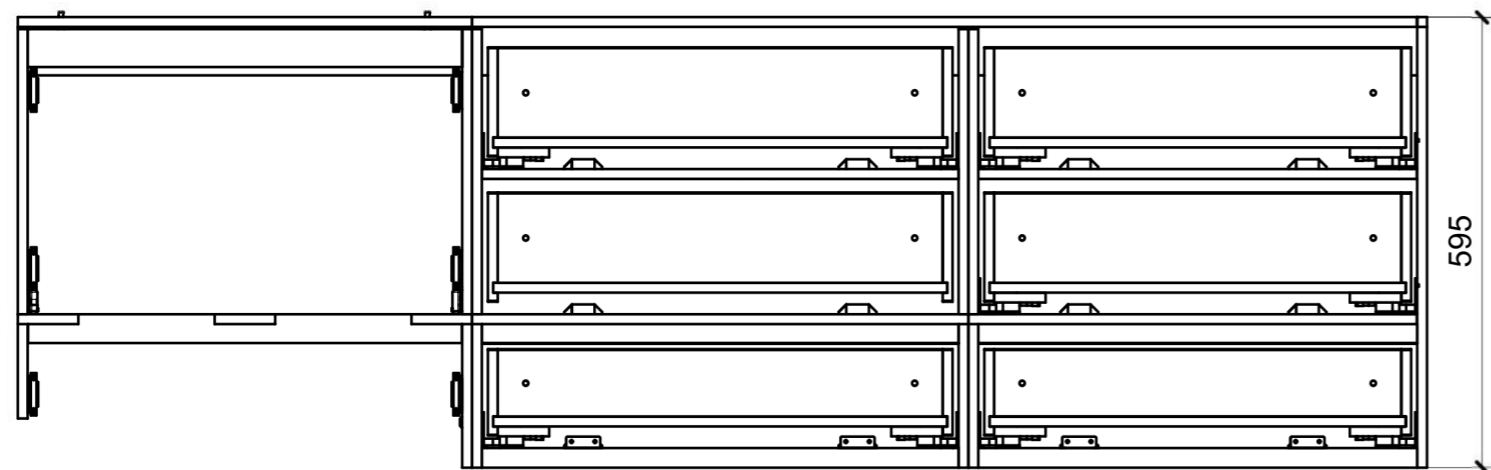

01

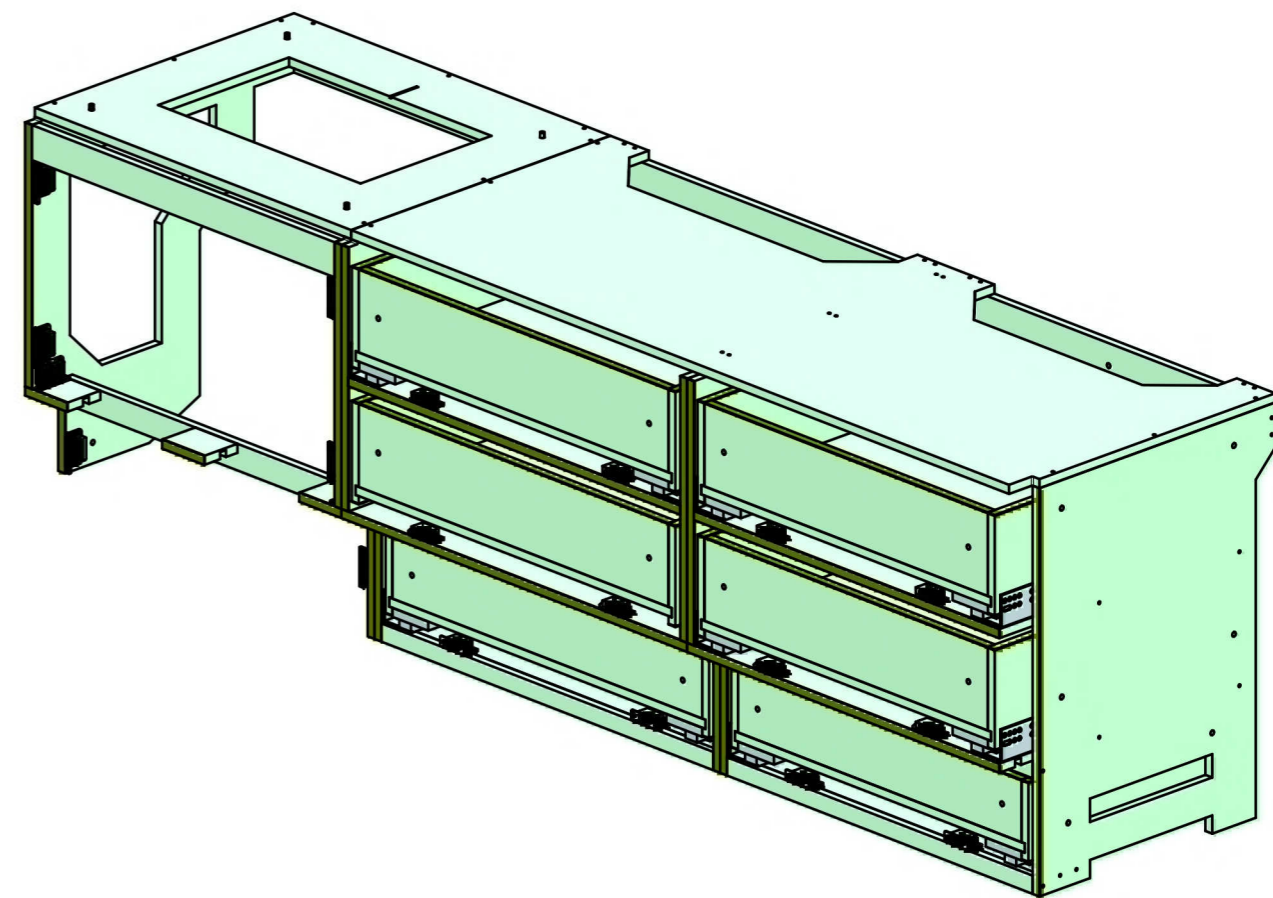

FERRAMENTA	QTY
GUIDA DYNAPRO SOFTCLOSE L300 L_ASSM	1
GUIDA DYNAPRO SOFTCLOSE L300 R_ASSM	1
BUSSOLA 6MA X 10 FORO DIAM.8	4
CALAMITA SEALED MAGNETIC_TECNOPARTNER_MC-JM50-BL	12
CHIUSURA A SPINTA_TECNOPARTNER_SOU C3-203	8
GUIDA DYNAPRO ADJUSTMENT ADAPTER L_FBC_F134141746 4D	5
GUIDA DYNAPRO ADJUSTMENT ADAPTER R_FBC_F134141746 4D	5
GUIDA DYNAPRO FRONT LOCKING DEVICE L_FBC_F134108955 4D	5
GUIDA DYNAPRO FRONT LOCKING DEVICE R_FBC_F134108955 4D	5
GUIDA DYNAPRO SOFTCLOSE L250 L_FBC_F130107790 4D	1
GUIDA DYNAPRO SOFTCLOSE L250 R_FBC_F130107790 4D	1
GUIDA DYNAPRO SOFTCLOSE L350 L_FBC_F130107802 4D	1
GUIDA DYNAPRO SOFTCLOSE L350 R_FBC_F130107802 4D	1
GUIDA DYNAPRO SOFTCLOSE L400 L_FBC_F130107808 4D	1
GUIDA DYNAPRO SOFTCLOSE L400 R_FBC_F130107808 4D	1
GUIDA DYNAPRO SOFTCLOSE L450 L_FBC_F130107814 4D	2
GUIDA DYNAPRO SOFTCLOSE L450 R_FBC_F130107814 4D	2
PLACCHETTA COUNTER STEEL_TECNOPARTNER_MC-JM49	4
VITE 6MA X 20 TESTA BOMBATA	8

LOCALE	CODICE	DESCRIZIONE COMPONENTE	FINITURA	GR.
CABINA ARMATORE	MD321_AT01	RIV. PARETE TV STD VAR.1 43"	OKUME' GREZZO	PTP

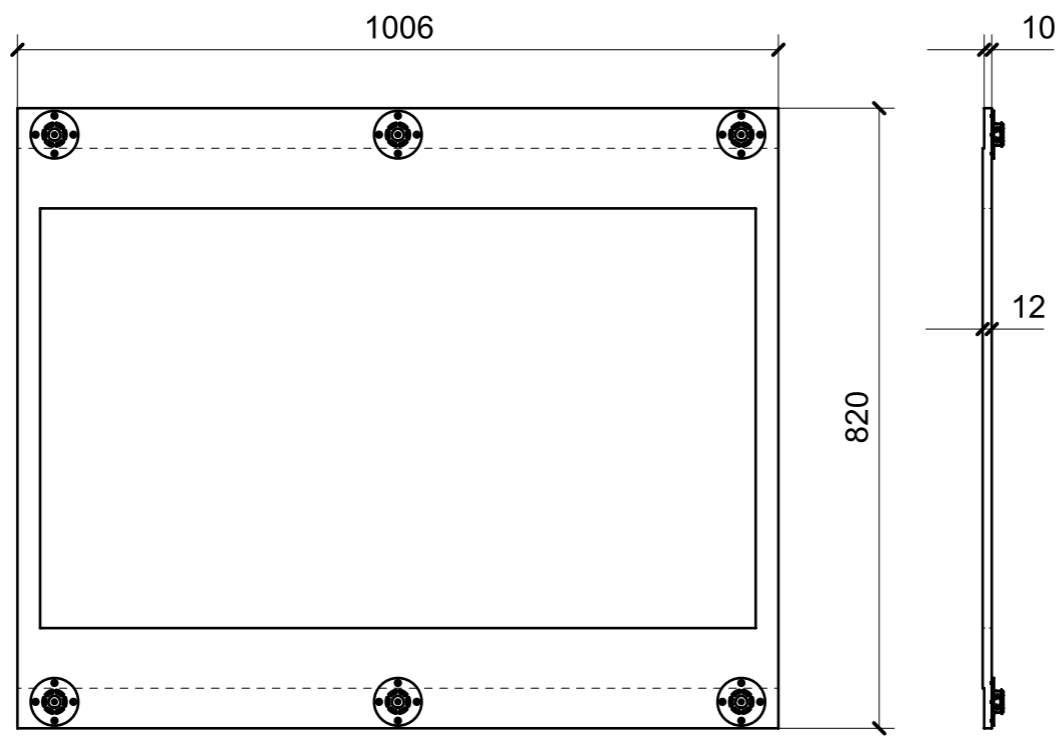

01

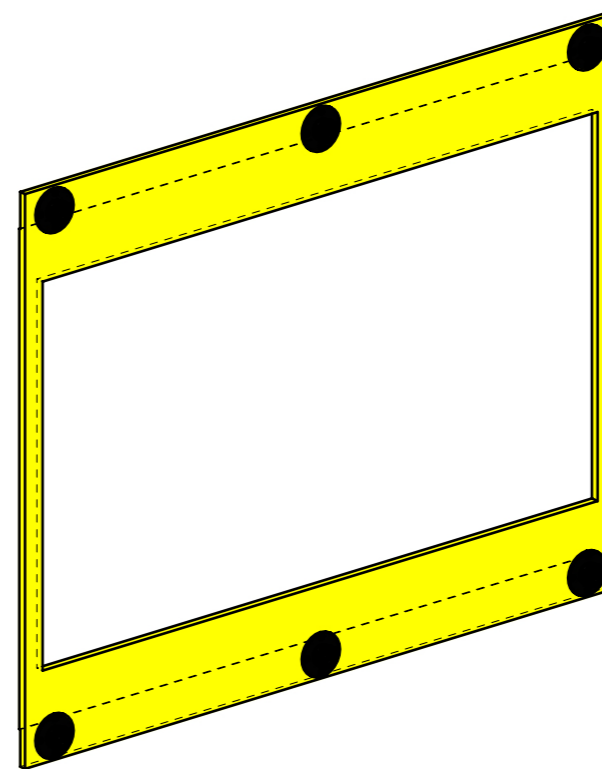

FERRAMENTA	QTY
FITLOCK M_MASCHERPA_3MM_6020202101	6

LOCALE	CODICE	DESCRIZIONE COMPONENTE	FINITURA	GR.
CABINA ARMATORE	MD321_AAE01	SCURETTO CIELINO	LAMINATO SM'ART ES04 JUNGLE ANICE	PTP

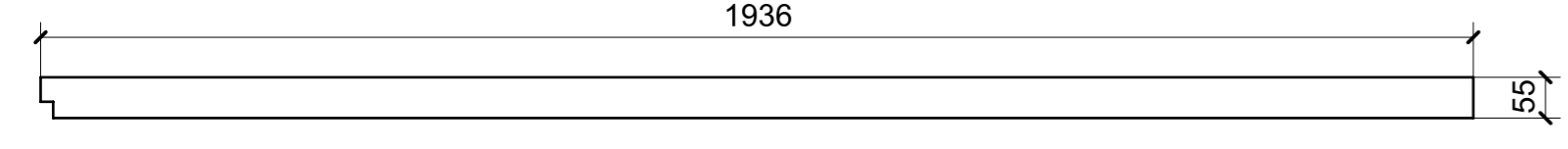
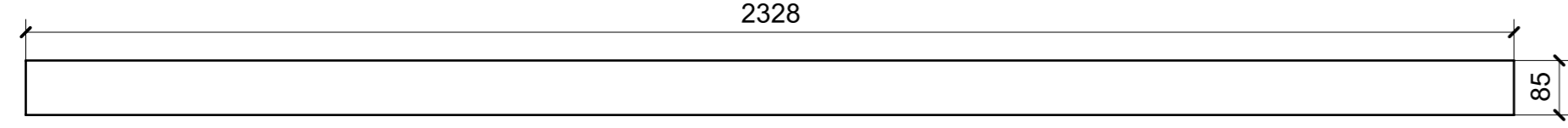
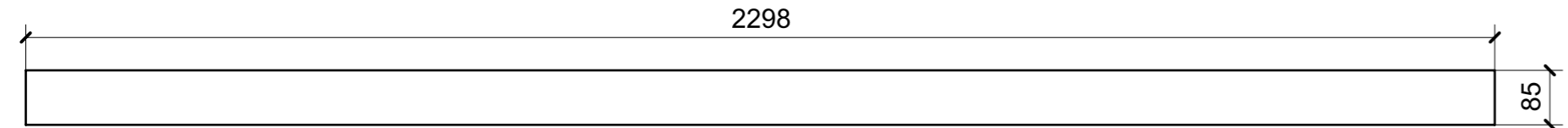
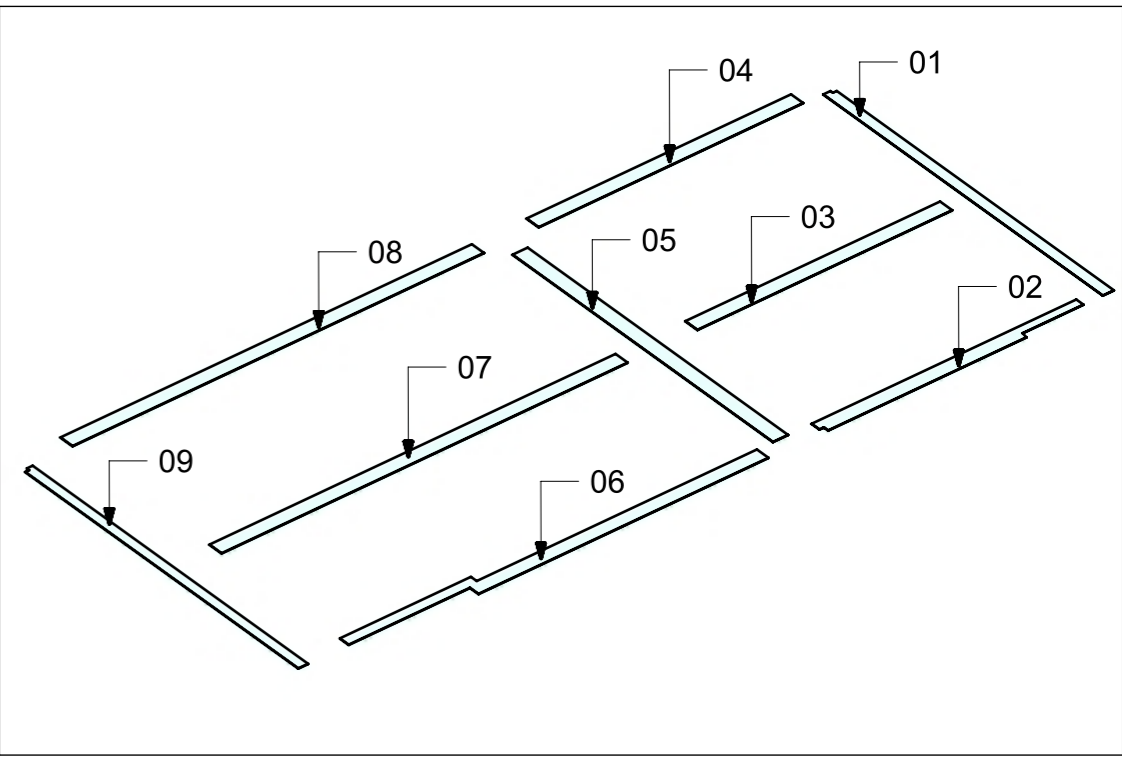
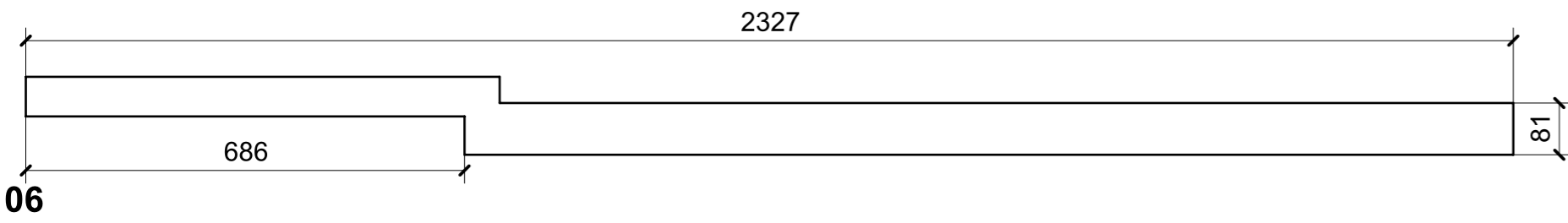
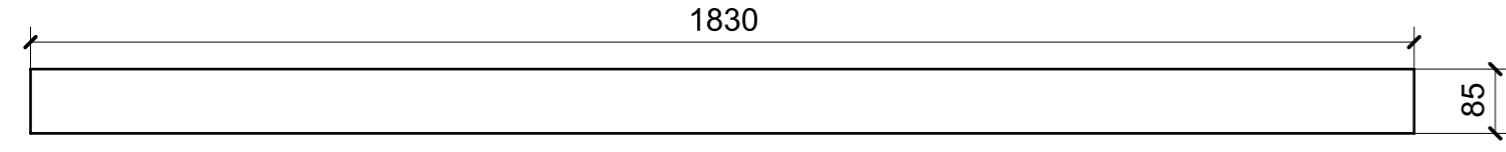
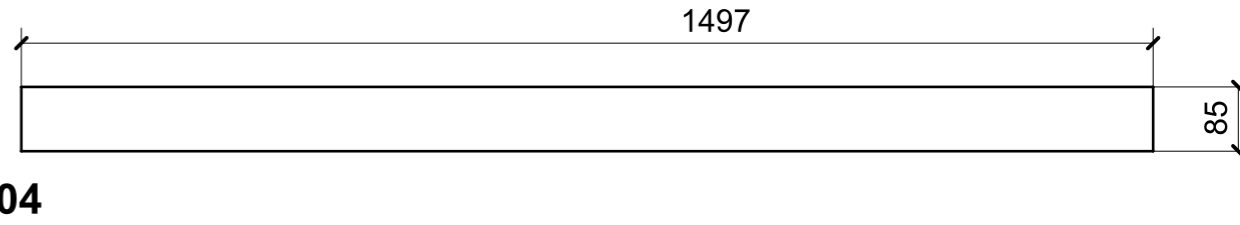
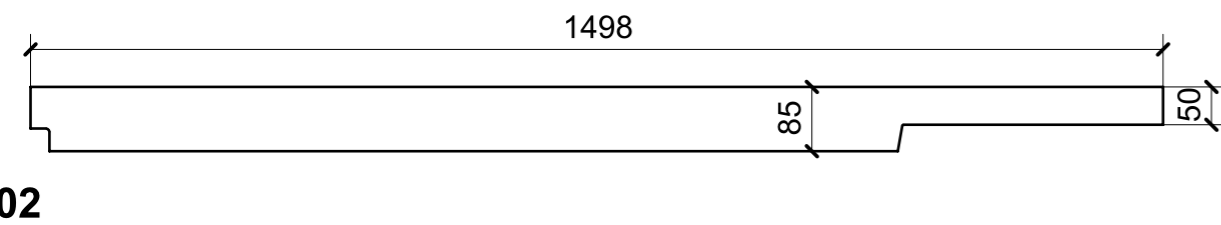
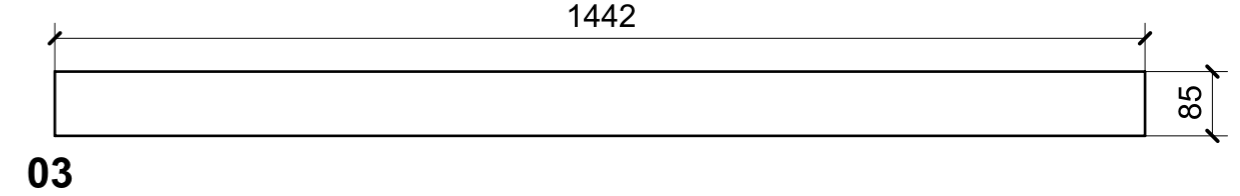
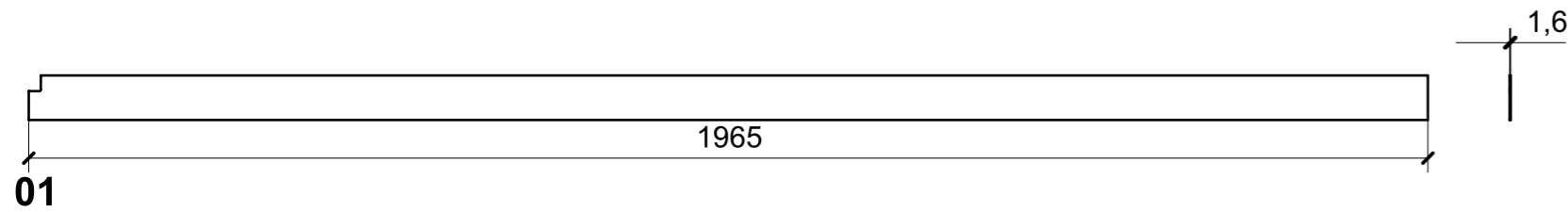

LOCALE	CODICE	DESCRIZIONE COMPONENTE	FINITURA	GR.
CABINA ARMATORE	MD321_AAF01	MOBILE VANITY MURATA DX STD VAR.2	LAMINATO SMART ES04 JUNGLE ANICE	2

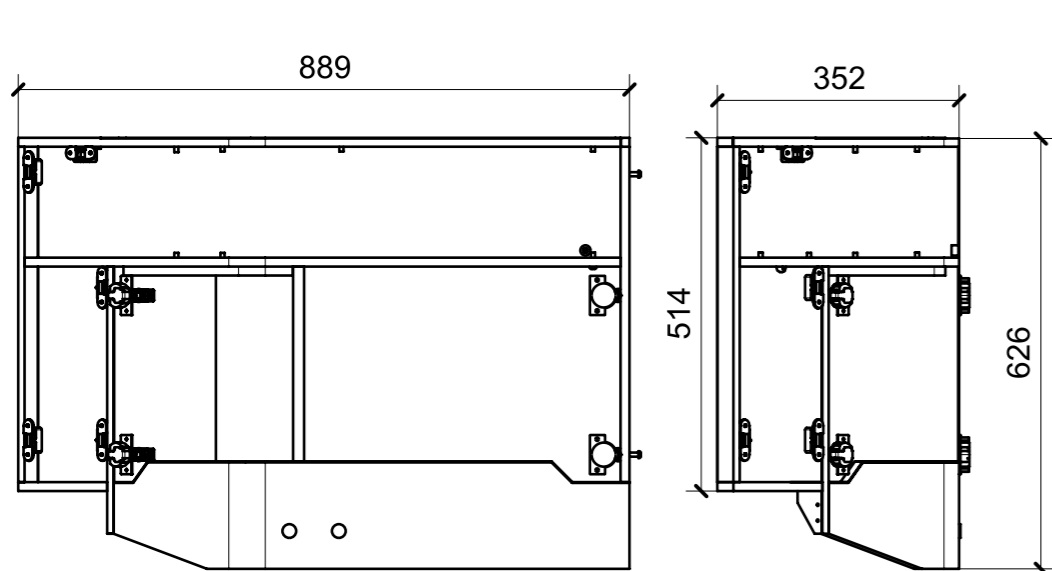

01

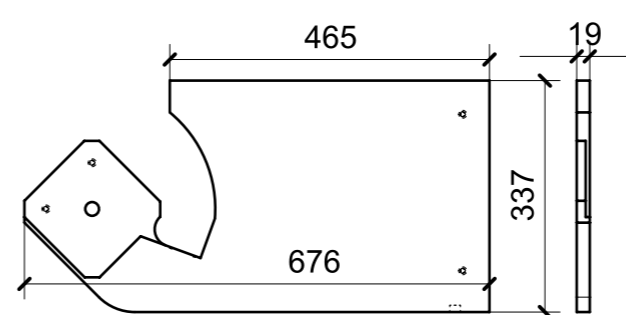

04

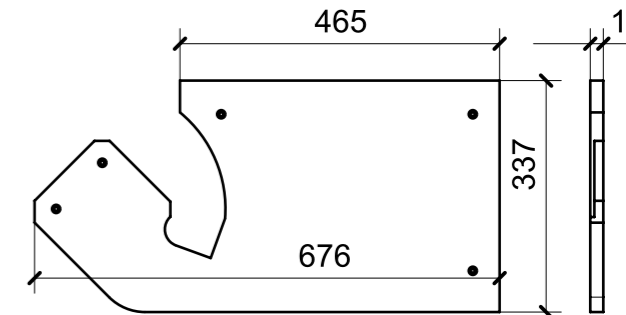

05

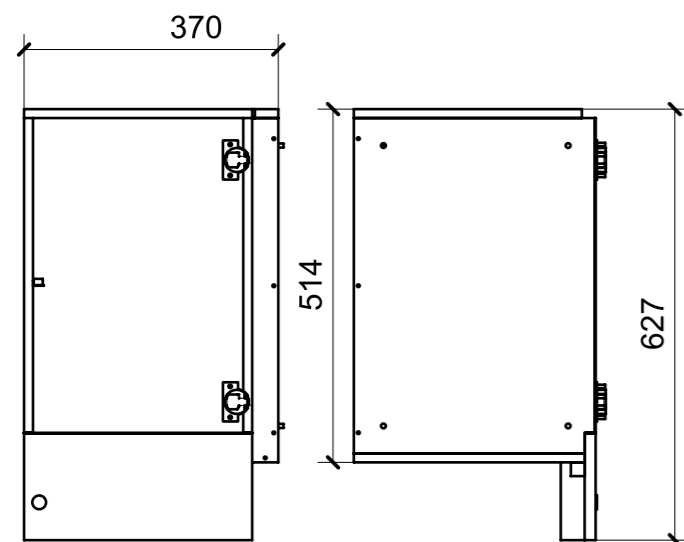
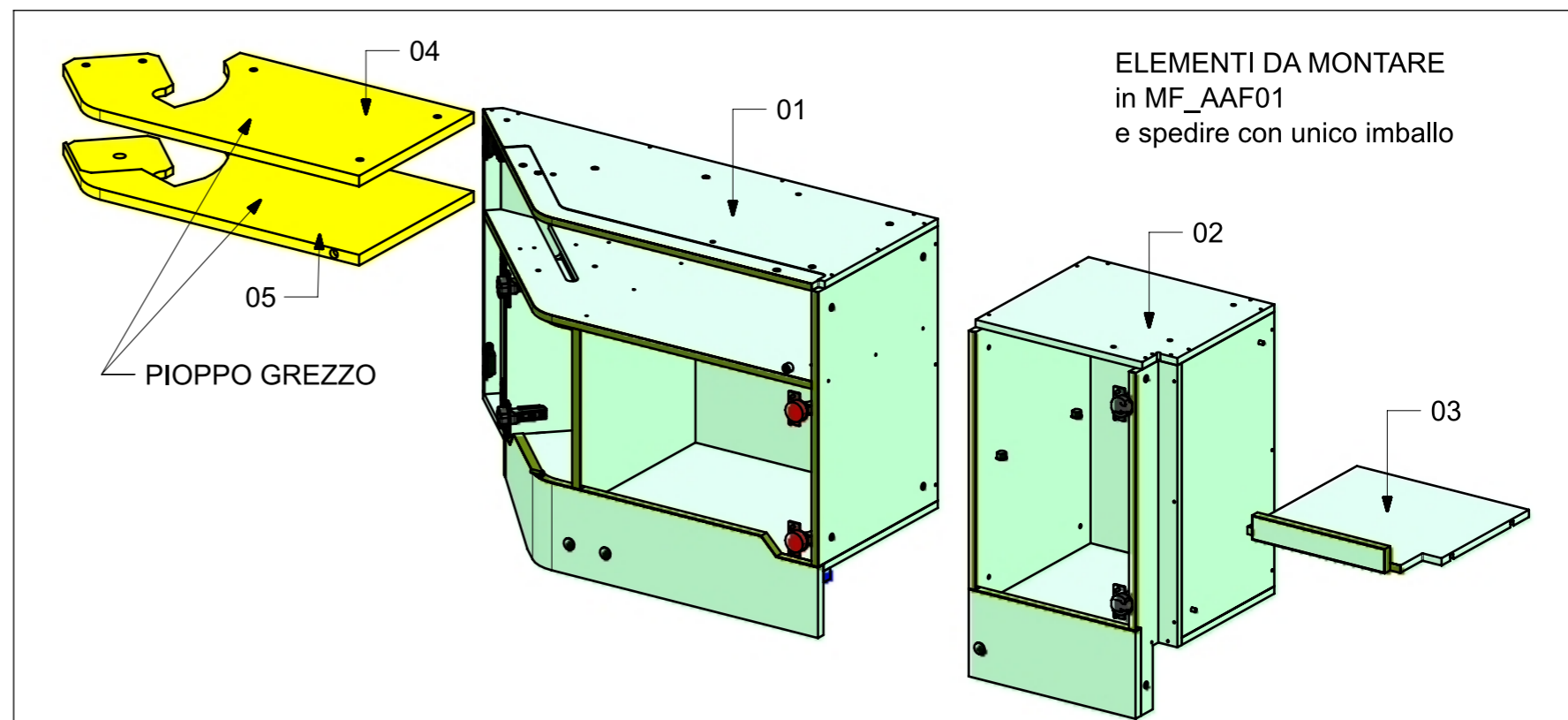

02

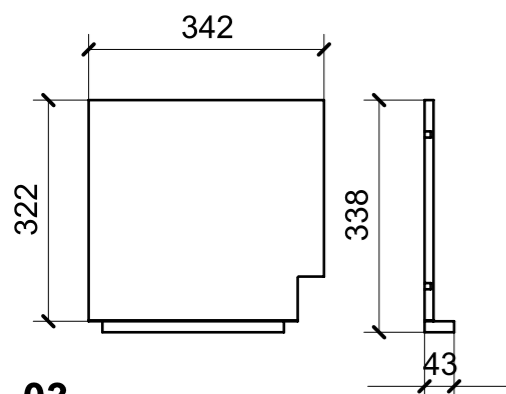

03

FERRAMENTA	QTY
MAGNETE_TONDO_AL_NEODIMIO M_F_FOR_377_15X10_BORGHII	1
RISCONTRO IN FERRO PER CALAMITA TONDO	3
BASE_0-NERA_HAFELE_342.22.065-BLUM_175H3100.STP	2
BASE_3-NERA_HAFELE_342.22.067-BLUM_175H3130.STP	4
BUSSOLA 5MA ANKOR BORGHI	4
BUSSOLA 5MA ANKOR BORGHI X BASE 0	8
BUSSOLA 6MA X 10 FORO DIAM.8	17
CERNIERA 94°_MEZZO COLLO-NERA_HAFELE_342.46.605-BLUM_71B9650	2
CERNIERA 94°_PIANA-NERA_HAFELE_342.46.604-BLUM_71B9550.STP	2
CERNIERA 95°_COLLO PIENO-NERA_HAFELE_342.46.606-BLUM_71B9750.STP	2
FITLOCK KU	5
GIUNTO REGGIRIPIANO CON BORDO ANTISGANCIIO_FBC BORGHI_1033XXB060902	4
MD321_AAF01_03	1
PERNO LISCIO PER SPALLA_FBC BORGHI_1033PXX050531	4
VITE 4MAX8 ANKOR BORGHI	4
VITE 4MAX8 ANKOR BORGHI X BASE 0	8
VITE 6MA X 20 TESTA SVASATA_FBC	9
VITE 6MA X 20 TESTA BOMBATA NERA BHCS 00317092	8

LOCALE	CODICE	DESCRIZIONE COMPONENTE	FINITURA	GR.
CABINA ARMATORE	MD321_AA01	OPT CASSAFORTE	LAMINATO SMART ES04 JUNGLE ANICE	PTP

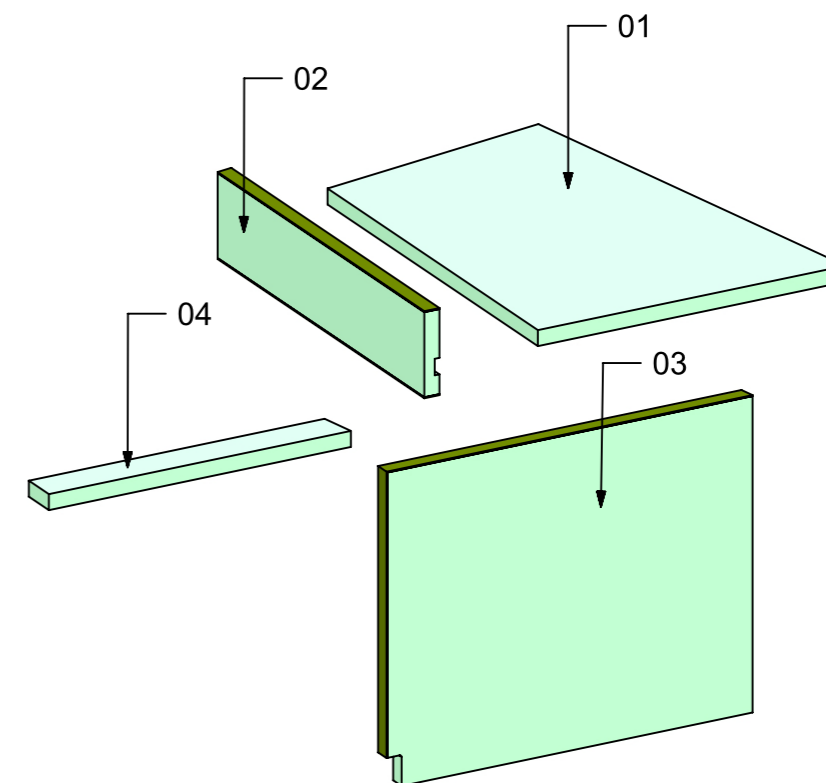
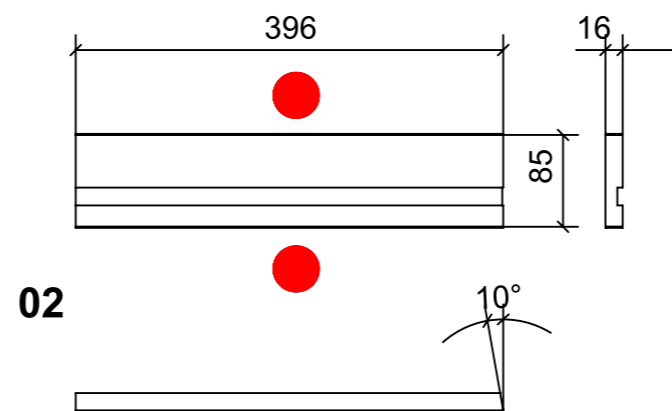
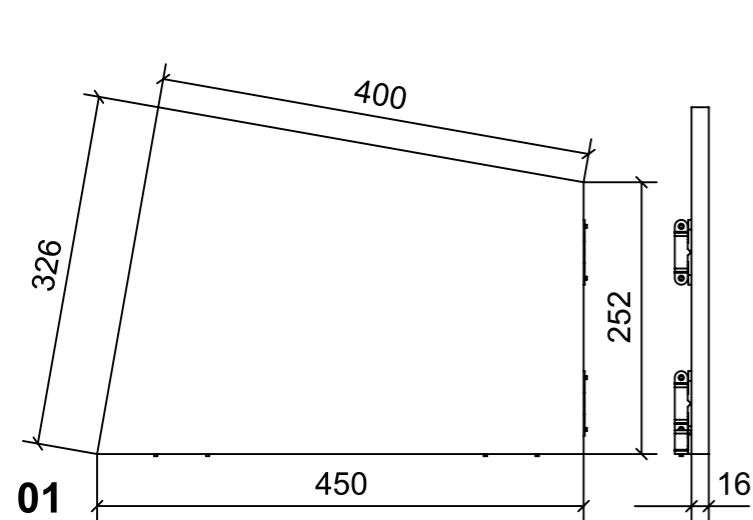

FERRAMENTA	QTY
FITLOCK KU	4

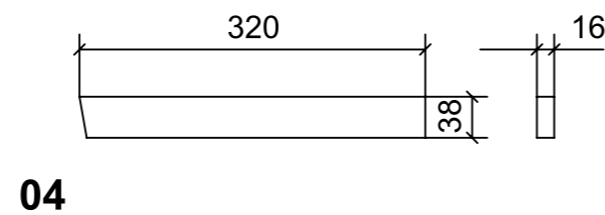
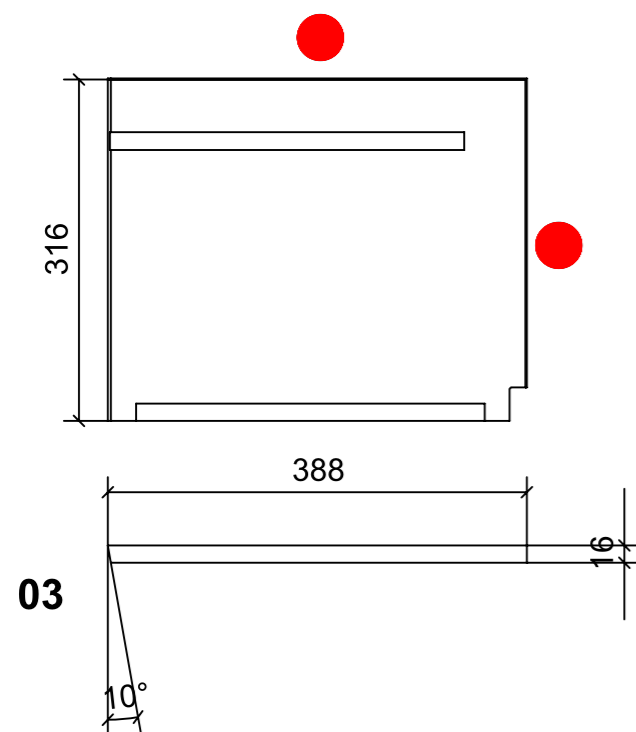

LOCALE	CODICE	DESCRIZIONE COMPONENTE	FINITURA	GR.
CABINA ARMATORE	MD321_AAI01	OPT AUDIO VIDEO	OKUME' GREZZO	PTP

