

LOCALE	CODICE	DESCRIZIONE COMPONENTE	FINITURA	GR.
BAGNO OSPITI SX	MD320_R02_YA01	STRUTTURA PENSILE A MURATA	LASTRA CHIARA	4

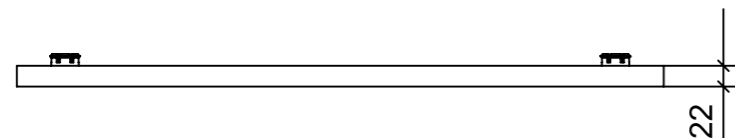

01

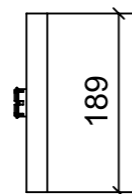
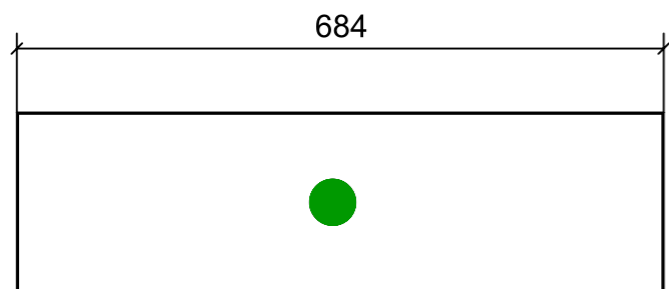
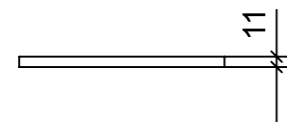
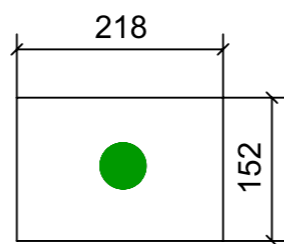
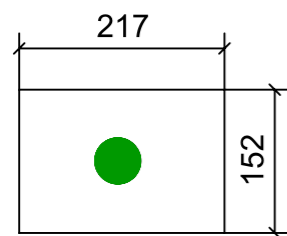

02

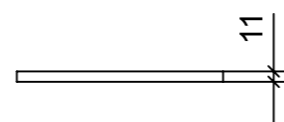

03

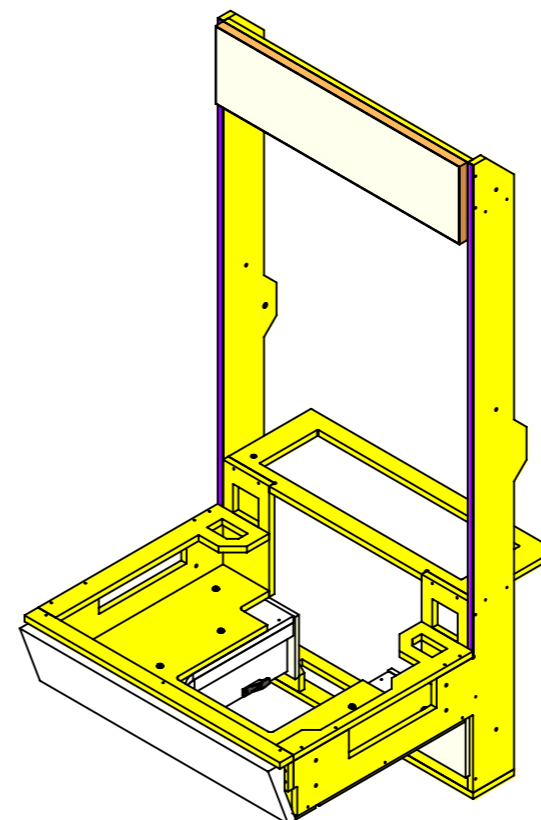

ELEMENTI DA MONTARE  
in MF\_YA01  
e spedire con unico imballo

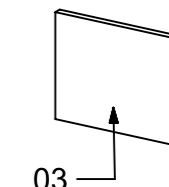
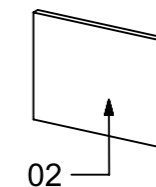
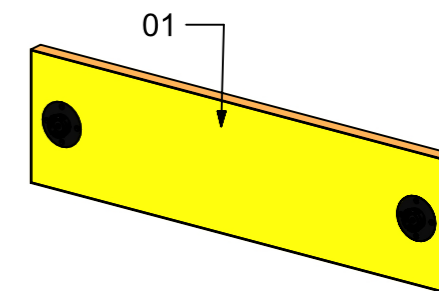

FERRAMENTA	QTY
FITLOCK M_MASCHERPA_3MM_6020202101	2

VERNICIATURA LASTRA/LACCATI:

● = VERNICIARE 1 LATO + FILI RASATI O BORDATI

NESSUN SIMBOLO = VERNICIARE 2 LATI + FILI RASATI O BORDATI

LOCALE	CODICE	DESCRIZIONE COMPONENTE	FINITURA	GR.
BAGNO OSPITI SX	MD320_R02_YB01	PENSILE A MURATA	LASTRA CHIARA	4

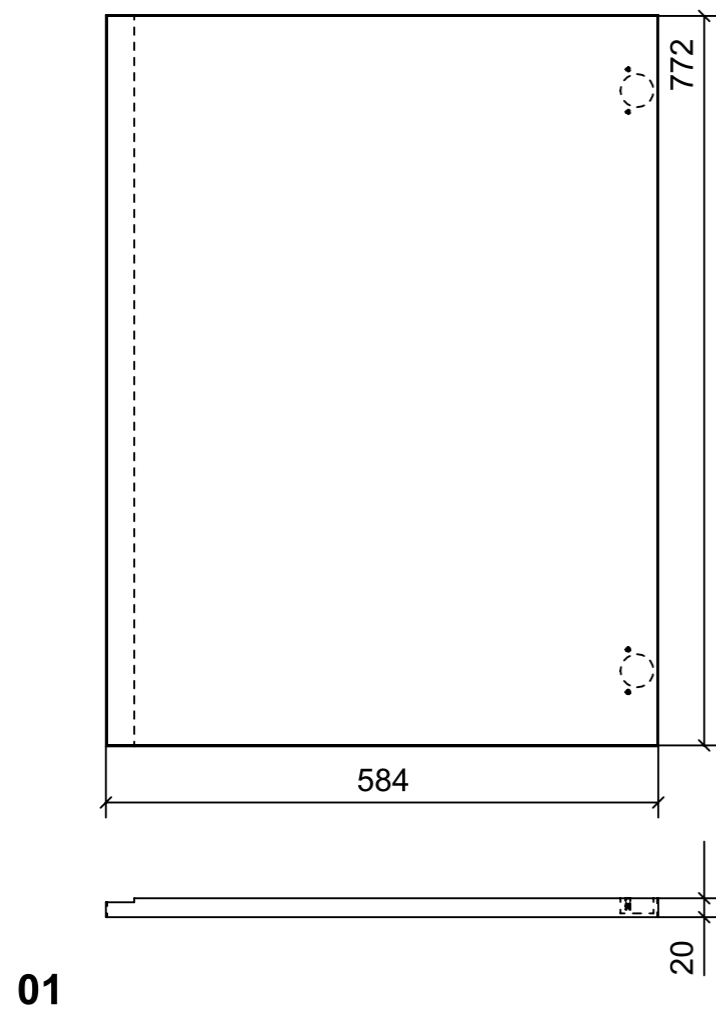

01

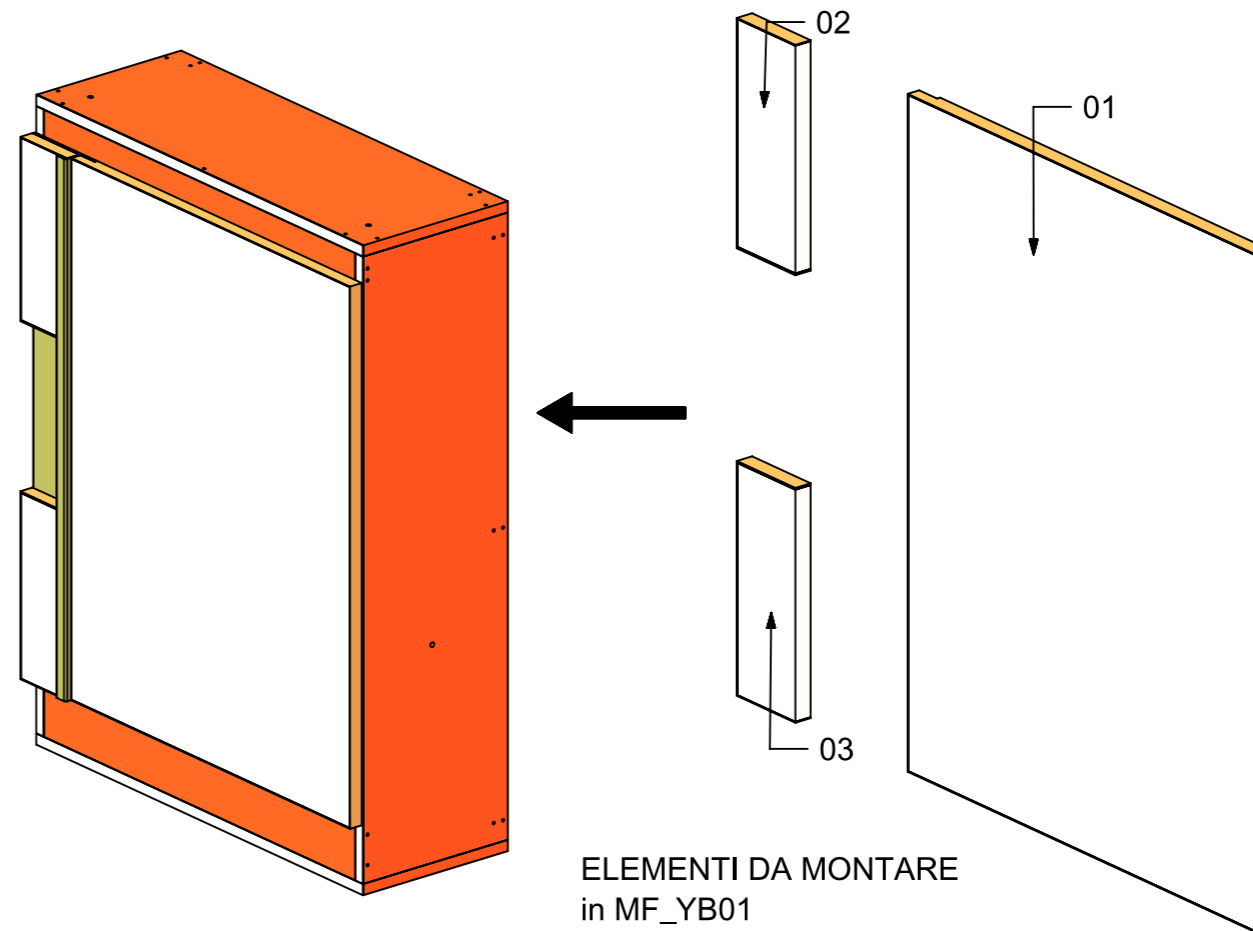

ELEMENTI DA MONTARE  
in MF\_YB01  
e spedire con unico imballo

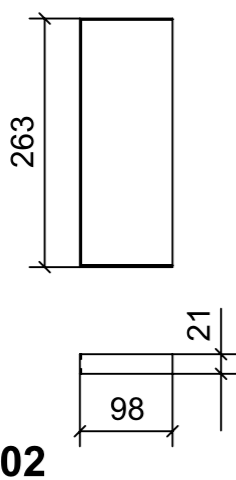

02

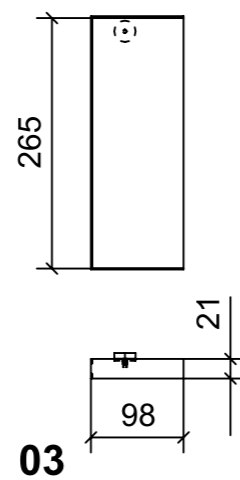

03

FERRAMENTA	QTY
MAGNETE FORZA MAGNETICA1-5 10KG_HAFELE_246.87.112	1
BUSSOLA 5MA ANKOR BORGHI X CERNIERA PIANA	4

VERNICIATURA LASTRA/LACCATI:

● = FILI RASATI

● = VERNICIARE 1 LATO + FILI RASATI O BORDATI

NESSUN SIMBOLO = VERNICIARE 2 LATI + FILI RASATI O BORDATI

LOCALE	CODICE	DESCRIZIONE COMPONENTE	FINITURA	GR.
BAGNO OSPITI SX	MD320_R02_YC01	RIVESTIMENTI ZONA LAVELLO	LASTRA CHIARA	3

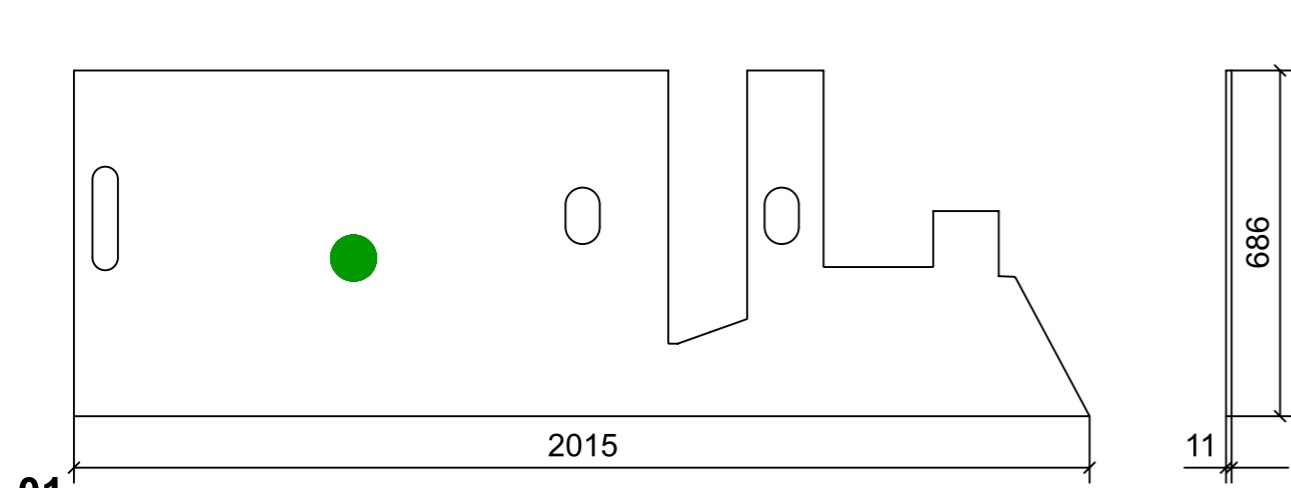

**01 UNICO PEZZO DA MONTARE**

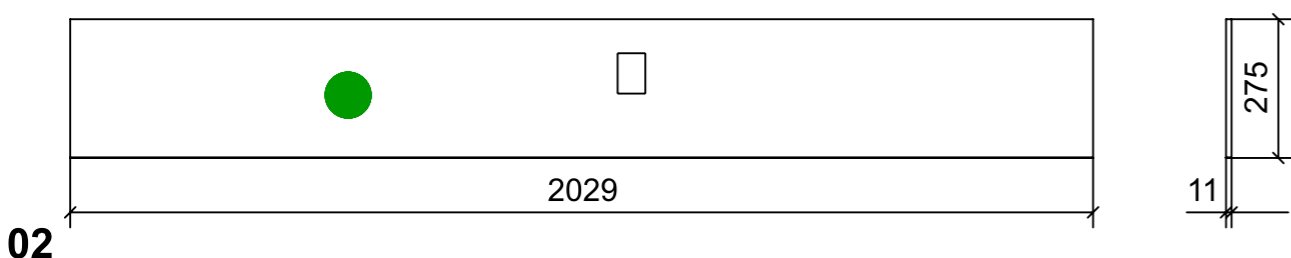
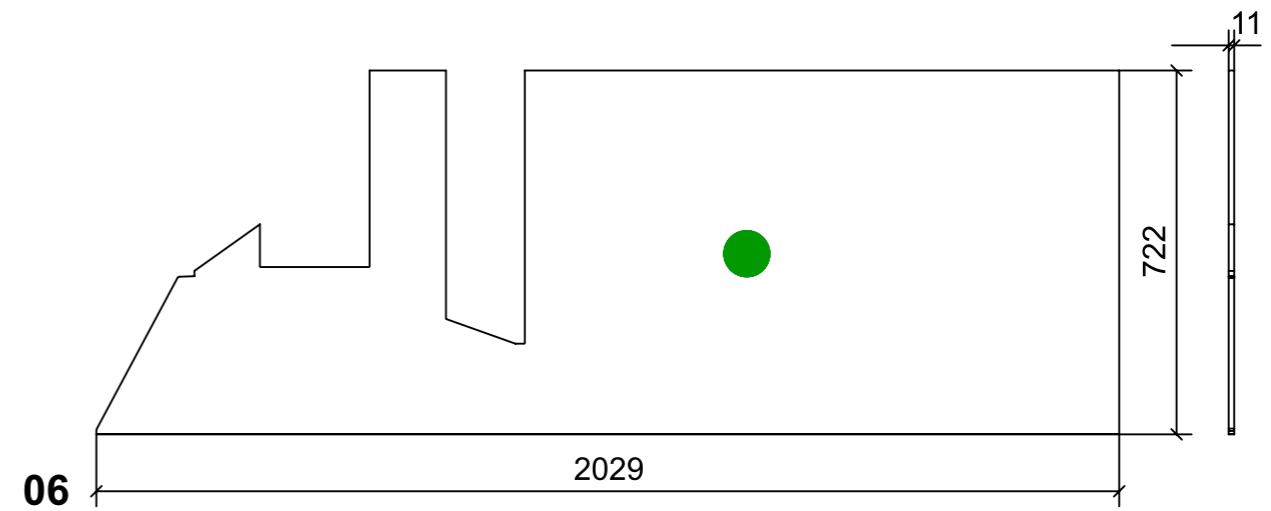

**02**

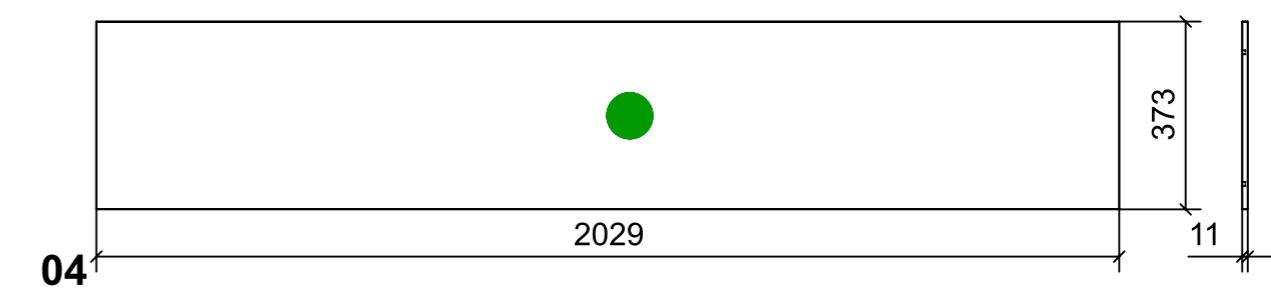

**04**

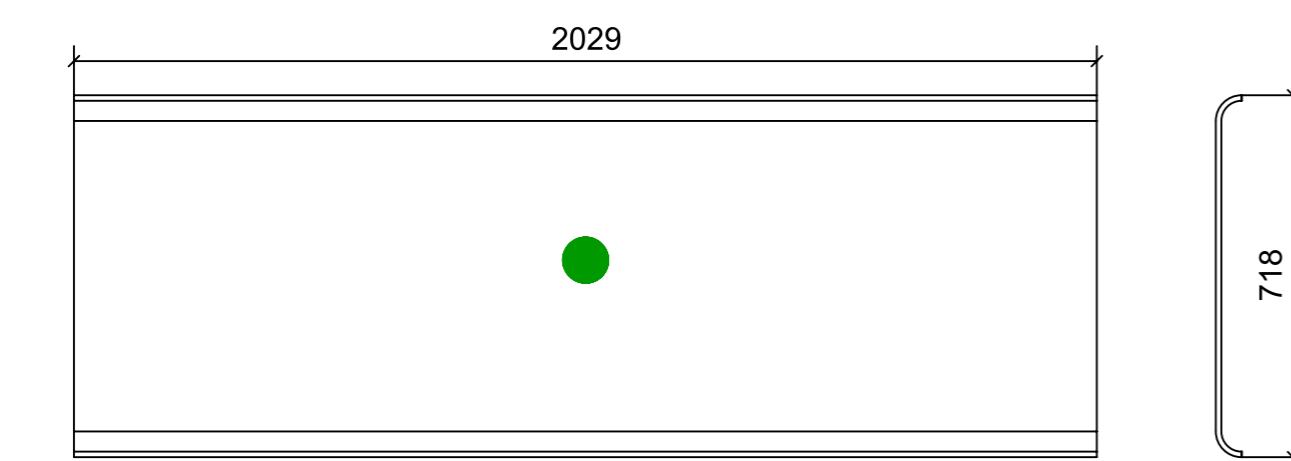

**03**

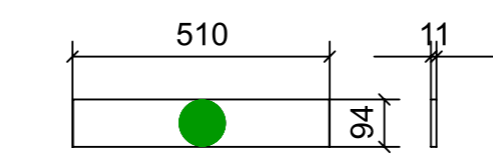

**05**

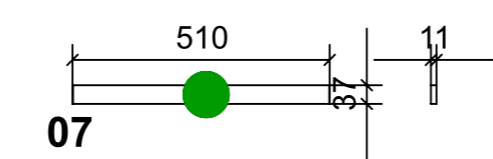

**07**

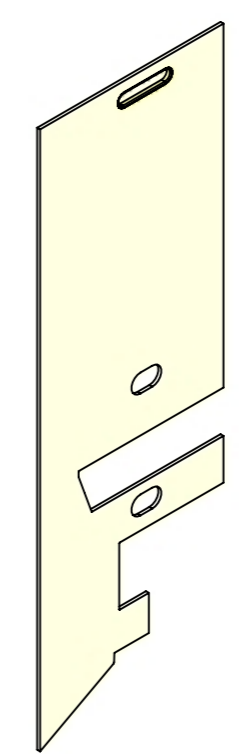

ELEMENTI DA MONTARE  
in MF\_YC01  
e spedire con unico imballo

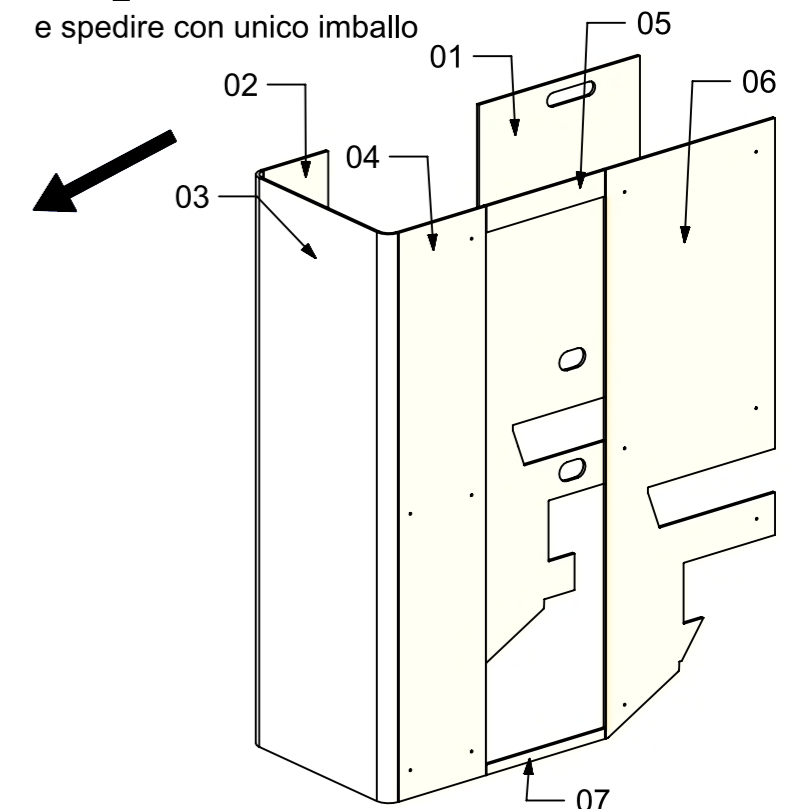

VERNICIATURA LASTRA/LACCATI:

● = VERNICIARE 1 LATO + FILI RASATI O BORDATI

NESSUN SIMBOLO = VERNICIARE 2 LATI + FILI RASATI O BORDATI

LOCALE	CODICE	DESCRIZIONE COMPONENTE	FINITURA	GR.
BAGNO OSPITI SX	MD320_R01_YD01	MOBILE SOTTO LAVELLO	LASTRA SCURA	4

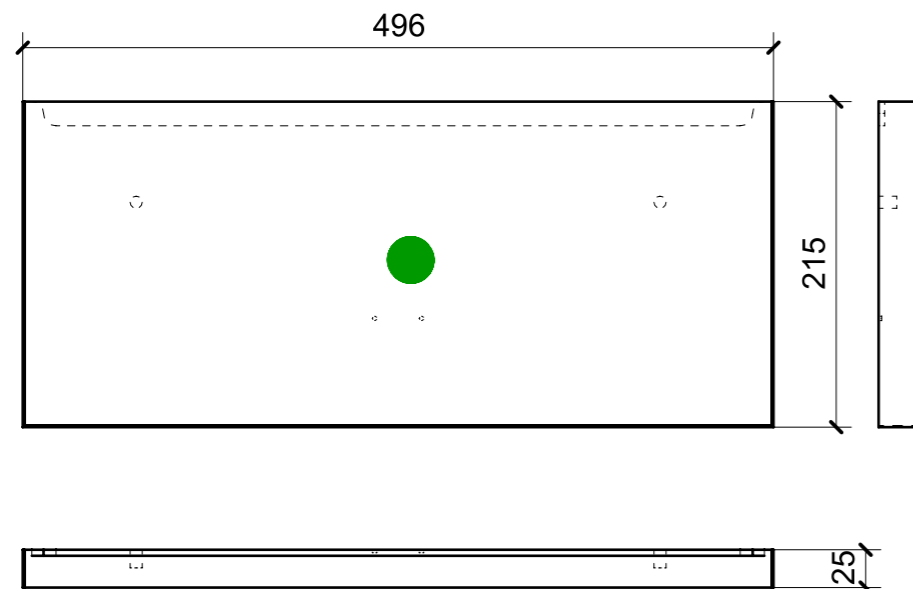

01

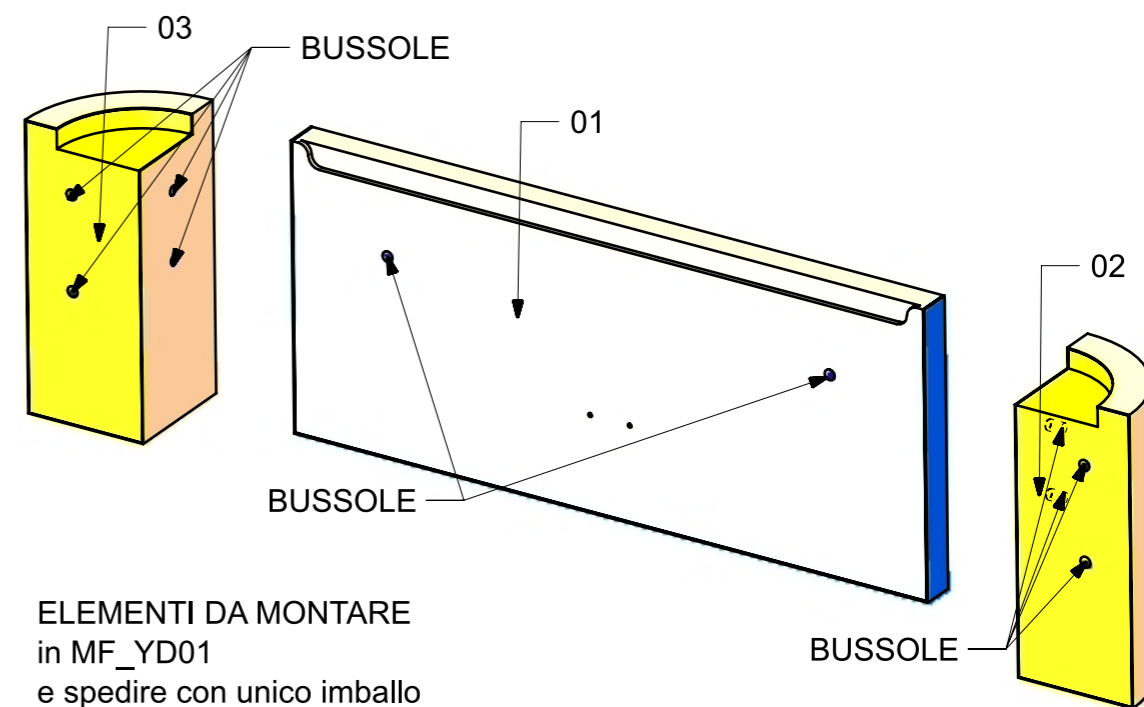

IMPIALLACCIARE TESTE E TUTTI I LATI (TRANNE QUESTO)

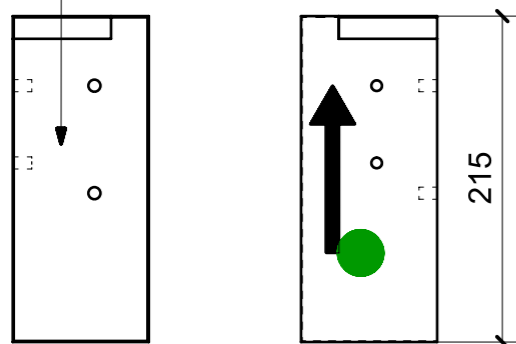

02

IMPIALLACCIARE TESTE E TUTTI I LATI (TRANNE QUESTO)

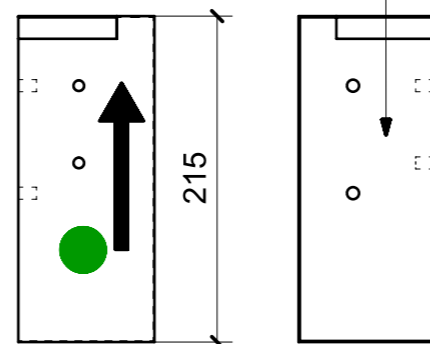

03

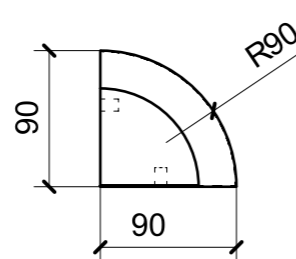
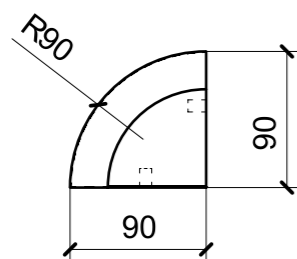

FERRAMENTA	QTY
BUSSOLA 6MA X 10 FORO DIAM.8	10
PLACCHETTA COUNTER STEEL_TECHNOPARTNER_MC-JM49	1

VERNICIATURA LASTRA/LACCATI:

● = VERNICIARE 1 LATO + FILI RASATI O BORDATI

NESSUN SIMBOLO = VERNICIARE 2 LATI + FILI RASATI O BORDATI

LOCALE	CODICE	DESCRIZIONE COMPONENTE	FINITURA	GR.
BAGNO OSPITI SX	MD320_R04_YN01	SEDUTA DOCCIA	IROKO DOGATO	2

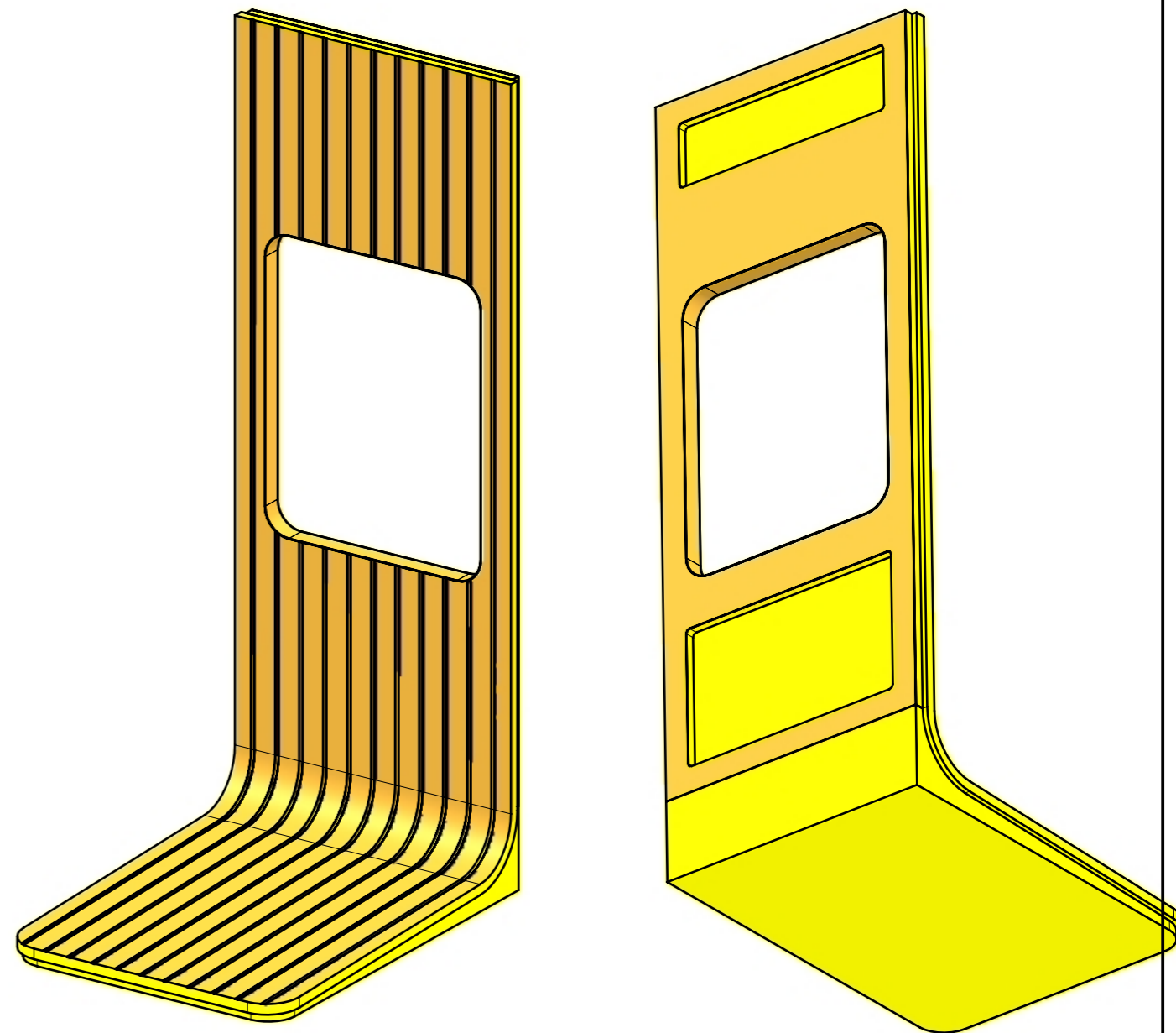
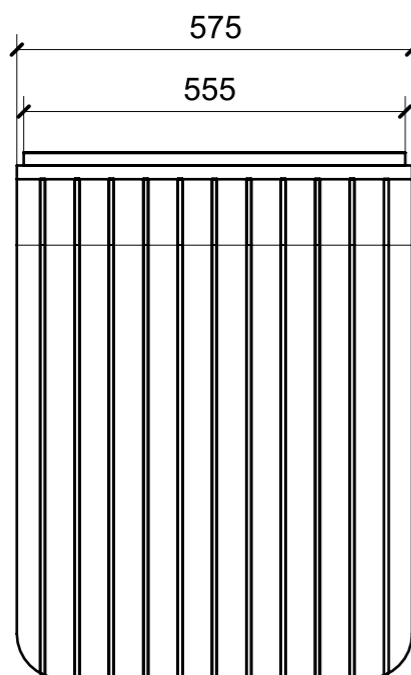
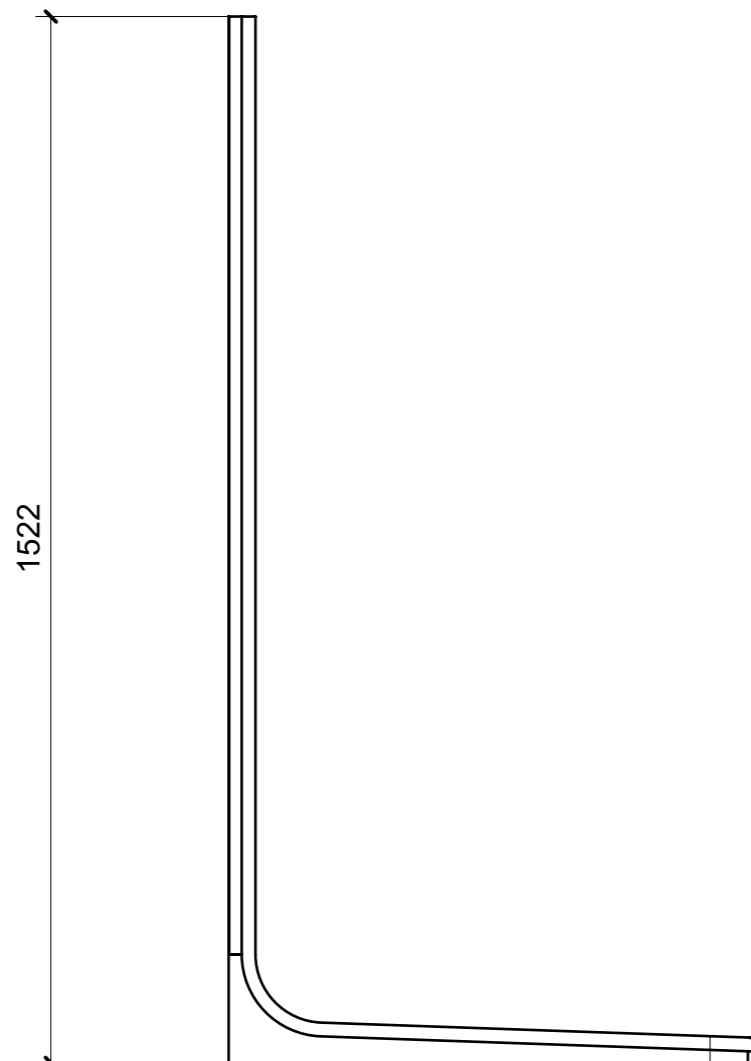
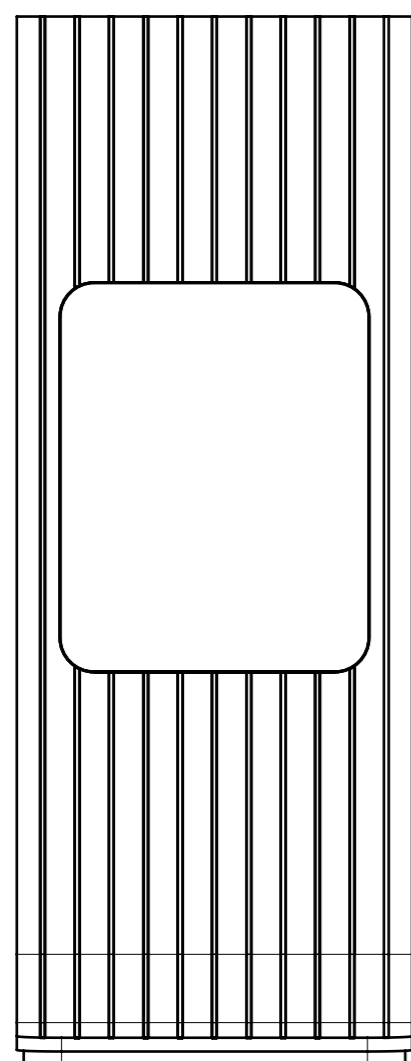

ELEMENTO DA MONTARE  
 con LACCATI BRONZO  
 in MF\_YN01  
 e spedire con unico imballo

VERNICIATURA LASTRA/LACCATI:

● = VERNICIARE 1 LATO + FILI RASATI O BORDATI

NESSUN SIMBOLO = VERNICIARE 2 LATI + FILI RASATI O BORDATI