

LOCALE	CODICE	DESCRIZIONE COMPONENTE	FINITURA	GR.
BAGNO ARMATORE	MD320_MF_WC01	MOBILE IN NICCHIA SOPRA LAVABO		2

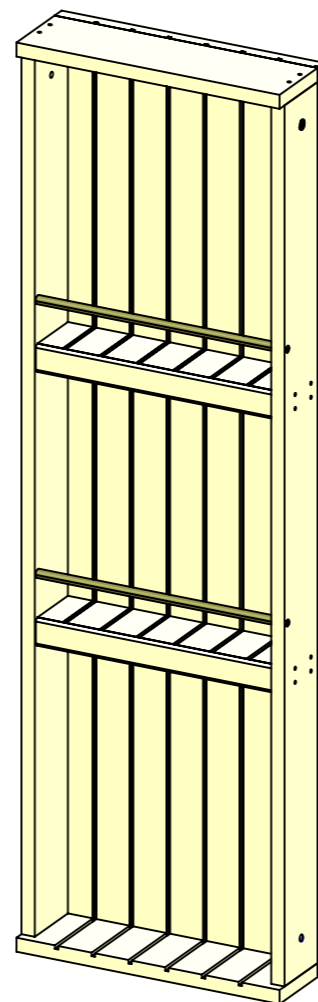

ACCIAIO VERNICIATO  
BRONZO 88634

ELEMENTI DA MONTARE  
in MF\_WC01  
e spedire con unico imbllo

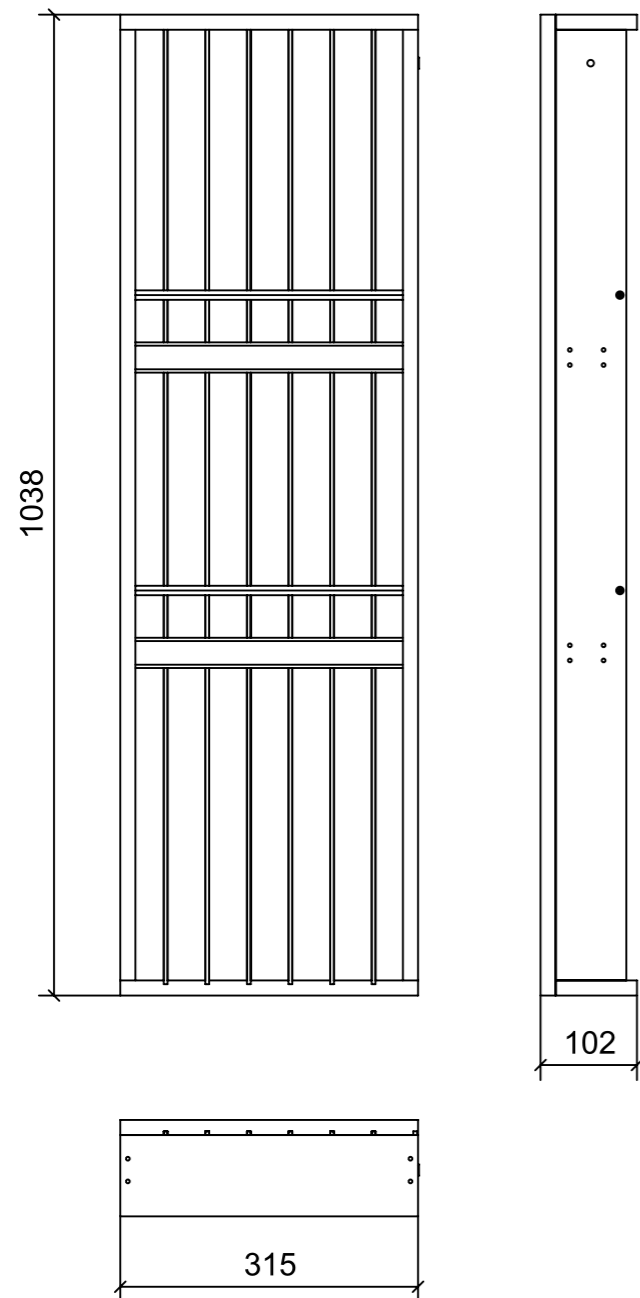
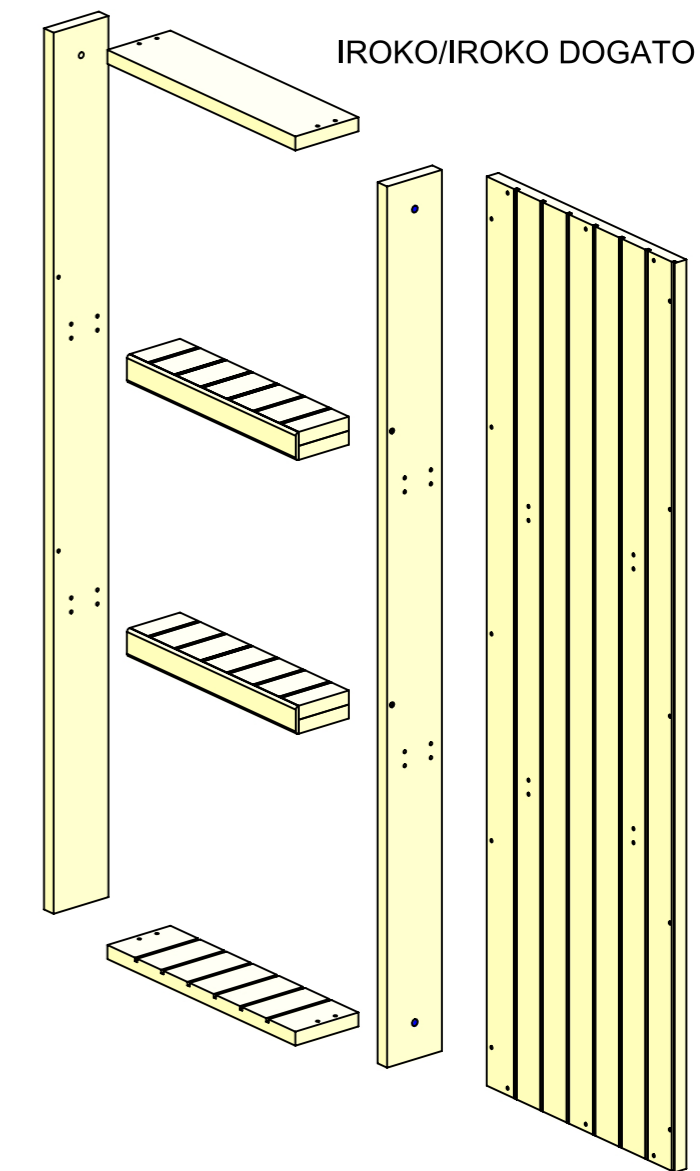

FERRAMENTA	QTY
BUSSOLA 6MA X 10 FORO DIAM.8	1
VITE 4MA X 30 TESTA SVASATA ESAGONALE NERA_FBC_21098	4

VERNICIATURA LASTRA/LACCATI:

● = VERNICIARE 1 LATO + FILI RASATI O BORDATI

NESSUN SIMBOLO = VERNICIARE 2 LATI + FILI RASATI O BORDATI

LOCALE	CODICE	DESCRIZIONE COMPONENTE	FINITURA	GR.
BAGNO ARMATORE	MD320_MF_WE01	SCATOLA CORPO MISCELATORI		3

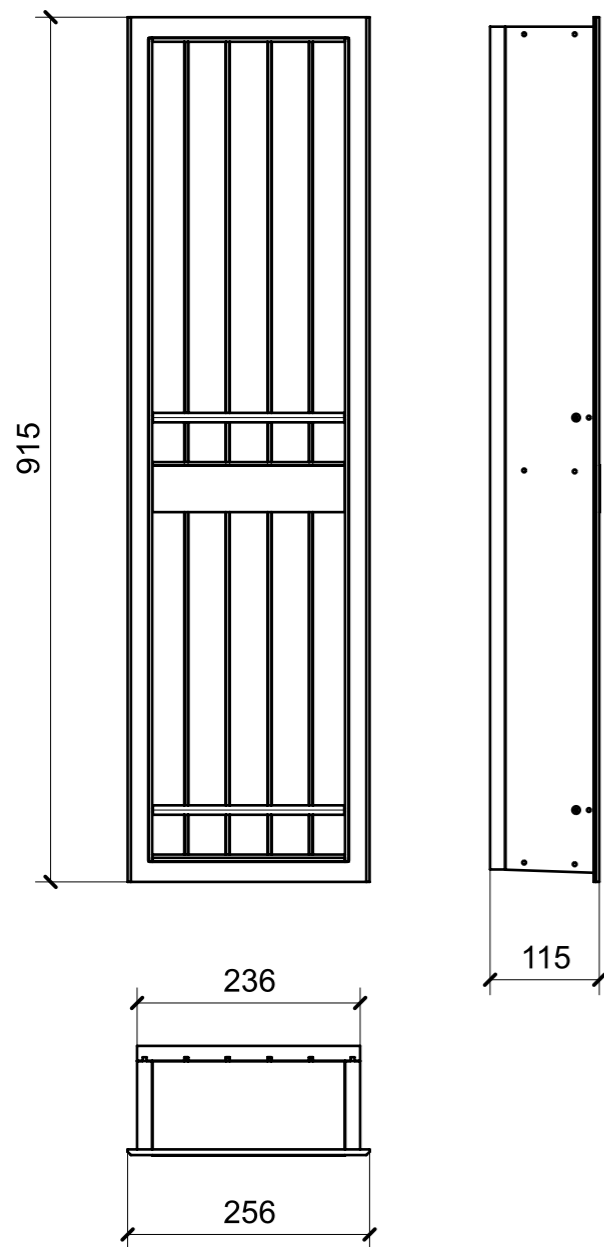

ELEMENTI DA MONTARE  
in MF\_WE01  
e spedire con unico imballo



IROKO DOGATO

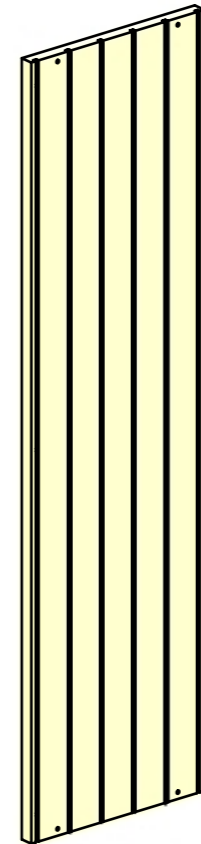

LACCATO BRONZO

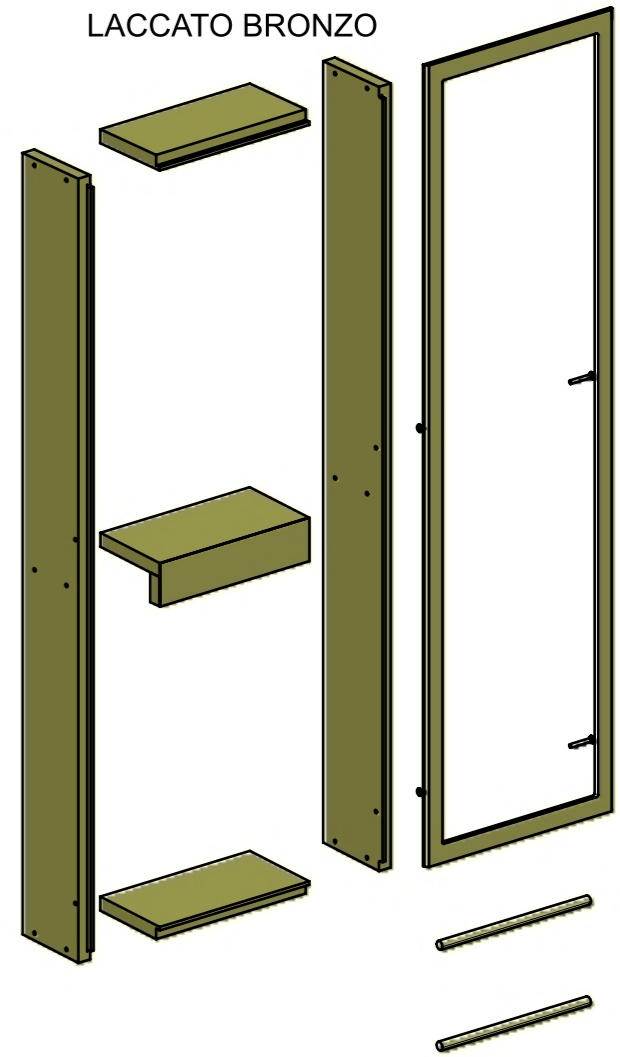

ACCIAIO VERNICIATO  
DARK BRONZE 88634

FERRAMENTA	QTY
VITE 4MA X 30 TESTA SVASATA ESAGONALE NERA_FBC_21098	4

VERNICIATURA LASTRA/LACCATI:

● = VERNICIARE 1 LATO + FILI RASATI O BORDATI

NESSUN SIMBOLO = VERNICIARE 2 LATI + FILI RASATI O BORDATI

LOCALE	CODICE	DESCRIZIONE COMPONENTE	FINITURA	GR.
BAGNO ARMATORE	MD320_MF_WH01	PARETE NICCHIA WATER		4

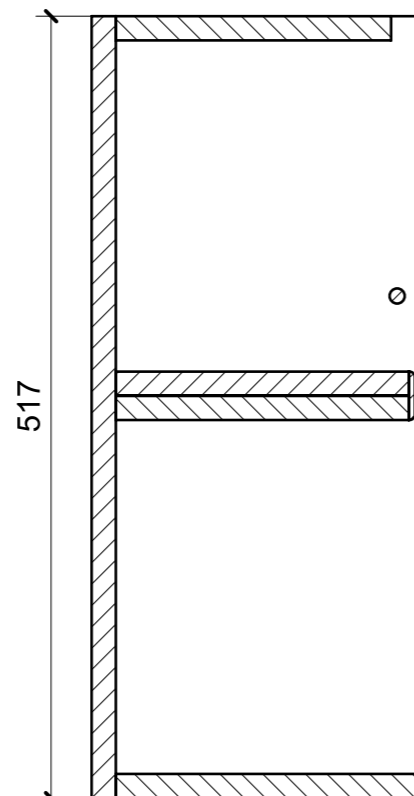
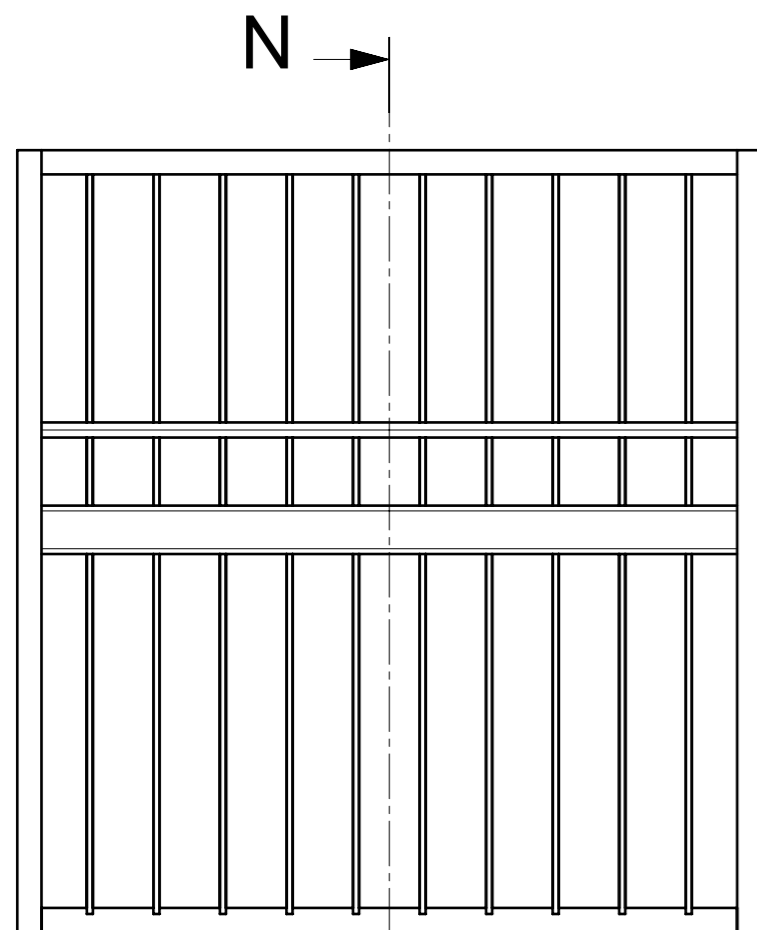

SECTION N-N

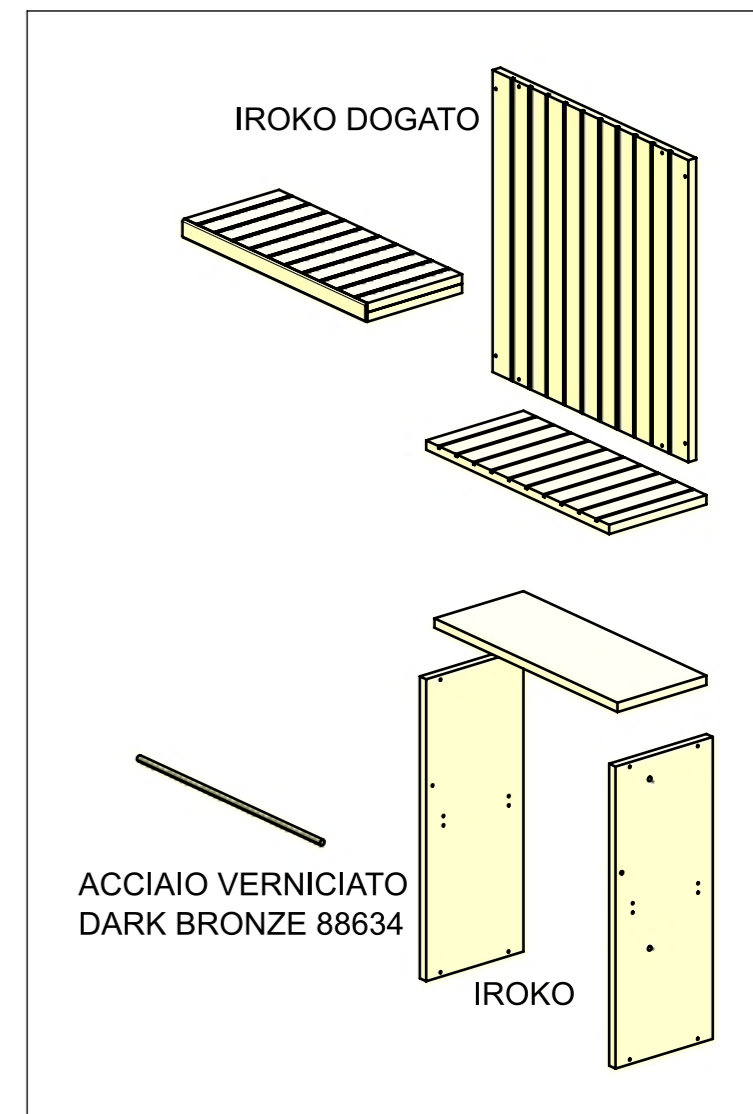
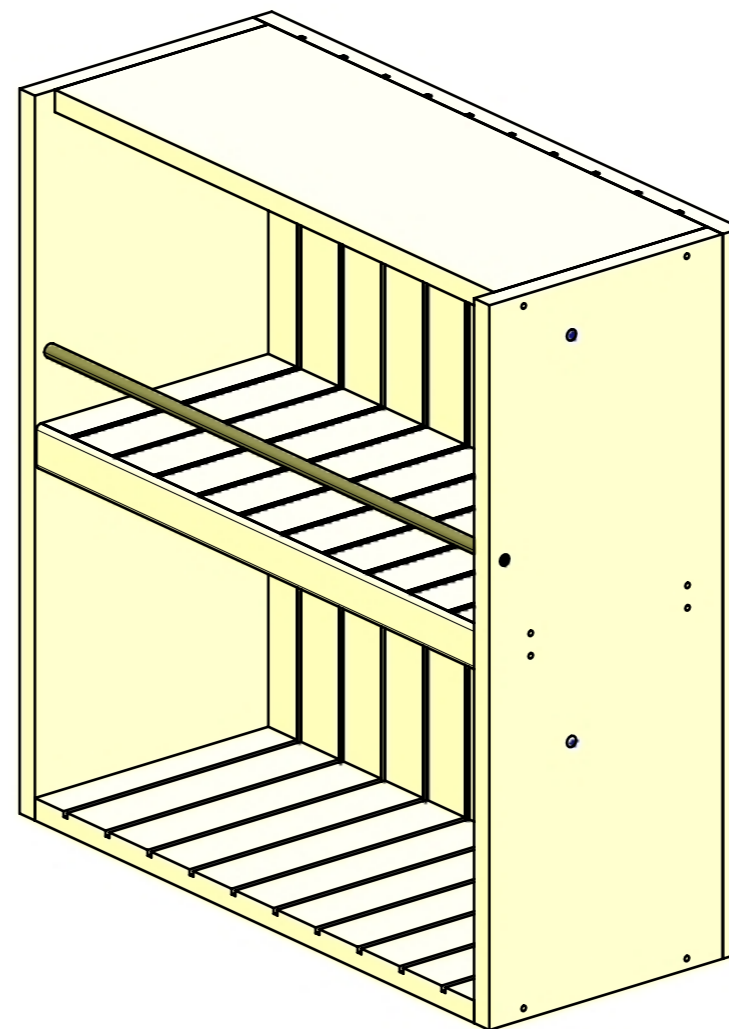
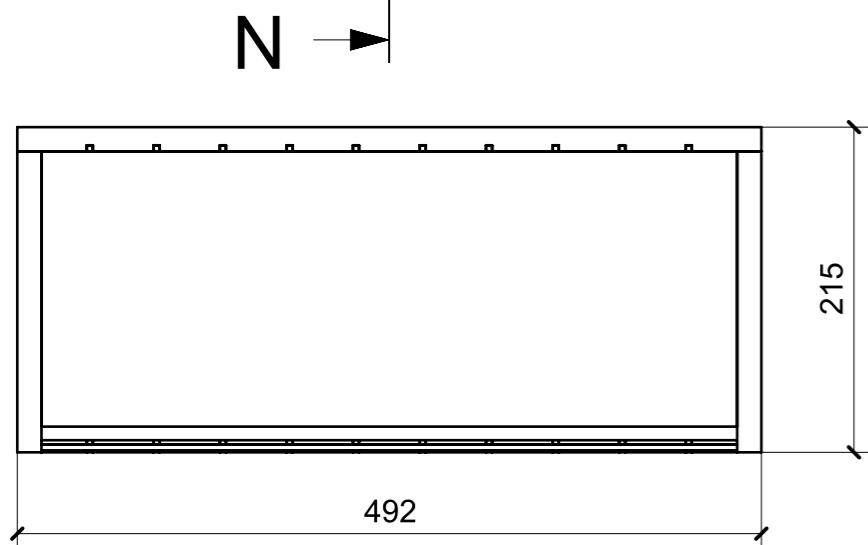

ELEMENTI DA MONTARE  
in MF\_WH01  
e spedire con unico imballo

FERRAMENTA	QTY
VITE 4MA X 30 TESTA SVASATA ESAGONALE NERA_FBC_21098	2

VERNICIATURA LASTRA/LACCATI:

● = VERNICIARE 1 LATO + FILI RASATI O BORDATI

NESSUN SIMBOLO = VERNICIARE 2 LATI + FILI RASATI O BORDATI

LOCALE	CODICE	DESCRIZIONE COMPONENTE	FINITURA	GR.
BAGNO ARMATORE	MD320_MF_WN01	SEDUTA DOCCIA		2

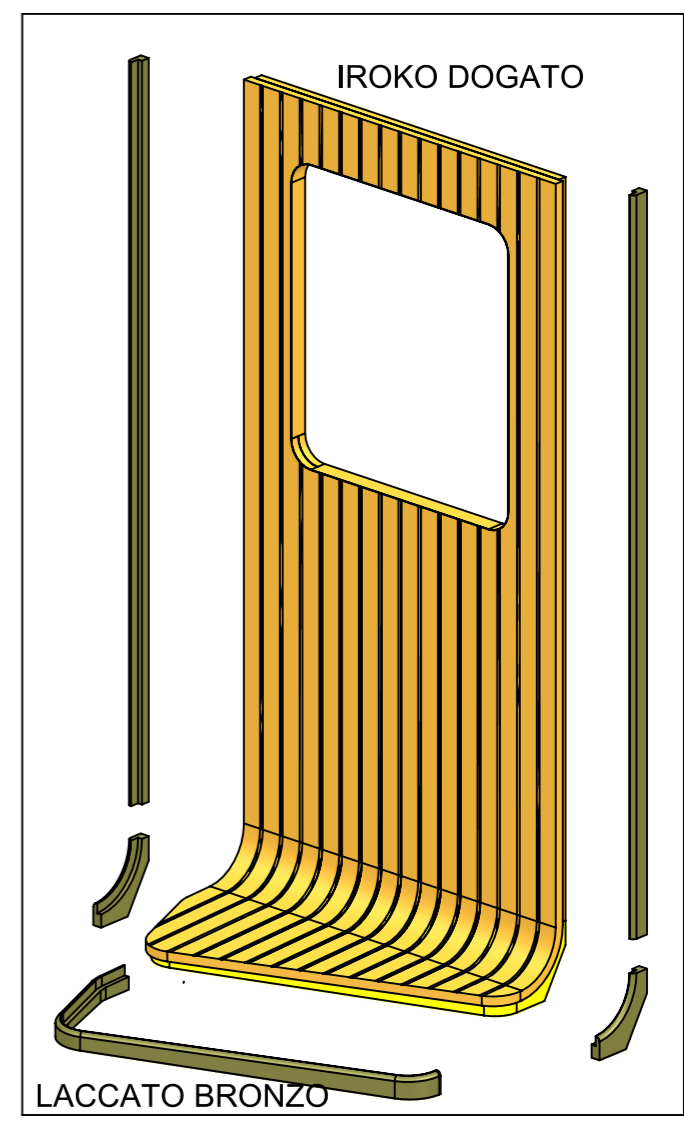
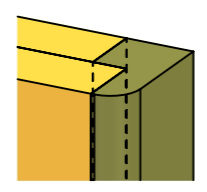
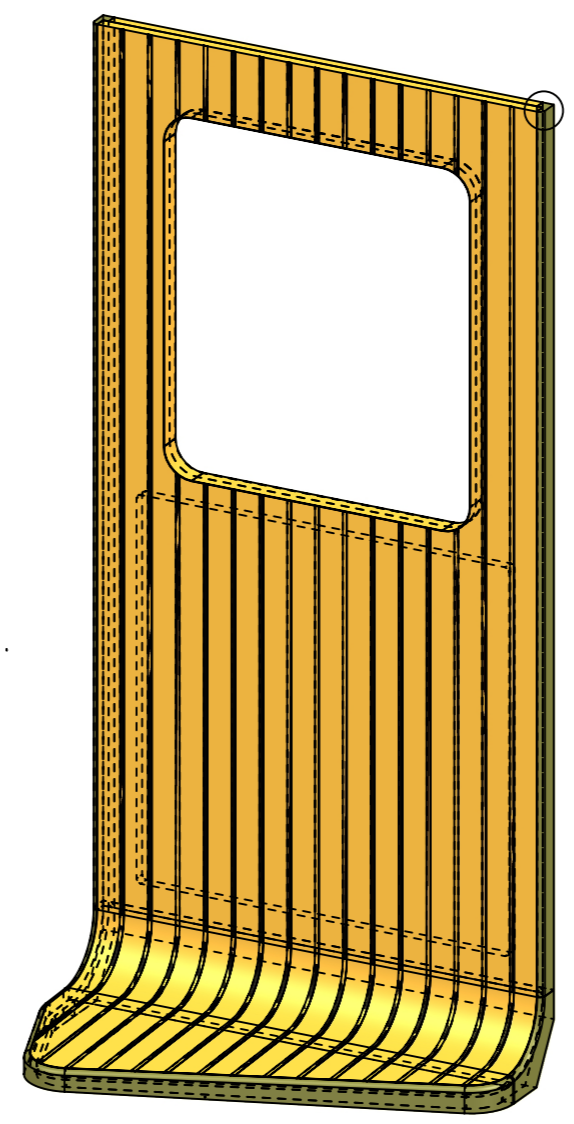
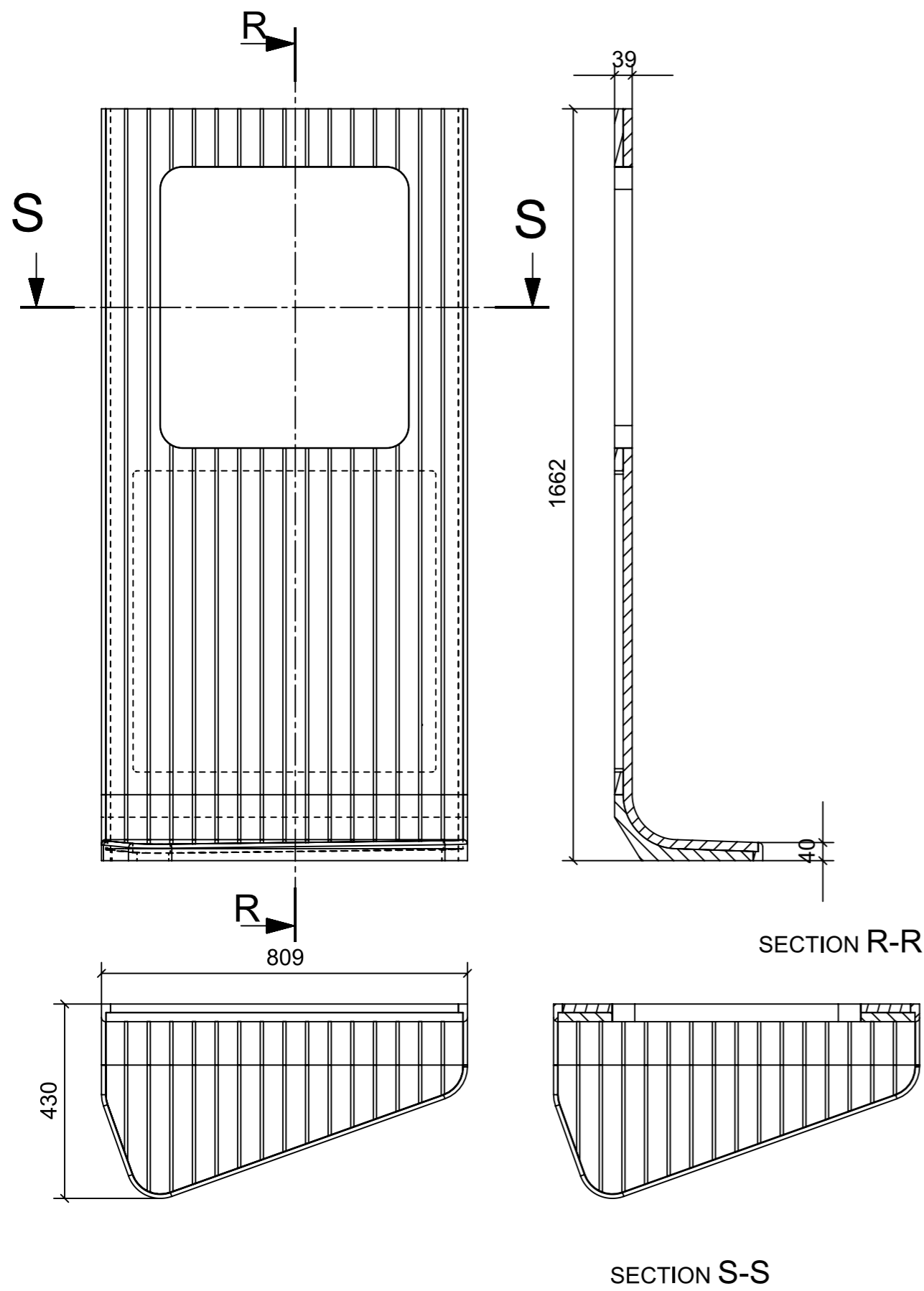

ELEMENTI DA MONTARE  
in MF\_WN01  
e spedire con unico imballo

LOCALE	CODICE	DESCRIZIONE COMPONENTE	FINITURA	GR.
BAGNO ARMATORE	MD320_MF_WO01	CASSETTIERA MOBILE BAGNO	-	4

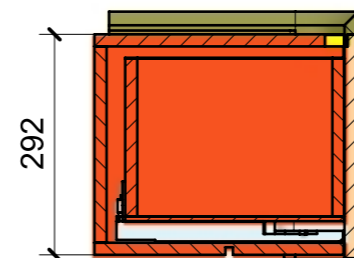
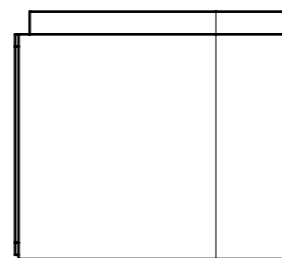
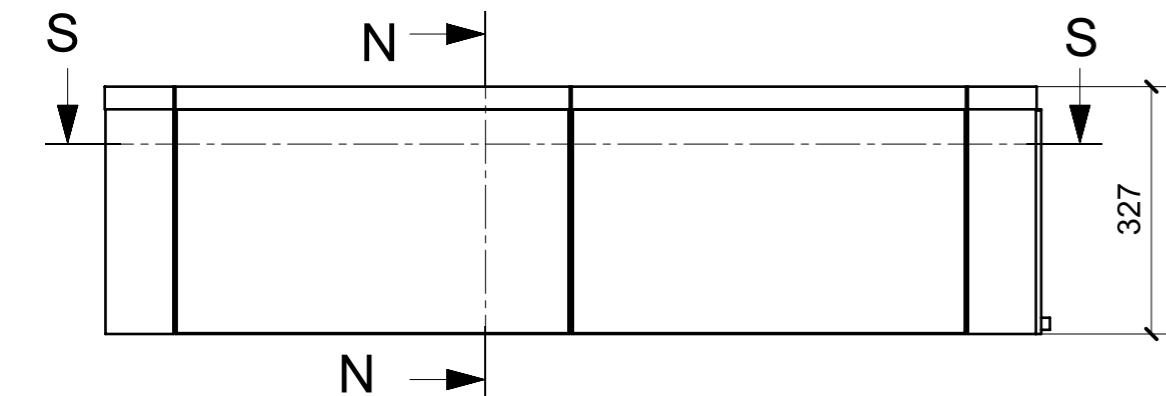

SECTION N-N

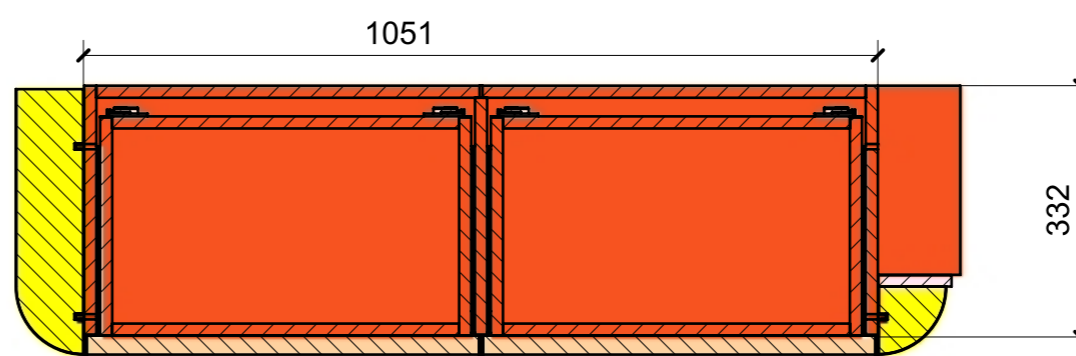

SECTION S-S

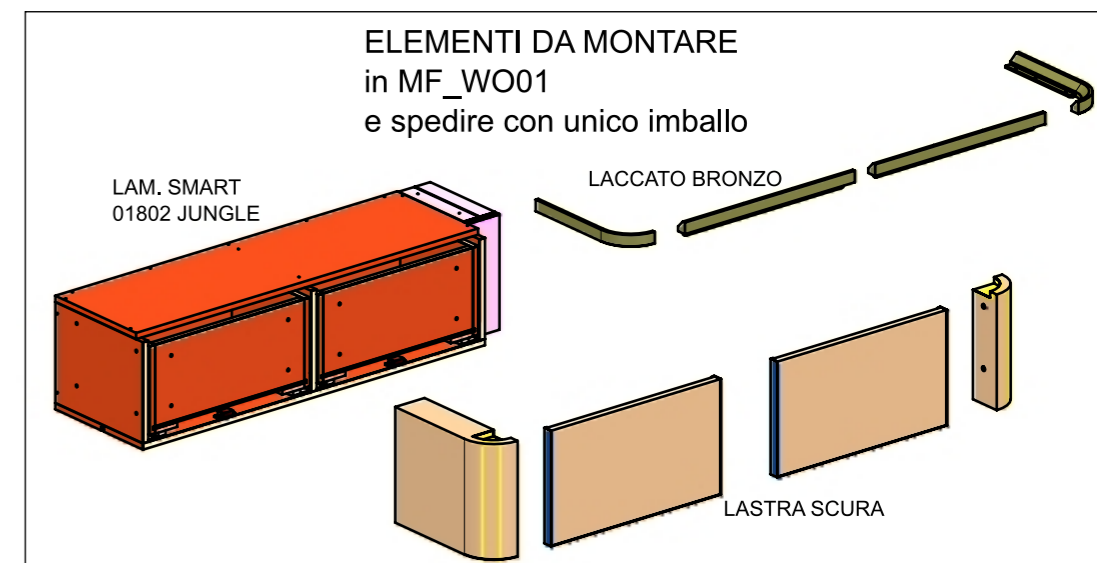
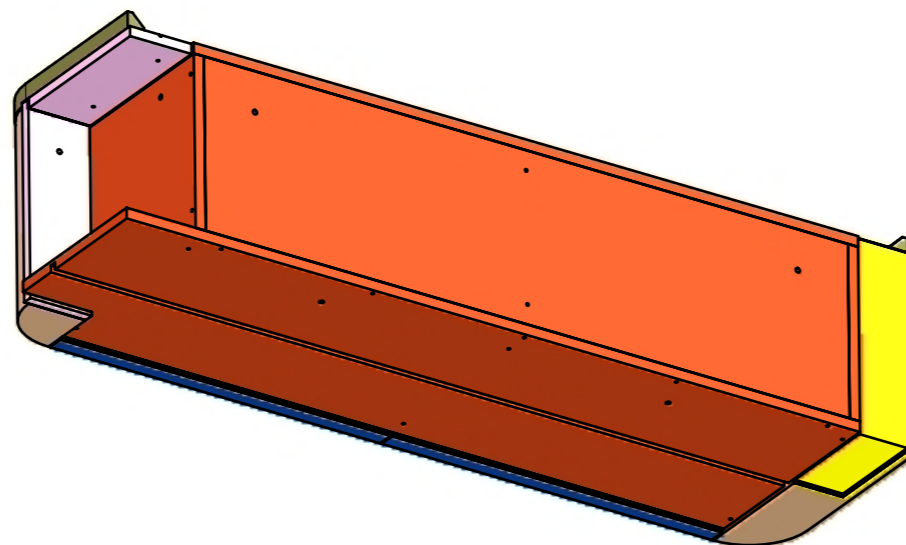
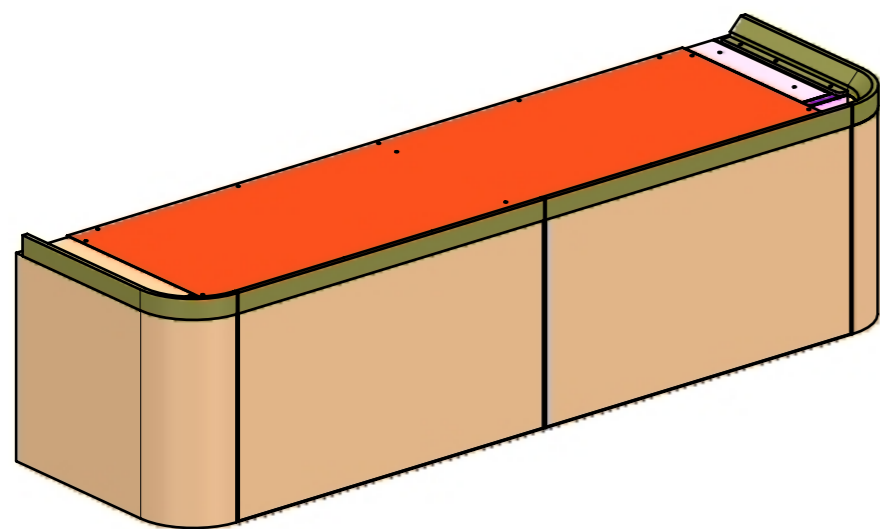

FERRAMENTA	QTY
BUSSOLA 6MA X 10 FORO DIAM.8	16
CALAMITA SEALED MAGNETIC_TECNOPARTNER_MC-JM50-BL	2
GUIDA DYNAPRO ADJUSTMENT ADAPTER L_FBC_F134141746 4D	2
GUIDA DYNAPRO ADJUSTMENT ADAPTER R_FBC_F134141746 4D	2
GUIDA DYNAPRO FRONT LOCKING DEVICE L_FBC_F134108955 4D	2
GUIDA DYNAPRO FRONT LOCKING DEVICE R_FBC_F134108955 4D	2
GUIDA DYNAPRO SOFTCLOSE L300 L_FBC_F130107796 4D	2
GUIDA DYNAPRO SOFTCLOSE L300 R_FBC_F130107796 4D	2
PARTE TELAIO EHS_HAFELE_262_49_365	2
PLACCHETTA COUNTER STEEL_TECNOPARTNER_MC-JM49	2

LOCALE	CODICE	DESCRIZIONE COMPONENTE	FINITURA	GR.
BAGNO ARMATORE	MD320_MF_WQ01	PORTA SCOPINO		2

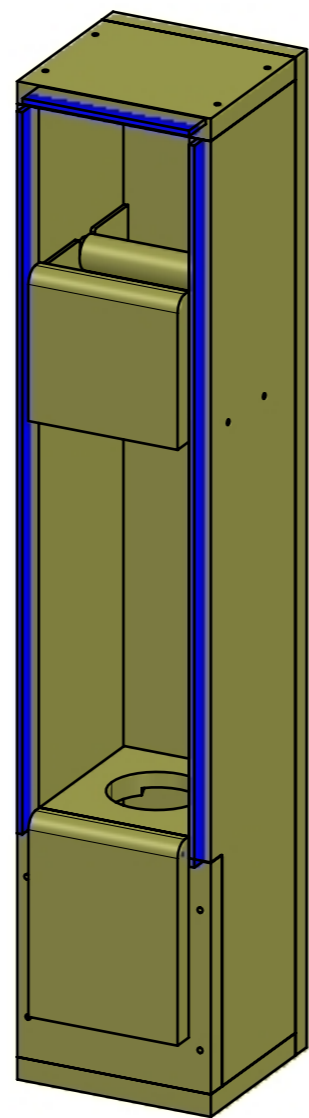
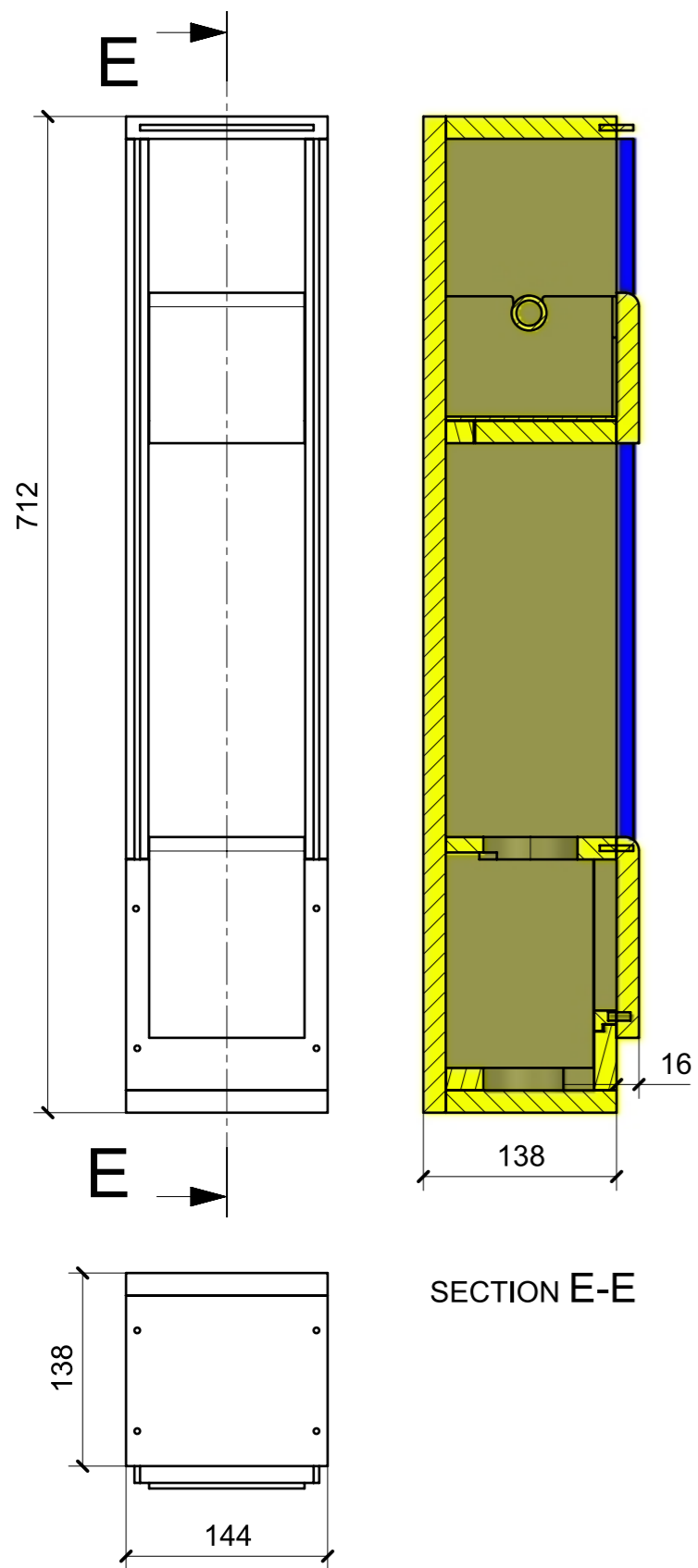

ELEMENTI DA MONTARE  
in MF\_WQ01  
e spedire con unico imballo



ACCIAIO VERNICIATO  
DARK BRONZE 88634

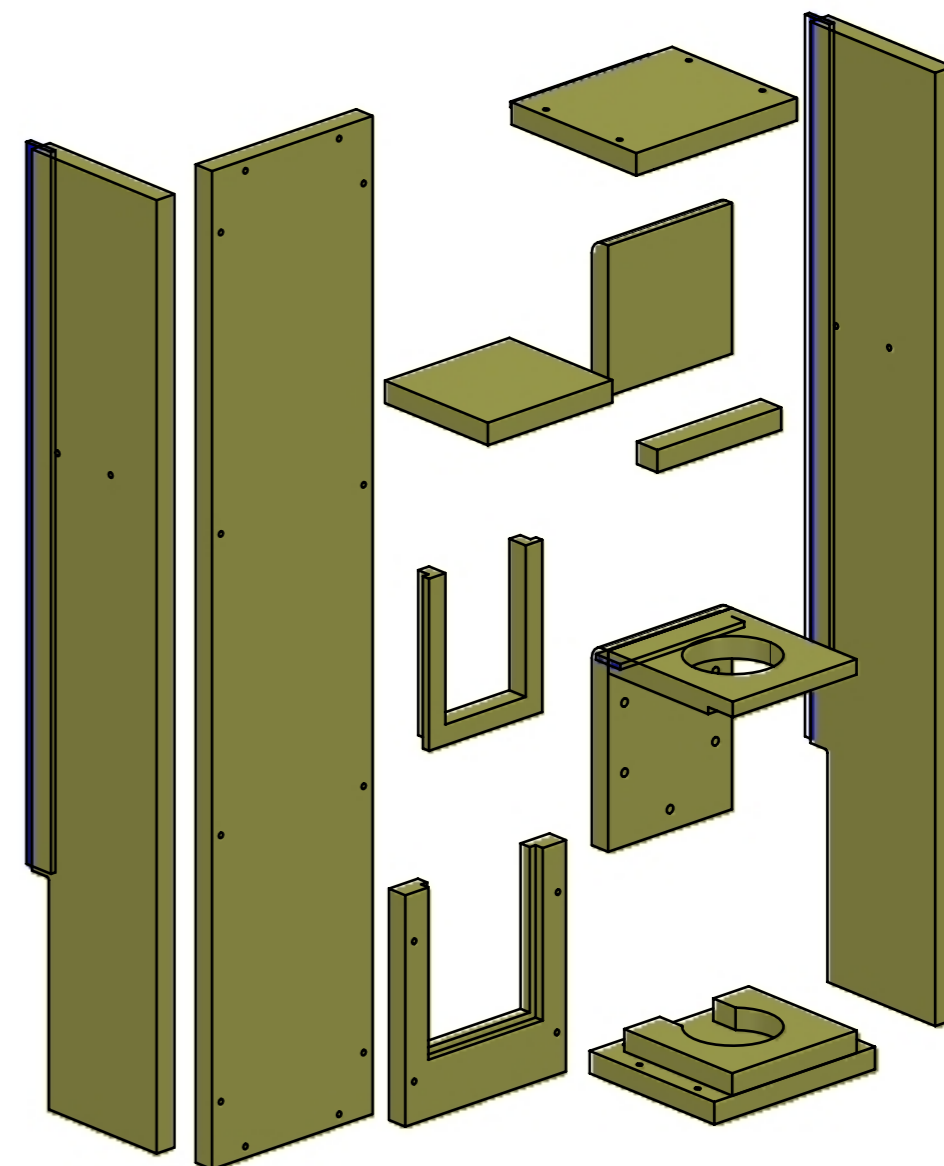
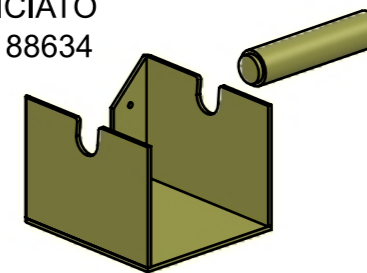

LACCATO BRONZO

LOCALE	CODICE	DESCRIZIONE COMPONENTE	FINITURA	GR.
BAGNO ARMATORE	MD320_MF_WWR01	FACCIATA INGROSSO PARETE WC VAR.4		4

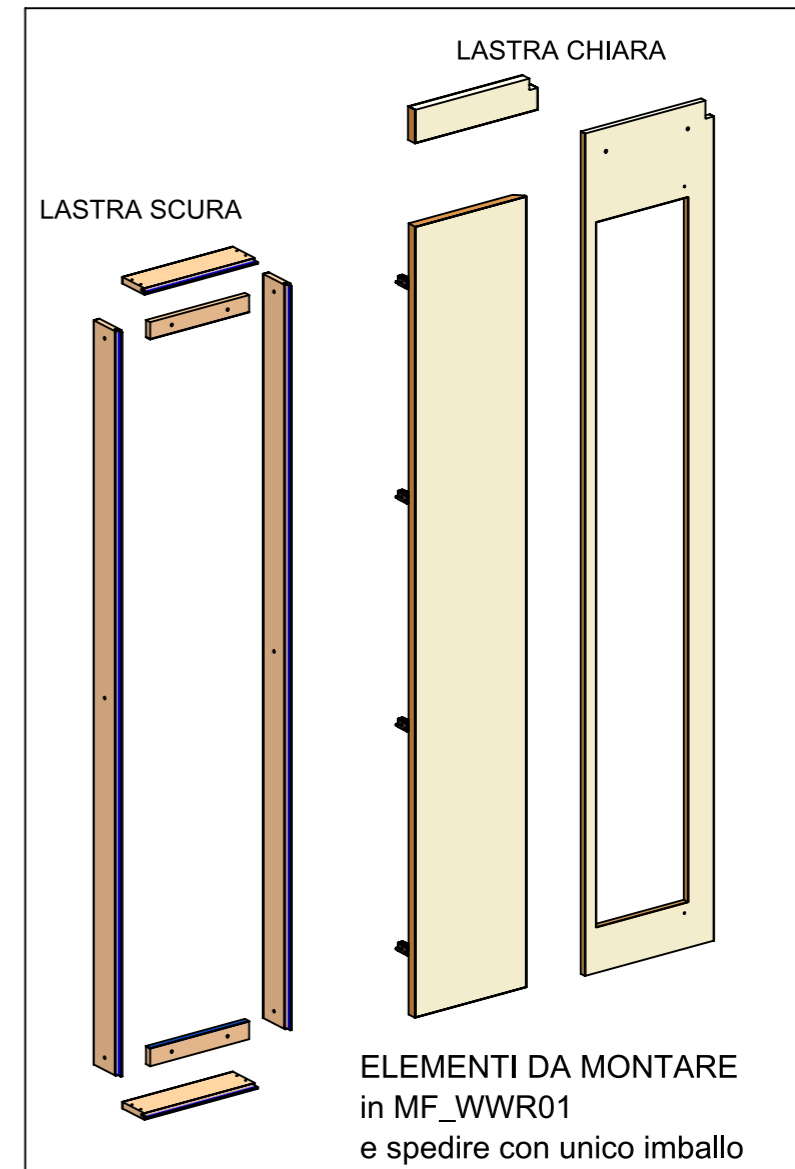
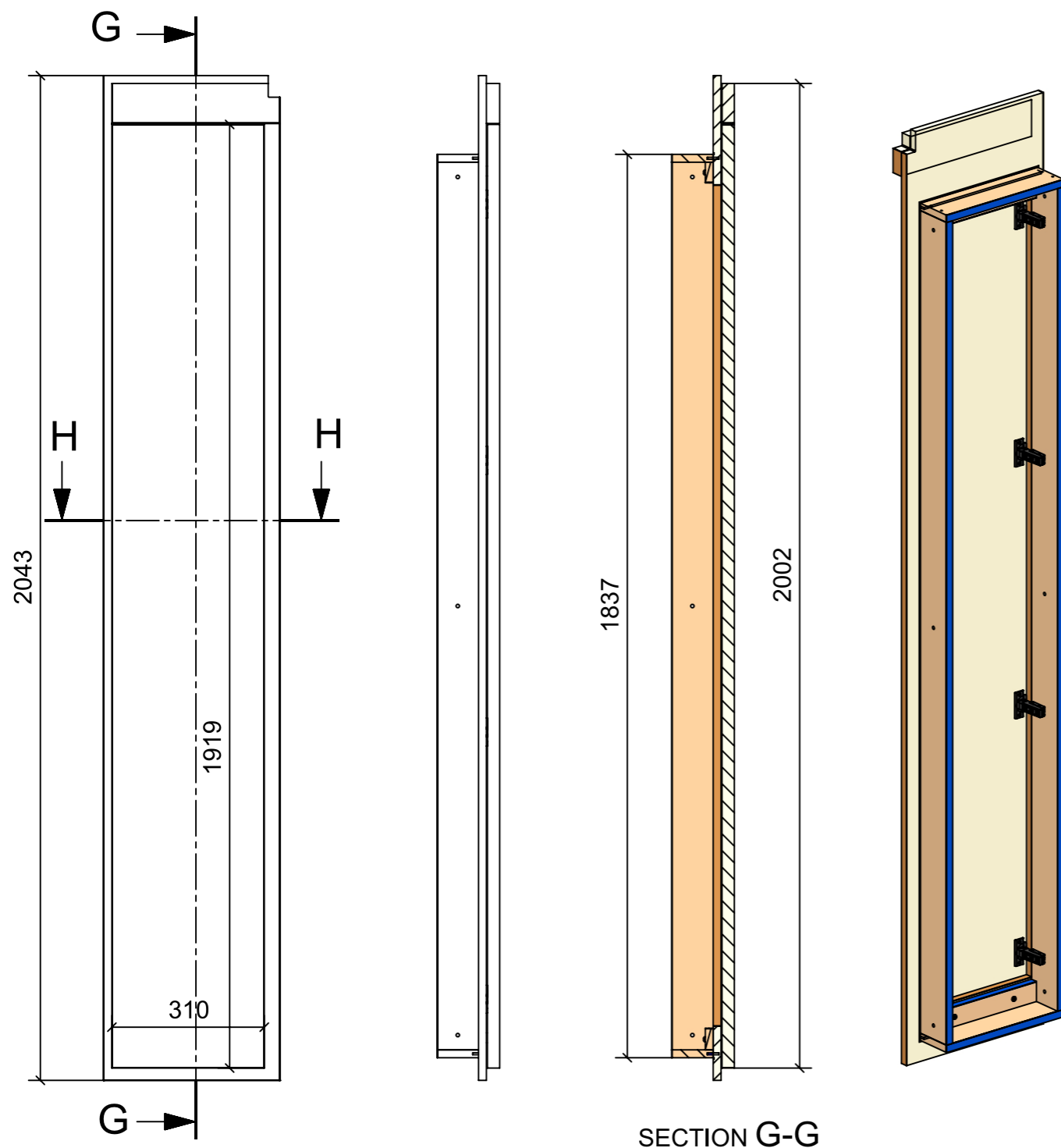

FERRAMENTA	QTY
BASE_3-NERA_HAFELE_342.22.067-BLUM_175H3130.STP	4
BUSSOLA 5MA ANKOR BORGHI	8
BUSSOLA 5MA ANKOR BORGHI X CERNIERA COLLO PIENO	8
BUSSOLA 6MA X 10 FORO DIAM.8	4
CERNIERA 94°_PIANA-NERA_HAFELE_342.46.604-BLUM_71B9550.STP	4
MAGNETE FORZA MAGNETICA1-5 10KG_HAFELE_246.87.112	2
RISCONTRO IN FERRO PER CALAMITA TONDO	2
VITE 4MAX8 ANKOR BORGHI	8
VITE 4MAX8 ANKOR BORGHI X CERNIERA COLLO PIENO	8
VITE 6MA X 25 TESTA BOMBATA NERA BHCS 10.9 ISO 7380	4

SECTION H-H

SECTION G-G