

LOCALE	CODICE	DESCRIZIONE COMPONENTE	FINITURA	GR.
LOBBY LD	MD320_MF_CF01	RIVESTIMENTI PRUA SX		3

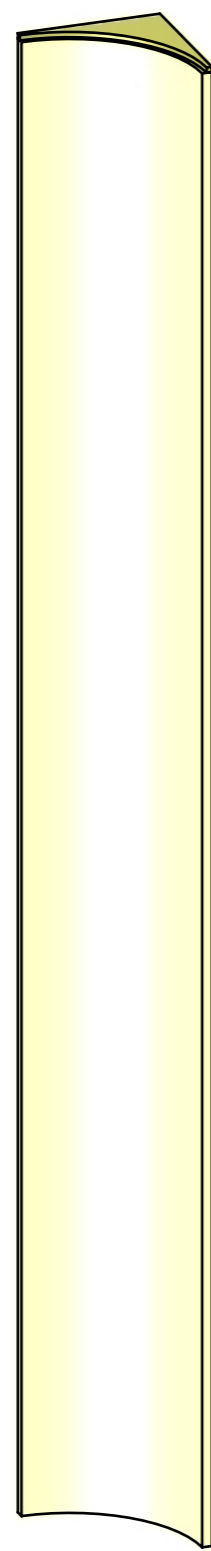

ELEMENTI DA MONTARE
in MF_CF01
spedire con unico imballo



L01_CF01_01

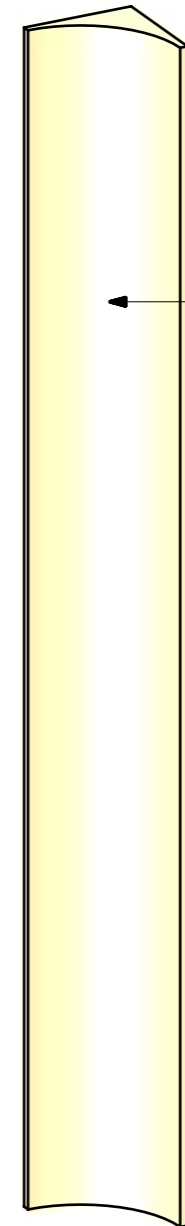

R01_CF01_04

LOCALE	CODICE	DESCRIZIONE COMPONENTE	FINITURA	GR.
LOBBY LD	MD320_MF_CG01	RIVESTIMENTI TRAVERSONAVE DISCESA SCALE PRUA		2

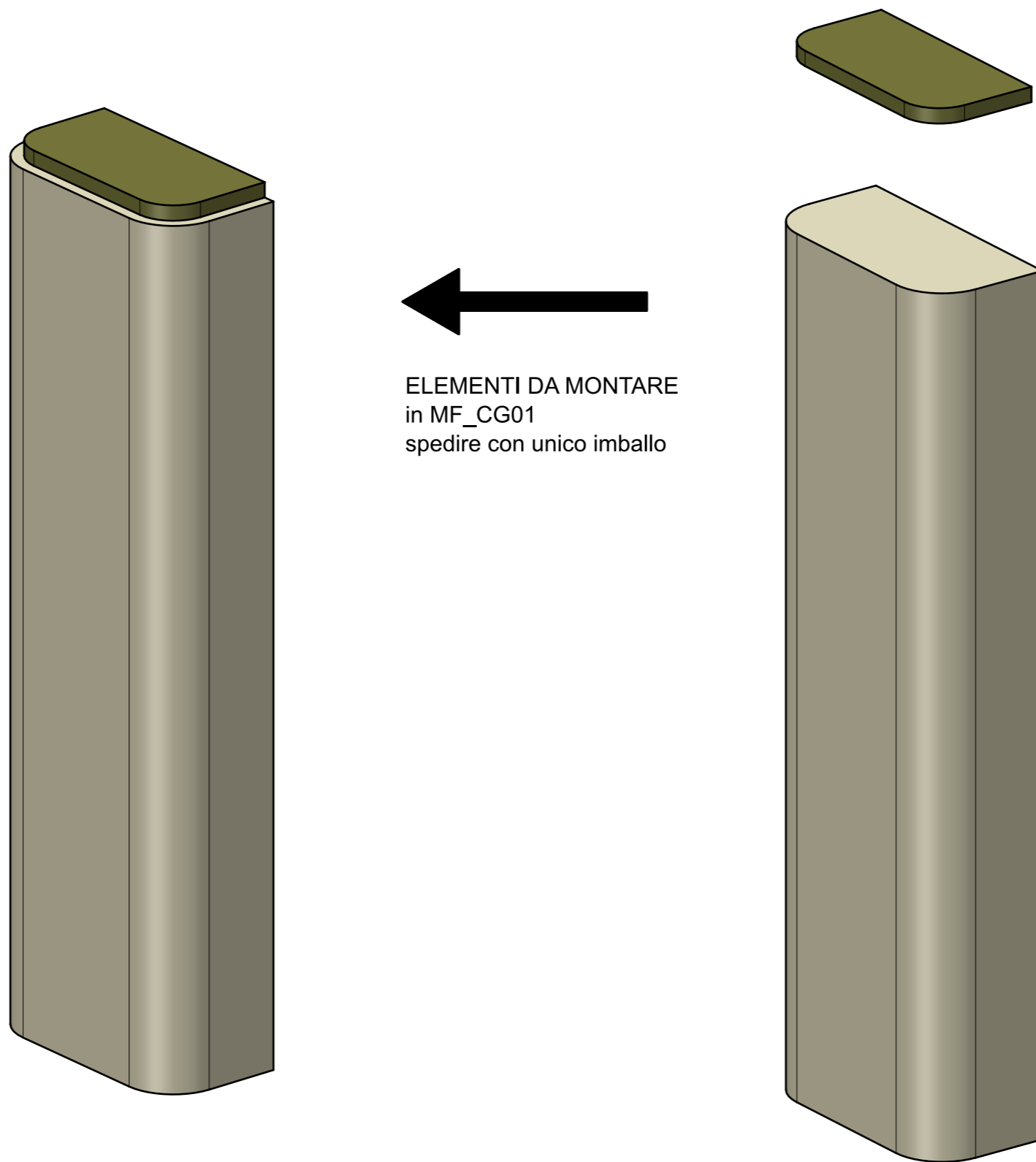

LOCALE	CODICE	DESCRIZIONE COMPONENTE	FINITURA	GR.
LOBBY LD	MD320_MF_CH01	MOBILE QUADRO ELETTRICO		4

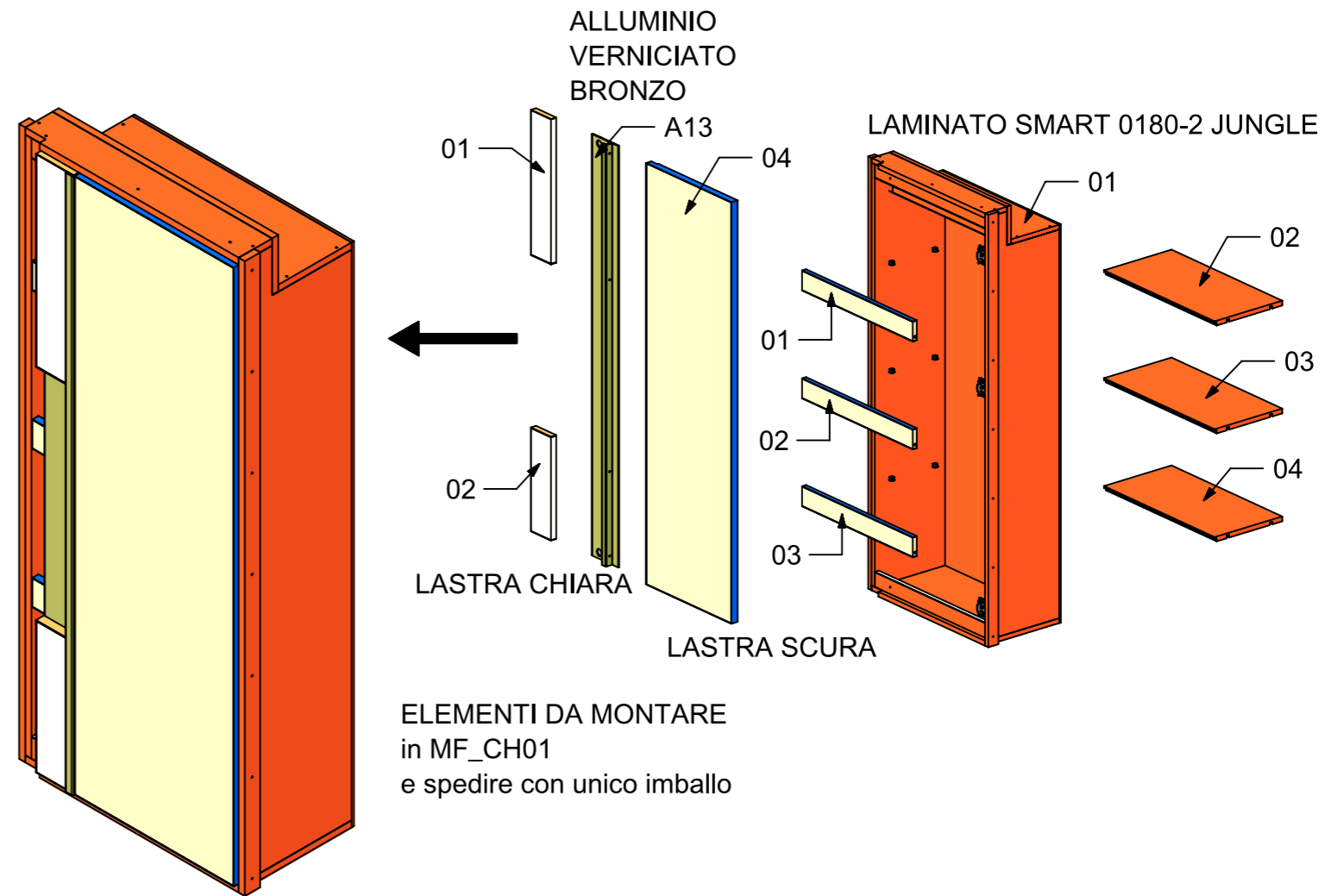
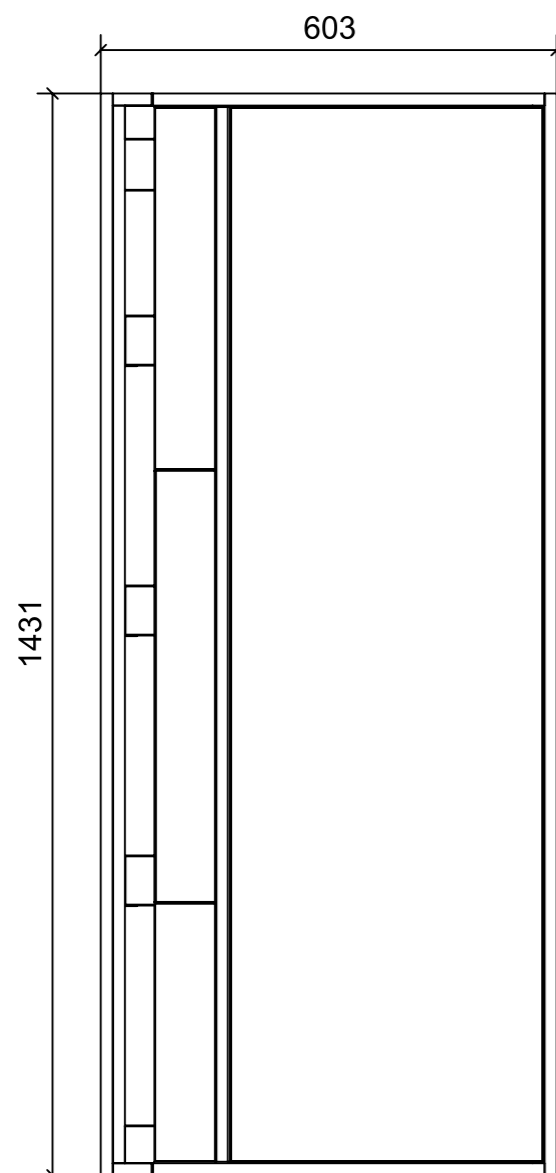
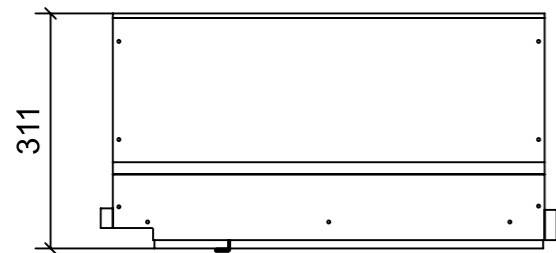

FERRAMENTA	QTY
MAGNETE FORZA MAGNETICA1-5 10KG_HAFELE_246.87.112	2
BUSSOLA 5MA ANKOR BORGHI X CERNIERA PIANA	6
VITE 4MAX8 ANKOR BORGHI	6
COPERTURA BRACCIO CERNIERA NERO-HAFELE_342.94.602-BLUM_70.1503.STP	3
BASE_3-NERA_HAFELE_342.22.067-BLUM_175H3130.STP	3
CERNIERA 94°_PIANA-NERA_HAFELE_342.46.604-BLUM_71B9550.STP	3
VITE 4MAX8 ANKOR BORGHI X CERNIERA PIANA	6
BUSSOLA 5MA ANKOR BORGHI	6
RISCONTRO IN FERRO PER CALAMITA DA FAR PRODURRE	2
GIUNTO REGGIRIPIANO CON BORDO ANTISGANCIO_FBC BORGHI_1033XXB060902	12