

LOCALE	CODICE	DESCRIZIONE COMPONENTE	FINITURA	Q.TA
CABINA VIP	MD299 MG_VA01	LETTO	LAMINATO - GREZZO - LACCATO BIANCO GOFFRATONE	4

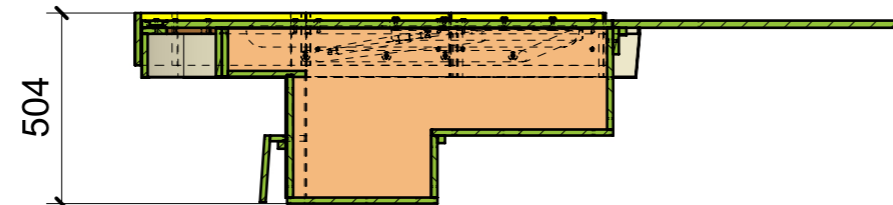

SECTION R-R

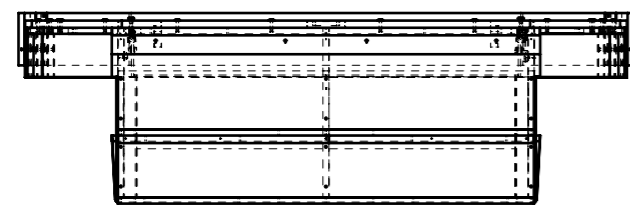
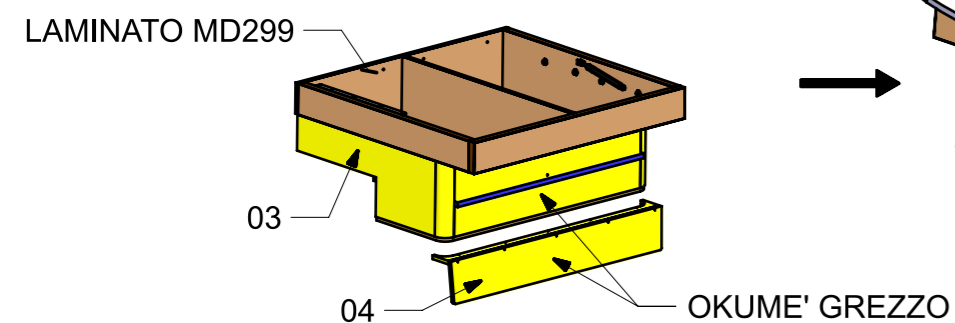
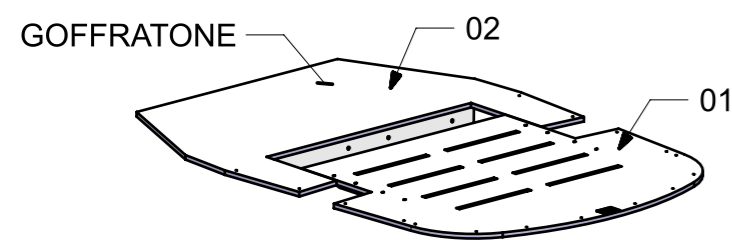
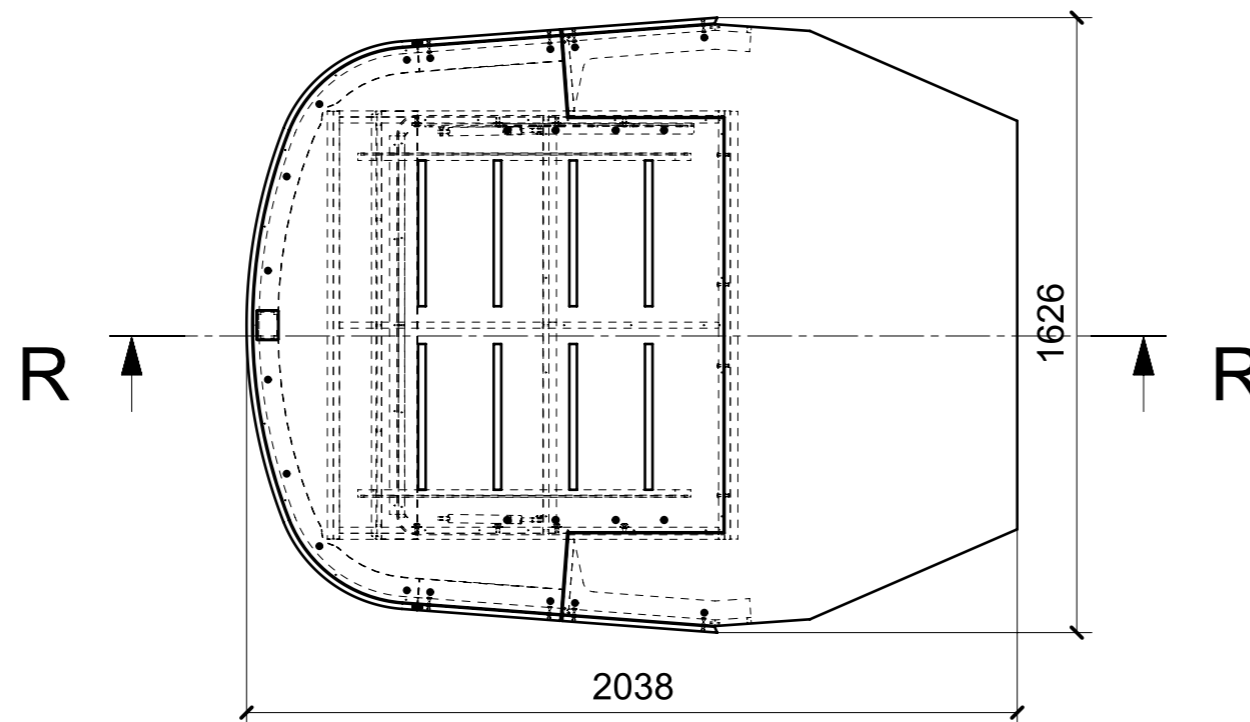
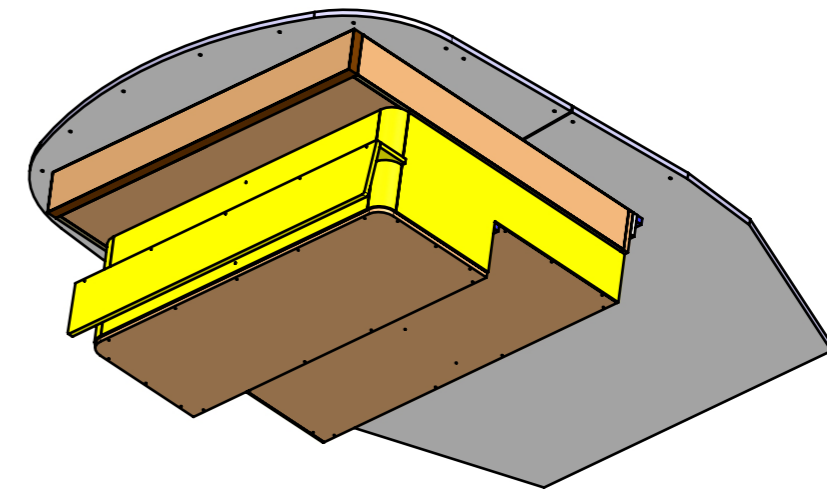

FERRAMENTA	QTY
BUSSOLA 5MA X 10 FORO DIAM.8	4
BUSSOLA 8MA X 14_FBC	4
BUSSOLA 8MA X 14_FBCMIRROR_	1
BUSSOLA 8MA X 14_FBCMIRROR_0	1
BUSSOLA 8MA X 14_FBCMIRROR_1	1
BUSSOLA 8MA X 14_FBCMIRROR_2	1
CP TRAPEZI STABILUS TZ 530 BTZ T2.A0_FBC_99999032	1
MANIGLIETTA ALZA LETTO_FORESTI_ART.76A.C	1
PISTONE A GAS STABILUS_456306_600NW-L385_FBC_99999049	1
PISTONE A GAS STABILUS_456306_600NW-L385_FBC_99999049MIRROR_	1
RANELLA SP.2 MM DIAM.24 FORO 8_FBC	4
RANELLA SP.2 MM DIAM.24 FORO 8_FBCMIRROR_	1
RANELLA SP.2 MM DIAM.24 FORO 8_FBCMIRROR_0	1
RANELLA SP.2 MM DIAM.24 FORO 8_FBCMIRROR_1	1
RANELLA SP.2 MM DIAM.24 FORO 8_FBCMIRROR_2	1
SEEGER PER MECC. LETTO_00407908	1
SEEGER PER MECC. LETTO_00407908MIRROR_	1
TBL 8MA X 20_FBC	4
TBL 8MA X 20_FBCMIRROR_	1
TBL 8MA X 20_FBCMIRROR_0	1
TBL 8MA X 20_FBCMIRROR_1	1
TBL 8MA X 20_FBCMIRROR_2	1

LOCALE	CODICE	DESCRIZIONE COMPONENTE	FINITURA	Q.TA
CABINA VIP	MD299_MG_VC01	COLLEGAMENTO MURA DX	LASTRA SCURA	1

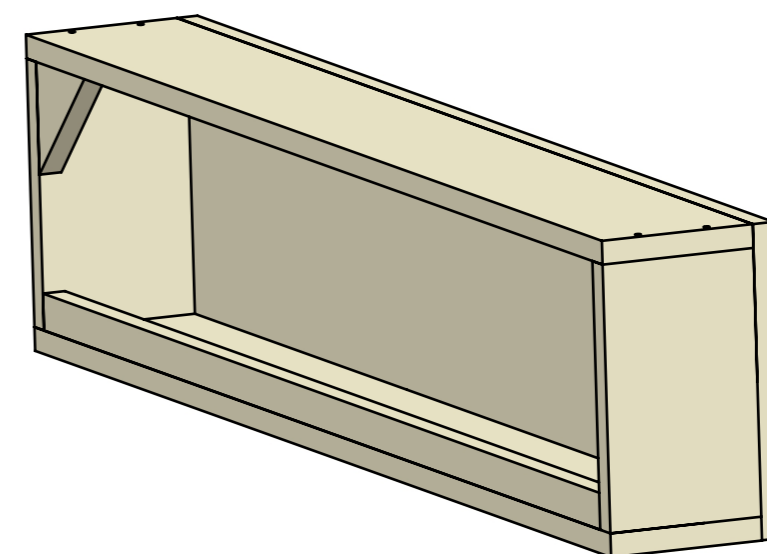
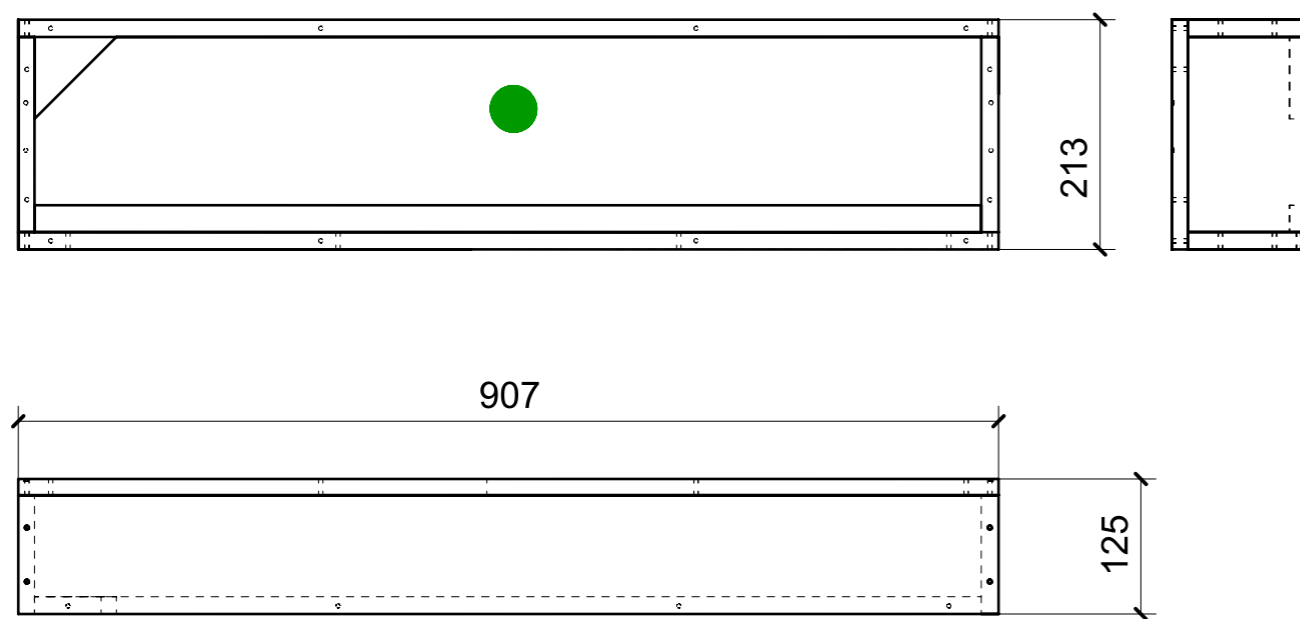

VERNICIATURA LASTRA/LACCATI:

● = VERNICIARE 1 LATO + FILI RASATI O BORDATI

NESSUN SIMBOLO = VERNICIARE 2 LATI + FILI RASATI O BORDATI

LOCALE	CODICE	DESCRIZIONE COMPONENTE	FINITURA	Q.TA
CABINA VIP	MD299_MG_VD01	COLLEGAMENTO MURA SX	LASTRA SCURA	1

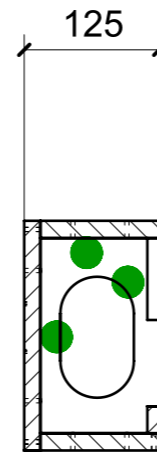
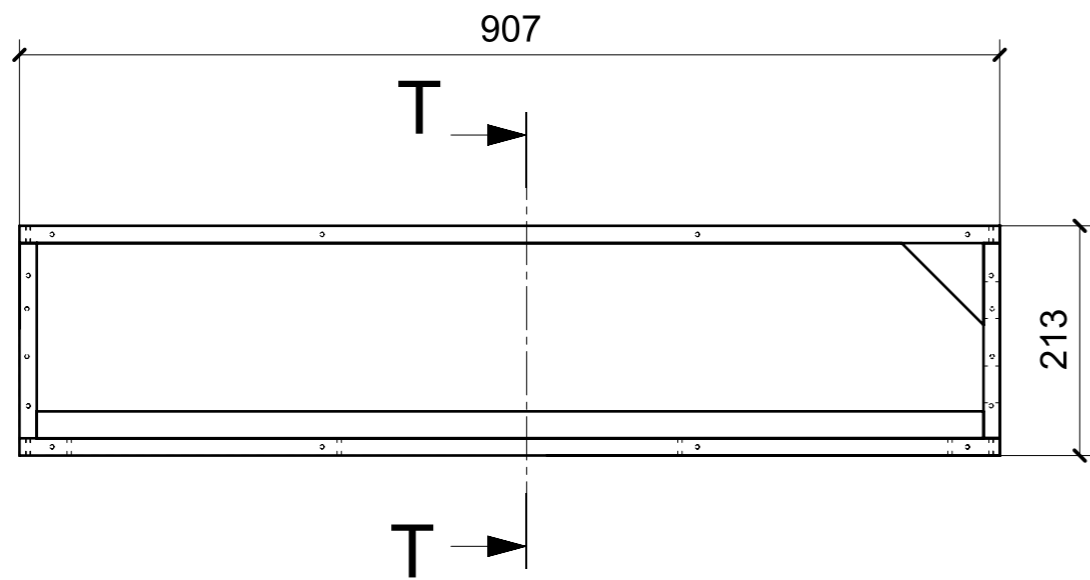

SECTION T-T

MONTATO GREZZO

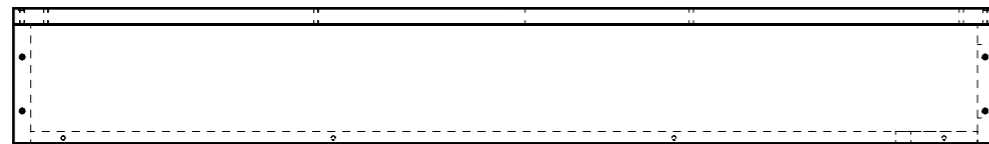
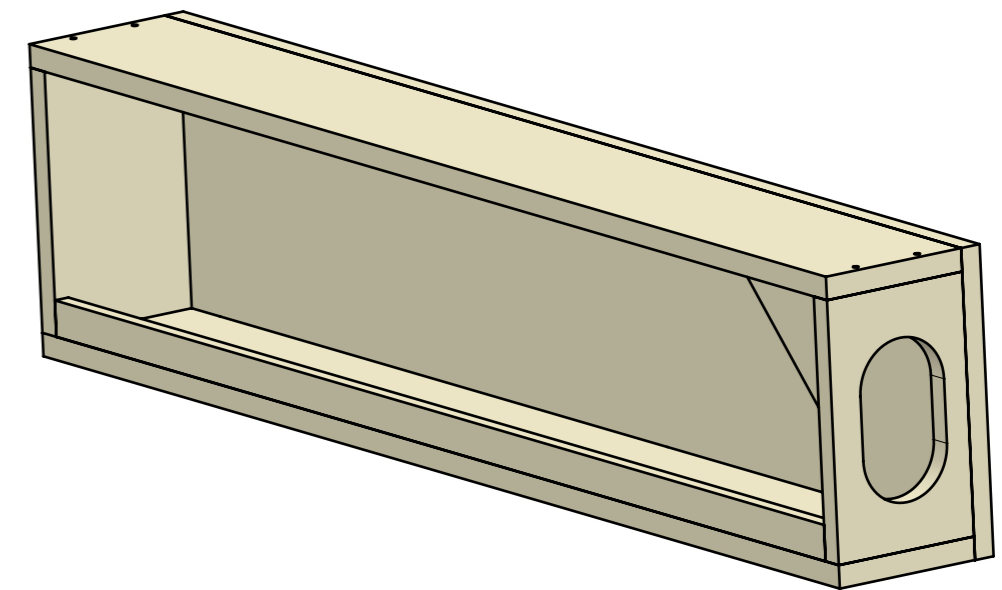

VERNICIATURA LASTRA/LACCATI:

● = VERNICIARE 1 LATO + FILI RASATI O BORDATI

NESSUN SIMBOLO = VERNICIARE 2 LATI + FILI RASATI O BORDATI

LOCALE	CODICE	DESCRIZIONE COMPONENTE	FINITURA	Q.TA
CABINA VIP	MD299_MG_VG01	ARMADIO SX	LASTRA SCURA	1

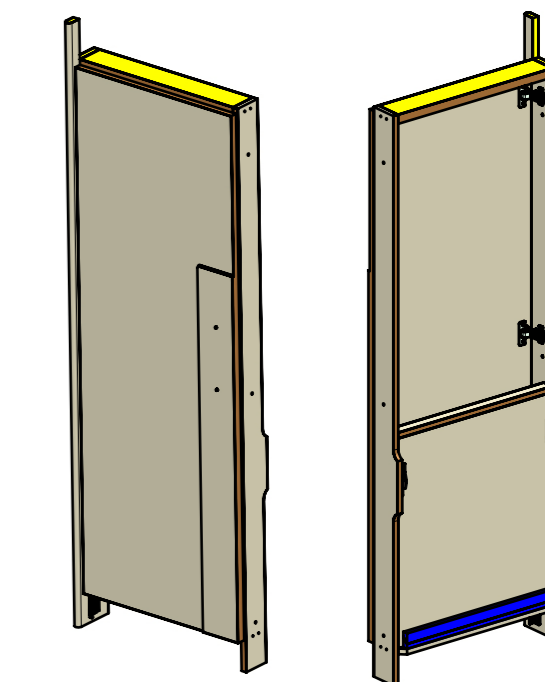
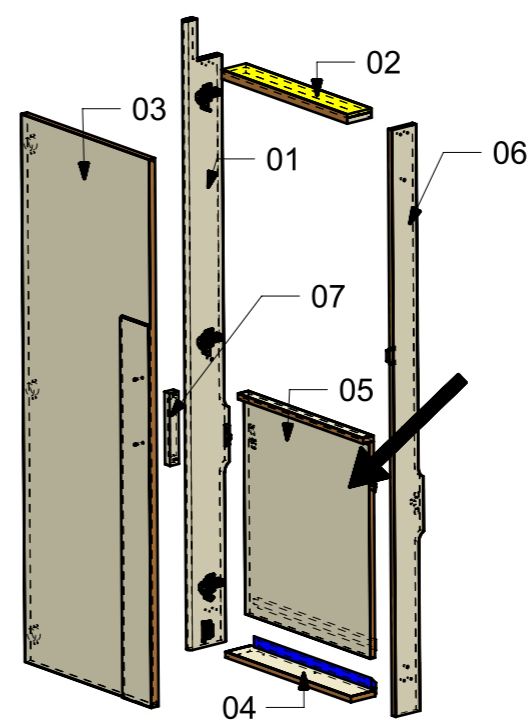
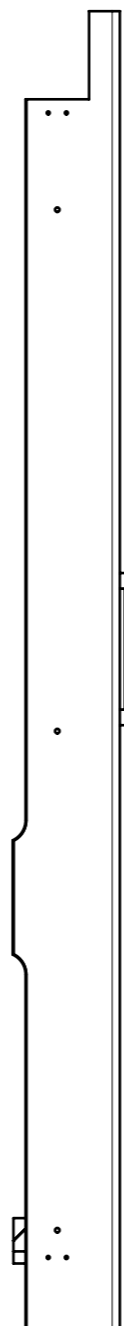
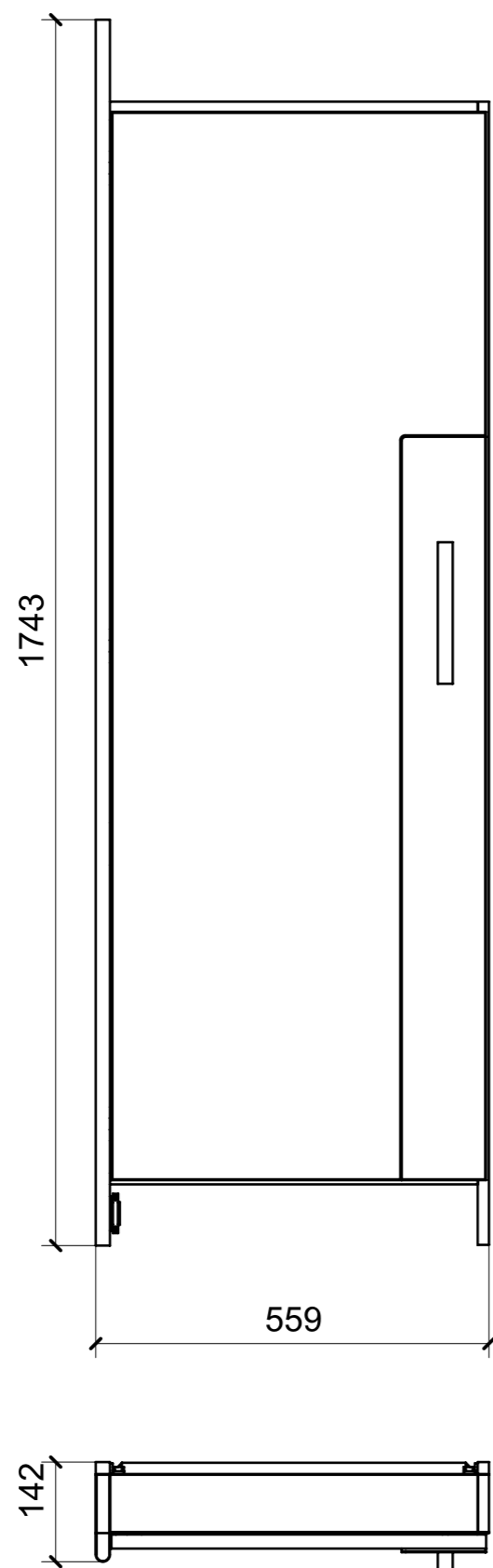

MONTATO GREZZO

FERRAMENTA	QTY
BUSSOLA 4MA X 10 FORO DIAM.6	2
CALAMITA SEALED MAGNETIC_TECNOPARTNER_MC-JM50-BL	1
PARTE TELAIO EHS_HAFELE_262_49_367 OPPOSTO	1
VITE 4MA X 30 TESTA SVASATA ESAGONALE NERA	2
GOMMINO PARACOLPO ANTA	2
MD299_R01_VG01_04	1
PARTE PANNELLO CON INCASTRO_HAFELE_262_49_356	1
PARTE PANNELLO CON INCASTRO_HAFELE_262_49_356 OPPOSTO	1
MD299_R01_VG01_02	1
CERNIERA 94° COLLO PIENO AMMORTIZZATA_HAFELE_329_49_313	3
BUSSOLA 5MA ANKOR BORGHI X CERNIERA PIANA	6
VITE 4MAX8 ANKOR BORGHI X CERNIERA COLLO PIENO	6
VITE 4MAX8 ANKOR BORGHI X CERNIERA PIANA	6
BUSSOLA 5MA ANKOR BORGHI X CERNIERA COLLO PIENO	6
BASE_6_HAFELE_329_84_026	3
CHIUSURA A SPINTA_TECHNOPARTNER_SOU C3-203	1
PARTE TELAIO EHS_HAFELE_262_49_367	1

VERNICIATURA LASTRA:

● = VERNICIARE 1 LATO + FILI RASATI O BORDATI

NESSUN SIMBOLO = VERNICIARE 2 LATI + FILI RASATI O BORDATI

LOCALE	CODICE	DESCRIZIONE COMPONENTE	FINITURA	Q.TA
CABINA VIP	MD299_MG_VH01	ARMADIO DX	LAMINATO	1

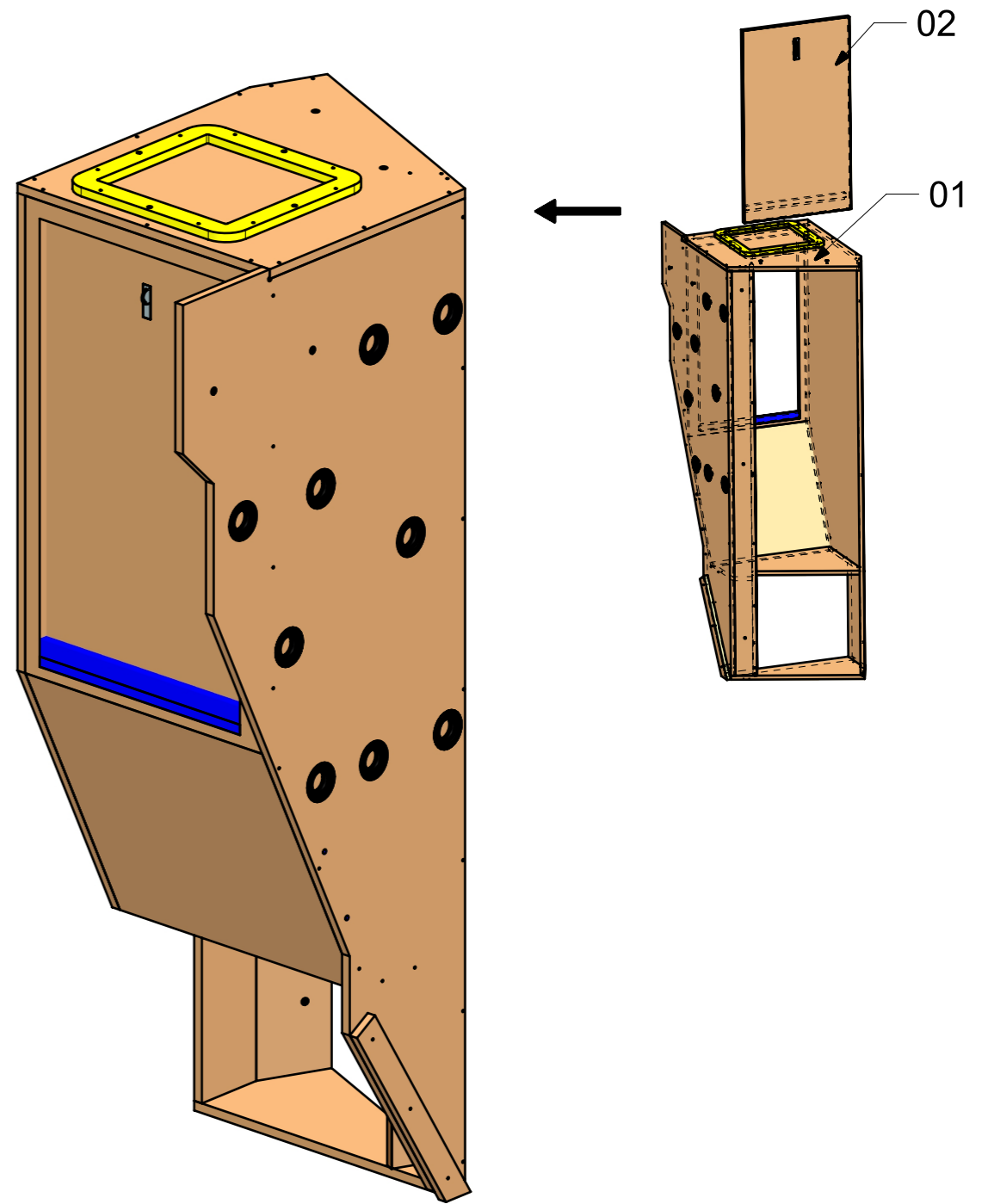
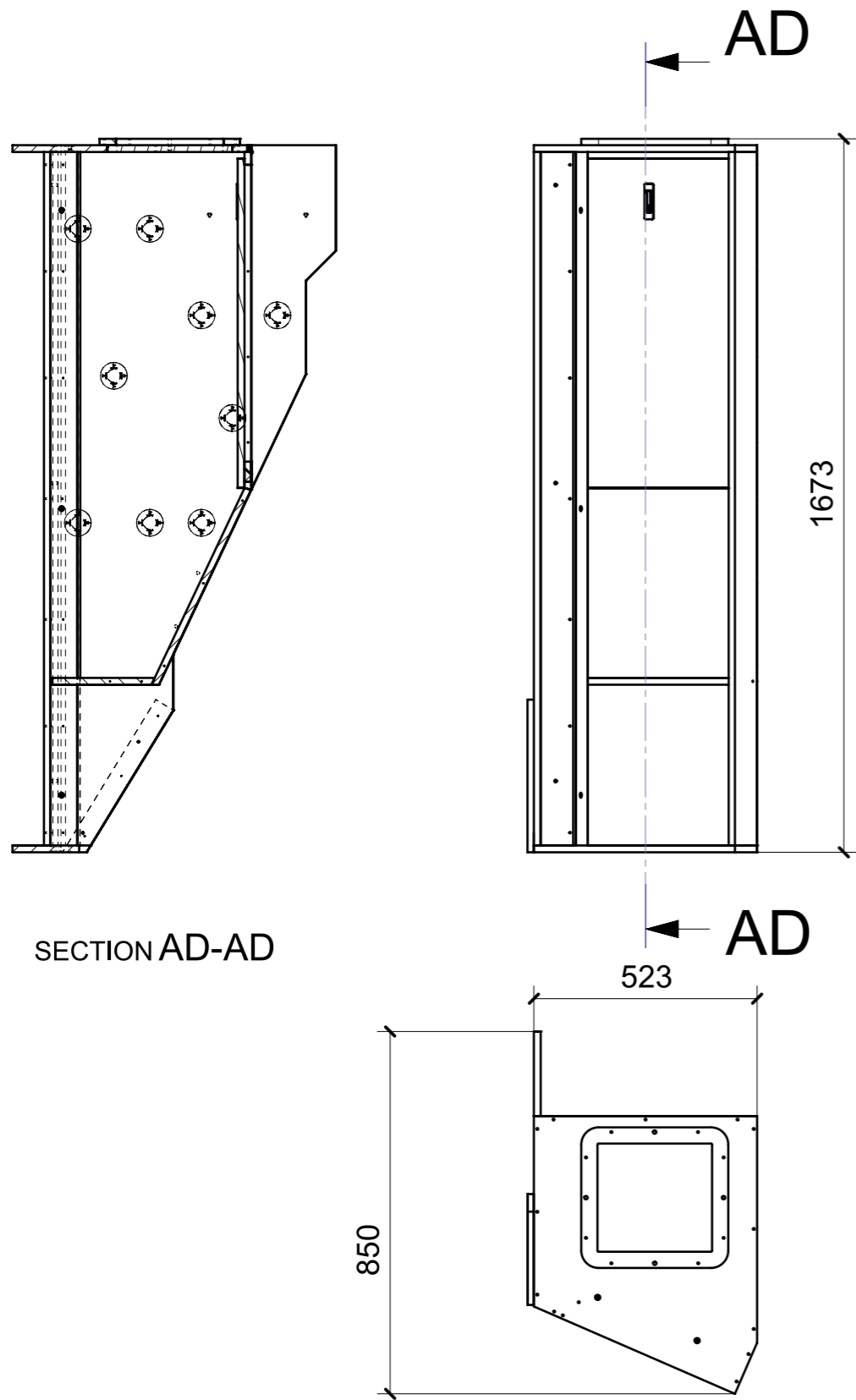

FERRAMENTA	QTY
BUSSOLA 5MA X 10 FORO DIAM.8	6
FITLOCK F_MASCHERPA_6020101102	9
ALZAPAGLIOLI_FORESTI_164.C	1
BUSSOLA 6MA X 10 FORO DIAM.8	4

LOCALE	CODICE	DESCRIZIONE COMPONENTE	FINITURA	Q.TA
CABINA VIP	MD299_MG_VH02	ARMADIO DX	LASTRA SCURA	1

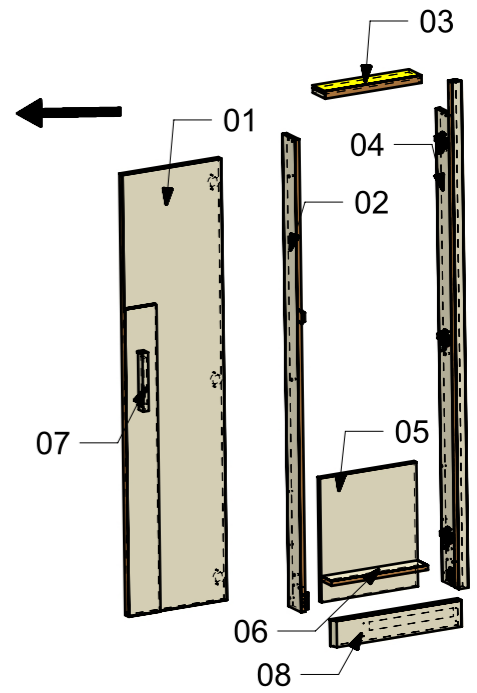
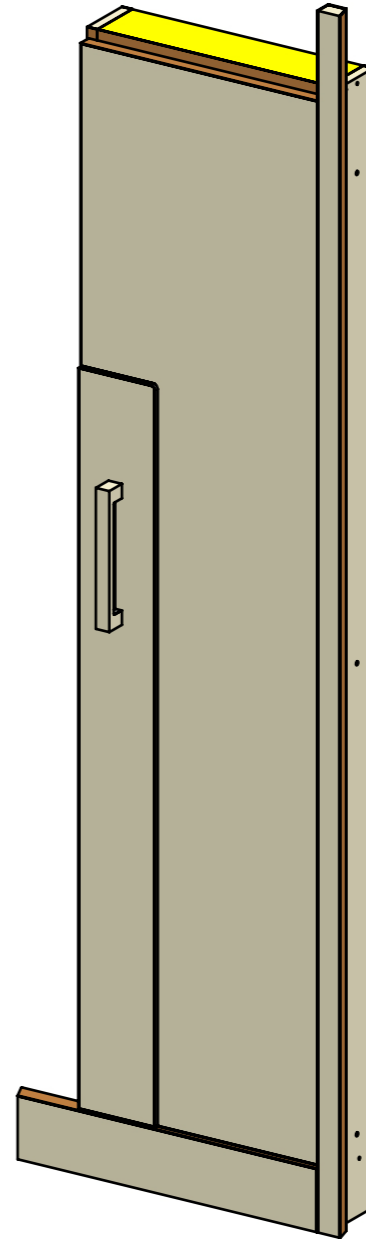
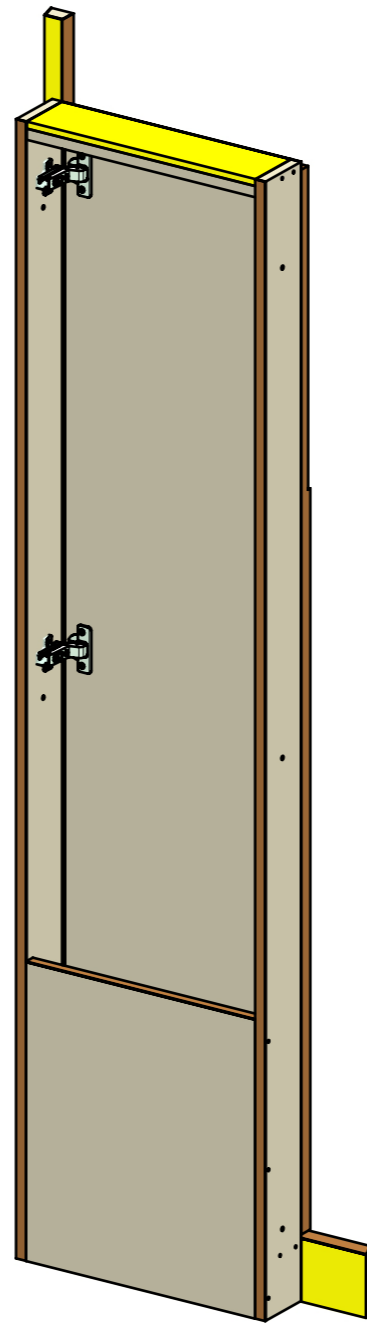
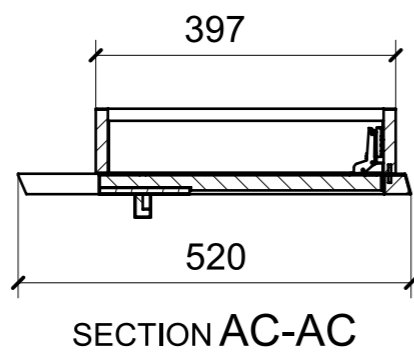
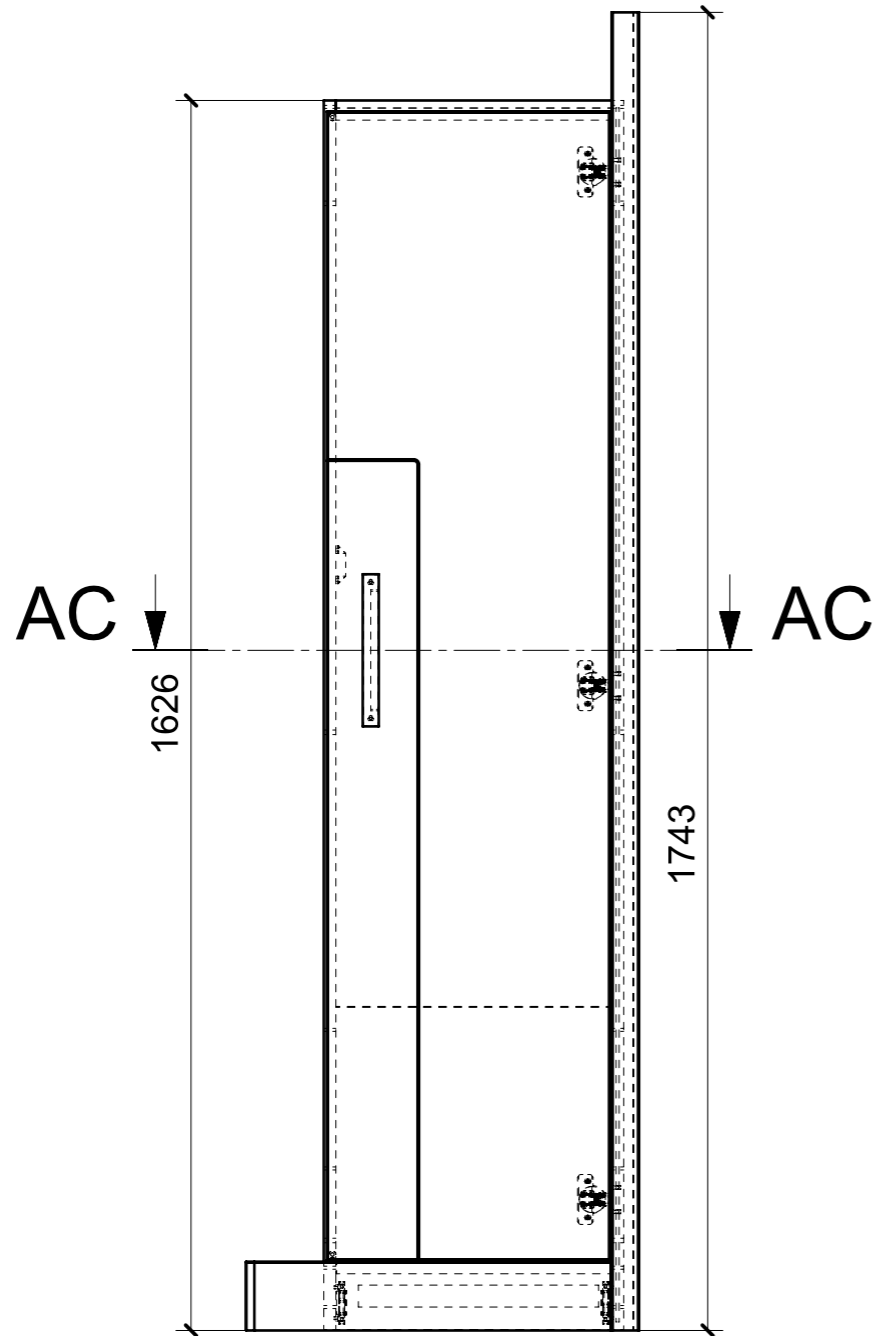
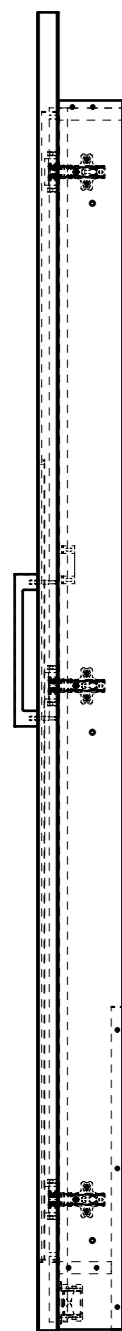

FERRAMENTA	QTY
BUSSOLA 4MA X 10 FORO DIAM.6	2
BASE_6_HAFELE_329_84_026	3
CERNIERA 94° COLLO PIENO AMMORTIZZATA_HAFELE_329_49_313	3
VITE 4MAX8 ANKOR BORGHI X CERNIERA PIANA	6
BUSSOLA 5MA ANKOR BORGHI X CERNIERA COLLO PIENO	6
VITE 4MAX8 ANKOR BORGHI X CERNIERA COLLO PIENO	6
BUSSOLA 5MA ANKOR BORGHI X CERNIERA PIANA	6
VITE 4MA X 30 TESTA SVASATA ESAGONALE NERA	2
GOMMINO PARACOLPO ANTA	2
CALAMITA SEALED MAGNETIC_TECNOPARTNER_MC-JM50-BL	1
CHIUSURA A SPINTA_TECNOPARTNER_SOU C3-203	2

LOCALE	CODICE	DESCRIZIONE COMPONENTE	FINITURA	Q.TA
CABINA VIP	MD299_MG_VI01	PENSILE SX	LACCATO BIANCO 9010	1

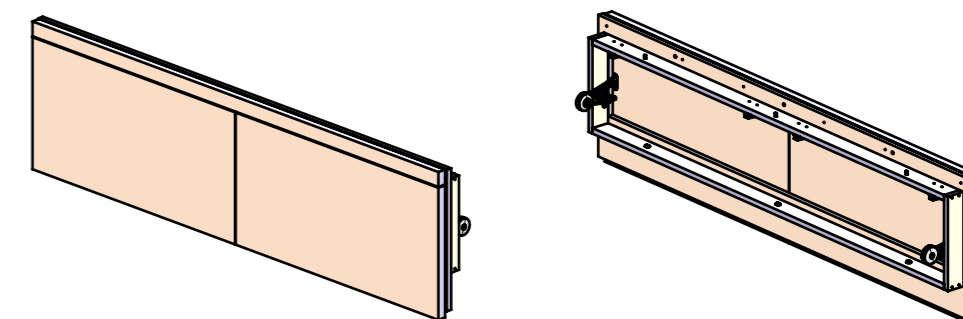
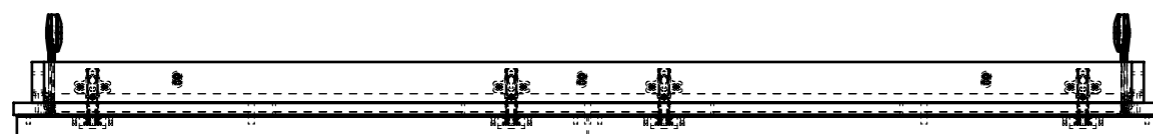
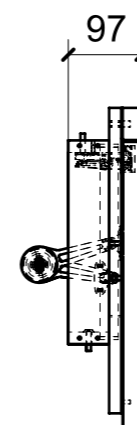
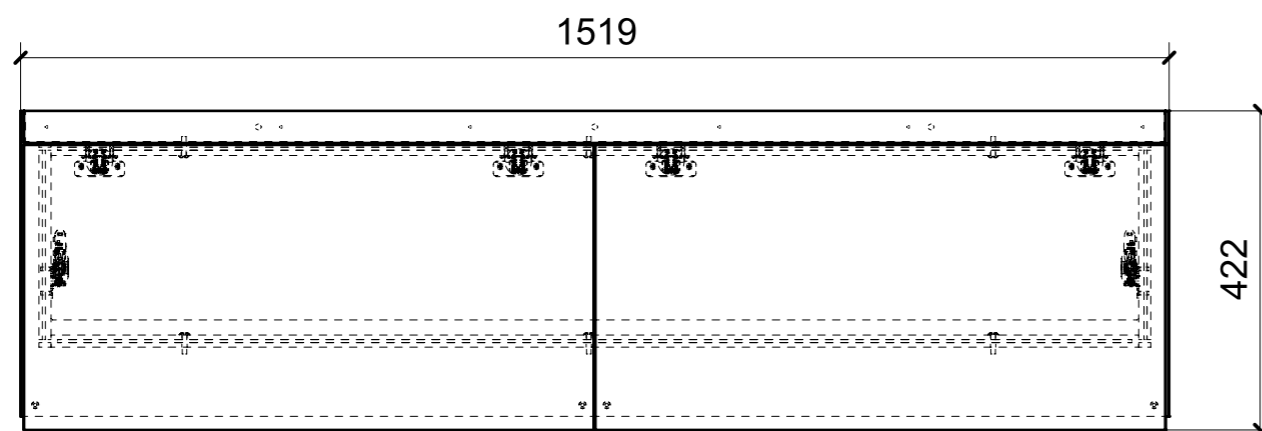

ELEMENTI DA MONTARE IN MG_VI01
e spedire con unico imballo

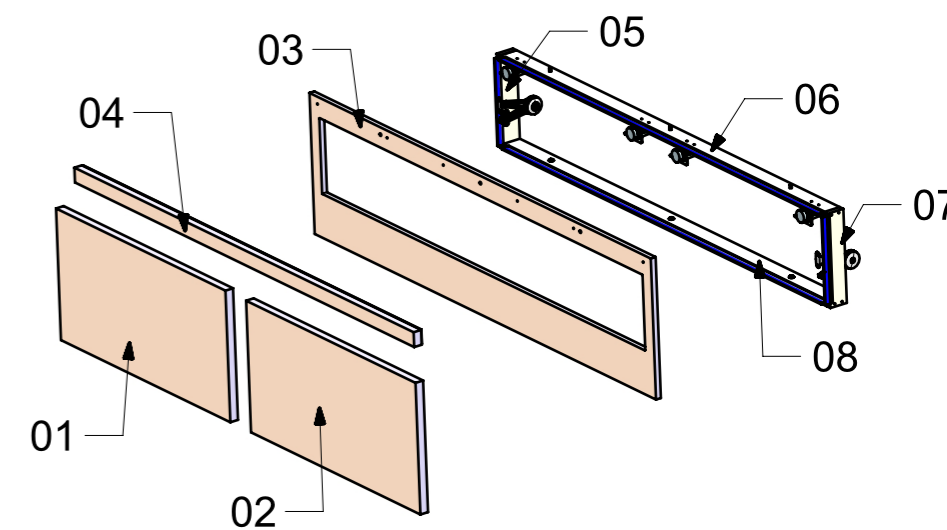

FERRAMENTA	QTY
BASE_6_HAFELE_329_84_026	4
BRACCETTO PER ANTA_HAFELE_373_66_611	1
BRACCETTO PER ANTA_HAFELE_373_66_611MIRROR_	1
BUSSOLA 5MA ANKOR BORGHIS X CERNIERA PIANA	16
CERNIERA 94° PIANA AMMORTIZZATA_HAFELE_329_49_310	4
GOMMINO PARACOLPO ANTA	4
VITE 4MAX8 ANKOR BORGHIS X CERNIERA PIANA	16
VITE 6MA X 25 TESTA BOMBATA	6

LOCALE	CODICE	DESCRIZIONE COMPONENTE	FINITURA	Q.TA
CABINA VIP	MD299_MG_VL01	PENSILE DX	LACCATO BIANCO 9010	1

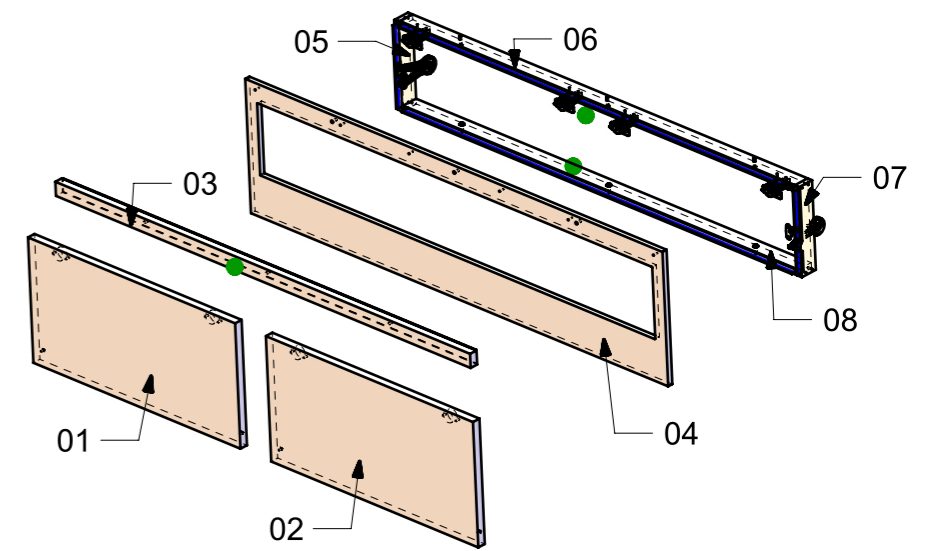
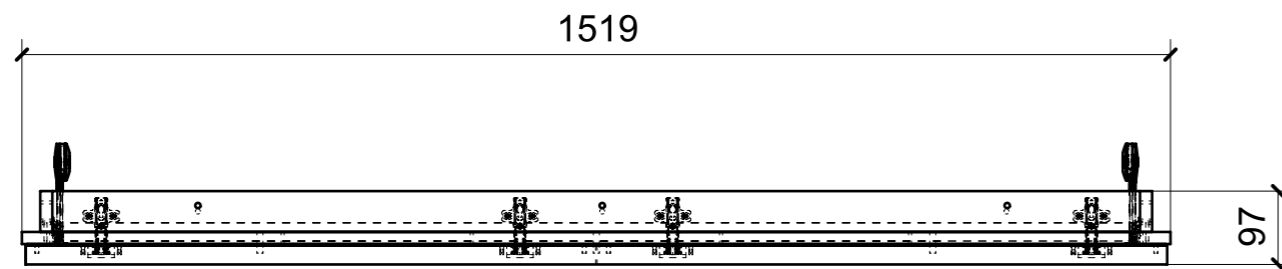
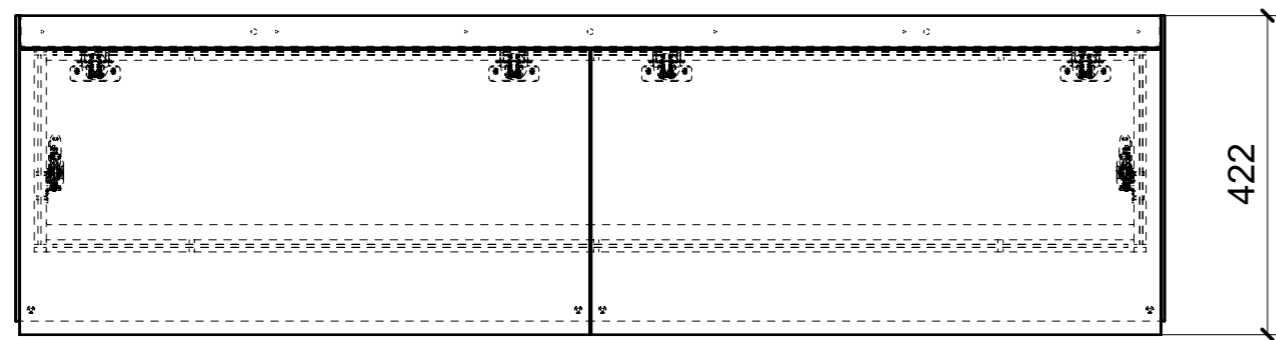
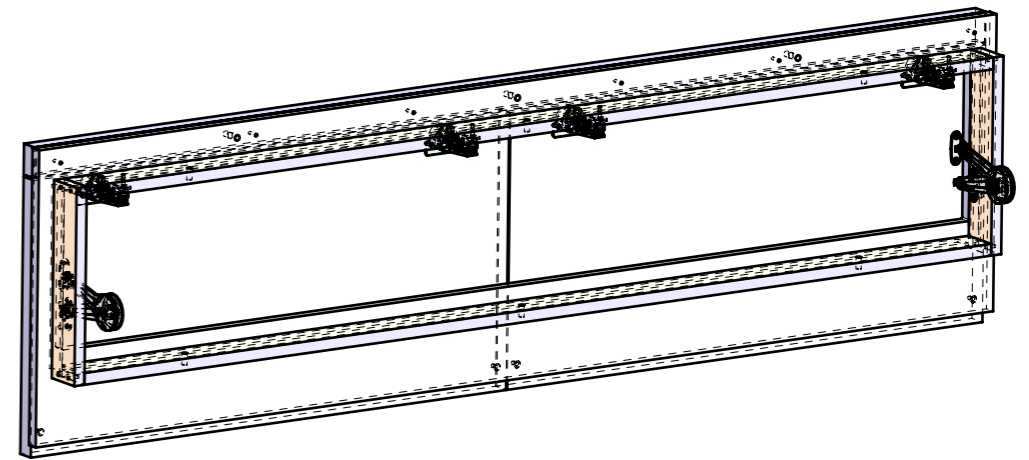
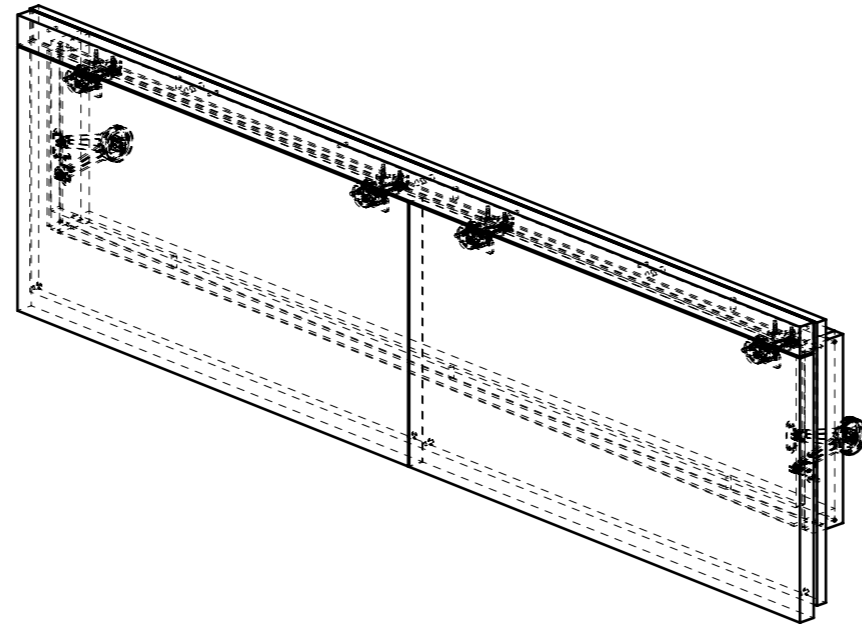

FERRAMENTA	QTY
BASE_6_HAFELE_329_84_026	4
BRACCETTO PER ANTA_HAFELE_373_66_611	1
BRACCETTO PER ANTA_HAFELE_373_66_611MIRROR_	1
BUSSOLA 5MA ANKOR BORGHI X CERNIERA PIANA	16
CERNIERA 94° PIANA AMMORTIZZATA_HAFELE_329_49_310	4
GOMMINO PARACOLPO ANTA	4
VITE 4MAX8 ANKOR BORGHI X CERNIERA PIANA	16