

LOCALE	CODICE	DESCRIZIONE COMPONENTE	FINITURA	Q.TA
BAGNO ARMATORE	MD298_R01_WA01	STRUTTURA MURATA	LASTRA CHIARA	1

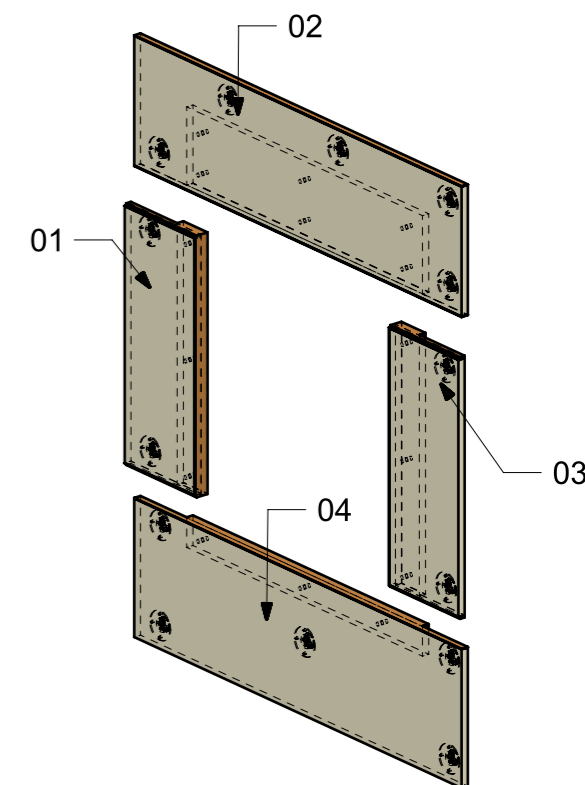
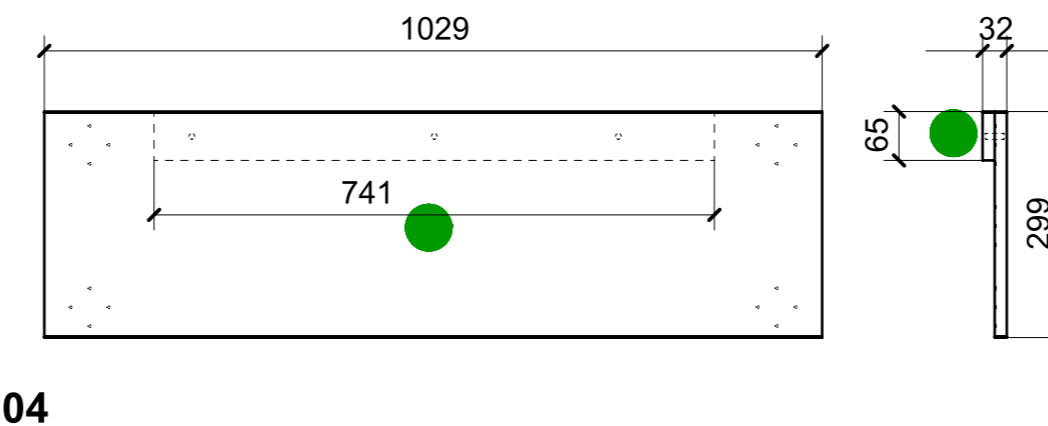
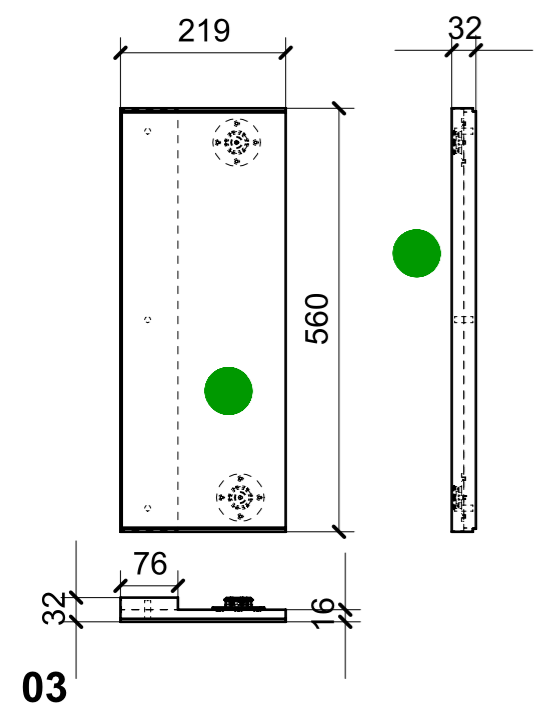
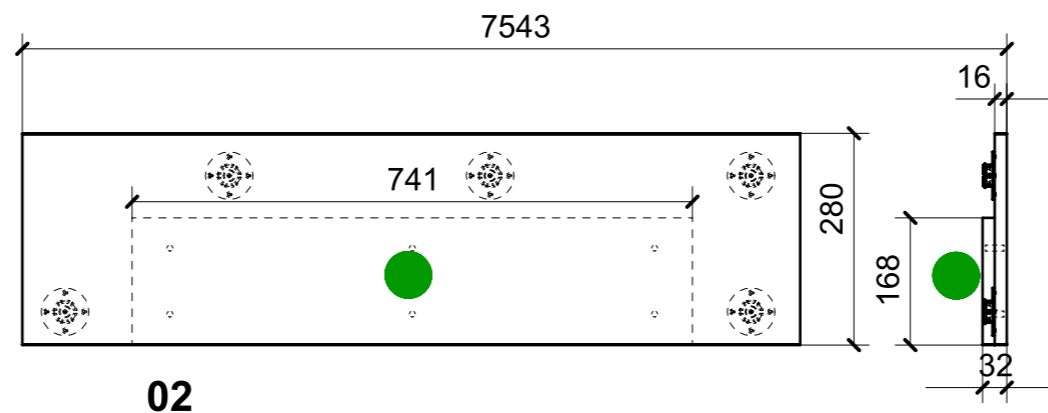
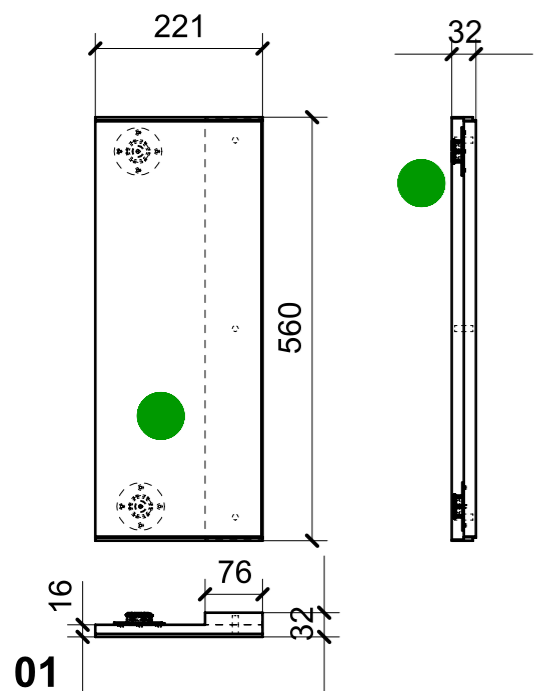

FERRAMENTA	QTY
FITLOCK M_MASCHERPA_3MM_6020202101	14

VERNICIATURA LASTRA/LACCATI:

● = VERNICIARE 1 LATO + FILI RASATI O BORDATI

NESSUN SIMBOLO = VERNICIARE 2 LATI + FILI RASATI O BORDATI

LOCALE	CODICE	DESCRIZIONE COMPONENTE	FINITURA	GR
BAGNO ARMATORE	MD298_R01_WB01	RIV. PARETE DI POPPA	LASTRA CHIARA	8

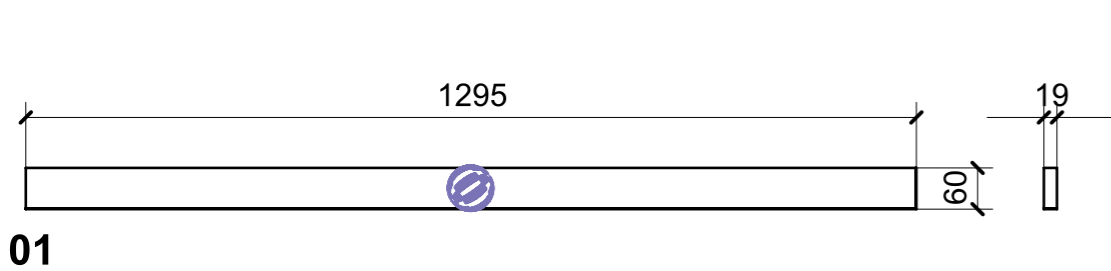

01

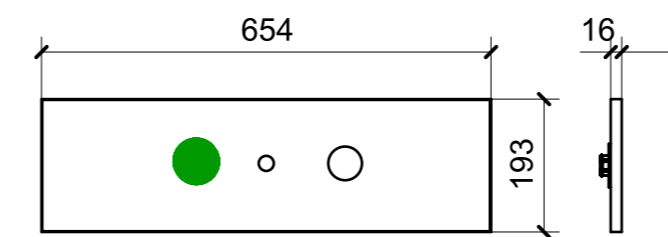

06

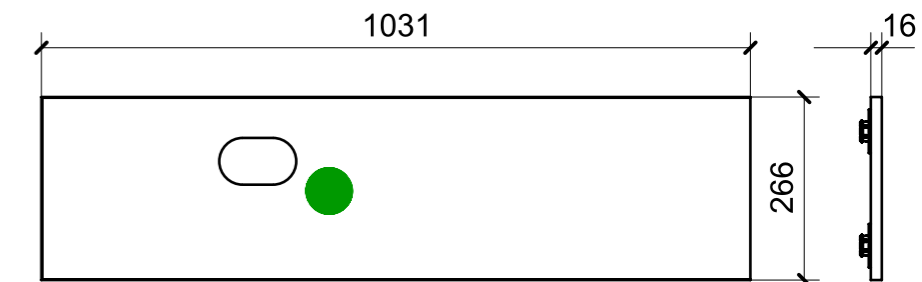

07

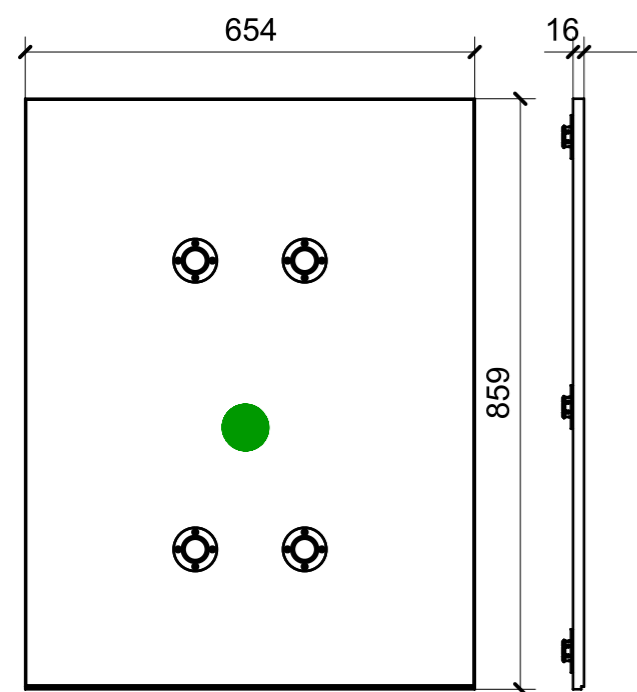

02

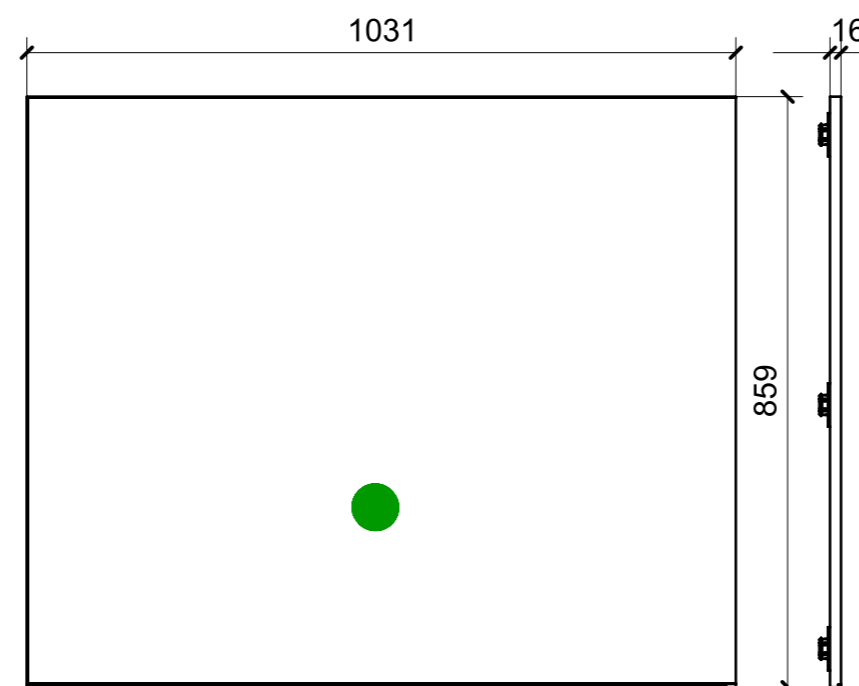

04

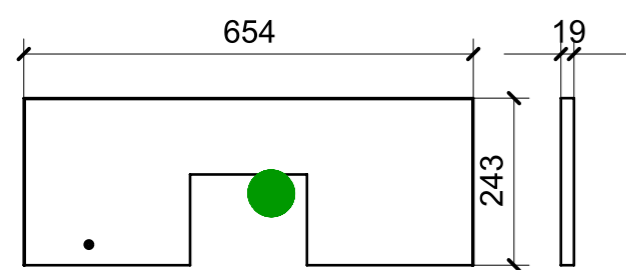
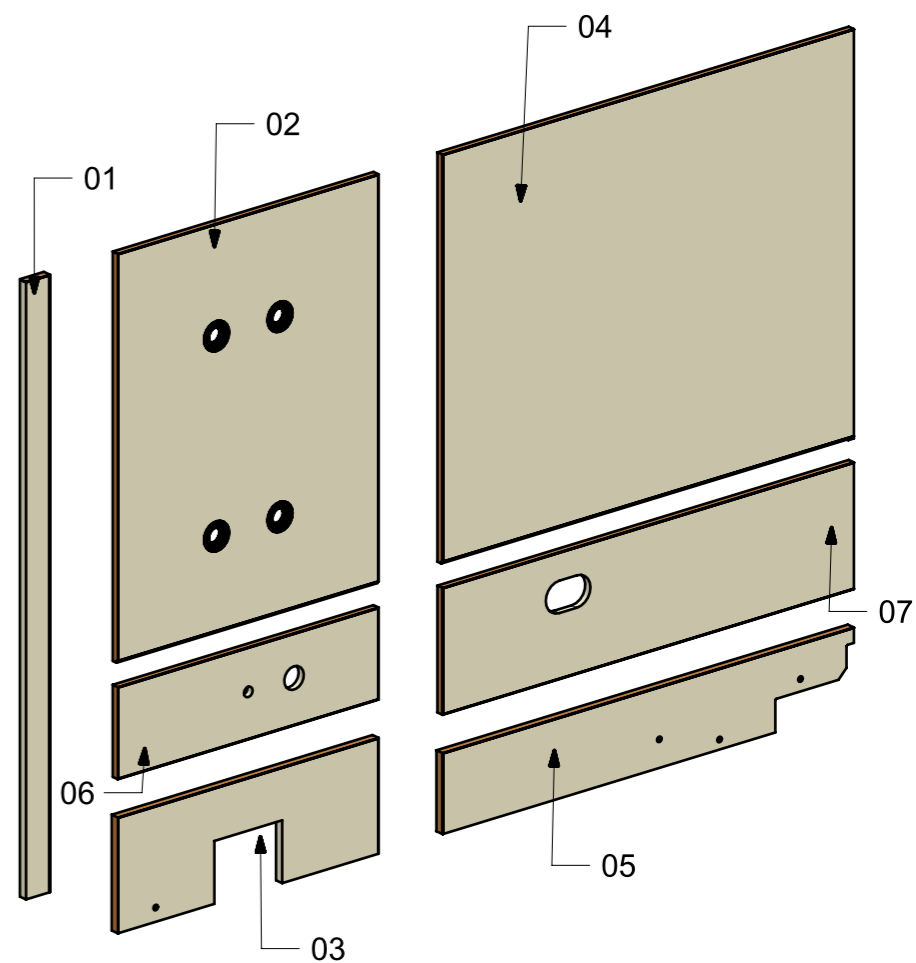

03

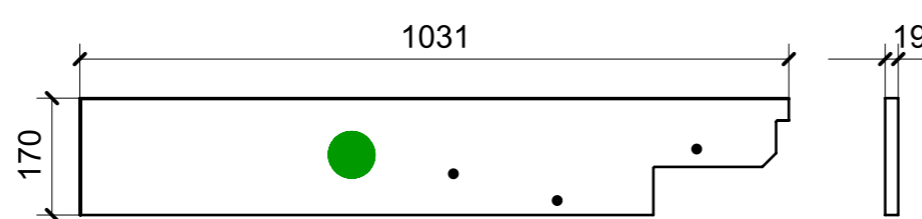

05

FERRAMENTA	QTY
FITLOCK F_MASCHERPA_6020101102	4
FITLOCK M_MASCHERPA_3MM_6020202101	24
BUSSOLA 5MA X 10 FORO DIAM.8	4

VERNICIATURA LASTRA/LACCATI:

● = VERNICIARE 1 LATO + FILI RASATI O BORDATI

NESSUN SIMBOLO = VERNICIARE 2 LATI + FILI RASATI O BORDATI

LOCALE	CODICE	DESCRIZIONE COMPONENTE	FINITURA	GR
BAGNO ARMATORE	MD298_R01_WD01	MOBILE A MURATA	LASTRA CHIARA	8

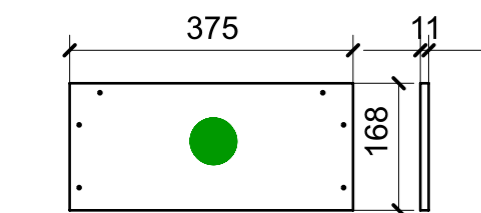
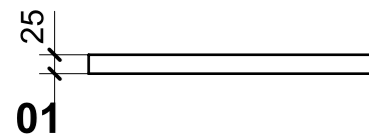
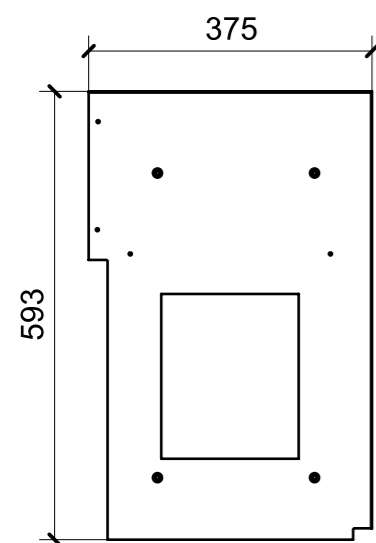

09

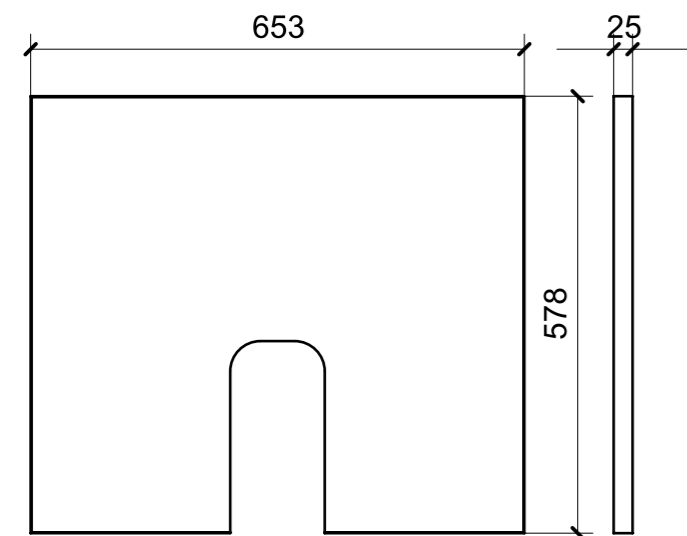

05

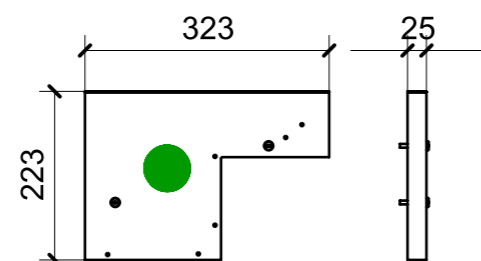

02

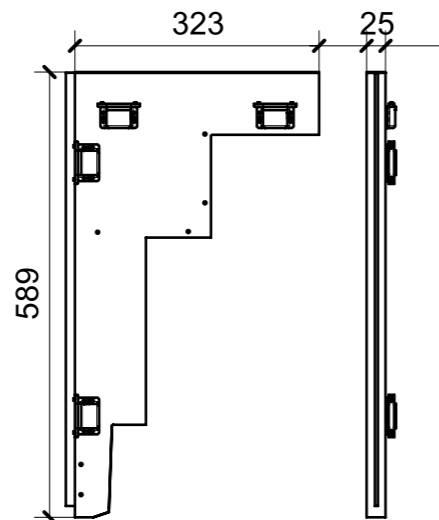

04

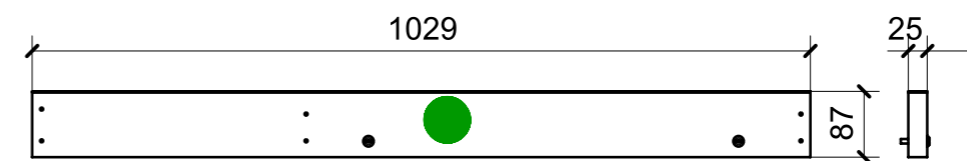

03

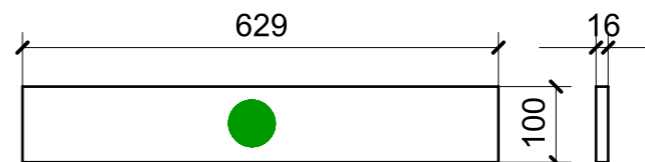

06

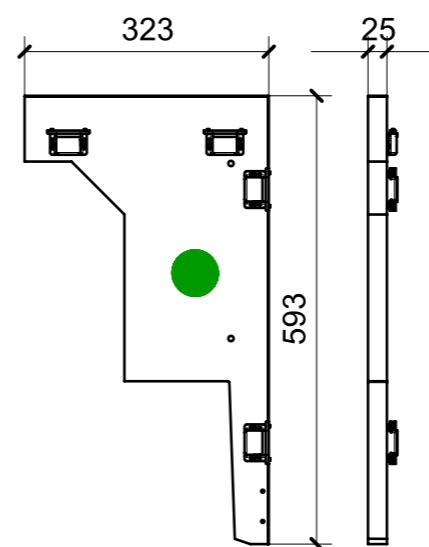

07

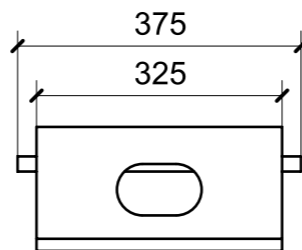

08

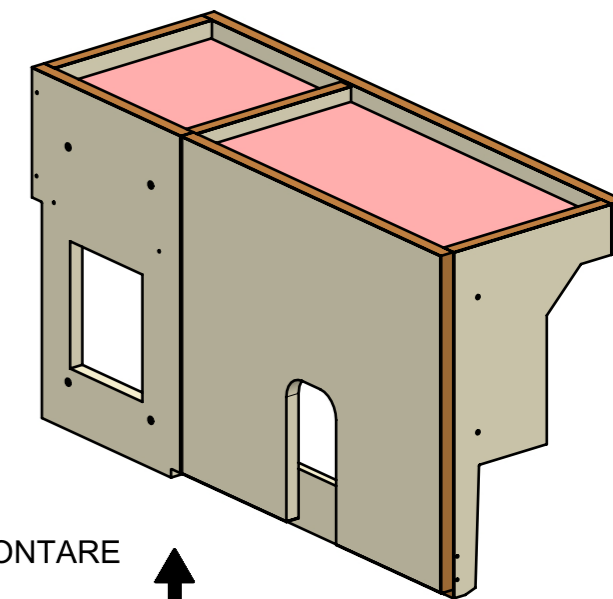
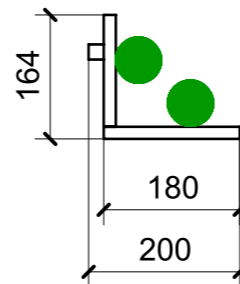

ELEMENTI DA MONTARE  
in MF\_WD01  
e spedire con unico imballo

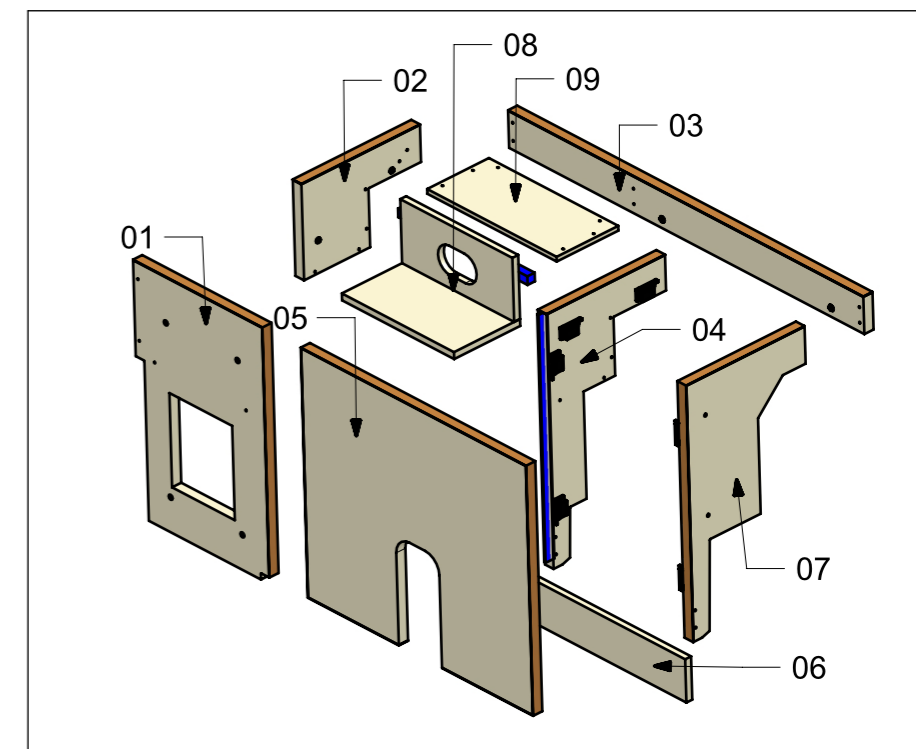

FERRAMENTA	QTY
BUSSOLA 5MA X 10 FORO DIAM.8	4
CHIUSURA A SPINTA_TECHNOPARTNER_SOU C3-203	8
VITE 5MA X 35 TESTA BOMBATA	2
VITE 6MA X 35 TESTA BOMBATA	2

VERNICIATURA LASTRA/LACCATI:

● = VERNICIARE 1 LATO + FILI RASATI O BORDATI

NESSUN SIMBOLO = VERNICIARE 2 LATI + FILI RASATI O BORDATI

LOCALE	CODICE	DESCRIZIONE COMPONENTE	FINITURA	GR
BAGNO ARMATORE	MD298_R01_WE01	MOBILE LAVABO	LASTRA CHIARA	8

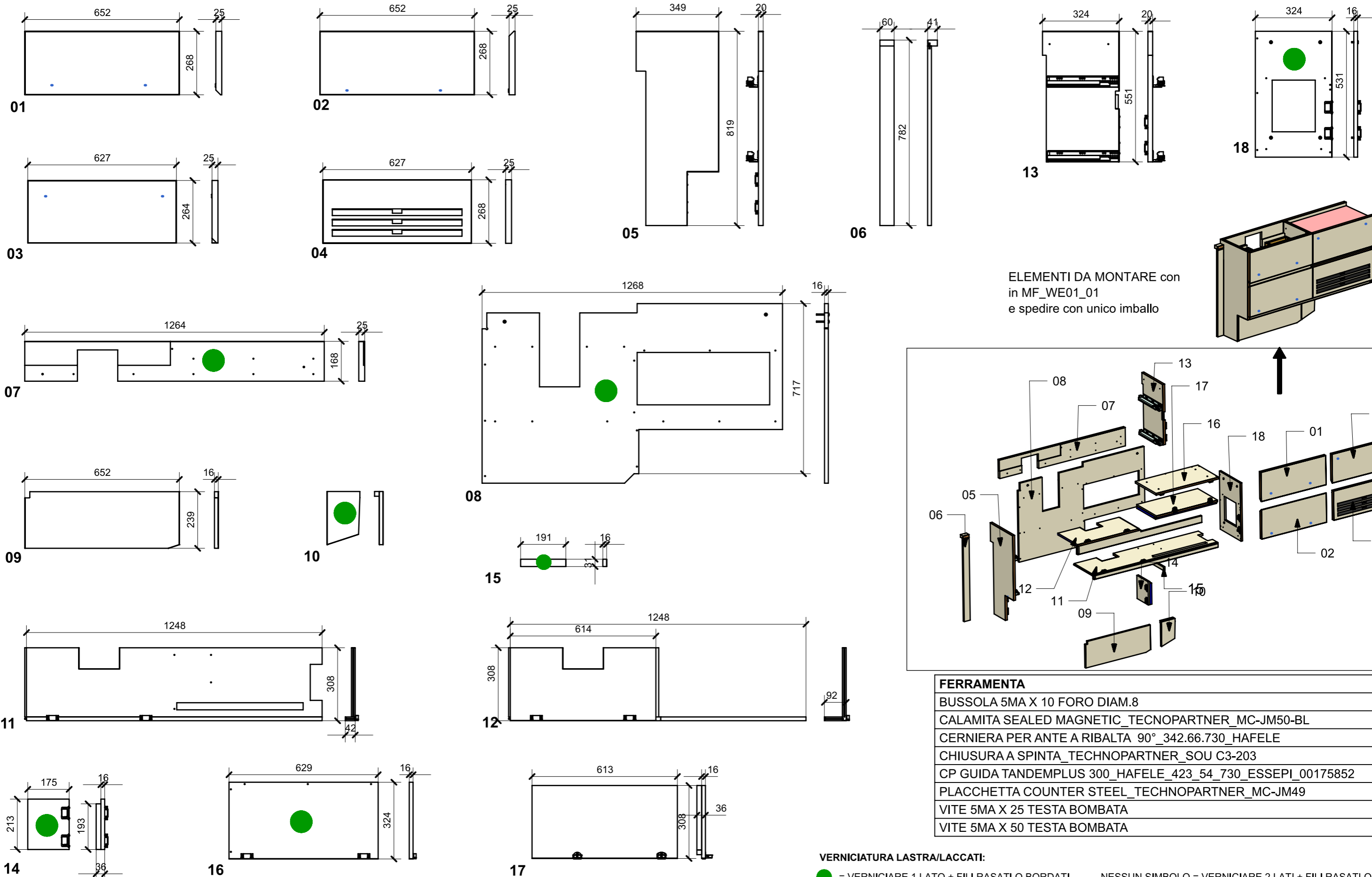

ELEMENTI DA MONTARE con  
in MF\_WE01\_01  
e spedire con unico imballo

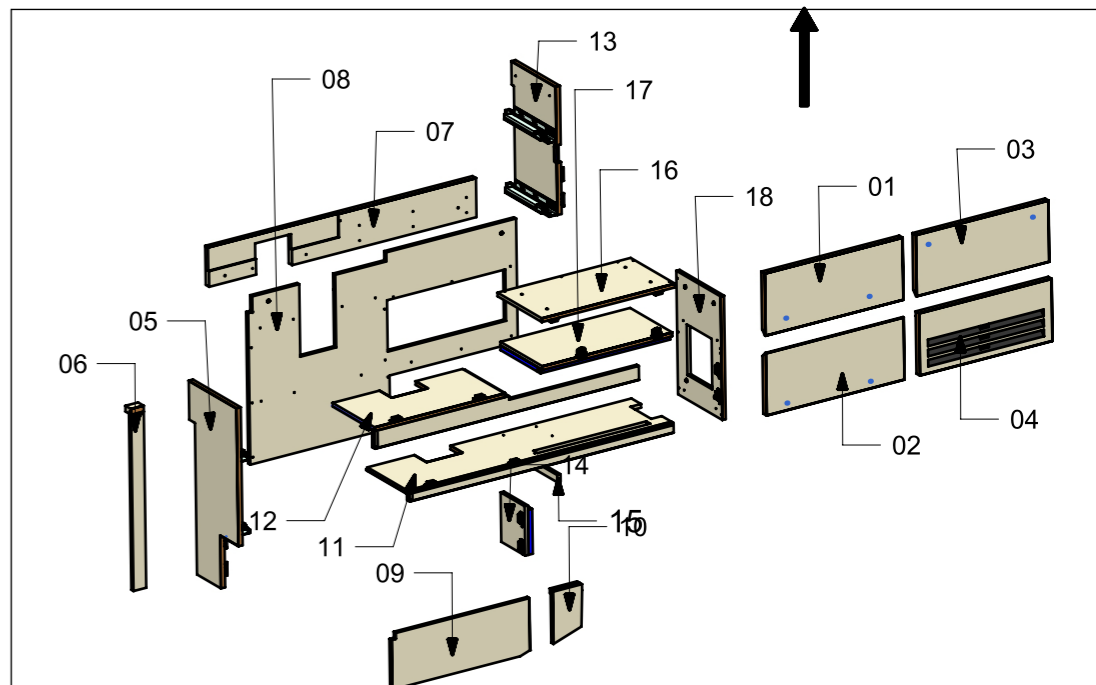

FERRAMENTA	QTY
BUSSOLA 5MA X 10 FORO DIAM.8	8
CALAMITA SEALED MAGNETIC_TECNOPARTNER_MC-JM50-BL	6
CERNIERA PER ANTE A RIBALTA 90°_342.66.730_HAFELE	2
CHIUSURA A SPINTA_TECNOPARTNER_SOU C3-203	8
CP GUIDA TANDEMPPLUS 300_HAFELE_423_54_730_ESSEPI_00175852	2
PLACCHETTA COUNTER STEEL_TECNOPARTNER_MC-JM49	6
VITE 5MA X 25 TESTA BOMBATA	4
VITE 5MA X 50 TESTA BOMBATA	2

VERNICIATURA LASTRA/LACCATI:  
 = VERNICIARE 1 LATO + FILI RASATI O BORDATI      NESSUN SIMBOLO = VERNICIARE 2 LATI + FILI RASATI O BORDATI