

AZ68F

REV. 10-01-2022

LOCALE	CODICE	DESCRIZIONE COMPONENTE	FINITURA	Q.TA	OPERATORE
CABINA OSPITI DX	AZ68F-MG_RC01/RC02	STRUTTURA A MURATA			Damiano

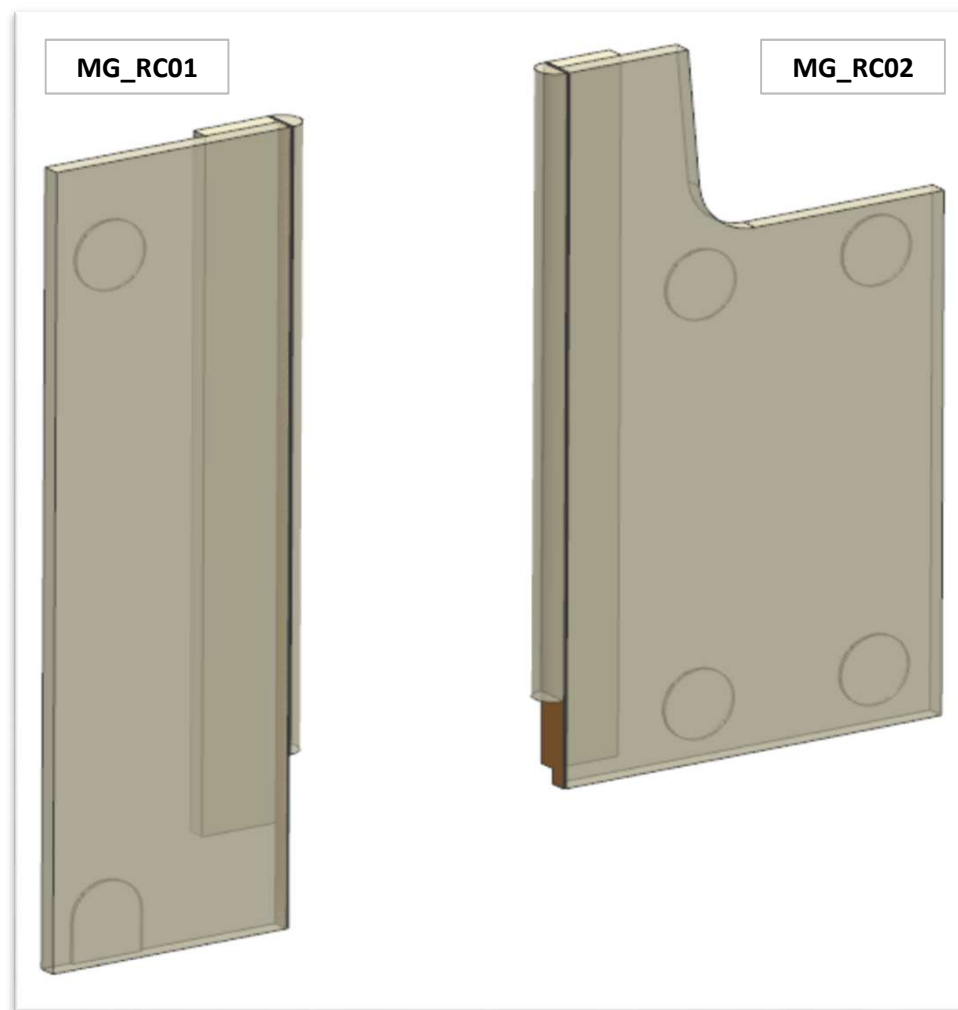

AZ68F

REV. 29-04-2024

LOCALE	CODICE	DESCRIZIONE COMPONENTE	FINITURA	Q.TA	OPERATORE
CABINA OSPITI DX	AZ68F-R01_RC01	STRUTTURA A MURATA	LASTRA CHIARA	13	Damiano

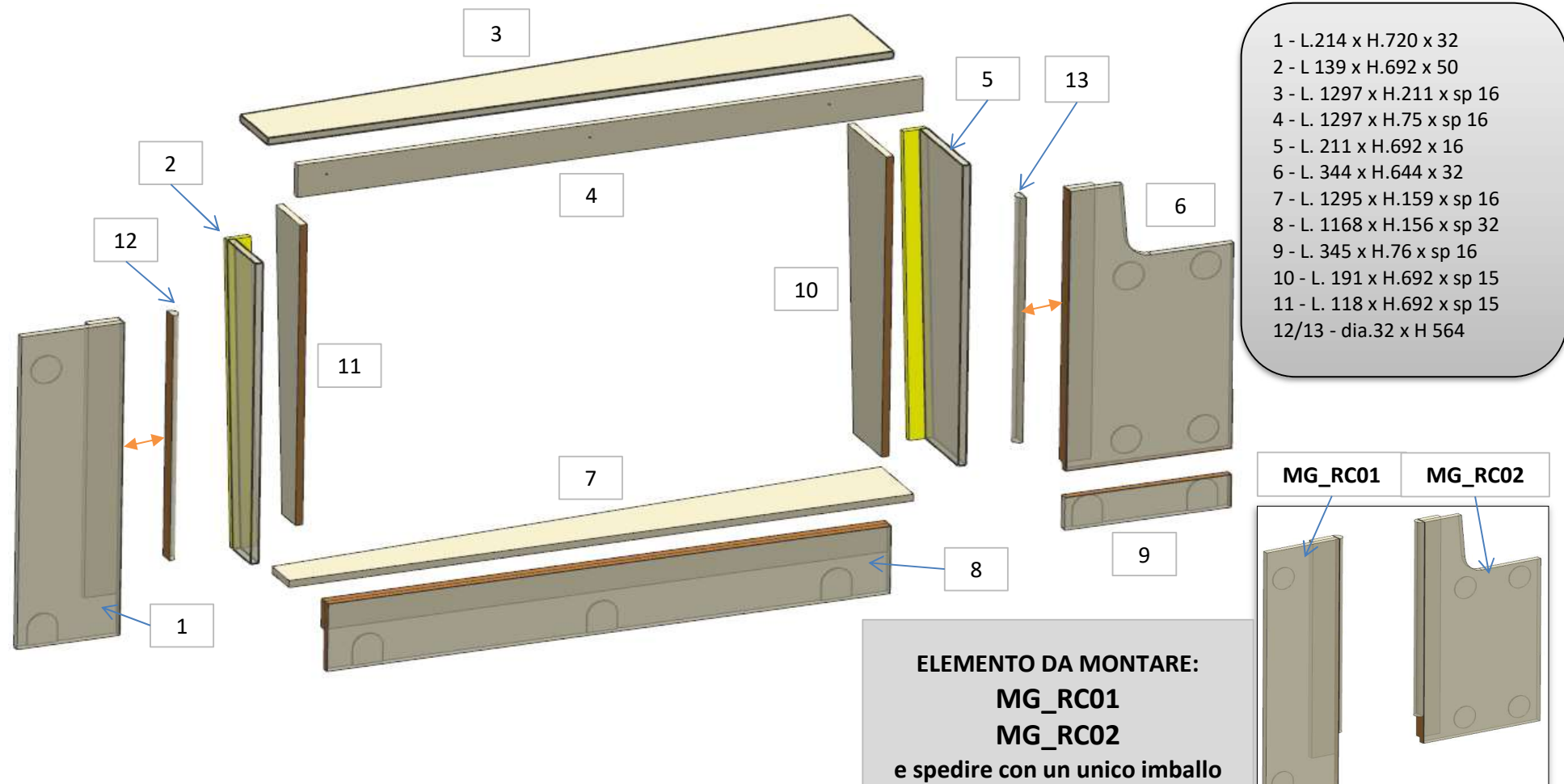

AZ68F

DA MAT. 265 REV. 29-04-2024

LOCALE	CODICE	DESCRIZIONE COMPONENTE	FINITURA	Q.TA	OPERATORE
CABINA OSPITI DX	AZ68F-R01_RD01	PENSILE	LASTRA CHIARA	5	Damiano

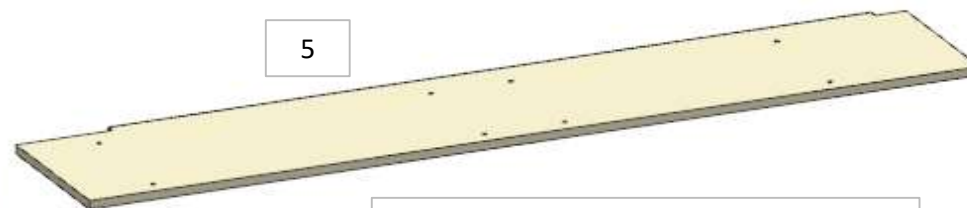
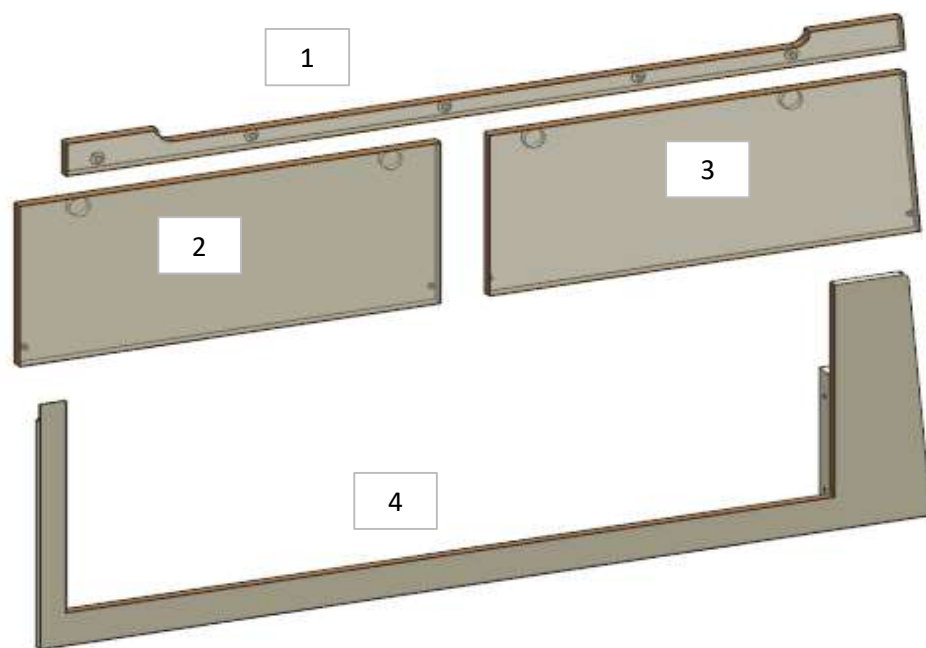

PZ 1-2-3 NON PIÙ DA MONTARE CON MF_RD01

ELEMENTO DA MONTARE con:
RD01
e spedire con un unico imballo

- 1 - L. 1420 x H.61 x sp 20
- 2 - L. 714 x H 298 x sp 20
- 3 - L. 705 x H 298 x sp 20
- 4 - L. 1509 x H.455 x sp 16
- 5 - L. 1508 x H.296 x sp 16

RD02

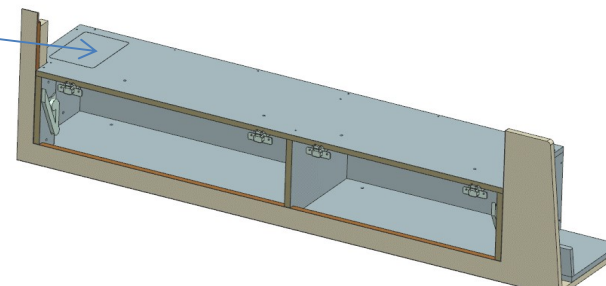

AZ68F

DA MAT.216

REV. 29-04-2024

LOCALE	CODICE	DESCRIZIONE COMPONENTE	FINITURA	Q.TA	OPERATORE
CABINA OSPITI DX	AZ68F-R01_RE01	TESTALETTO	LASTRA CHIARA	2	Damiano

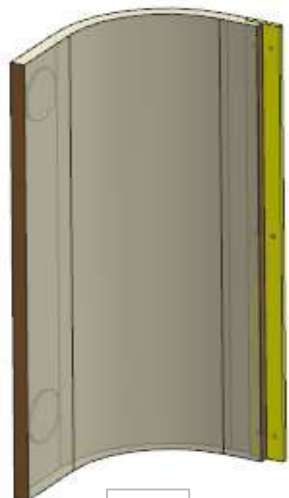

1

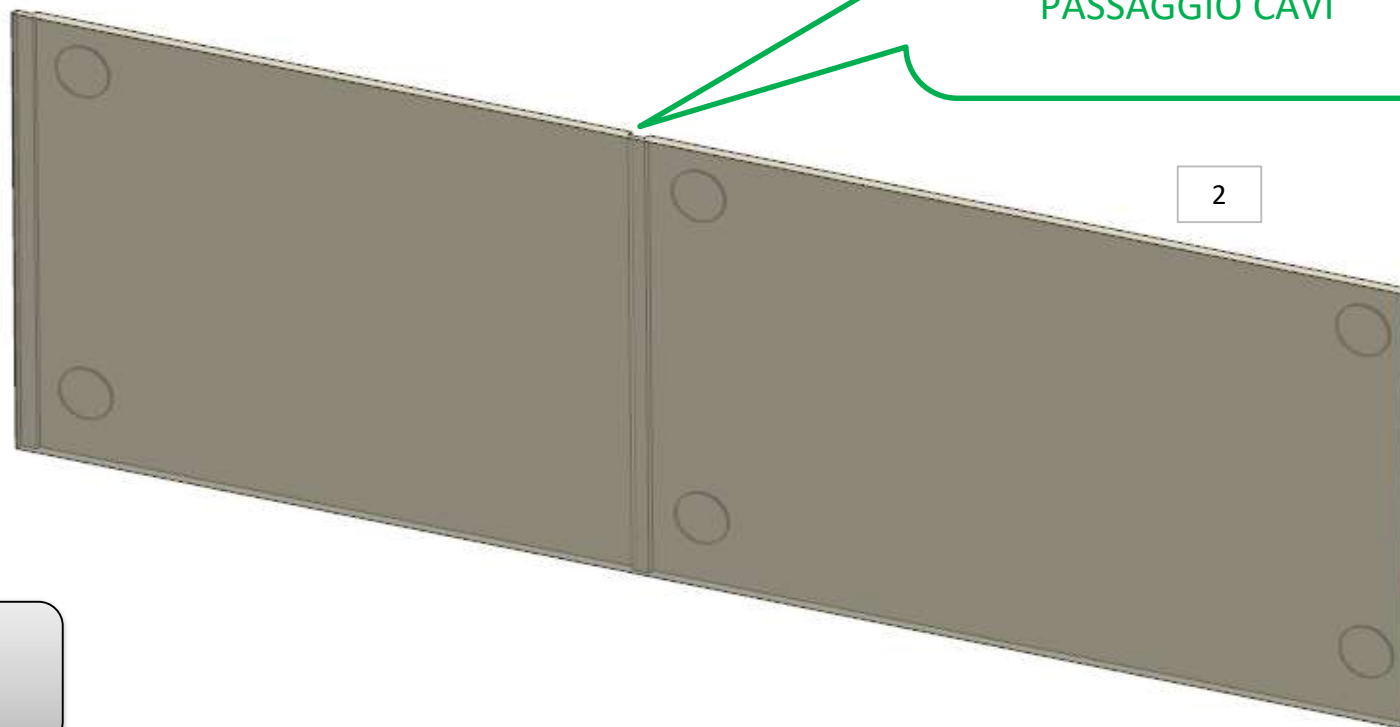

2

212
AGGIUNTO
ABBASSAMENTO PER
PASSAGGIO CAVI

1 - L 350 x H 549 x sp 16mm
2 - L 1655 x H 549 x sp 16mm

AZ68F

REV. 29-04-2024

LOCALE	CODICE	DESCRIZIONE COMPONENTE	FINITURA	Q.TA	OPERATORE
CABINA OSPITI DX	AZ68F-MF_RH01	SPECCHIERA TV			Damiano

FRONTE

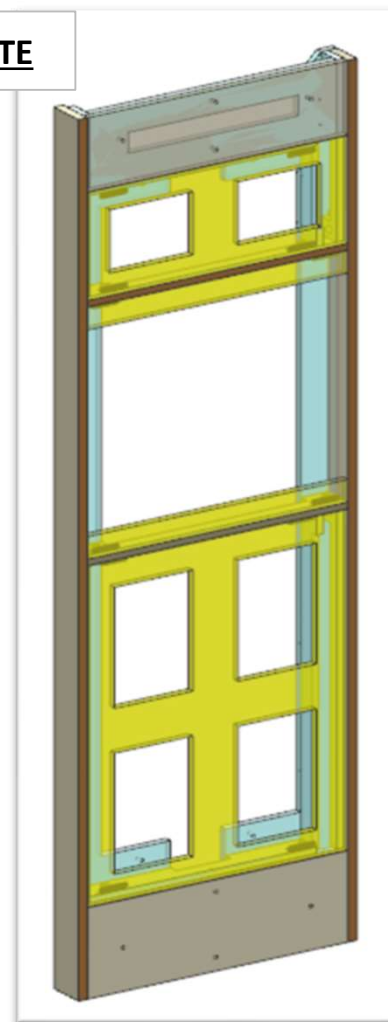

RETRO

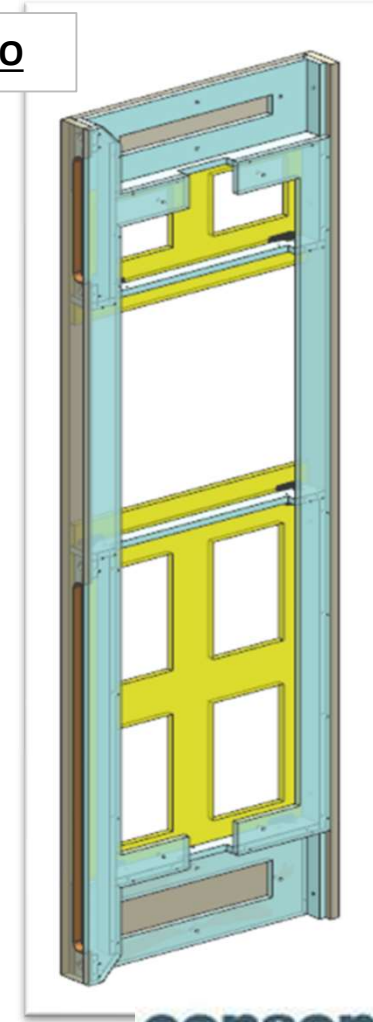

FERRAMENTA:

- N° 4 - FAST MOUNT MASCHIO
- N° 4 - FAST MOUNT FEMMINA
- N° 12 - SOUTHCO
- N° 12 - RISCANTRO SOUTHCO
- N° 13 - VITI 6MA X 25 TB
- N°12- BUSSOLE ZAMA 6 MA

consonni&c

AZ68F

DA MAT. 201 REV. 29-04-2024

LOCALE	CODICE	DESCRIZIONE COMPONENTE	FINITURA	Q.TA	OPERATORE
CABINA OSPITI DX	AZ68F-RH01	SPECCHIERA TV	OKOUME' GREZZO / VERNICIATO NERO	5	Damiano

1 - L. 574 x H 240 x sp 15
2 - 3 - L. 574 x H 50 x sp 15
4 - L. 574 x H 759 x sp 15

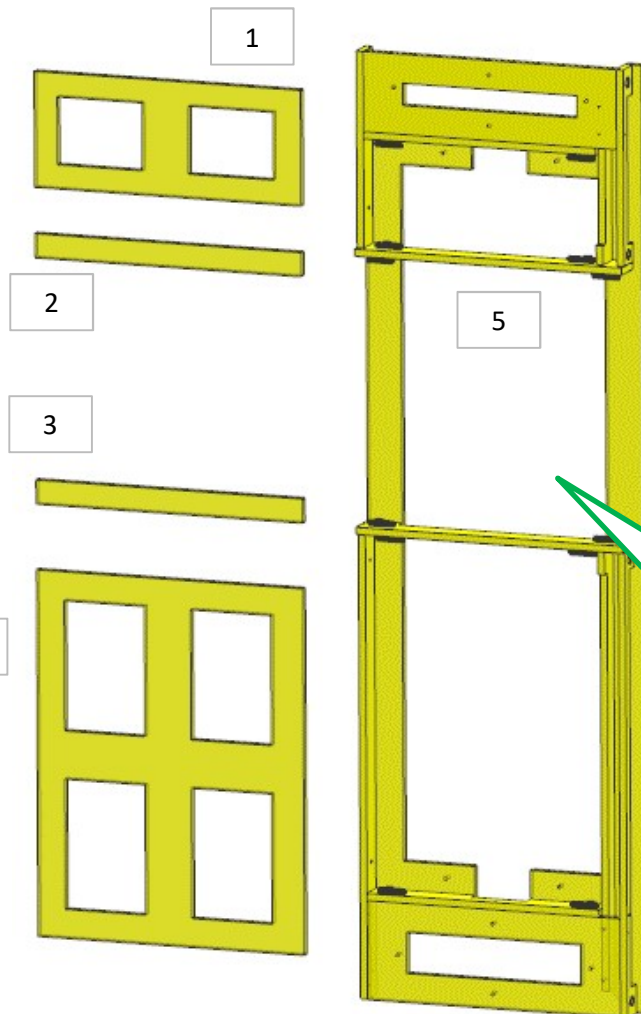

17
SPRUZZARE DI
NERO ASOLA

17
SPRUZZARE DI
NERO VANO PER
TV

ELEMENTO DA
MONTARE con:
R01_RH01
e spedire con un
unico imballo

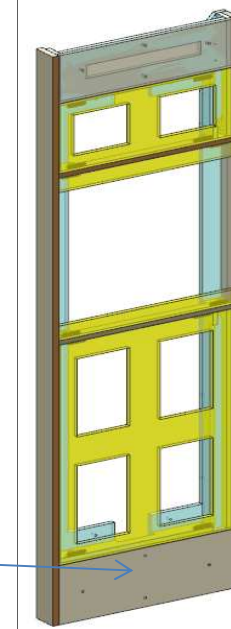

R01_RH01

FERRAMENTA:

N° 4 - FAST MOUNT MASCHIO
N° 4 - FAST MOUNT FEMMINA
N° 12 - SOUTHCO
N° 12 - RISCANTRO SOUTHCO
N° 13 - VITI 6MA X 25 TB
N°12- BUSSOLE ZAMA 6 MA

AZ68F

REV. 29-04-2024

LOCALE	CODICE	DESCRIZIONE COMPONENTE	FINITURA	Q.TA	OPERATORE
CABINA OSPITI DX	AZ68F-R01_RH01	SPECCHIERA TV	LASTRA CHIARA	4	Damiano

- 1 - L.68 x H.1963 x sp 20
- 2 - L.575 x H.166 x sp 15
- 3 - L.575 x H.205 x sp 15
- 4 - L.83 x H.1963 x sp 20

METTERE BORDO

METTERE BORDO

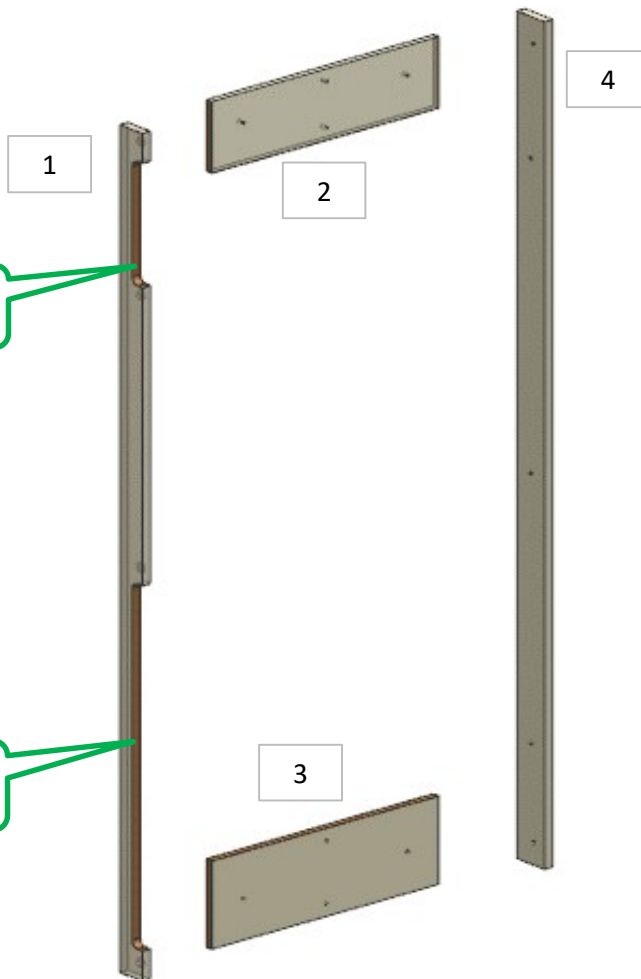

ELEMENTO DA MONTARE con:
RH01
L01_RH01
e spedire con un unico imballo

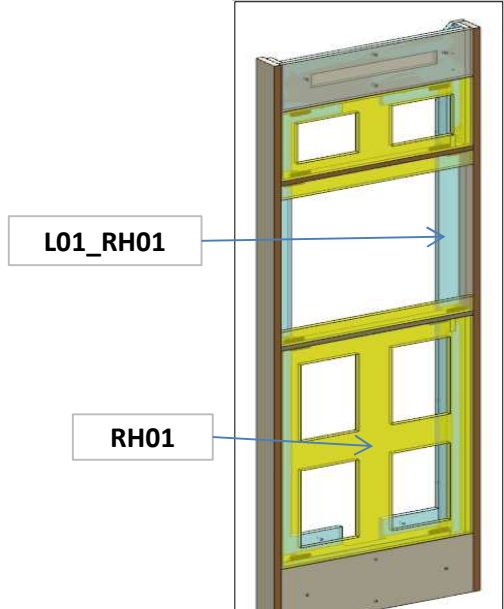

AZ68F

DA MAT. 201 REV. 10-01-2022

LOCALE	CODICE	DESCRIZIONE COMPONENTE	FINITURA	Q.TA	OPERATORE
CABINA OSPITI DX	AZ68F-L01_RM01	GRIGLIA TRATTAMENTO ARIA-OPT	LACCATO BIANCO ARTICO	2	Damiano

1 - 2 - L.110 x H.120 x sp 12

AGGIUNTO CODICE

1

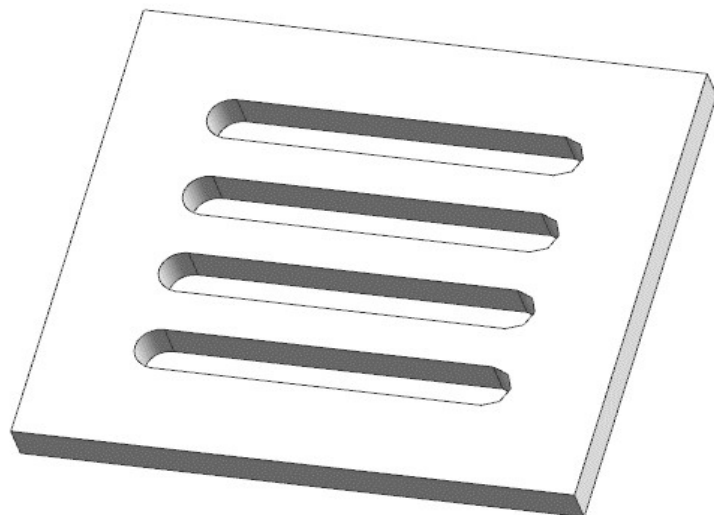

2

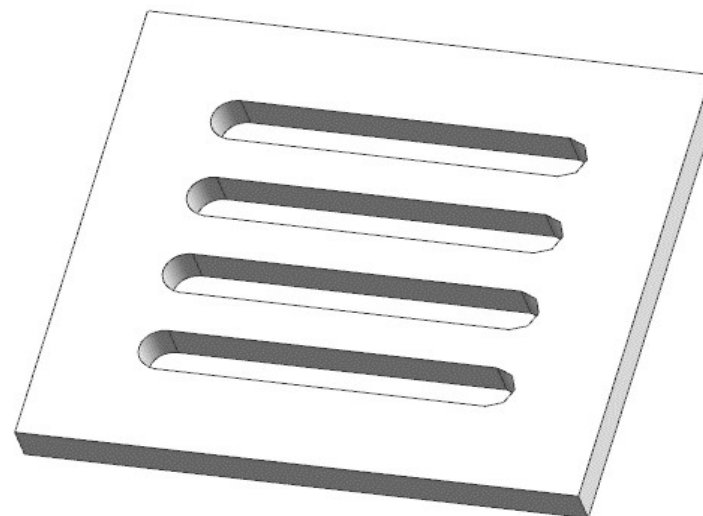

AZ68F

REV. 29-04-2024

LOCALE	CODICE	DESCRIZIONE COMPONENTE	FINITURA	Q.TA	OPERATORE
CABINA OSPITI DX	AZ68F-R01_RQ01_01/02	RINGROSSO PRESE	LASTRA CHIARA	2	Damiano

1

2

1, 2 - L.116 x H.81 x sp 10

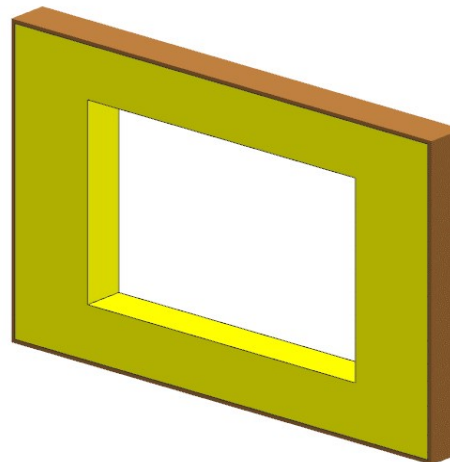
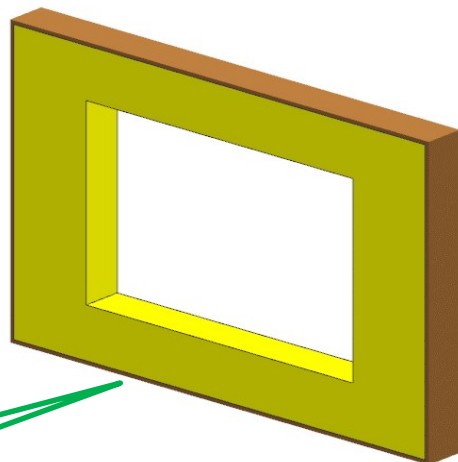

METTERE BORDO