

| LOCALE           | CODICE         | DESCRIZIONE COMPONENTE         | FINITURA      | GR. |
|------------------|----------------|--------------------------------|---------------|-----|
| CABINA OSPITI DX | MD320_R02_RA01 | STRUTTURA MURATA TESTATA LETTO | LASTRA CHIARA | 4   |

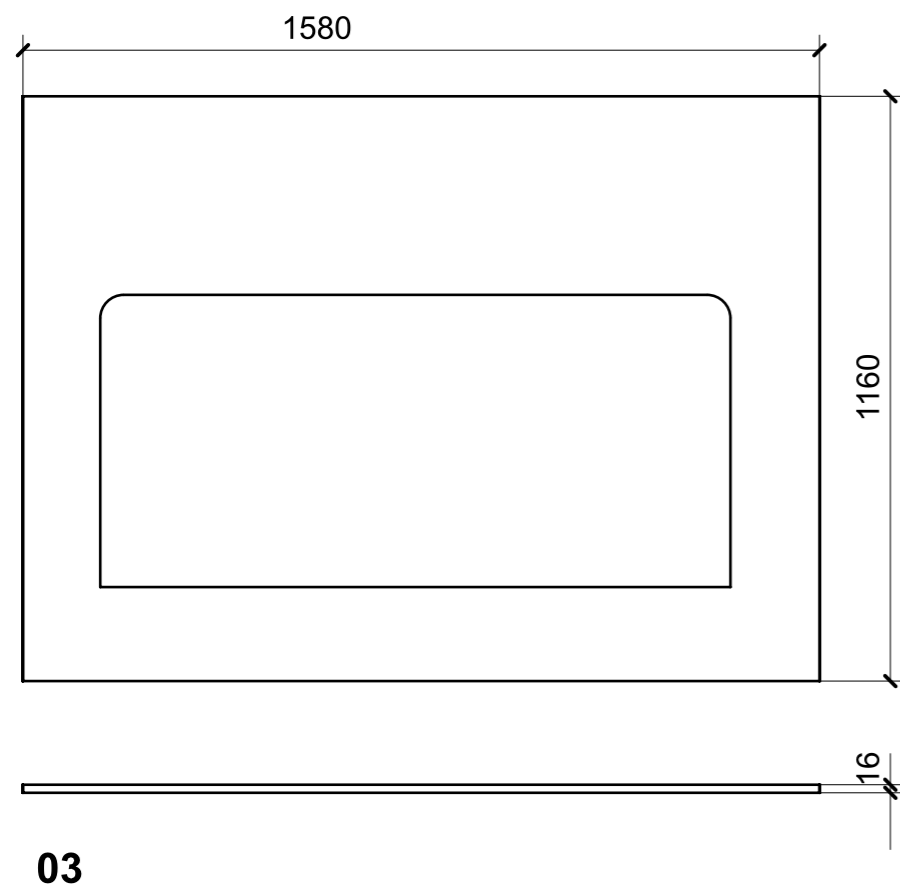
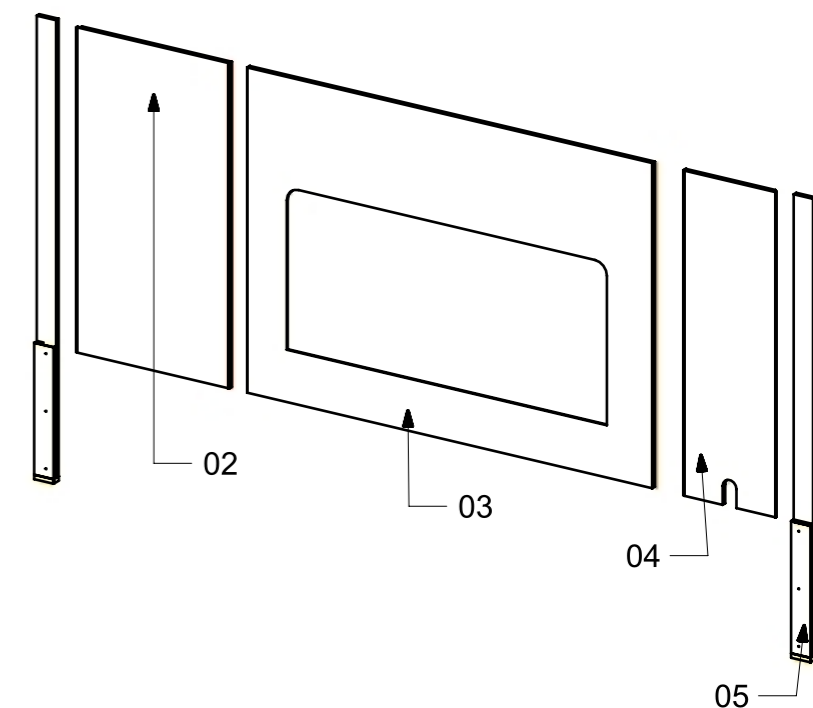
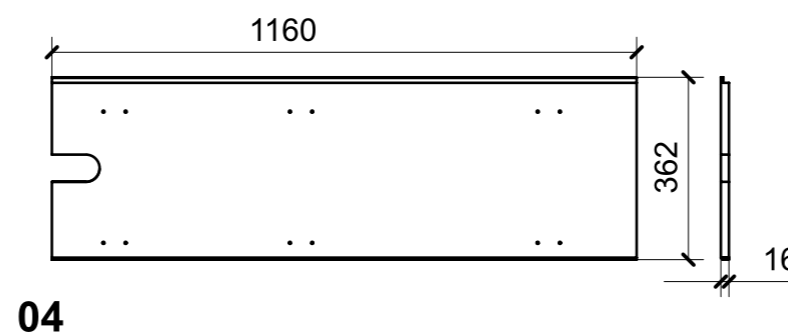
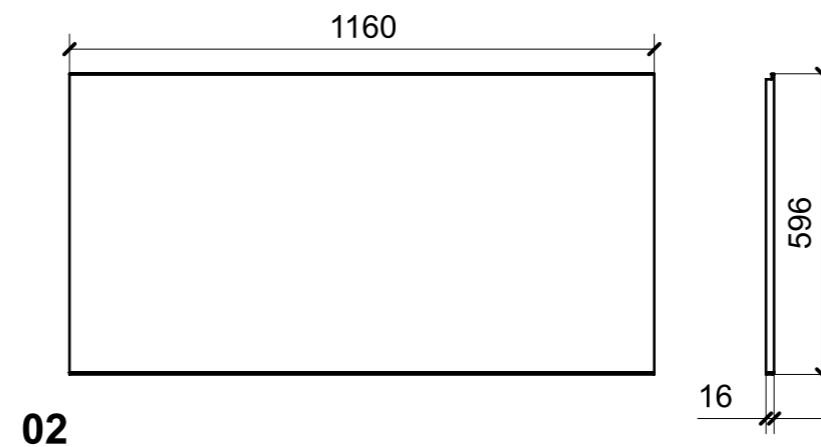
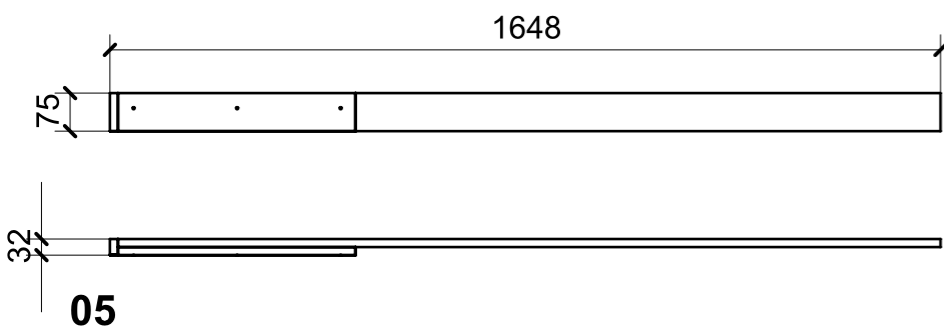
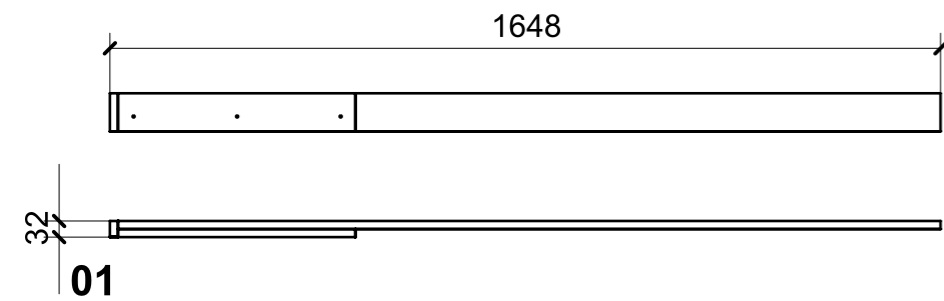

| FERRAMENTA                                 | QTY |
|--|-----|
| BUSSOLA 6MA X 10 FORO DIAM.8               | 4   |
| CHIUSURA A SPINTA_TECHNOPARTNER_SOU C3-203 | 6   |
| VITE 6MA X 25 TESTA BOMBATA                | 6   |
| FITLOCK F_MASCHERPA_6020101102             | 30  |
| FITLOCK M_MASCHERPA_3MM_6020202101         | 46  |

VERNICIATURA LASTRA/LACCATI:

● = VERNICIARE 1 LATO + FILI RASATI O BORDATI / ○ = VERNICIARE 2 LATI + FILI RASATI O BORDATI

| LOCALE           | CODICE         | DESCRIZIONE COMPONENTE | FINITURA     | GR. |
|------------------|----------------|------------------------|--------------|-----|
| CABINA OSPITI DX | MD320_R01_RE01 | RIV. PARETE POPPA      | LASTRA SCURA | 2   |

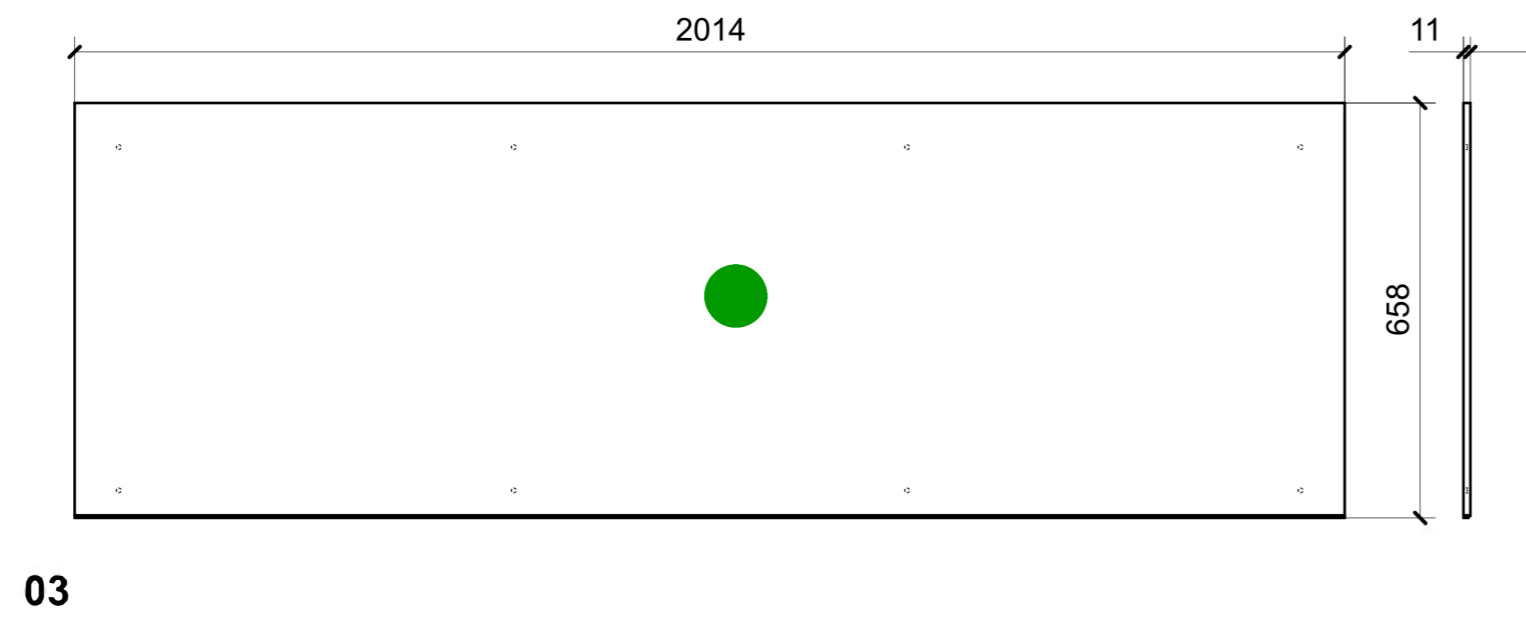
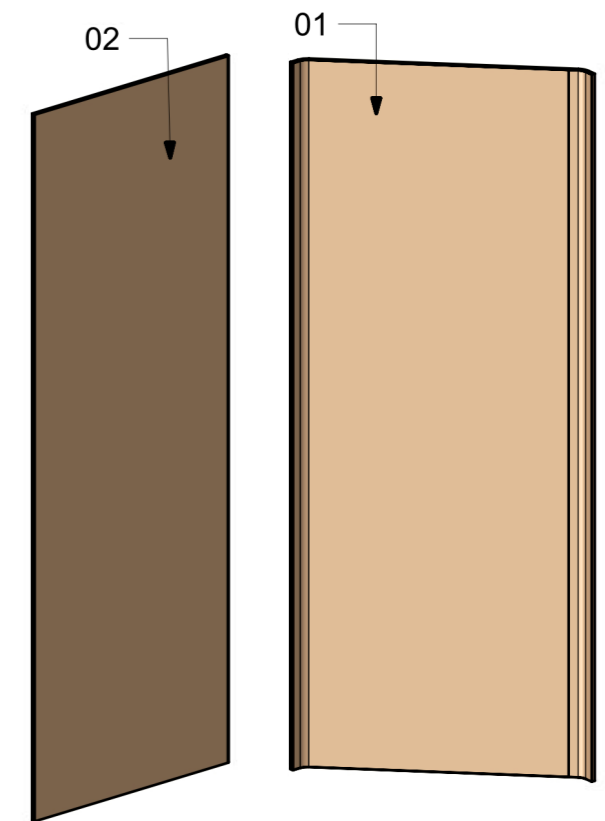
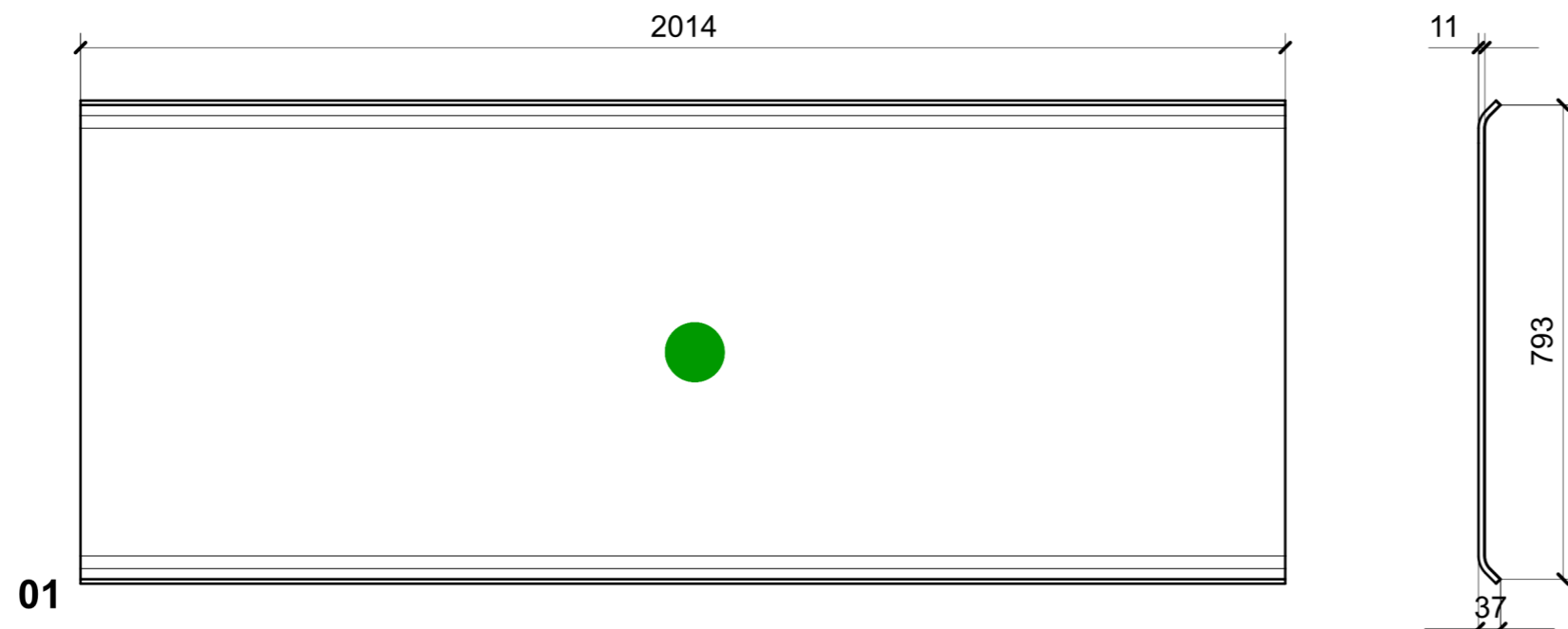

VERNICIATURA LASTRA/LACCATI:  
 ● = VERNICIARE 1 LATO + FILI RASATI O BORDATI      NESSUN SIMBOLO = VERNICIARE 2 LATI + FILI RASATI O BORDATI

| LOCALE           | CODICE         | DESCRIZIONE COMPONENTE | FINITURA      | GR. |
|------------------|----------------|------------------------|---------------|-----|
| CABINA OSPITI DX | MD320_R02_RE01 | RIV. PARETE POPPA      | LASTRA CHIARA | 2   |

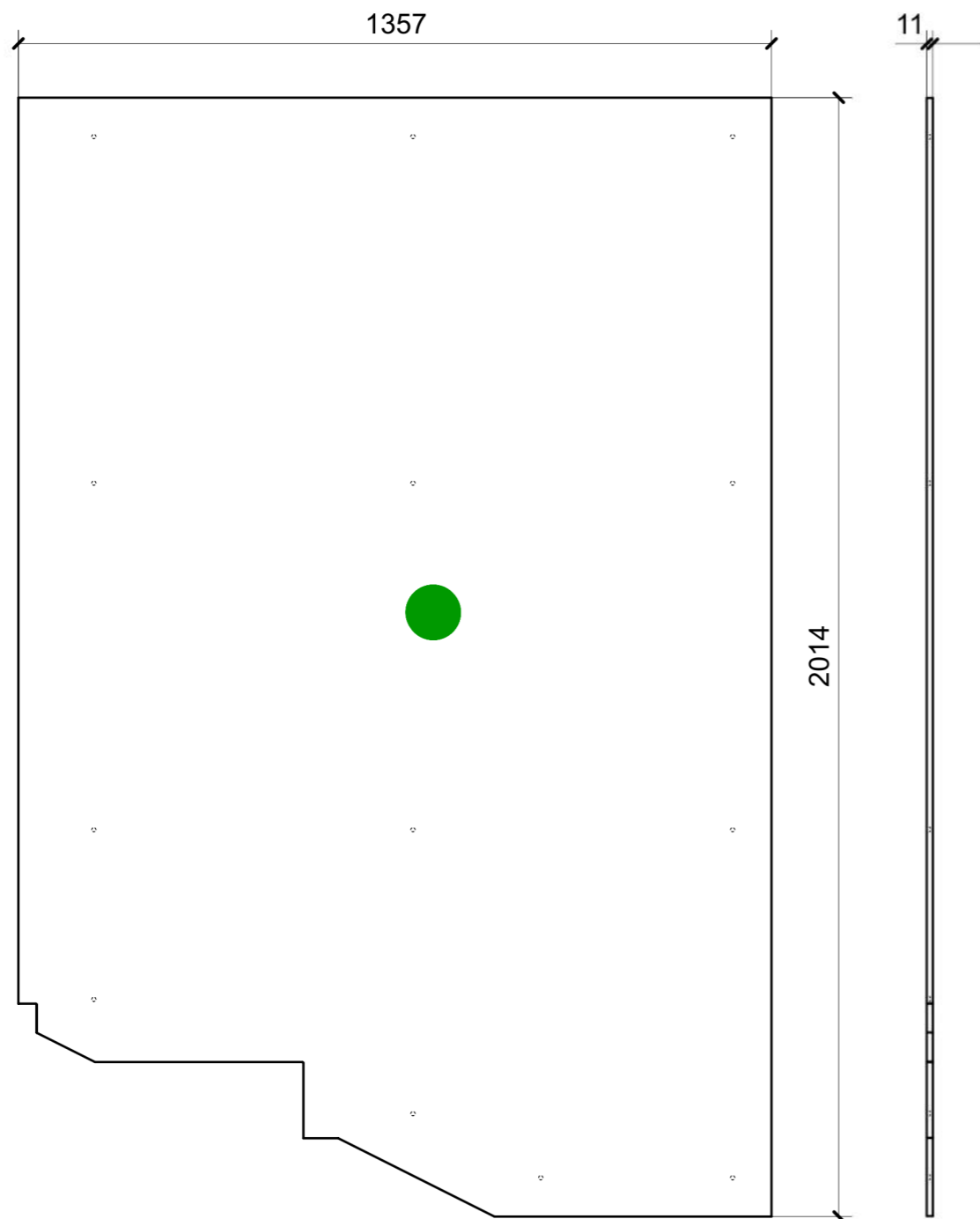

VERNICIATURA LASTRA/LACCATI:

● = VERNICIARE 1 LATO + FILI RASATI O BORDATI

NESSUN SIMBOLO = VERNICIARE 2 LATI + FILI RASATI O BORDATI

| LOCALE           | CODICE         | DESCRIZIONE COMPONENTE  | FINITURA     | GR. |
|------------------|----------------|-------------------------|--------------|-----|
| CABINA OSPITI DX | MD320_R01_RF01 | RIV. PARETE CENTRO NAVE | LASTRA SCURA | 3   |

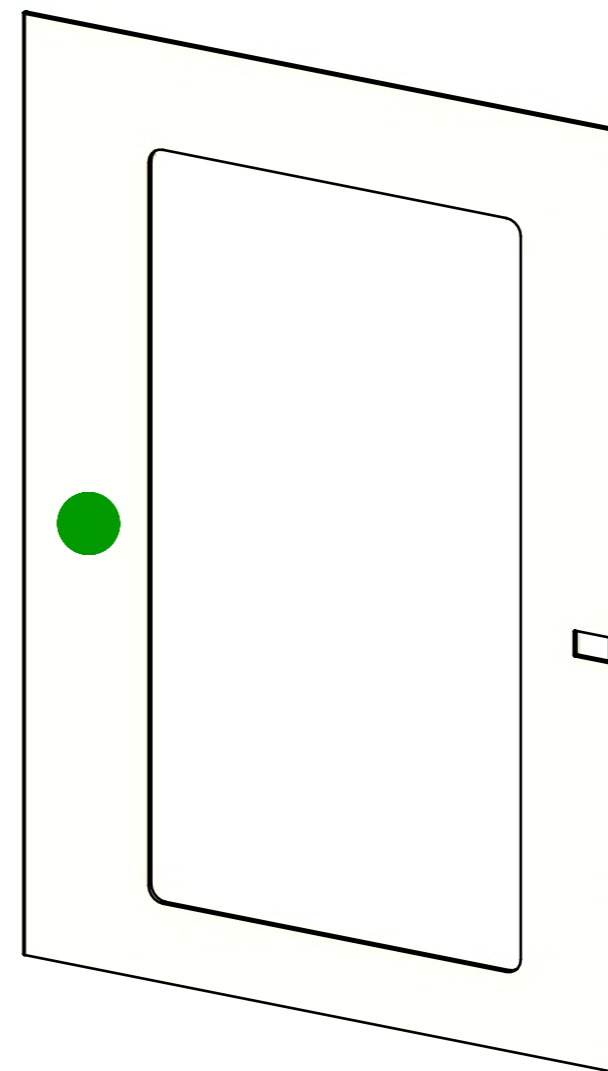
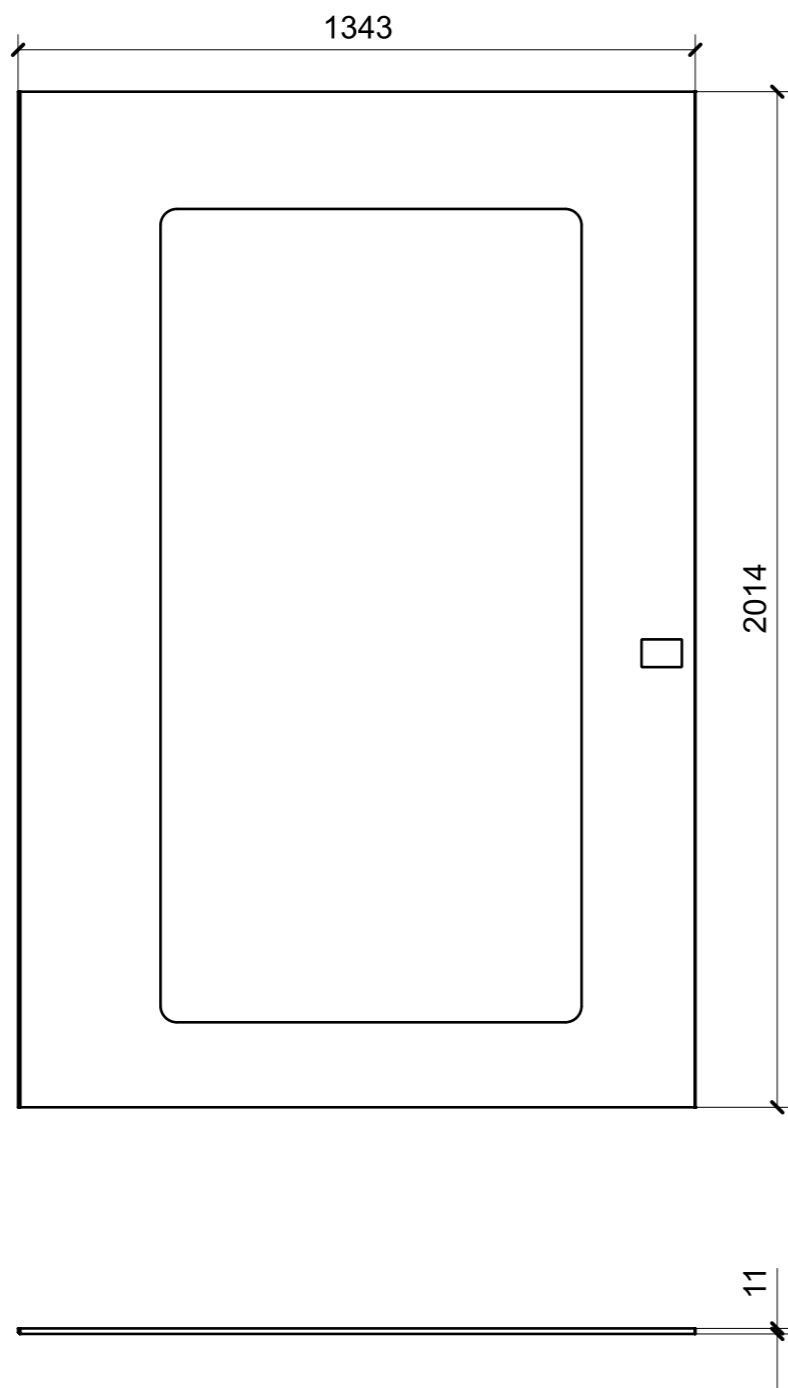

VERNICIATURA LASTRA/LACCATI:

● = VERNICIARE 1 LATO + FILI RASATI O BORDATI

NESSUN SIMBOLO = VERNICIARE 2 LATI + FILI RASATI O BORDATI

| LOCALE           | CODICE         | DESCRIZIONE COMPONENTE | FINITURA     | GR. |
|------------------|----------------|------------------------|--------------|-----|
| CABINA OSPITI DX | MD320_R01_RG01 | RIV. PARETE PRUA       | LASTRA SCURA | 3   |

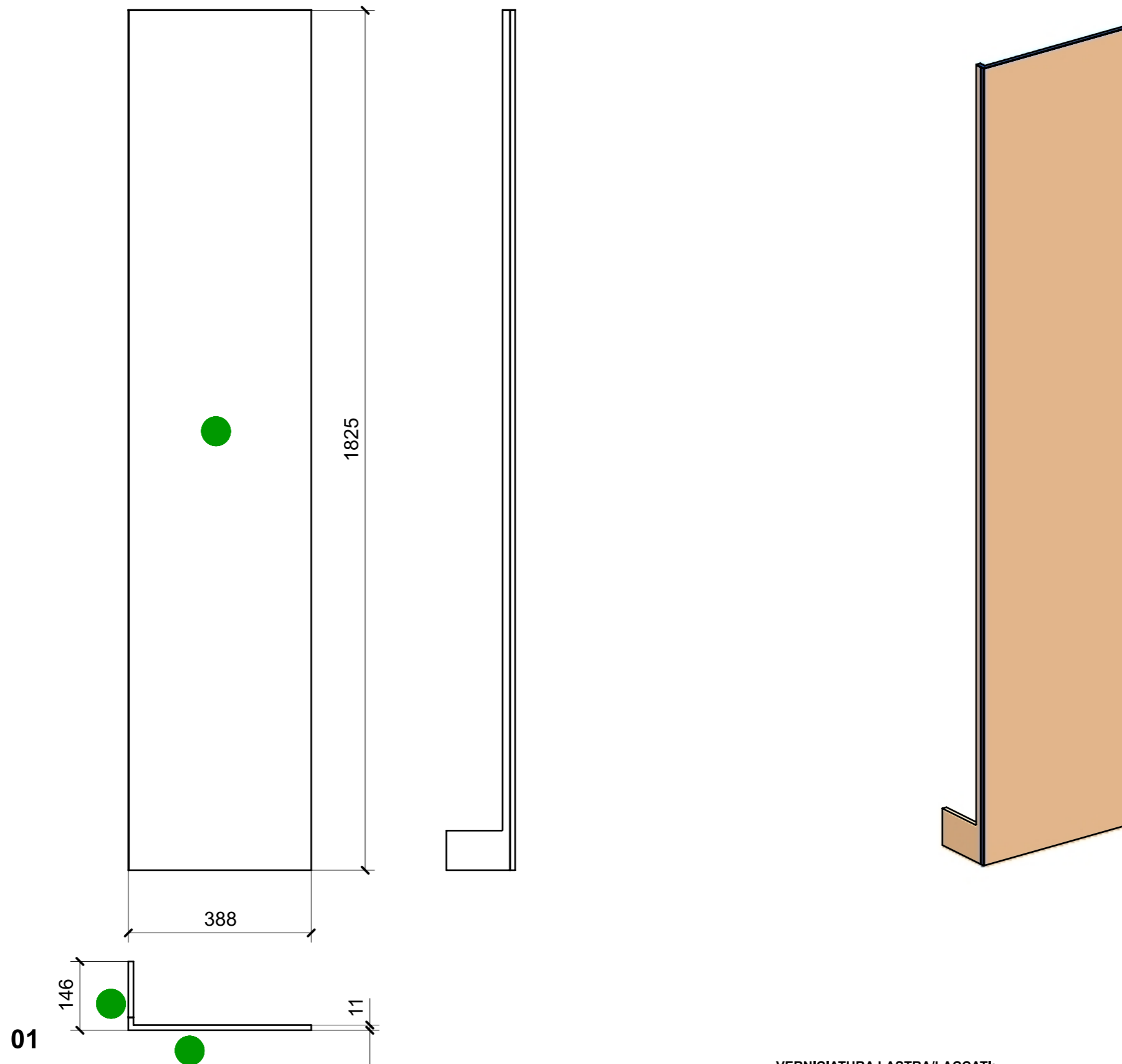

VERNICIATURA LASTRA/LACCATI:

● = VERNICIARE 1 LATO + FILI RASATI O BORDATI

NESSUN SIMBOLO = VERNICIARE 2 LATI + FILI RASATI O BORDATI

| LOCALE           | CODICE         | DESCRIZIONE COMPONENTE | FINITURA      | GR. |
|------------------|----------------|------------------------|---------------|-----|
| CABINA OSPITI DX | MD320_R02_RG01 | RIV. PARETE PRUA       | LASTRA CHIARA | 3   |

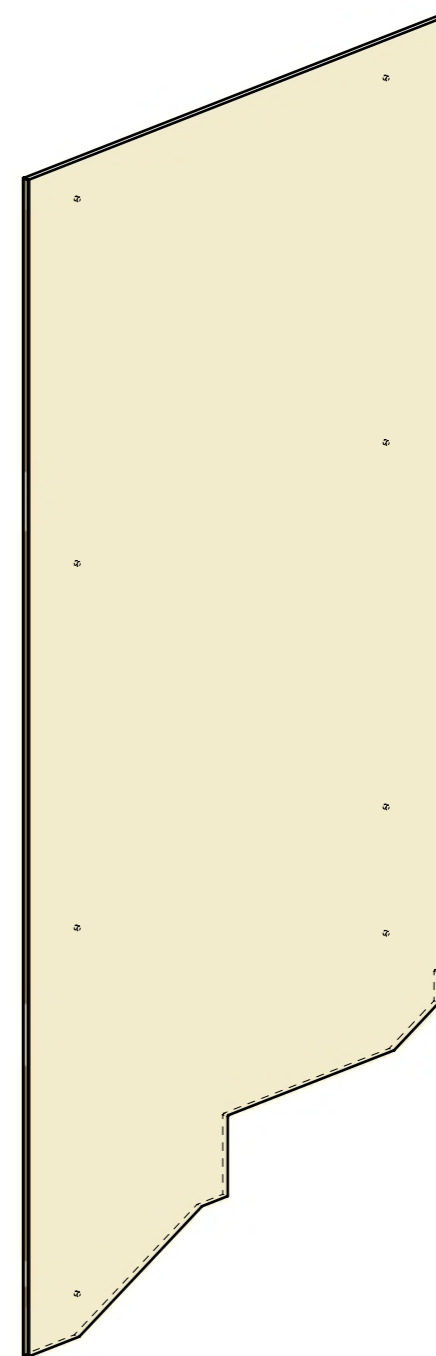
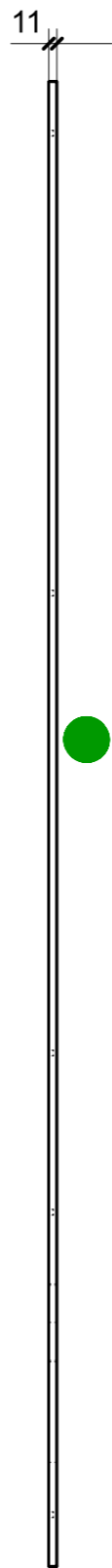
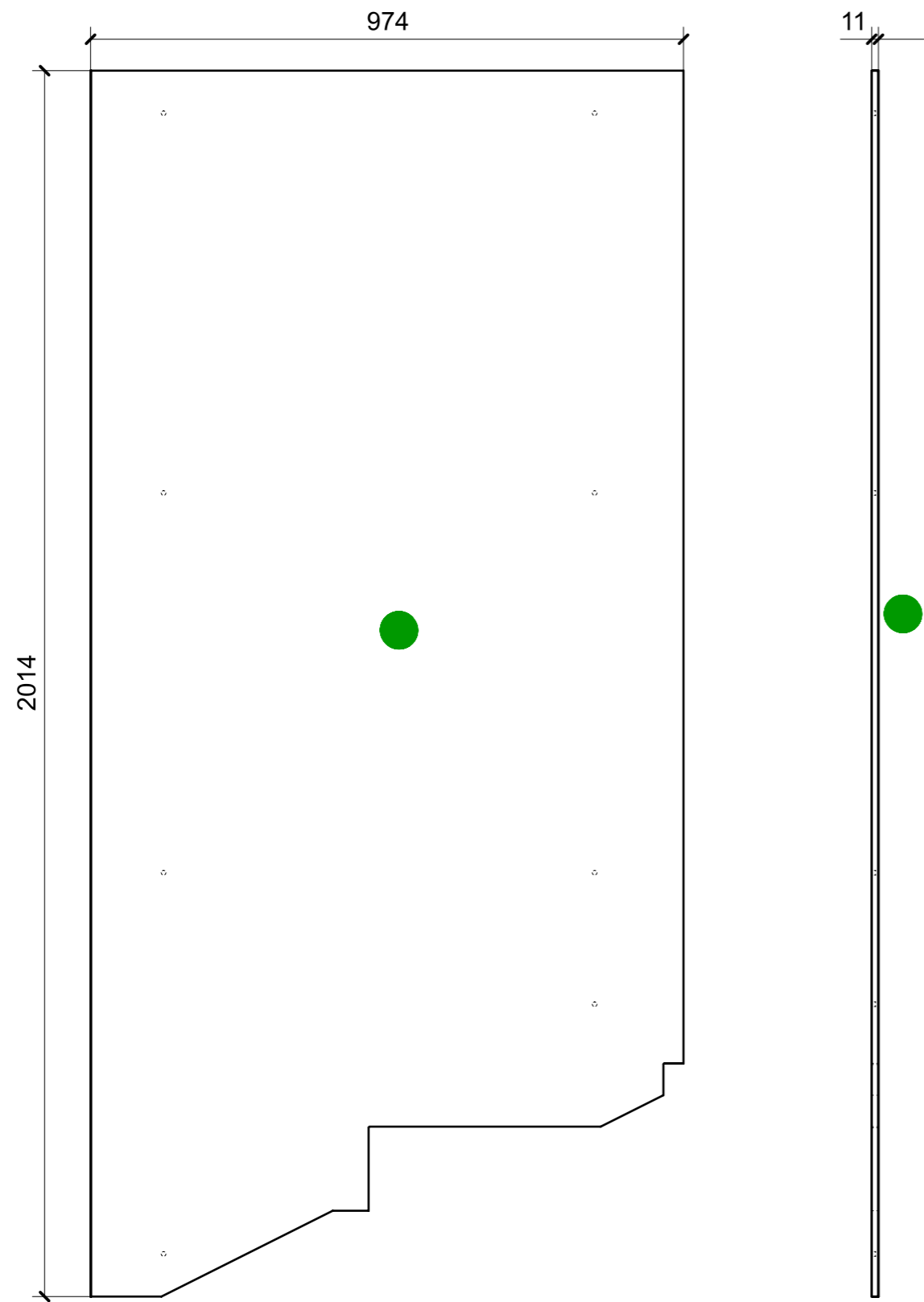

VERNICIATURA LASTRA/LACCATI:

● = VERNICIARE 1 LATO + FILI RASATI O BORDATI

NESSUN SIMBOLO = VERNICIARE 2 LATI + FILI RASATI O BORDATI

| LOCALE           | CODICE         | DESCRIZIONE COMPONENTE | FINITURA     | GR. |
|------------------|----------------|------------------------|--------------|-----|
| CABINA OSPITI DX | MD320_R01_RI01 | ARMADIO                | LASTRA SCURA | 4   |

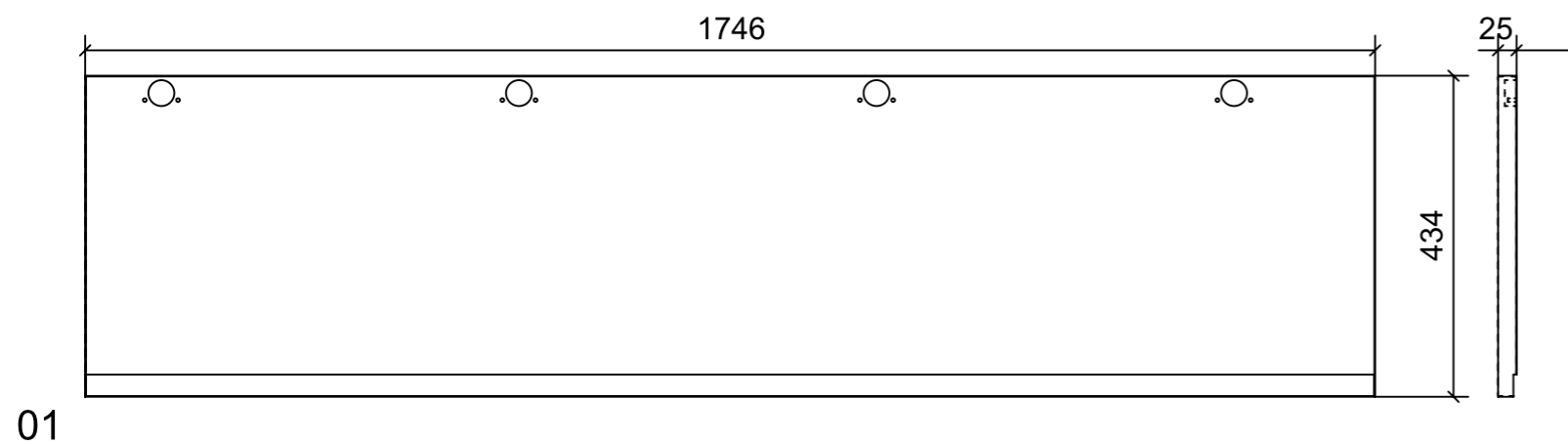

01

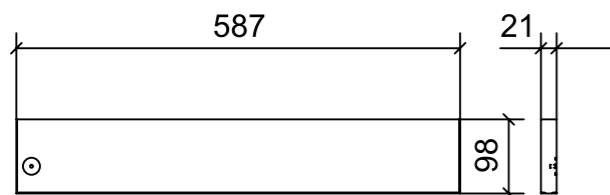

02

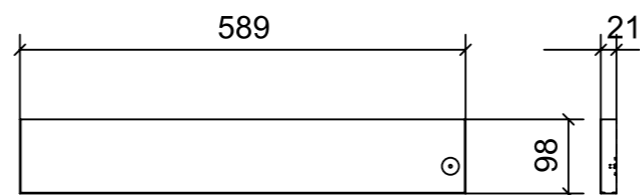

03

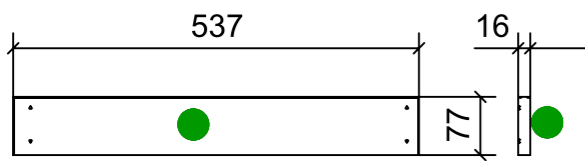

04

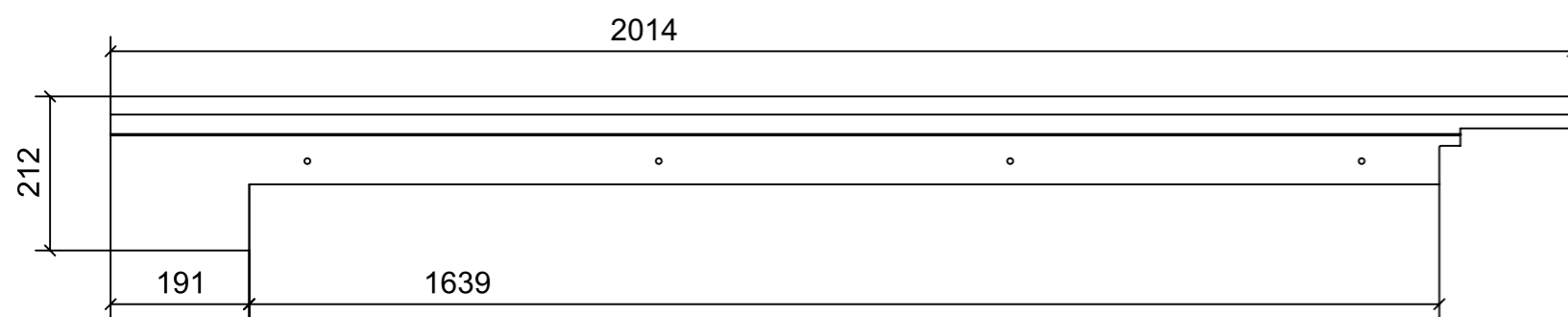

05

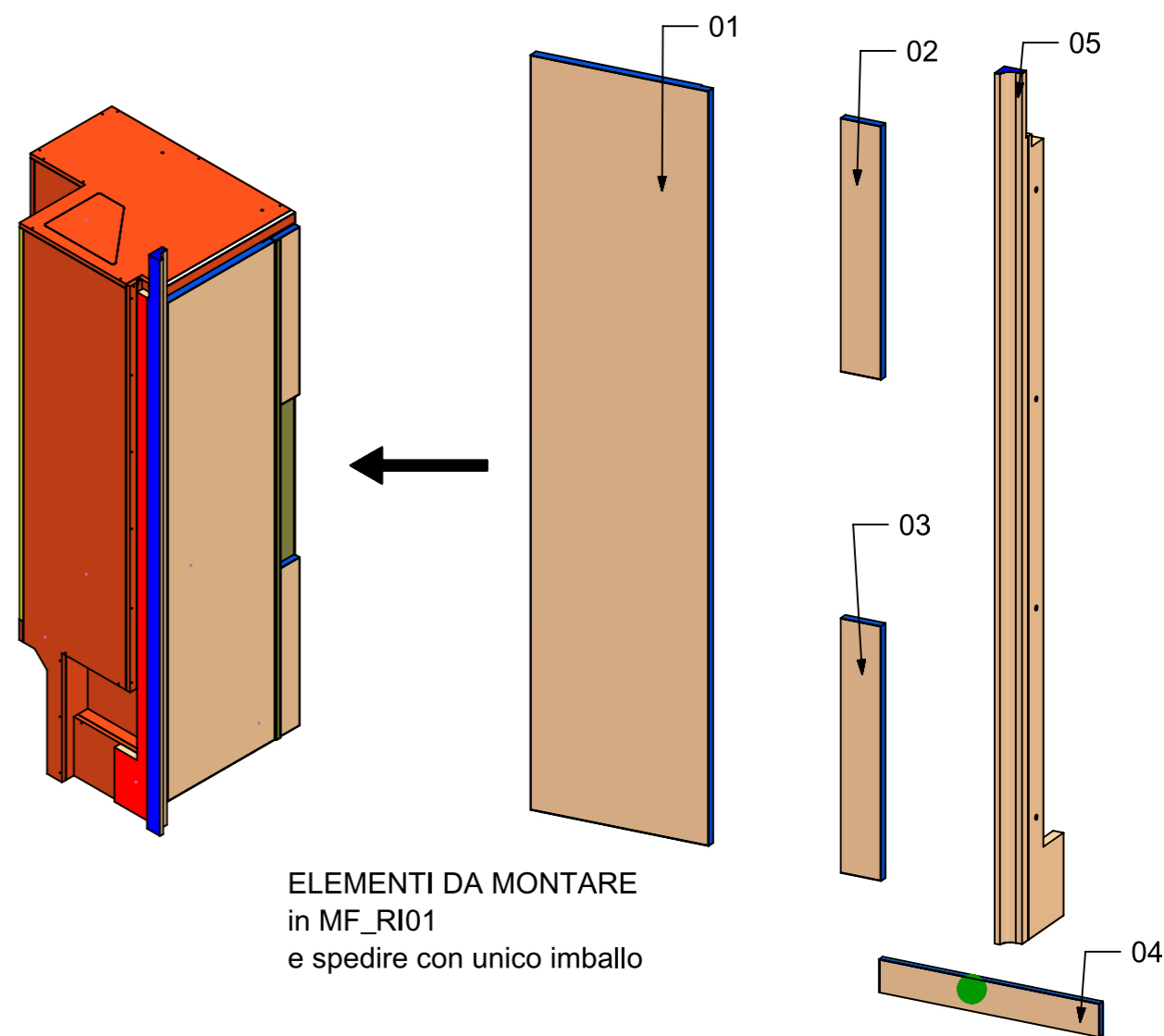
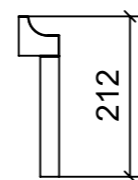

ELEMENTI DA MONTARE  
in MF\_RI01  
e spedire con unico imballo

| FERRAMENTA  | QTY |
|---|-----|
| BUSSOLA 6MA X 10 FORO DIAM.8                      | 4   |
| MAGNETE FORZA MAGNETICA1-5 10KG_HAFELE_246.87.112 | 2   |
| BUSSOLA 5MA ANKOR BORGHIS X CERNIERA PIANA        | 8   |
| BUSSOLA AD ESPANSIONE_HAFELE_042.98.051           | 4   |

VERNICIATURA LASTRA/LACCATI:

● = VERNICIARE 1 LATO + FILI RASATI O BORDATI

NESSUN SIMBOLO = VERNICIARE 2 LATI + FILI RASATI O BORDATI

| LOCALE           | CODICE         | DESCRIZIONE COMPONENTE | FINITURA     | GR. |
|------------------|----------------|------------------------|--------------|-----|
| CABINA OSPITI DX | MD320_R01_RM01 | PLENUM ARMADIO         | LASTRA SCURA | 2   |

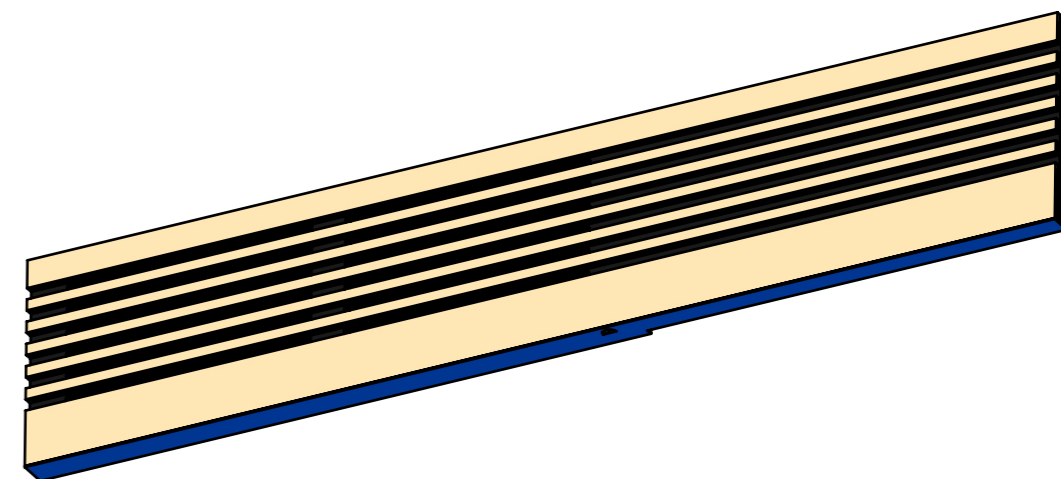
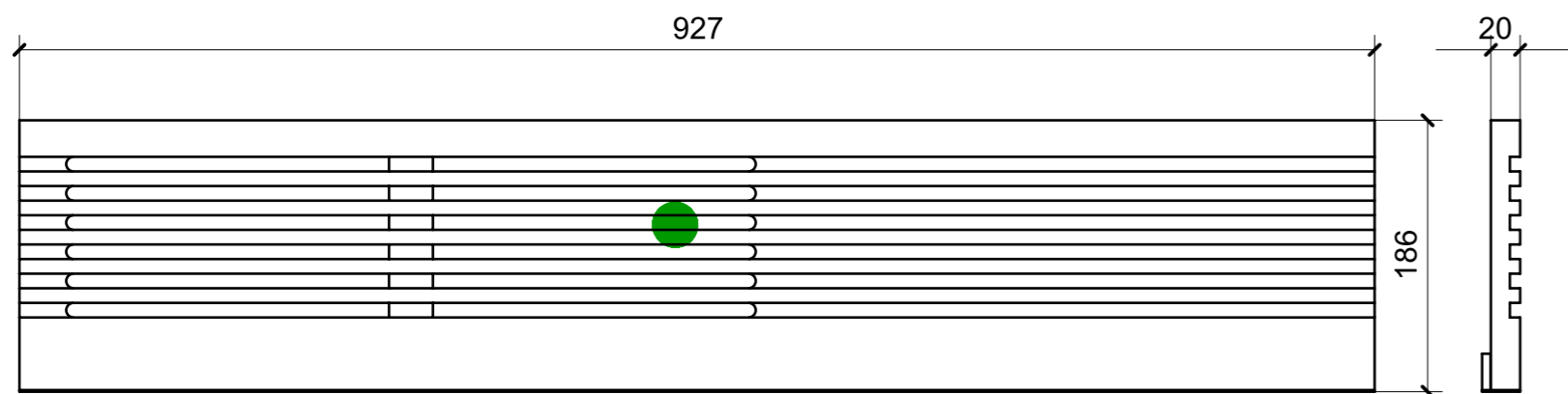

VERNICIATURA LASTRA/LACCATI:

● = VERNICIARE 1 LATO + FILI RASATI O BORDATI

NESSUN SIMBOLO = VERNICIARE 2 LATI + FILI RASATI O BORDATI