

LOCALE	CODICE	DESCRIZIONE COMPONENTE	FINITURA	Q.TA
CABINA ARMATORE	MD298_X01_AA01	STRUTTURA MURATA DX	LAMINATO SM'ART 3104 CORDA LACCATA	1

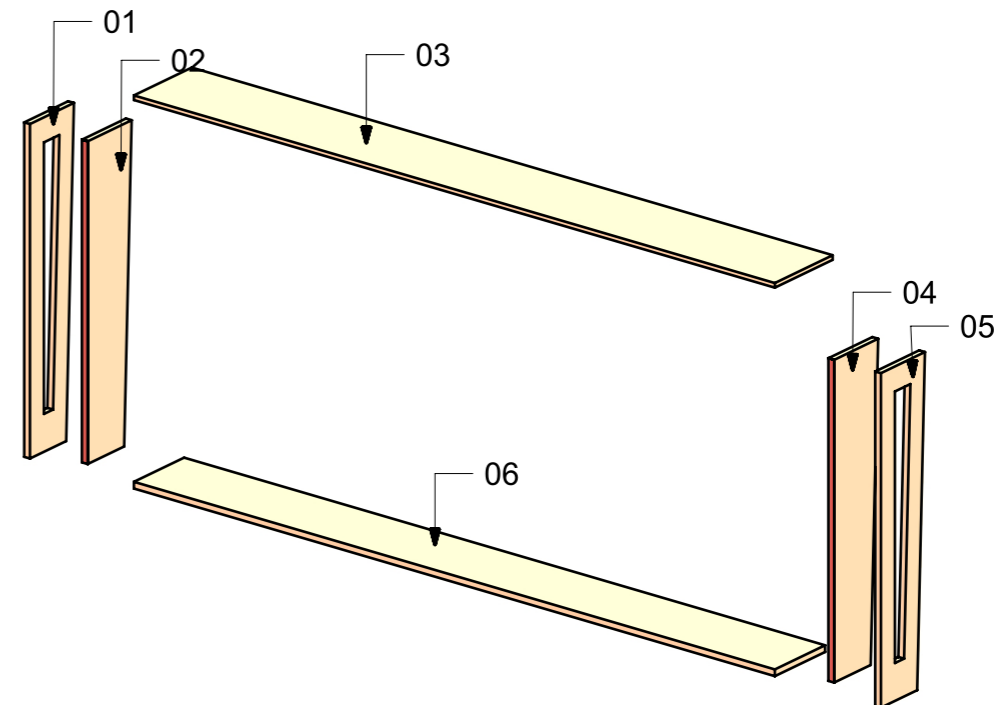

LOCALE	CODICE	DESCRIZIONE COMPONENTE	FINITURA	Q.TA
CABINA ARMATORE	MD298_X02_AA01	STRUTTURA MURATA DX	LAMINATO NERO OPACO	1

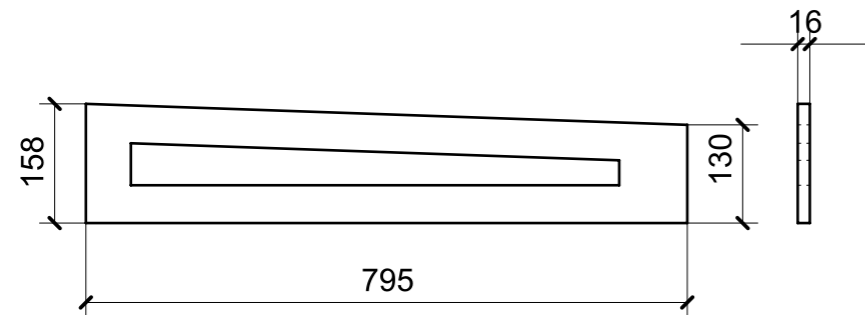
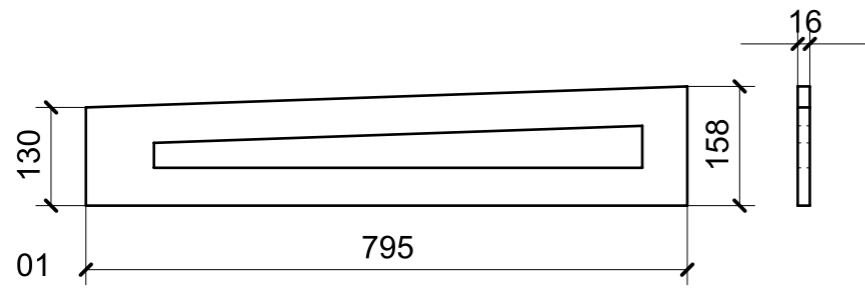
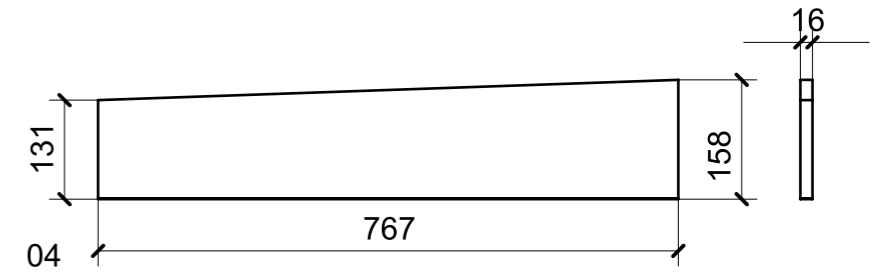
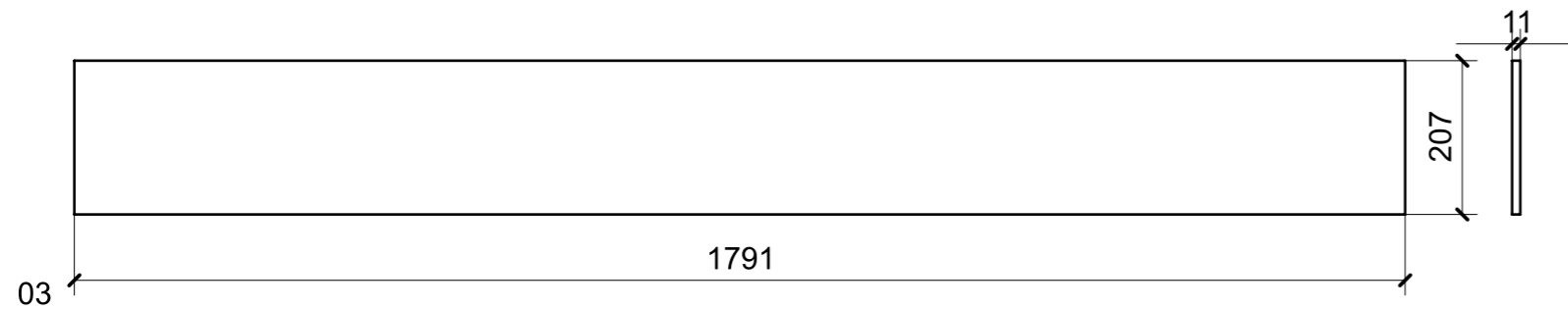
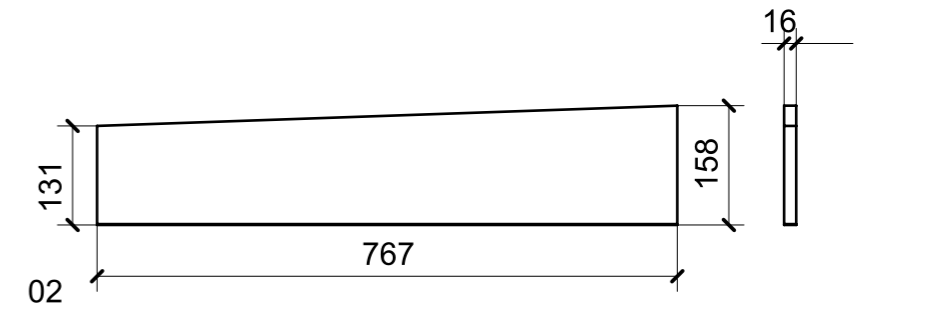
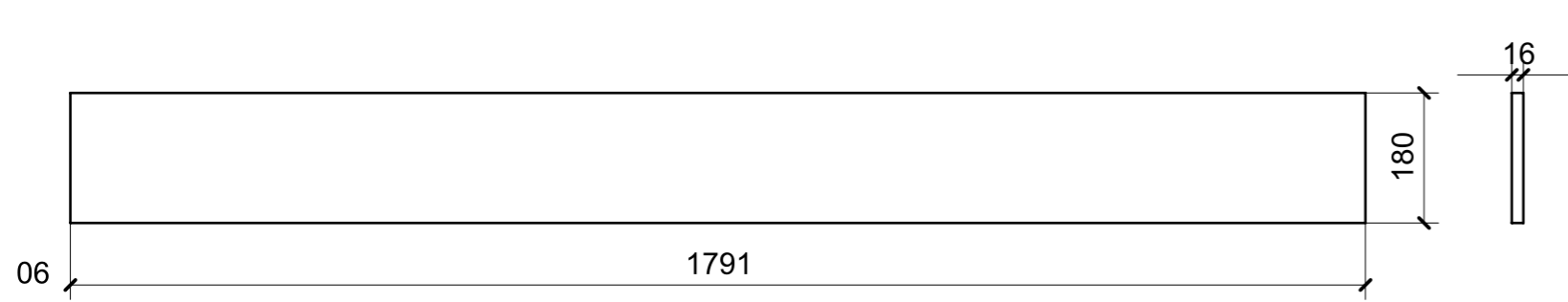
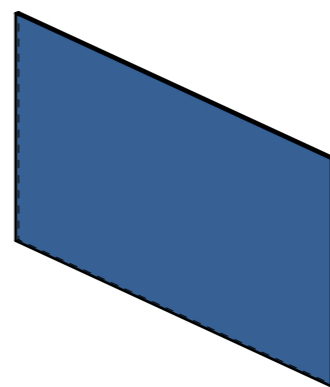
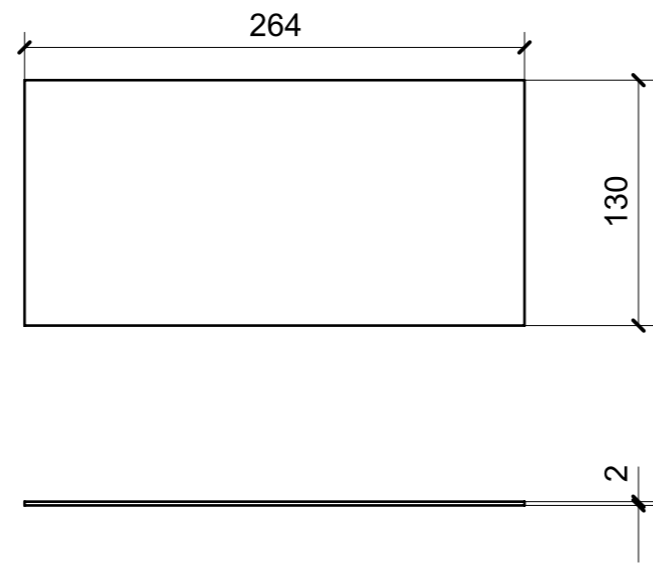

LOCALE	CODICE	DESCRIZIONE COMPONENTE	FINITURA	Q.TA
CABINA ARMATORE	MD298_X01_AB01	RACCORDO POPPIERO MURATA DX	LAMINATO NERO OPACO	1

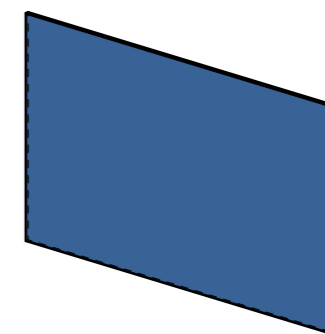
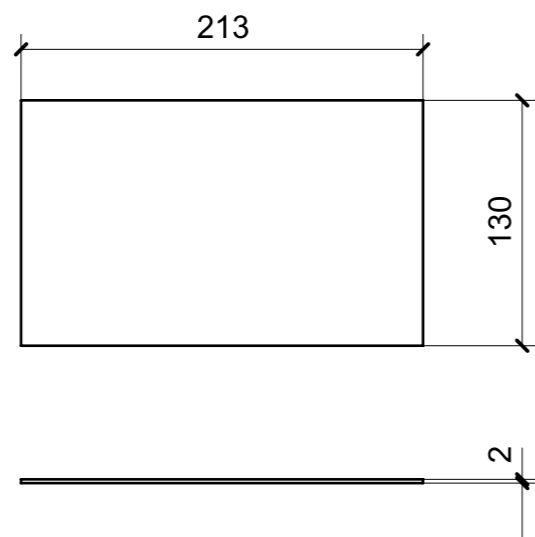

LOCALE	CODICE	DESCRIZIONE COMPONENTE	FINITURA	Q.TA
CABINA ARMATORE	MD298_X01_AC01	PLENUM MURATA	LAMINATO NERO OPACO	1

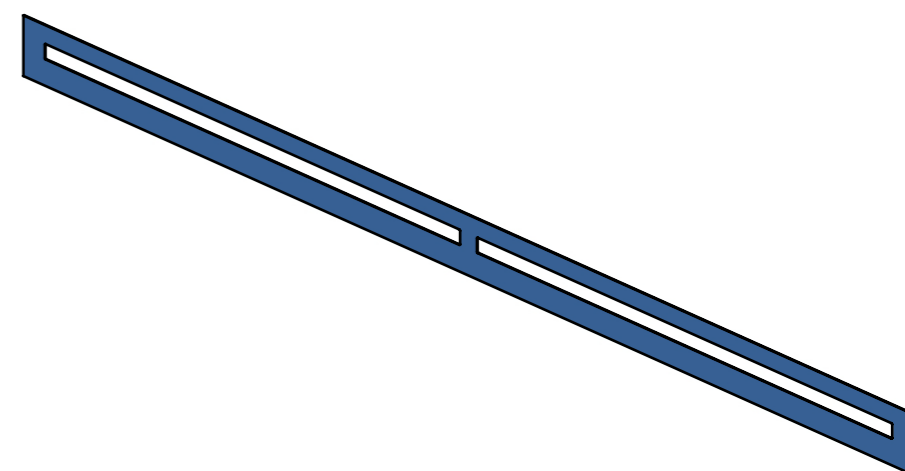
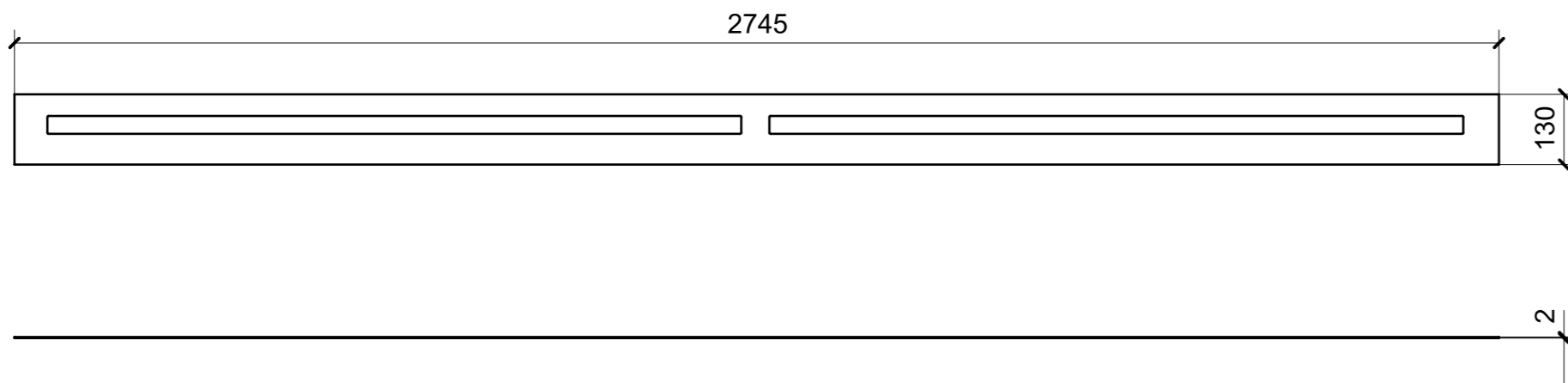

LOCALE	CODICE	DESCRIZIONE COMPONENTE	FINITURA	Q.TA
CABINA ARMATORE	MD298_X01_AE01	STRUTTURA MURATA SX	LAMINATO SM'ART 3104 CORDA LACCATA	1

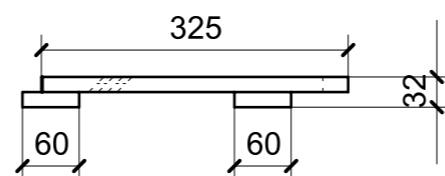
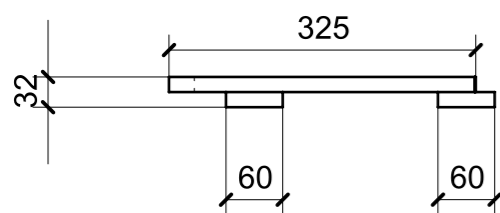
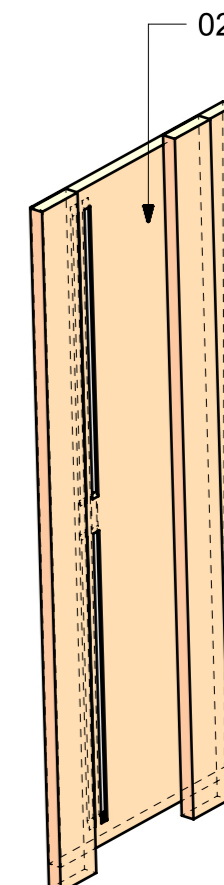
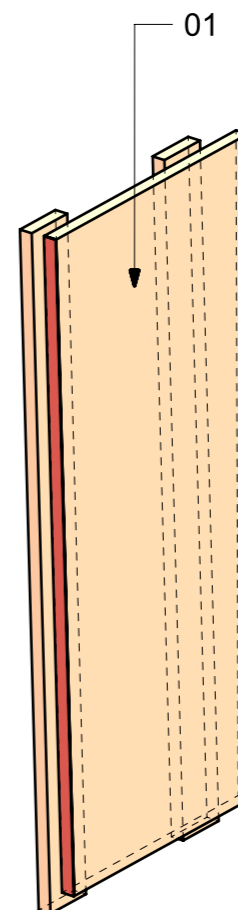
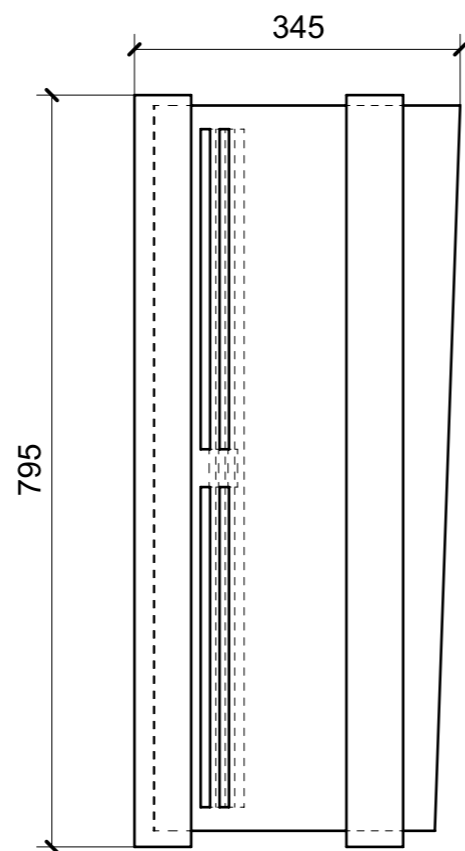
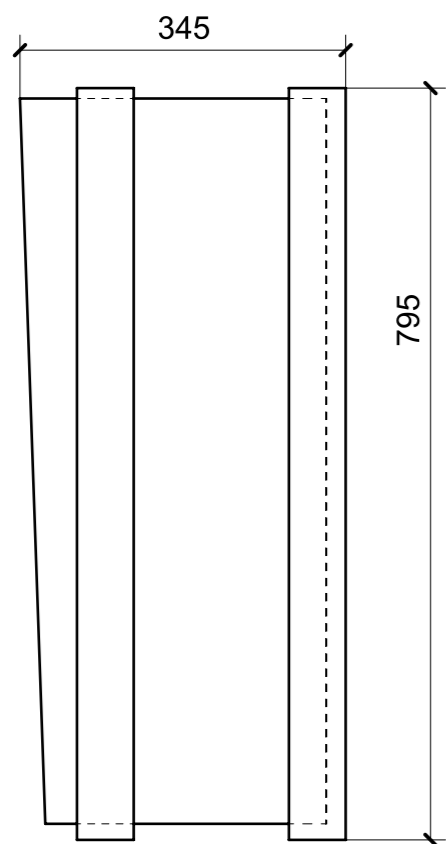

LOCALE	CODICE	DESCRIZIONE COMPONENTE	FINITURA	Q.TA
CABINA ARMATORE	MD298_X02_AE01	STRUTTURA MURATA SX	LAMINATO NERO	1

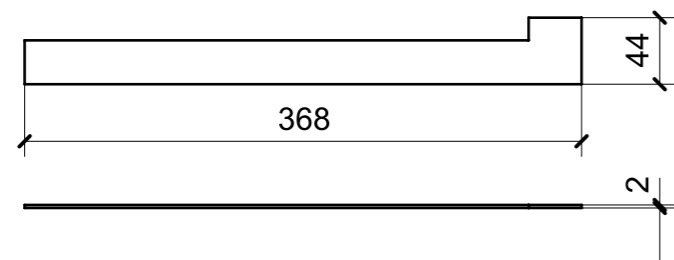
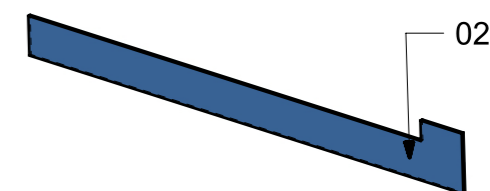
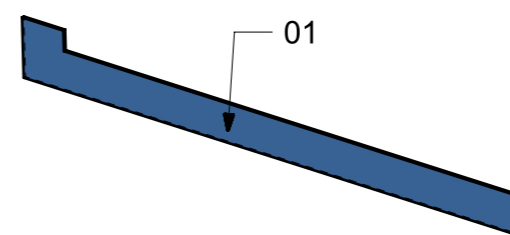
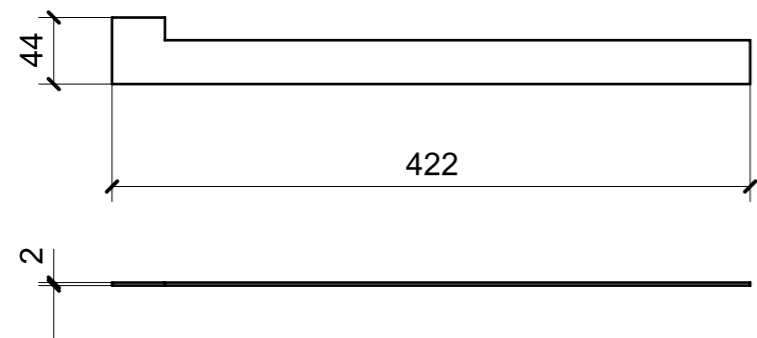

LOCALE	CODICE	DESCRIZIONE COMPONENTE	FINITURA	Q.TA
CABINA ARMATORE	MD298_X01_AF01	STRUTTURA A PONTE MURATA SX	LAMINATO SM'ART 3104 CORDA LACCATA	1

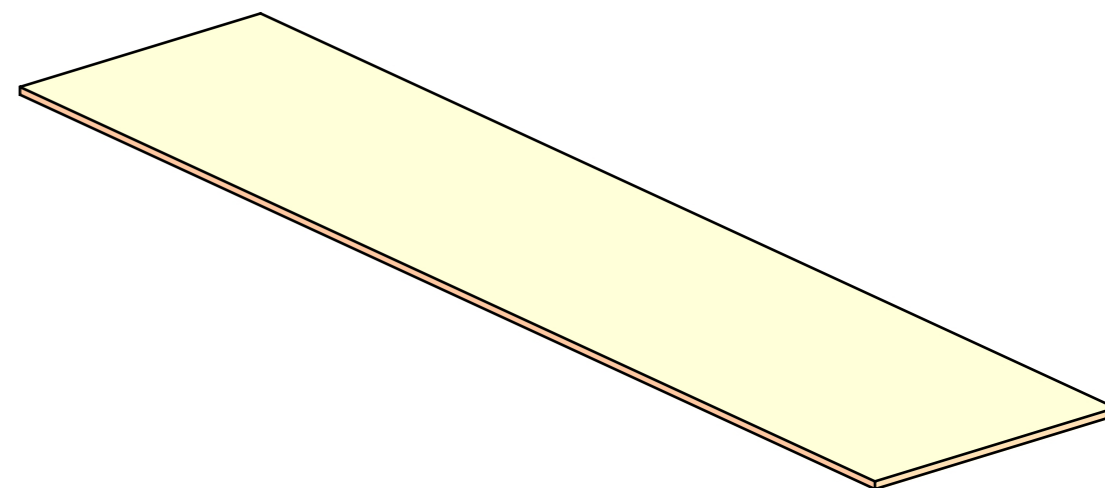
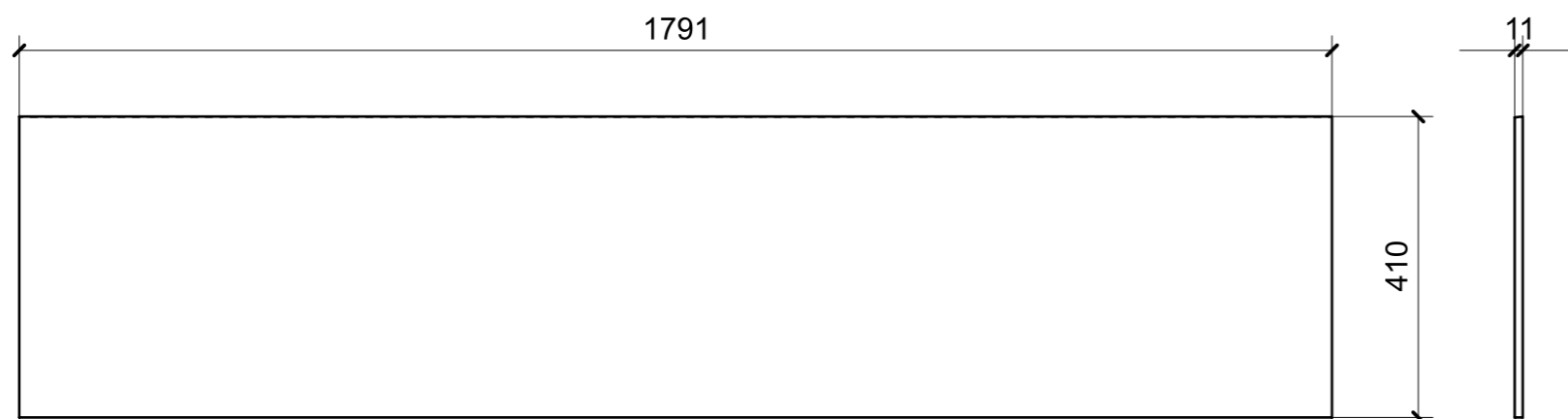

LOCALE	CODICE	DESCRIZIONE COMPONENTE	FINITURA	GR.
CABINA ARMATORE	MD298_X01_AI01	COMODINO PRODIERO	LAMINATO SM'ART 3104 CORDA LACCATA	06

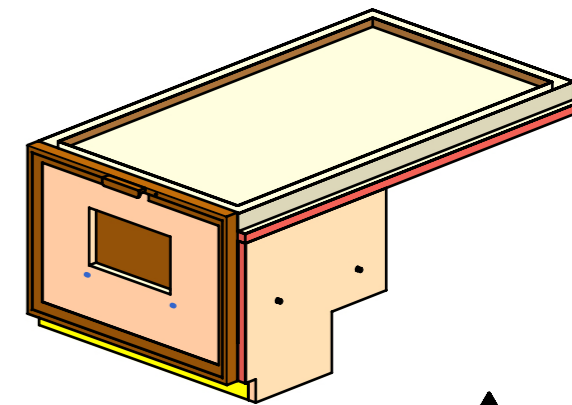
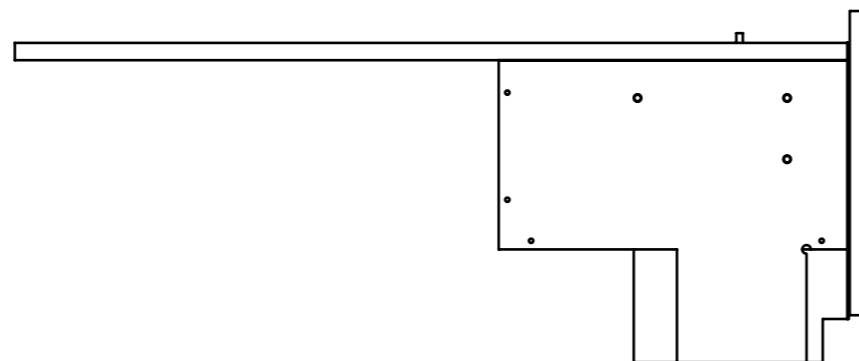
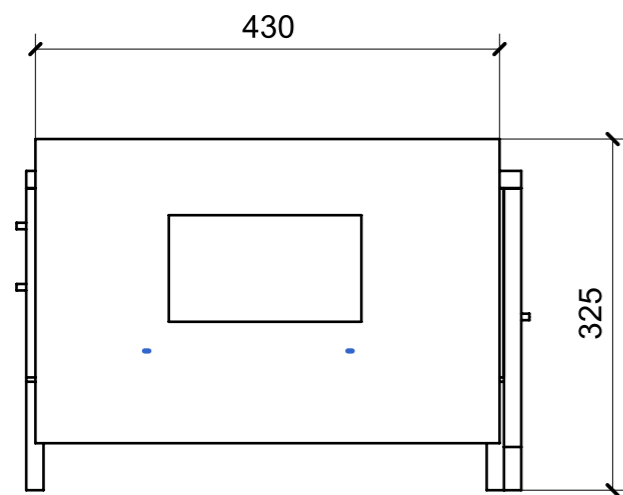

ELEMENTI DA MONTARE
 con AI_01/02; R01_AI01_01-02
 A01_AI01_13/14 in MF_AI01
 e spedire con unico imballo

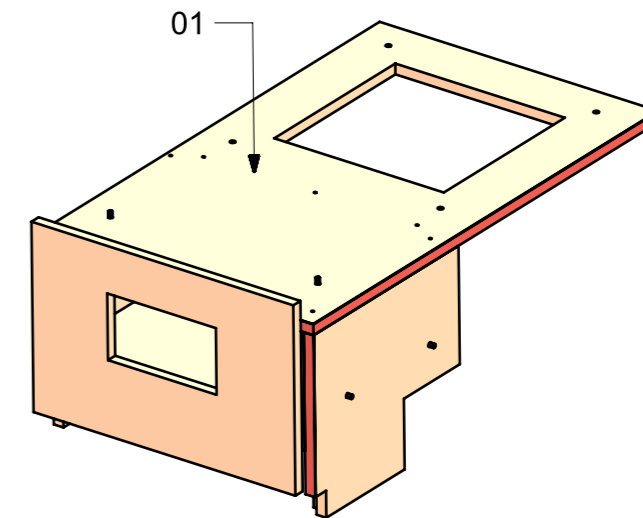
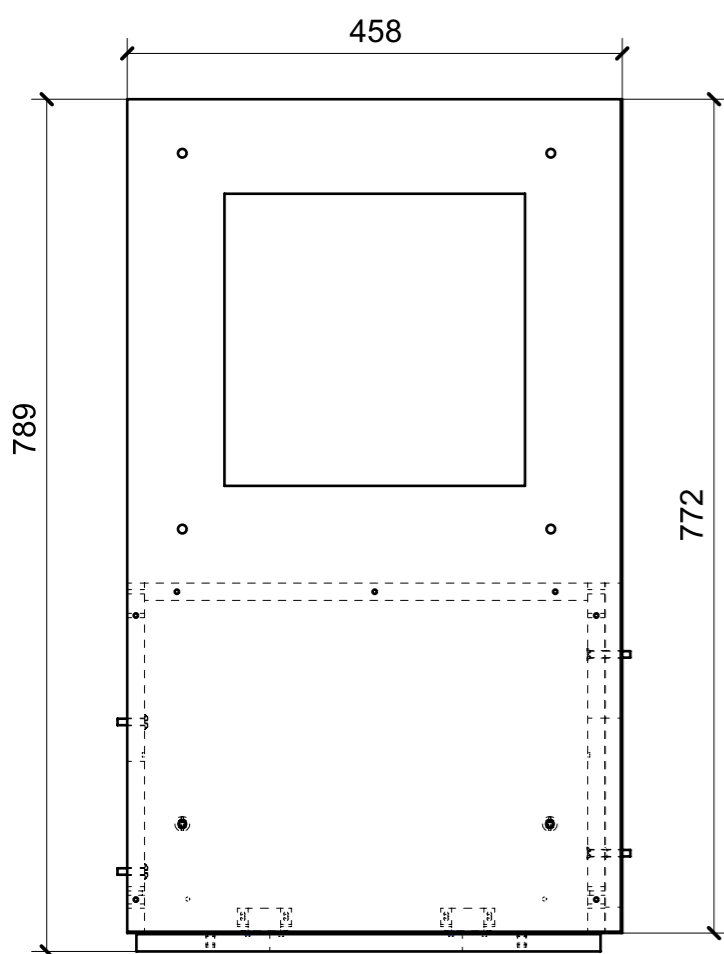

FERRAMENTA	QTY
CALAMITA SEALED MAGNETIC_TECNOPARTNER_MC-JM50-BL	2
VITE 6MA X 40 TESTA SVASATA	2
BUSSOLA 5MA X 10 FORO DIAM.8	2
PLACCHETTA COUNTER STEEL_TECNOPARTNER_MC-JM49	2
VITE 6MA X 25 TESTA BOMBATA	5

LOCALE	CODICE	DESCRIZIONE COMPONENTE	FINITURA	Q.TA
CABINA ARMATORE	MD298_X01_AG01	CASSA TV	LAMINATO SM'ART 3104 CORDA LACCATA	1

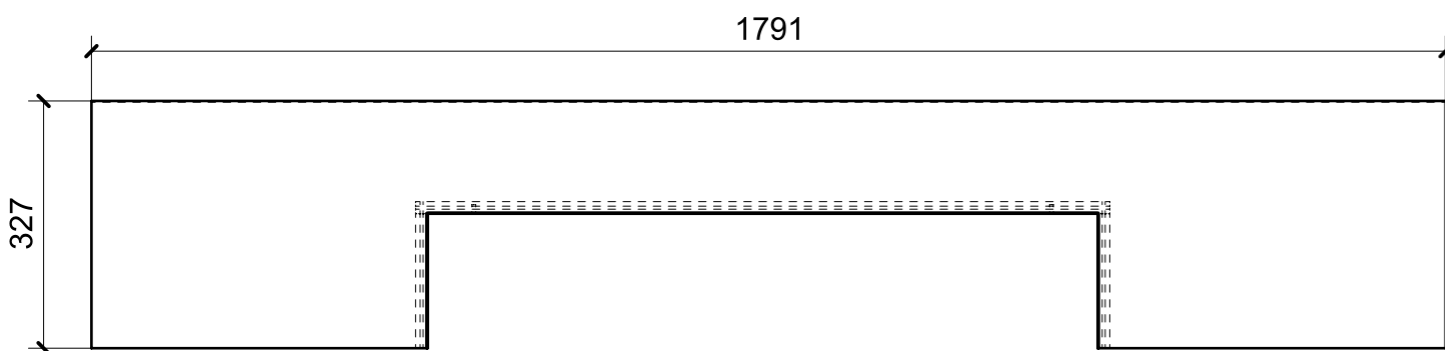
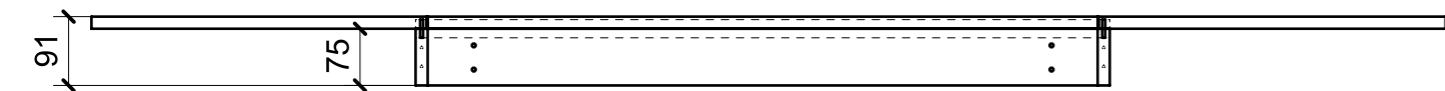

01

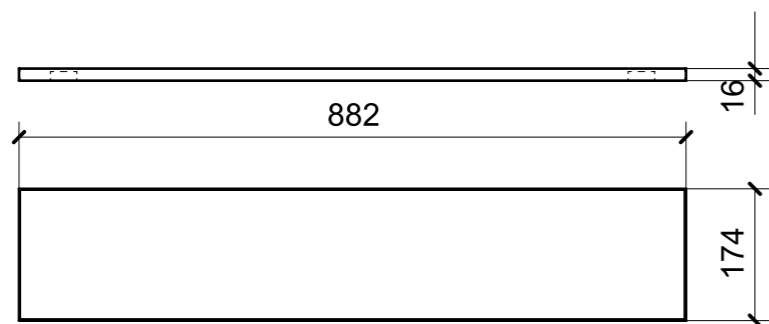

02

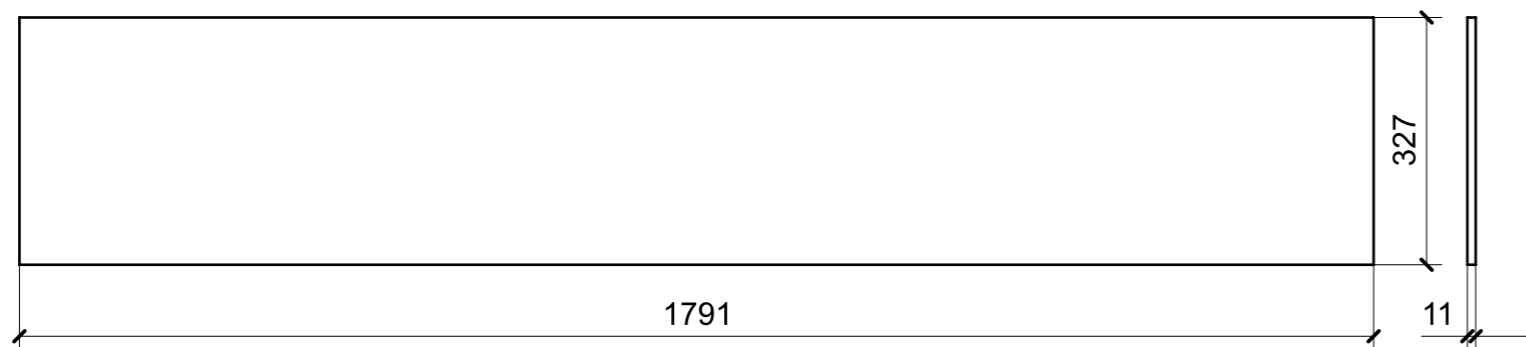

03

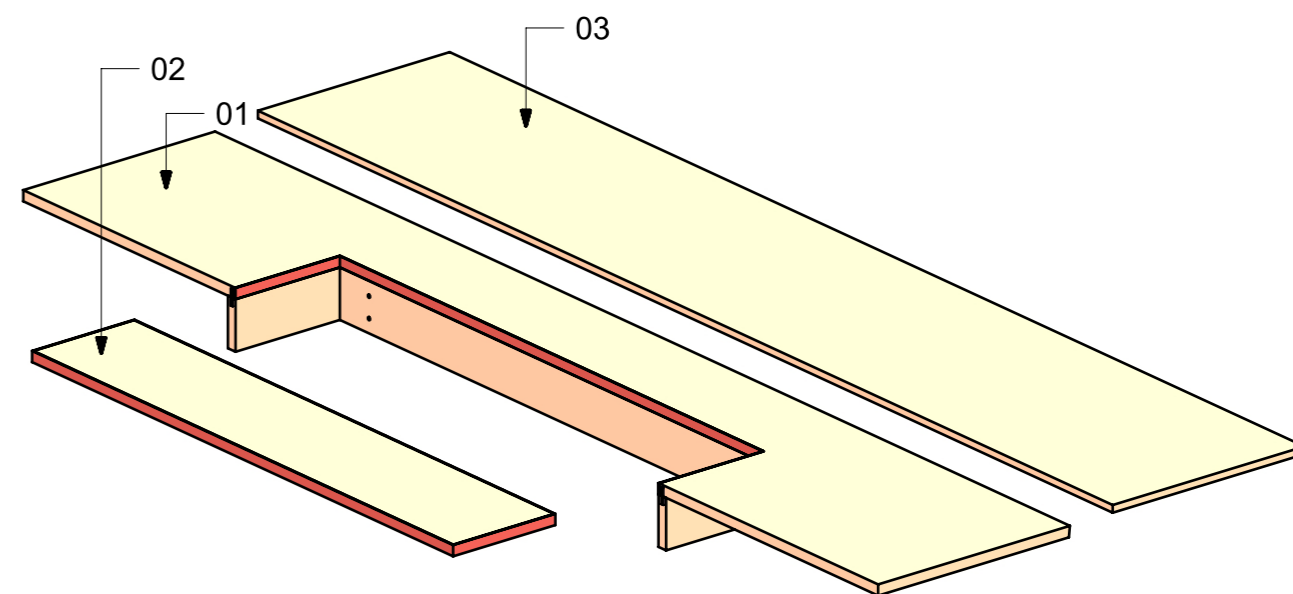

LOCALE	CODICE	DESCRIZIONE COMPONENTE	FINITURA	GR.
CABINA ARMATORE	MD298_X01_AL01	COMODINO POPPIERO	LAMINATO SM'ART 3104 CORDA LACCATA	06

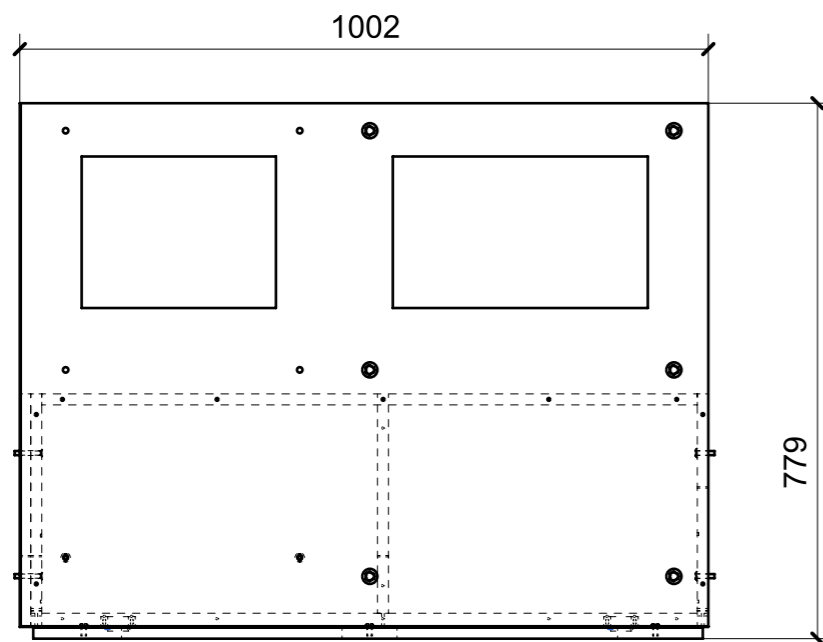
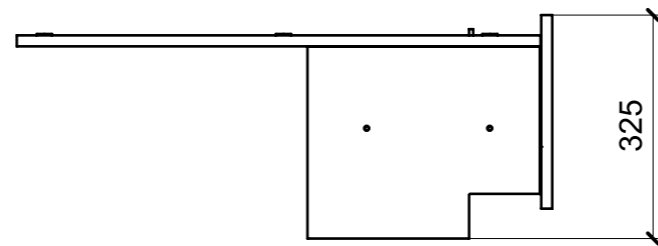
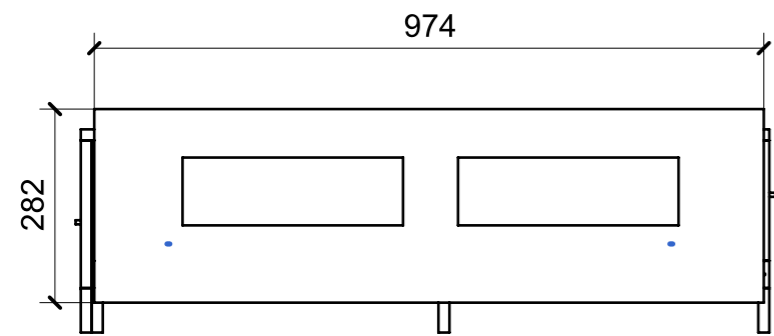

01

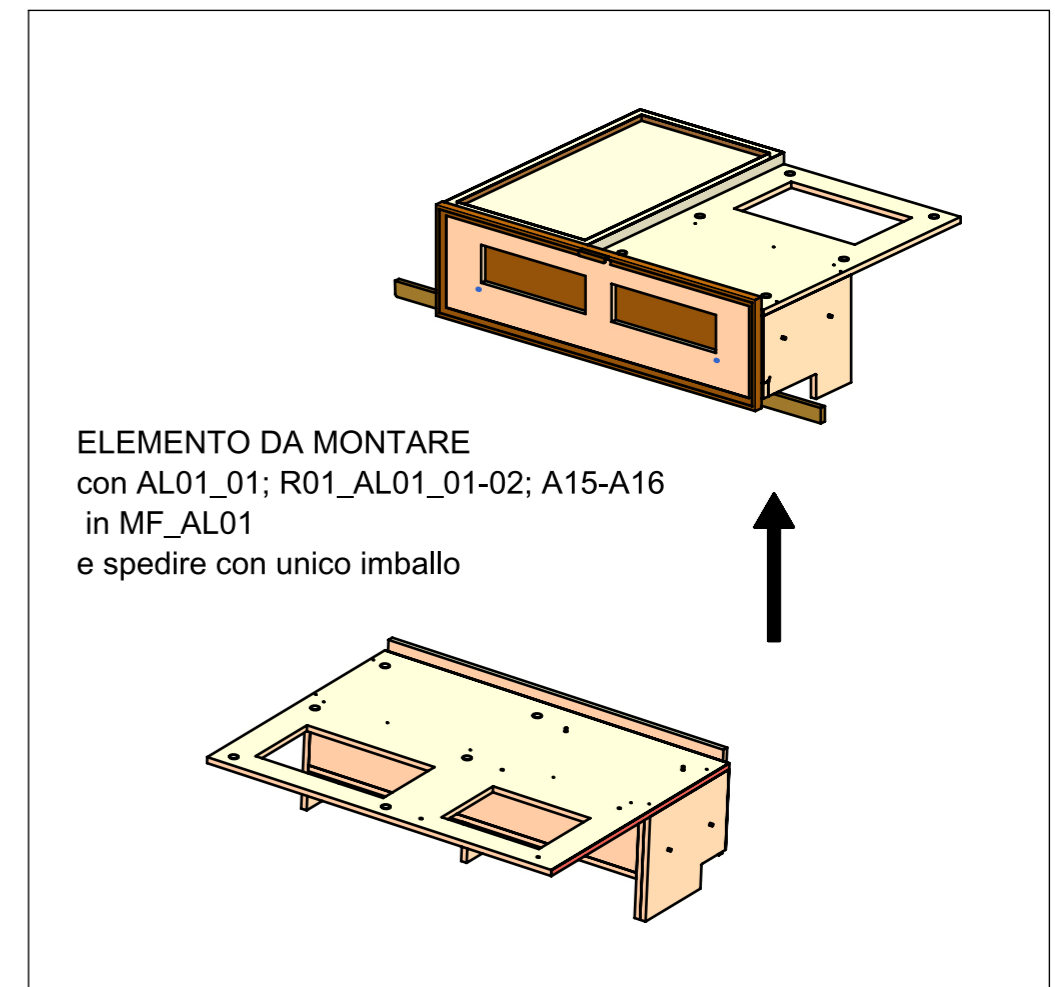

FERRAMENTA	QTY
CALAMITA SEALED MAGNETIC_TECNOPARTNER_MC-JM50-BL	2
VITE 6MA X 25 TESTA BOMBATA	4
FM INCASSO_ITALVIPLA_973_FMPC_F1A	6
VITE 6MA X 40 TESTA SVASATA	2
VITE 5MA X 15 TESTA BOMBATA	3
PLACCHETTA COUNTER STEEL_TECNOPARTNER_MC-JM49	2

LOCALE	CODICE	DESCRIZIONE COMPONENTE	FINITURA	Q.TA
CABINA ARMATORE	MD298_X01_AQ01	CIELINO MURATA DX	LAMINATO SM'ART 3104 CORDA LACCATA	1

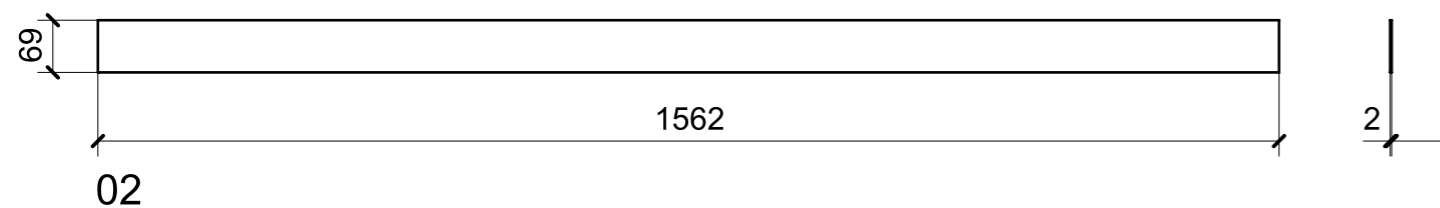
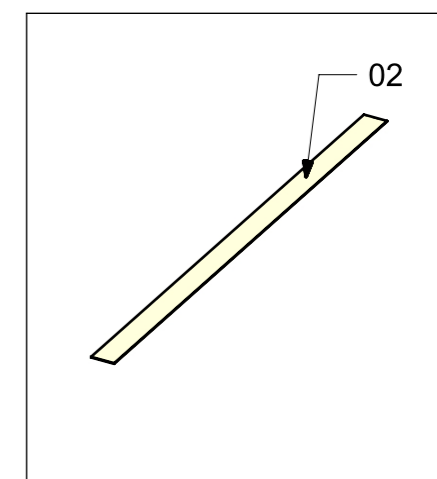
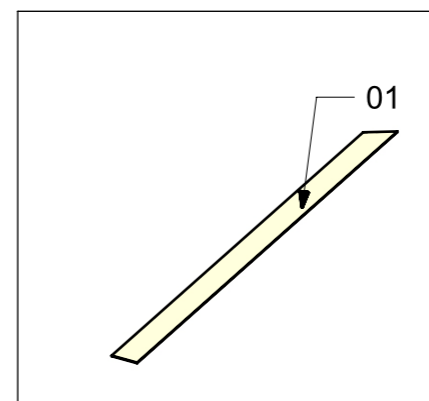
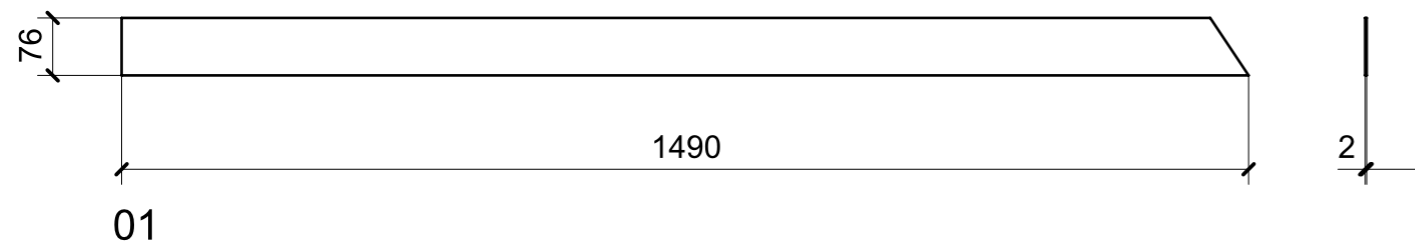

LOCALE	CODICE	DESCRIZIONE COMPONENTE	FINITURA	Q.TA
CABINA ARMATORE	MD298_X01_AR01	CIELINO CENTRALE	LAMINATO SM'ART 3104 CORDA LACCATA	1

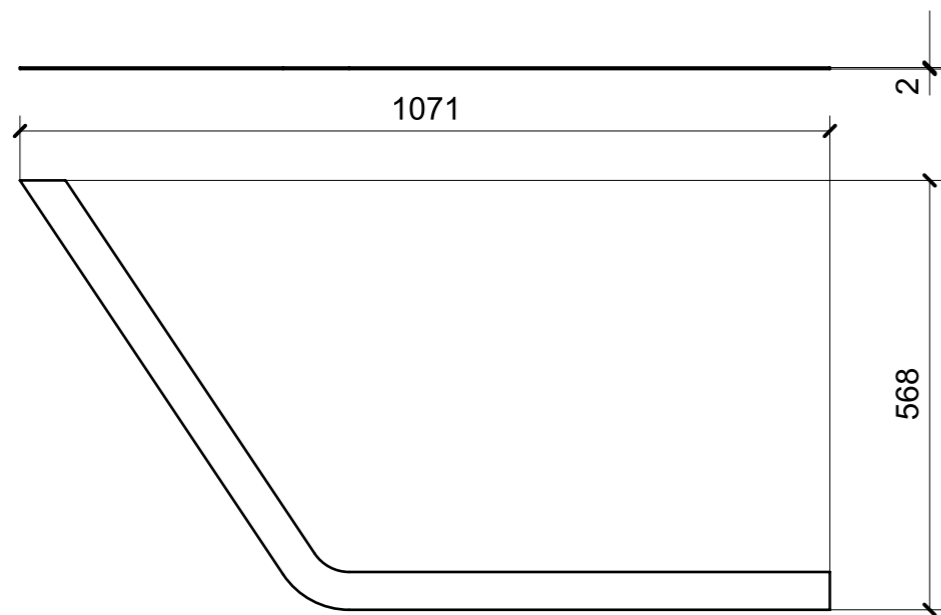

01

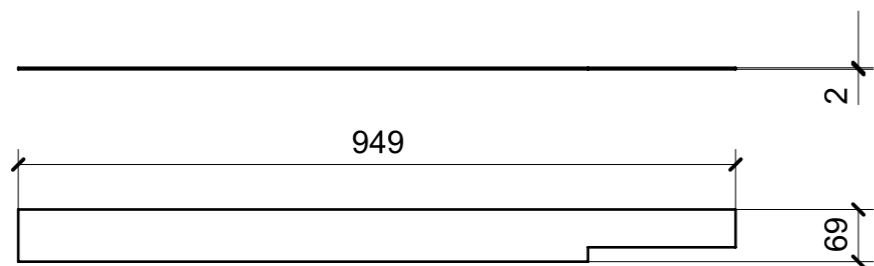
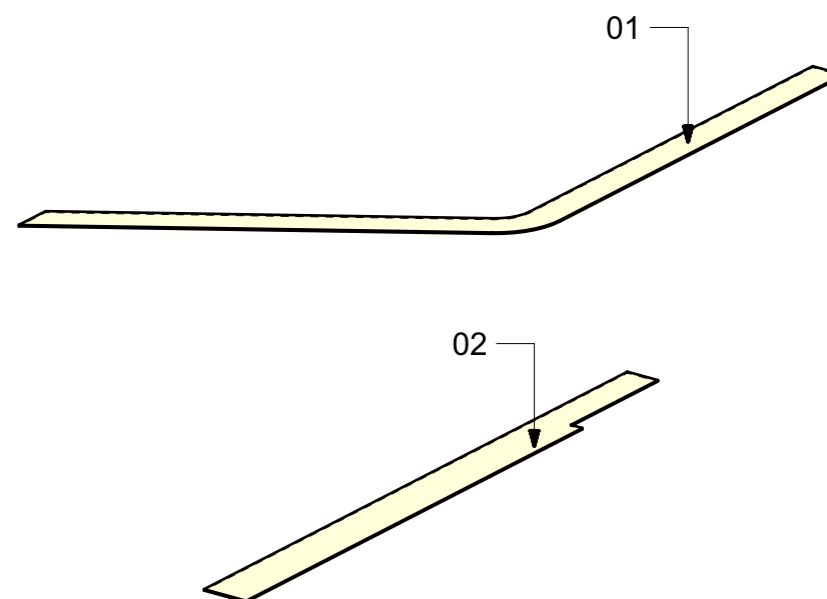

02

LOCALE	CODICE	DESCRIZIONE COMPONENTE	FINITURA	Q.TA
CABINA ARMATORE	MD298_X01_AS01	CIELINO MURATA SX	LAMINATO SM'ART 3104 CORDA LACCATA	1

